



Spring Woods High School Additions and Renovations Board Workshop

Spring Branch Independent School District \\ Houston, Texas \\ March 4th, 2019



Agenda

- Project Recap
- Project Development
- Design Development
- Schedule and Items
- Animation

Project Recap



PAT 01

08-31-2018

KICK-OFF

- Gather Data
- Start Design



PAT 02

09-13-2018

Schematic Design

- Layout Options
- Library Services
- Nutrition Services



PAT 03

09-27-2018

Final Schematic Design

- Refine Layout
- Start Interior Concepts



PAT 04

10-04-2018

Design Development

- Review Interior and plans
- Library Services
- Nutrition Services



PAT 05

10-25-2018

Final Design Develp.

- Finalize Overall Design
- Review Interior Finishes and colors



PAT 06

12-18-2018

Final Design Review

- Review Overall Design
- Review Budget
- Review Finishes

Goal

The goal of the PAT is to ensure that parents, staff and community members have the opportunity to take part in the planning and design of new schools. The PAT members will **serve as communicators** to and from the community during the schematic design and development phases of the project and participate in discussions that will lead to recommendations. The PAT concludes its work once construction begins.

Charge

Each Project Advisory Team's (PAT) members are charged with **providing input into planning and design development** for their school's new construction or major renovation project in the 2017 Bond Program. The PAT will meet as needed throughout the project, from initial planning, through design to the start of construction. Meeting agendas and minutes will be posted on the school's bond project website.



- ENTRY – EXIT ISSUES
- PRIORITY 1: **STUDENT FLOW**
- PRIORITY 2: STUDENT SEATING
- **IMPROVE STUDENT QUEUING**
- RELOCATE ENTRY POINTS
- USE EXISTING TEACHER LOUNGE
- REMOVE EXTERIOR STAIRWAY
- **SINGLE LUNCH A POSITIVE**
- INCREASE LUNCH PERIODS
- MAXIMIZE DAYLIGHT

On behalf of the entire **PBX** Team, we thank you for this opportunity!

"With You Not To You"- SWHS



LIBRARY VISIONING IDEAS

- How do you see the functionality of the Library?
- How is the access to the Library?
- Is there a need to define a main entry on the 2nd floor?
- Does the Library need more "social" areas?
- Does the Library need more "individual" areas?
- Issues with HVAC and Lighting?

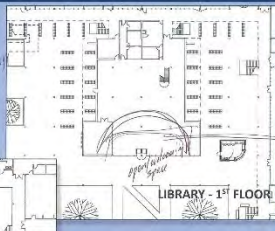

LIBRARY - 1st FLOOR

Sentiments About The Space

- Define a main entry and 2nd floor space is prepared for group spaces in the future?
- or - social areas of group areas on main
- Small personal space on second floor
- first layer of entry - open of light
- "safe" tables, social
- second layer - individual
- upstairs - group spaces (large group)
- social

On behalf of the entire **PBX** Team, we thank you for this opportunity!

"With You Not To You"- SWHS



LIBRARY VISIONING IDEAS

- How do you see the functionality of the Library?
- How is the access to the Library?
- Is there a need to define a main entry on the 2nd floor?
- Does the Library need more "social" areas?
- Does the Library need more "individual" areas?
- Issues with HVAC and Lighting?



LIBRARY - 1st FLOOR

Sentiments About The Space

- Access to tools to inspire & develop ideas.
- Reference materials to access historical & future writings / images

On behalf of the entire **PBX** Team, we thank you for this opportunity!

"With You Not To You"- SWHS



LIBRARY VISIONING IDEAS

- How do you see the functionality of the Library?
- How is the access to the Library?
- Is there a need to define a main entry on the 2nd floor?
- Does the Library need more "social" areas?
- Does the Library need more "individual" areas?
- Issues with HVAC and Lighting?



LIBRARY - 1st FLOOR

Sentiments About The Space

- Dining Commons & Library: They need more "definition" to identify them as "lunch room" & "library room"
- Stair by dining area -> it's on the way - Area needs better flow inside.
- Stair to library access 2nd floor -> wind/dark feeling of "do not go up!"
- More lighting & shared spaces (couches & lounge feeling)

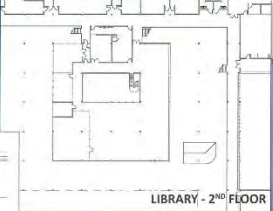

LIBRARY - 2nd FLOOR

DINING COMMONS VISIONING IDEAS

- Is there a student flow issue?
- Is there a need for additional seating?
- How is the front entry to the Commons?
- Is the stair "in the way"?
- How is the entry to the serving area?
- Issues with HVAC and Lighting?

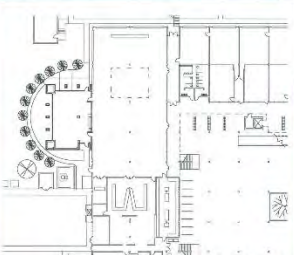

DINING COMMONS

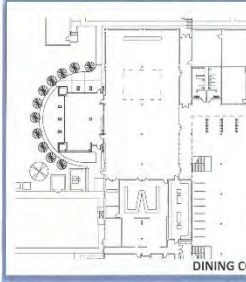

DINING C



11 Greenway Plaza
3rd Floor
Houston, Texas 77046
800.538.7372
SWHS-C1000

- IMPROVE **ACCESIBILITY**
- MORE **INVITING**
- STUDY/ SOCIAL BALANCE
- 1ST FLOOR PLACKED
- 2ND FLOOR UNDERUTILIZED
- WANT **FLEXIBLE SPACES**
- CONNECT TO ACADEMICS
- NO SPACE FOR LARGE GROUPS
- ADD TECH/POWER HUBS
- TAKE ADVANTAGE OF LOCATION

On behalf of the entire **PRK** Team, we thank you for this opportunity!
"With You Not To You"- SWHS

LIBRARY VISIONING IDEAS

- How do you see the functionality of the Library? *Not really because it's in flux w/ 1st fl.*
- How is the access to the Library? *Very good.*
- Is there a need to define a main entry on the 2nd floor? *No! Yes!*
- Does the Library need more "social" areas? *Not more, but defined spaces.*
- Does the Library need more "individual" areas? *Flexibility.*
- Issues with HVAC and Lighting? *It's cold. Lighting is fantastic.*

Sentiments About The Space

- Library wish list →
- updated furniture
- remote window blinds
- larger circulation desk
- updated active boards w/ software
- handicapped entrance - library 4

LIBRARY - 1ST FLOOR

On behalf of the entire **PRK** Team, we thank you for this opportunity!
"With You Not To You"- SWHS

LIBRARY VISIONING IDEAS

- How do you see the functionality of the Library?
- How is the access to the Library?
- Is there a need to define a main entry on the 2nd floor?
- Does the Library need more "social" areas?
- Does the Library need more "individual" areas?
- Issues with HVAC and Lighting?

Sentiments About The Space

- Love the natural light!
- columns provide structural support for a second vintage restoration in second floor area. Separating from building from building from an entrance that allows movement between function/purpose of library to rest place in ca.

LIBRARY - 1ST FLOOR

On behalf of the entire **PRK** Team, we thank you for this opportunity!
"With You Not To You"- SWHS

LIBRARY VISIONING IDEAS

- How do you see the functionality of the Library?
- How is the access to the Library?
- Is there a need to define a main entry on the 2nd floor?
- Does the Library need more "social" areas?
- Does the Library need more "individual" areas?
- Issues with HVAC and Lighting?

Sentiments About The Space

- Library - need and store entry - overall layout need renovations so that classes that are using the library are not disturb when other enter - needs a media area for student use - love the natural light but not the sound - library needs more signage of area - move extract fans out and use the space for student centers Cafeteria - yes there is a structural problem, and a need for more seating - Is it possible to make it two stories by removing the class rooms - make more inviting

LIBRARY - 1ST FLOOR

LIBRARY - 2ND FLOOR

DINING COMMONS VISIONING IDEAS

- Is there a student flow issue? *Lines block doors*
- Is there a need for additional seating?
- How is the front entry to the Commons?
- Is the stair "in the way"? *Yes - remove staircase*
- How is the entry to the serving area? *Blocked to traffic*
- Issues with HVAC and Lighting? *throughout the building*

DINING COMMONS

PRK
11 Greenway Blvd
22nd Floor
Houston, Texas 77055
800.938.7272
PRK.com

- **CODE AND STAIRS**
- **SKYLIGHT & KIOSK**
- **HVAC (VRF)**
- **SITE & SECURITY**
- **WAYFINDING**
- **FURNITURE**
- **BUDGET**

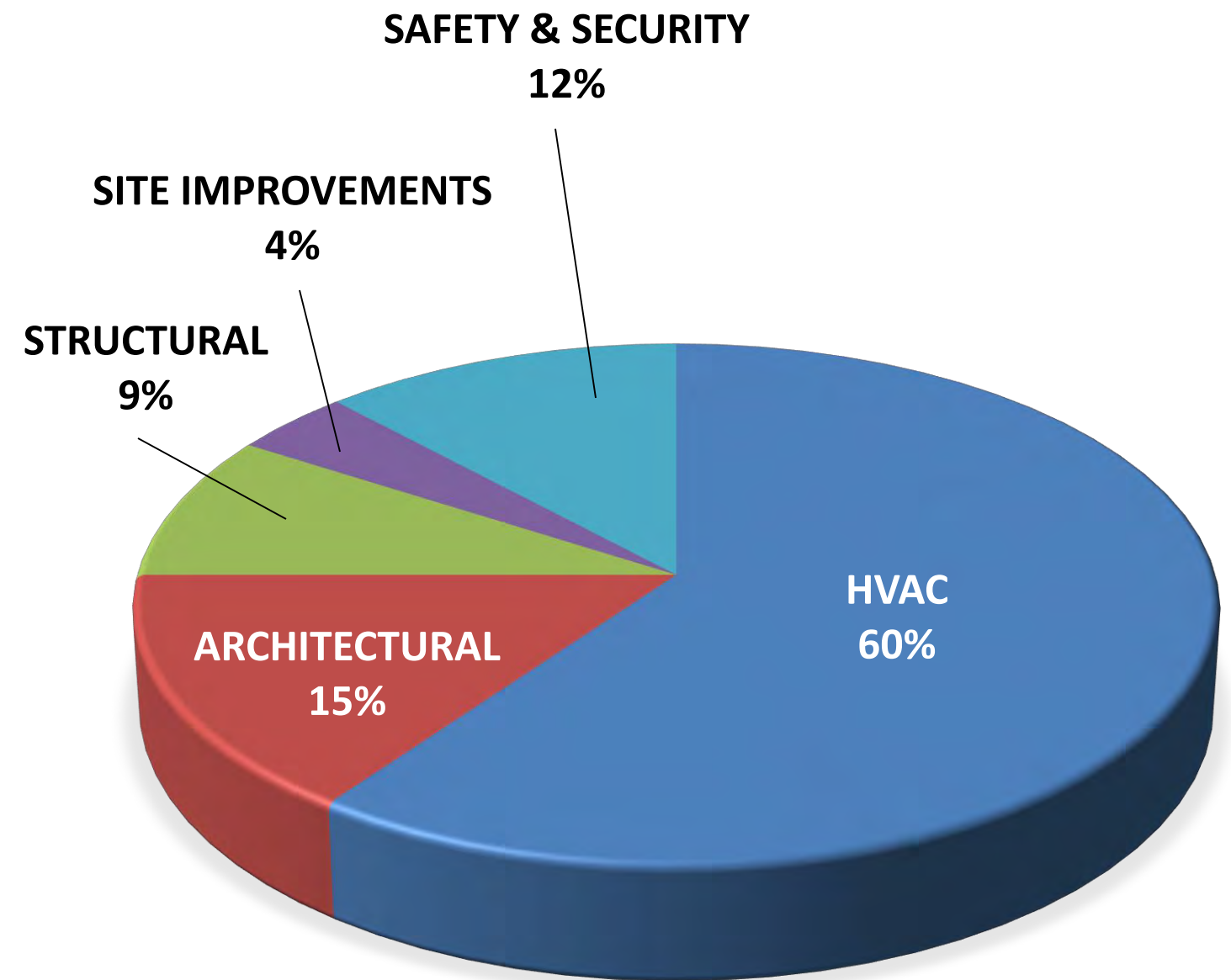

- **ATHLETICS**
- **FURNITURE**

Design Development

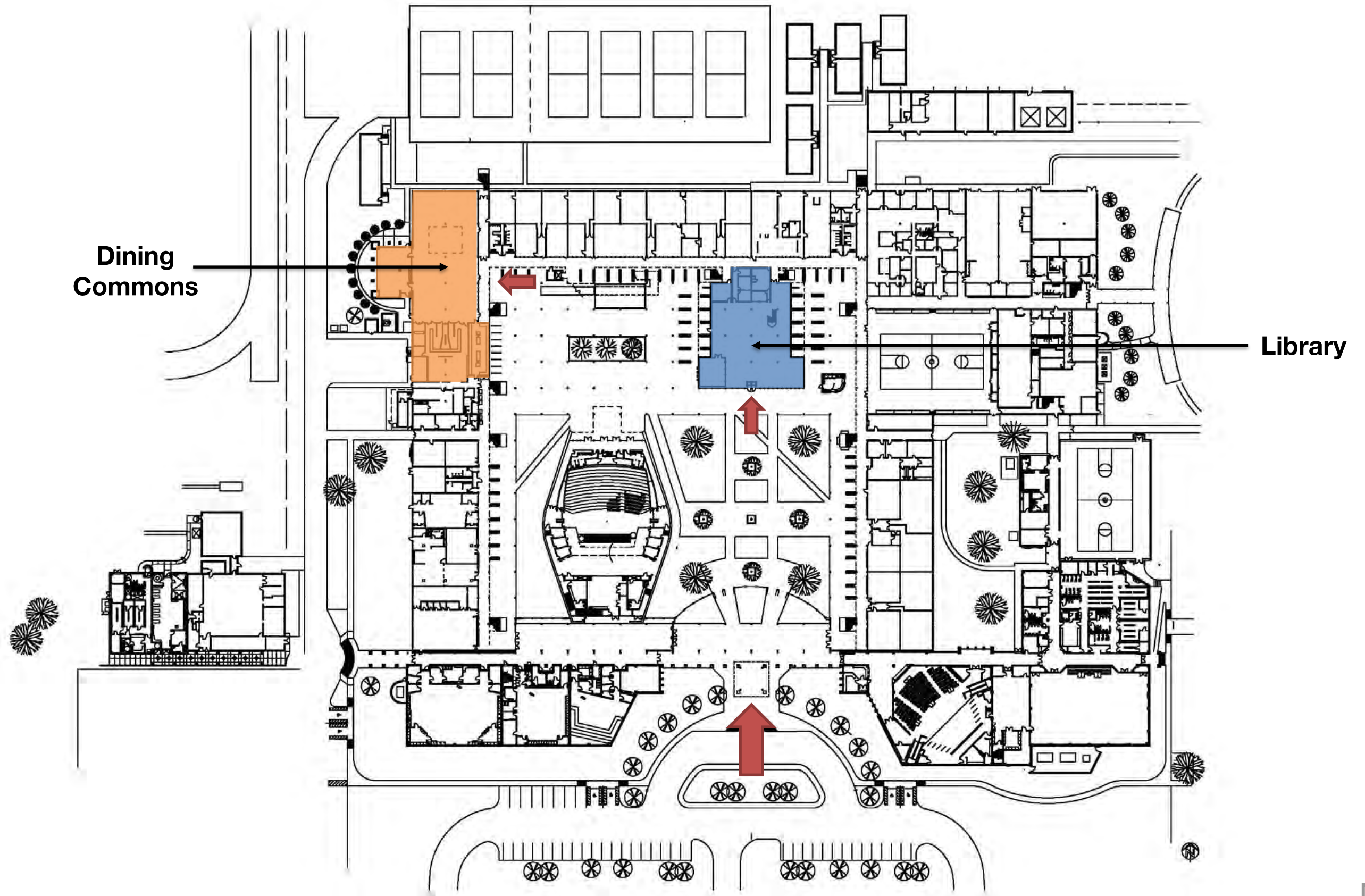

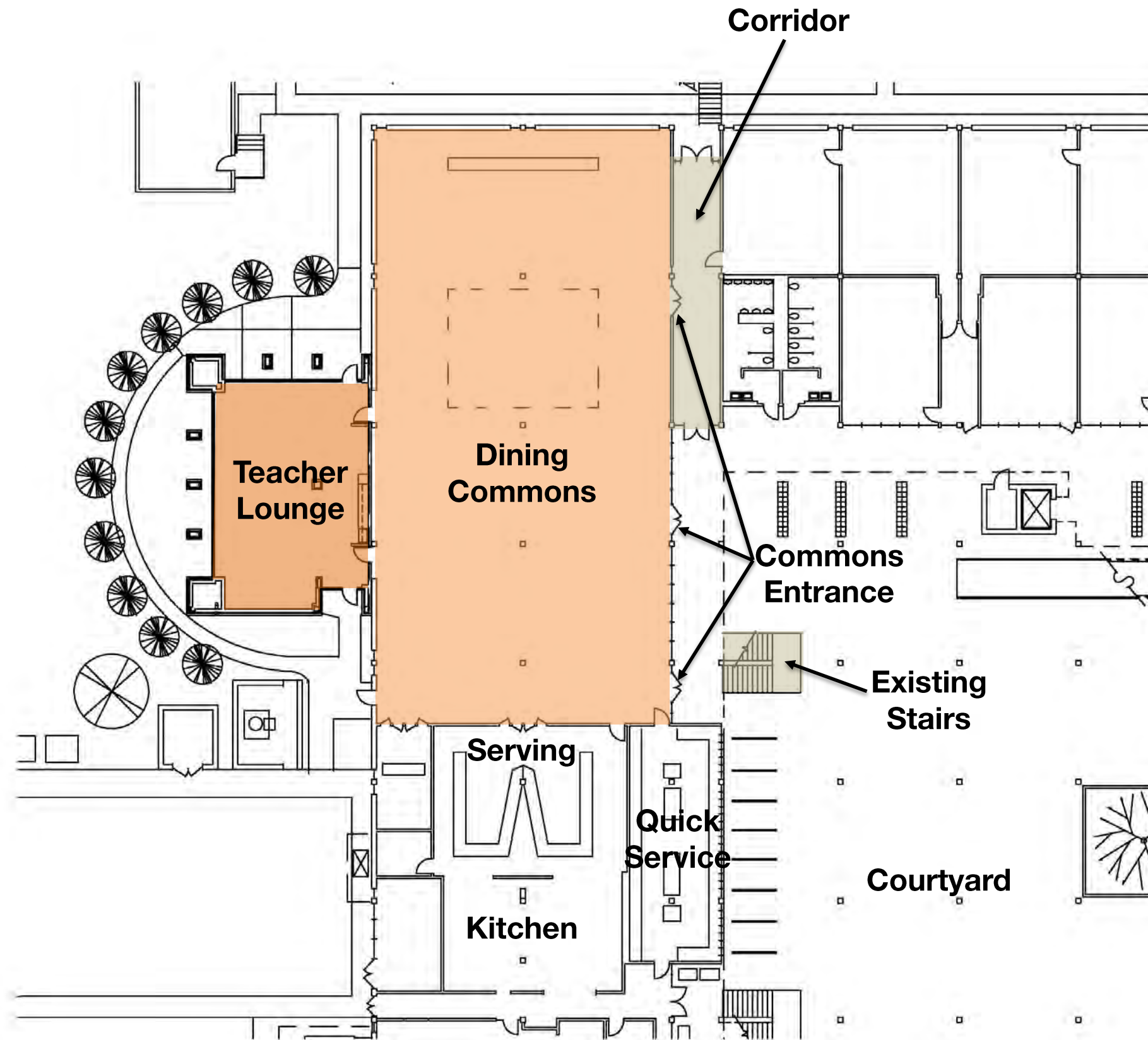



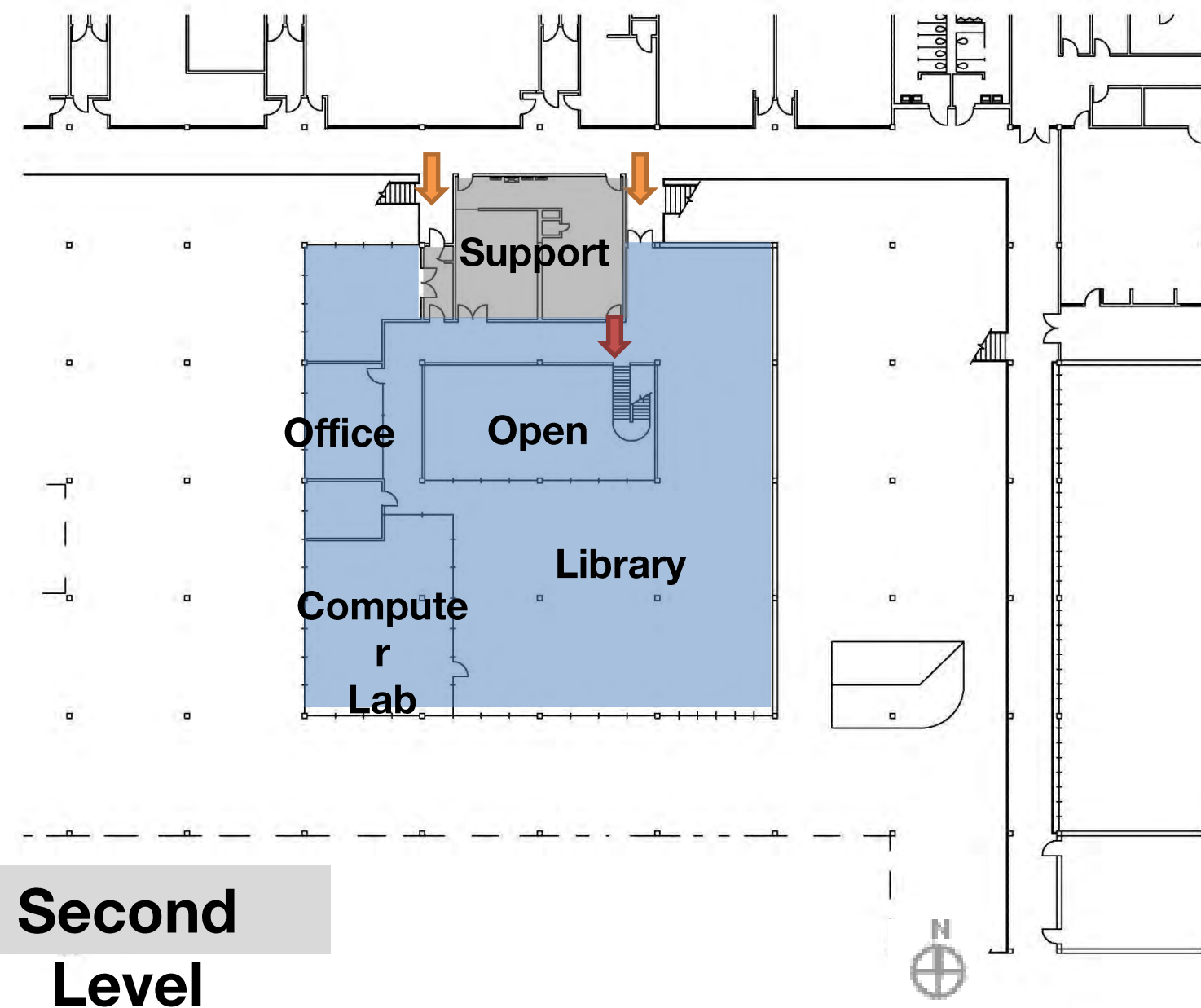
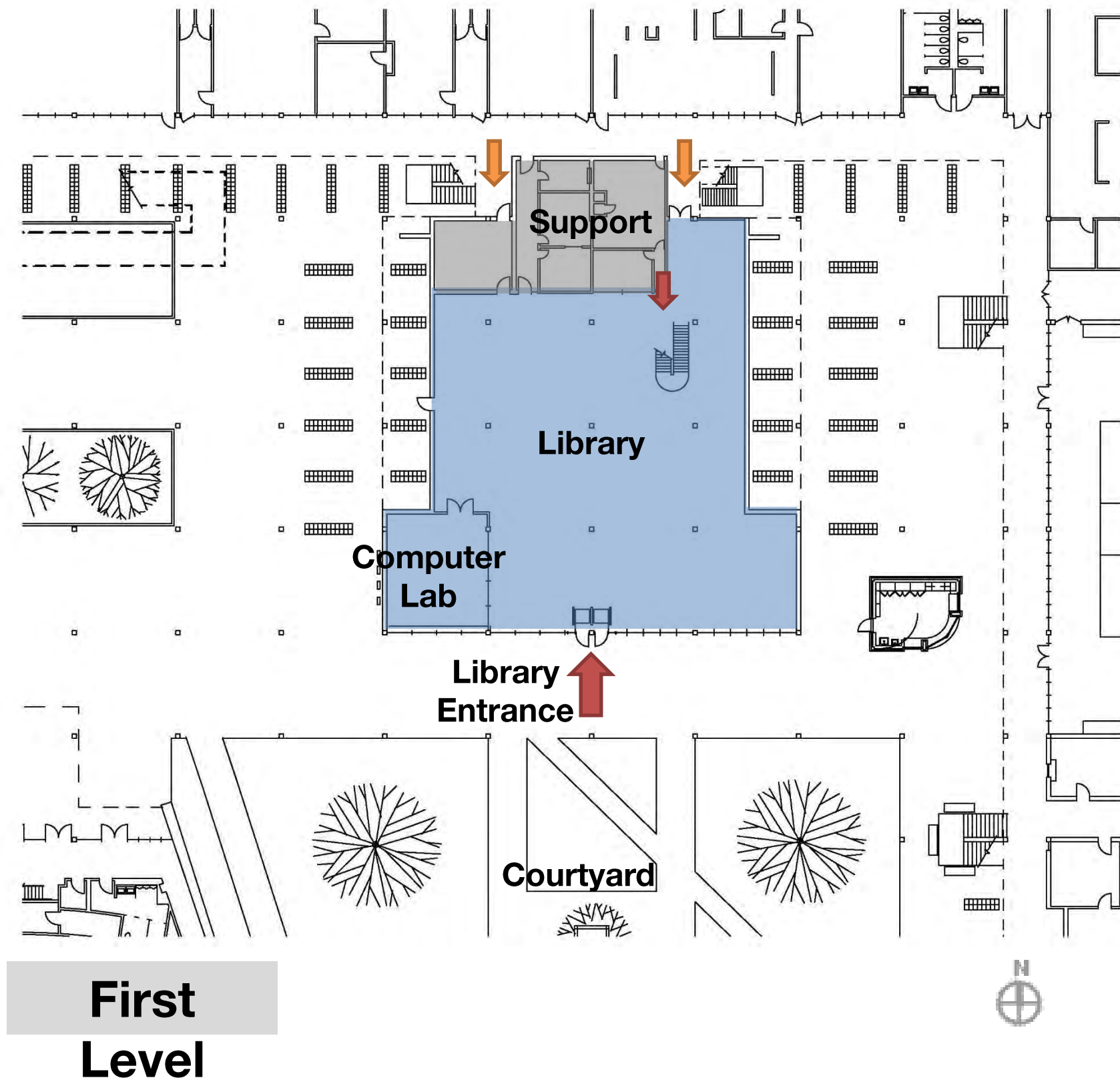



Spring Woods High School Additions and Renovations

Dining Commons Design Development

Seating Count/ Queue Line

Tables/ Seating

Existing Seating: 468 seats

New Seats (inside): 607 seats

Queue Lines

Existing Queue: 255 lft.

New Queue: 440 lft.

**Proposed
New
Windows**

**Proposed
High -Top
Counter**

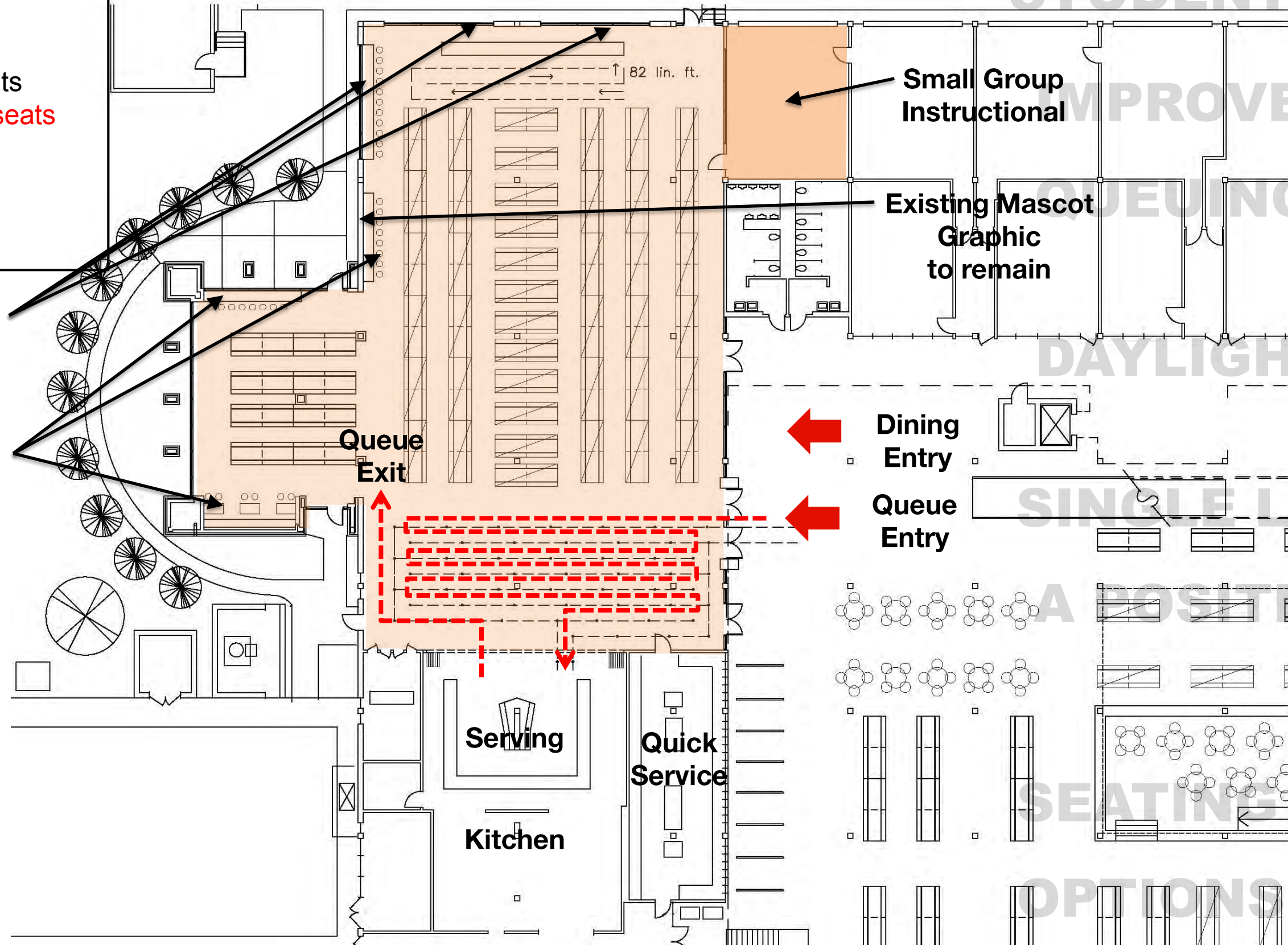







ACCESSIBILITY

INVITING

FLEXIBLE

SEATING
OPTIONS

GATHERING
OPTIONS

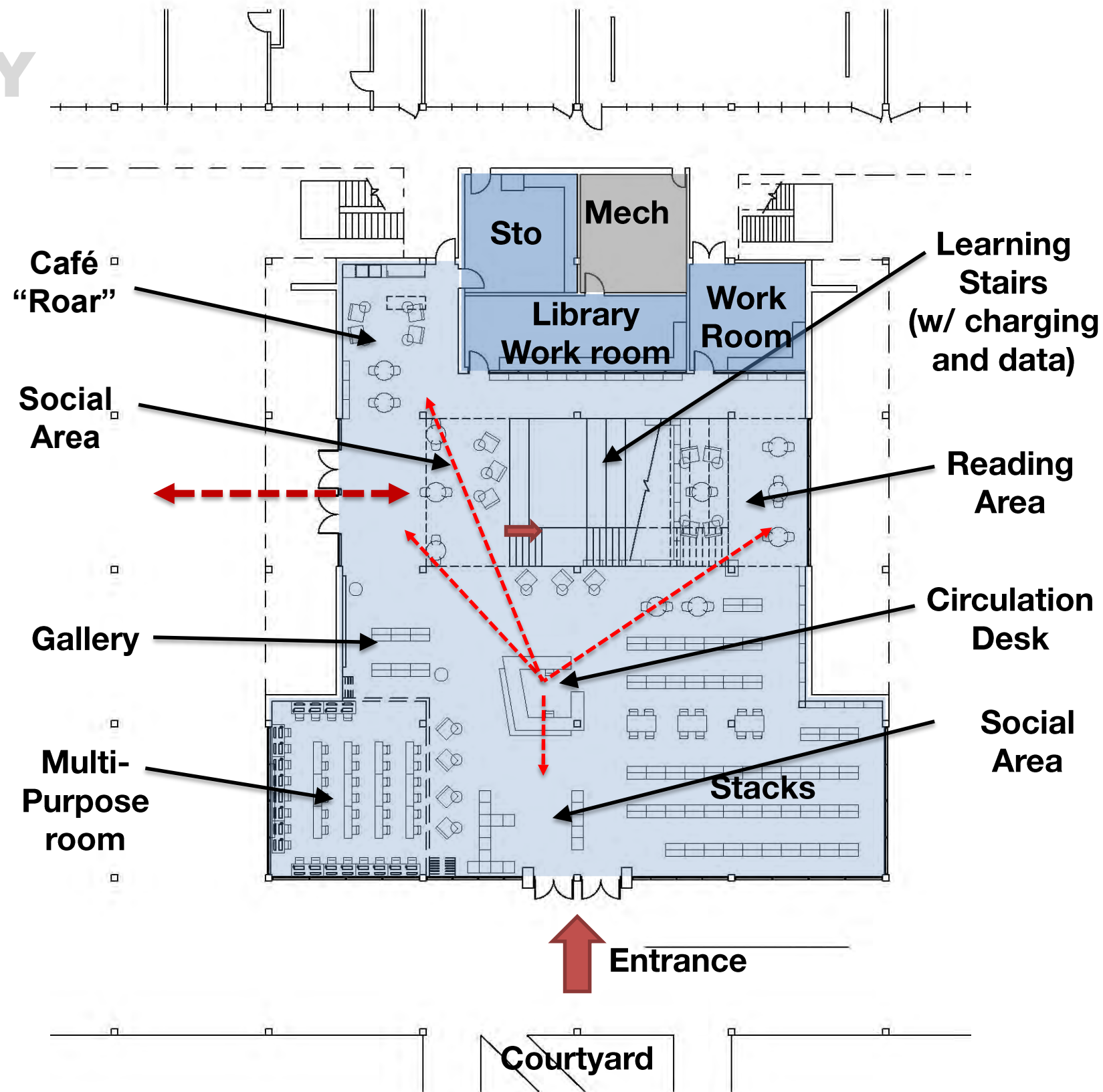

Book Count

**TEA Acceptable
(2,300 Students)**
18,500 Books

Shelves
Full 14 units = 2,450 books
Std 124 units = 12,400 books
Half 13 units = 975 books

Total
15,825 Books

ACCESSIBILITY

INVITING

FLEXIBLE

SEATING
OPTIONS

GATHERING
OPTIONS

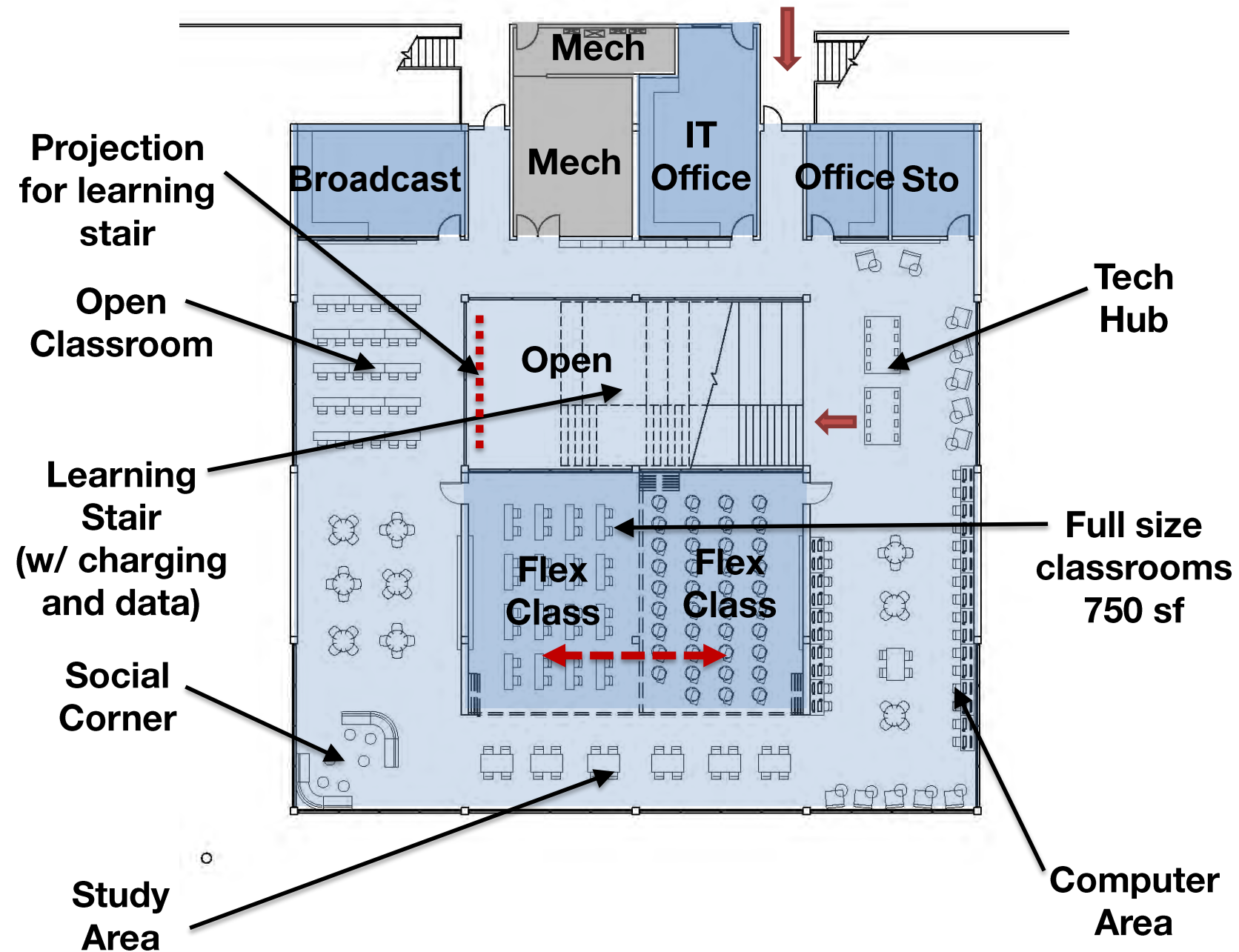

Book Count

TEA Acceptable
(2,300 Students)
18,500 Books

Shelves
Full 14 units = 2,450 books
Std 124 units = 12,400 books
Half 13 units = 975 books

Total
15,825 Books







Spring Woods High School Additions and Renovations

Learning Center Interior View (1st Level)









Spring Woods High School Additions and Renovations

Tiger Plaza Design Development

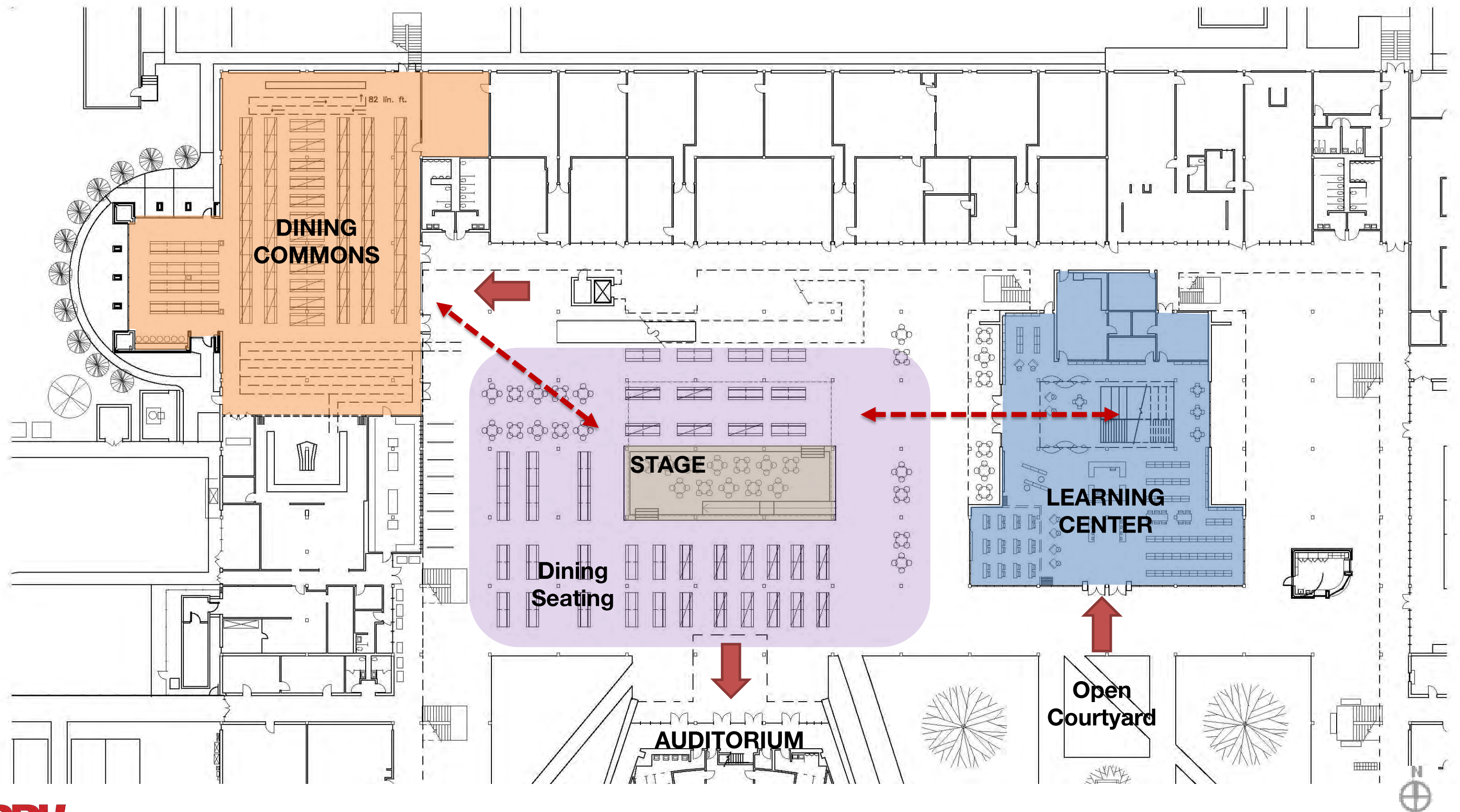

Spring Woods High School Additions and Renovations

Tiger Plaza Design Development (Pep Rally layout)

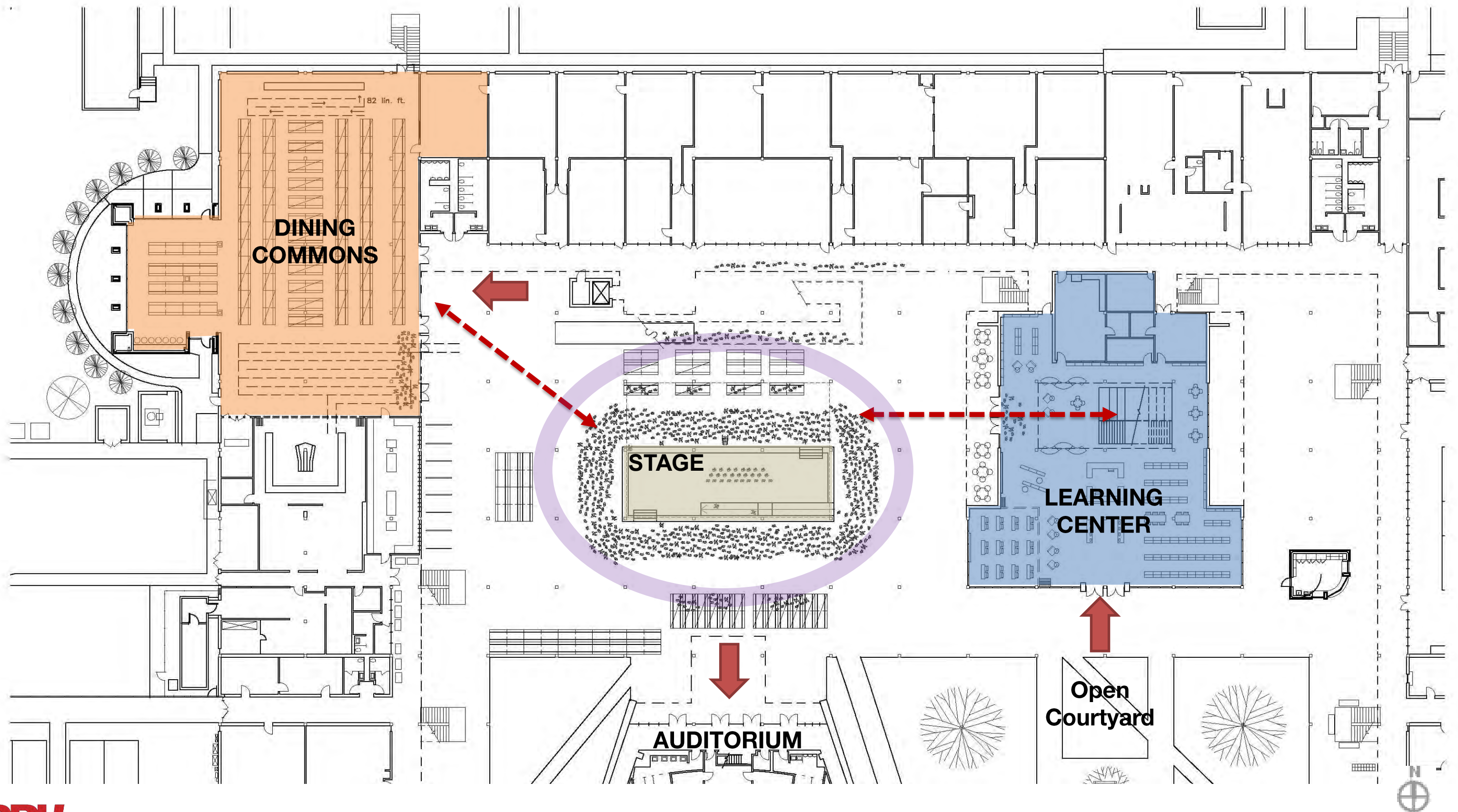

Spring Woods High School Additions and Renovations

Tiger Plaza Design Development (Performance Layout)

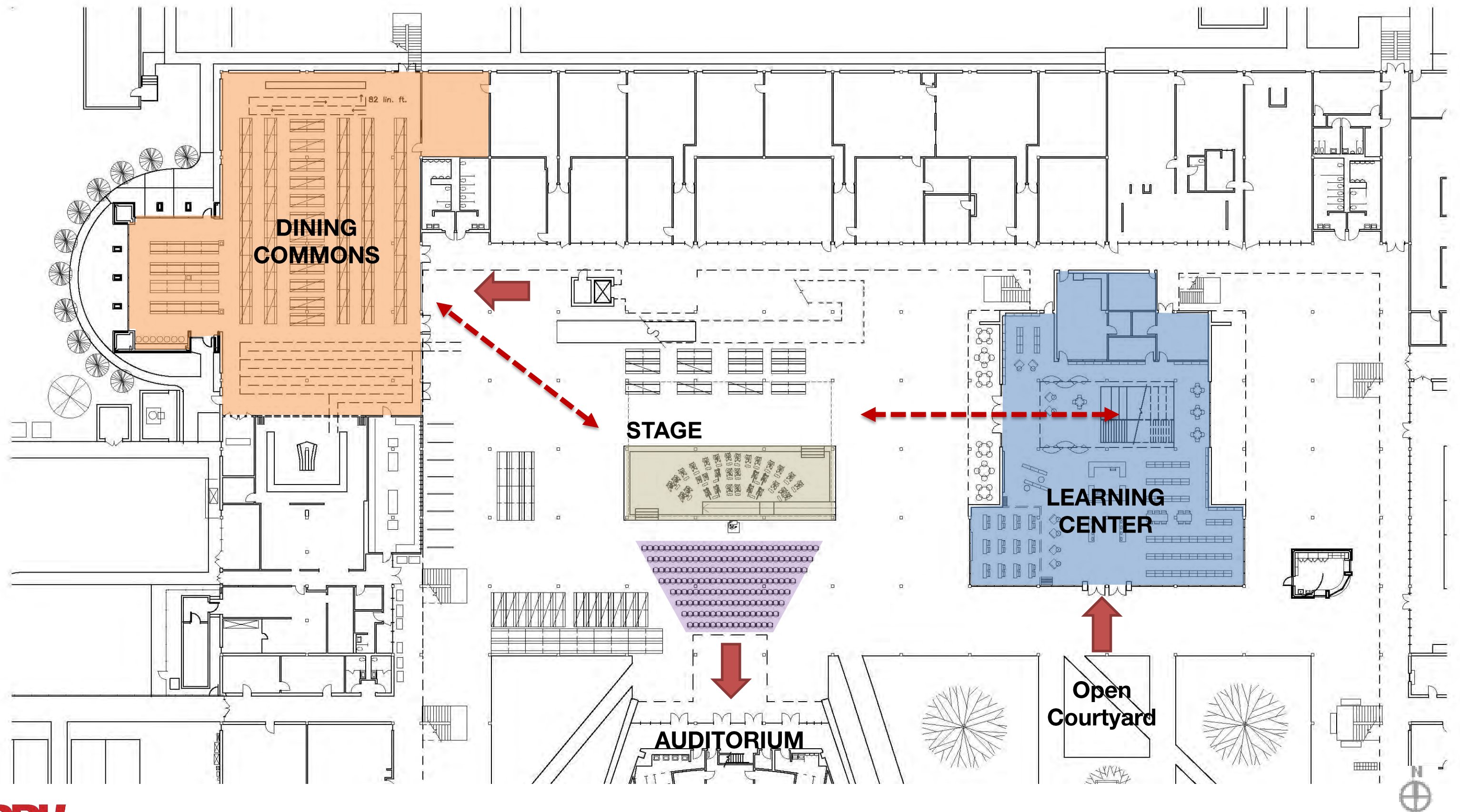







Spring Woods High School Additions and Renovations

Learning Center Exterior View (Side Entry)





Animation





Thank You!

