



**INVITATION TO BID  
BID NO. 9869  
CORRIDOR LOCKER REPLACEMENT  
BOULAN PARK AND LARSON MIDDLE SCHOOLS  
FOR TROY SCHOOL DISTRICT**

The Troy School District will receive firm, sealed bids for furnishing, delivering and installing corridor lockers at Boulan Park and Larson Middle Schools.

Specifications and proposal forms can be obtained online at <http://www.troy.k12.mi.us>. From the main page click the "Business Services" tab listed under "Departments", then click "Purchasing" and scroll down to locate and access the bid document.

Your proposal and one copy marked "**Bid No. 9869 Corridor Locker Replacement**" must be delivered no later than 1:00 pm, Thursday, November 29, 2018, Troy School District Administration Offices, 4400 Livernois Road, Troy, MI 48098, at which time all bids will be publicly opened and read aloud immediately thereafter. Bid proposals received after this time will not be considered or accepted.

A pre-bid walk through has been scheduled at 4:00 pm, Tuesday, November 20, 2018, at Boulan Park Middle School, 3570 Northfield Parkway, Troy, MI 48084. All questions regarding the services specified, the bid specified, or the bid terms and conditions will be accepted in writing ONLY and subsequently answered through an addendum to all interested parties. Questions must be received no later than the end of business day, Monday November 26, 2018; at no other time prior to the bid opening will questions/concerns be addressed or accepted and may be faxed to: 248.823.4077, or emailed as a Word document to: [PurchasingOffice@troy.k12.mi.us](mailto:PurchasingOffice@troy.k12.mi.us)

All bidders must provide familial disclosure in compliance with MCL 380.1267 and attach this information to the bid proposal. The bid proposal will be accompanied by a sworn and notarized statement disclosing any familial relationship that exists between the owner or any employee of the bidder and any member of the Troy School Board or the Troy School Districts Superintendent. Also, a sworn and notarized Affidavit of compliance for the Iran Economic Sanctions Act certifying the vendor does and will comply with Public Act 517 of 2012 shall accompany all proposals. Both forms will be enclosed in the specification's booklet that shall be used for this purpose. The District will not accept a bid proposal that does not include these sworn and notarized disclosure statement.

In accordance with Michigan Compiled Laws Section 129.201, successful bidders whose proposals are \$50,000 or more, for any bid category, will be required to furnish a U.S. Treasury Listed Company Performance and Payment Bond in the amount of 100% of their bid. The cost of the Bond shall be identified within each proposal.

The Troy Board of Education reserves the right to accept or reject any or all bids, either in whole or in part; to award contract to other than the low bidder; to waive any irregularities and/or informalities; and in general to make awards in any manner deemed to be in the best interest of the owner.

Purchasing Department  
Troy School District  
1140 Rankin  
Troy, MI 48083

## **INSTRUCTIONS TO BIDDERS**

### **PROPOSAL/INTENT**

1. The Troy School District will receive firm, sealed bids for all labor, material, equipment and all other services to complete Bid 9869 Corridor Locker Replacement at Boulan Park and Larson Middle Schools.
2. Proposals will be submitted only on the forms provided, will be enclosed in a sealed envelope marked with the name of the bidder, the title of the work and must be delivered to Troy School District Administration Offices, 4400 Livernois Road, Troy, MI 48098, no later than 1:00 pm, Thursday, November 29, 2018, at which time all bids will be publicly opened and read aloud immediately thereafter. Bid proposals received after this time will not be considered or accepted. Oral, telephone, fax or electronic mail bids are invalid and will not receive consideration. Submit one original and one copy.
3. Proposals will be made in conformity with all the conditions set forth in the specifications. All products must conform to the specifications.
4. A pre-bid walk through has been scheduled at 4:00 pm., Tuesday, November 20, 2018, at Boulan Park Middle School, 3570 Northfield Parkway, Troy, MI 48084. Questions must be received no later than the end of business day, Monday, November 26, 2018.
5. Bidder shall be reputable and a recognized organization, with at least five (5) years successful experience on work of this type and scope, of equal or better quality than this project.
6. References in the specifications to any article, product, material, fixture, form or type of construction, etc., by proprietary name, manufacturer, make or catalog number will be interpreted as establishing a standard quality of design and will not be construed as limiting proposals.
7. Bid bond or certified check, for an amount not less than five (5%) percent of the amount of the bid, must accompany each bid. Failure to submit proper bid security shall constitute rejection of bid.
8. A performance bond shall be required for the project if the cost is in excess of \$50,000 and must be listed separately on the proposal form as an individual line item.
9. A completed Familial Disclosure and an Iran Economic Sanctions form must be included with each proposal submitted or the proposal will not be accepted, please note these forms must be notarized.
10. The Troy Board of Education reserves the right to accept or reject any or all proposals either in whole or in part; to waive any irregularities and/or informalities; and in general to make awards or cancel this proposal, if deemed to be in the best interests of the owner.

### **SCOPE**

This specification includes furnishing, delivering and installing corridor lockers at Boulan Park and Larson Middle Schools, in accordance with the attached specifications. The awarded Vendor must follow the manufacturer recommended installation guidelines, test and provide training, with follow-up visits, for new products, as well as, remove the existing old equipment for this project.

### **WARRANTY**

All material and equipment will be guaranteed to be free from defects in both workmanship and materials for no less than two years from date of receipt/installation. If manufacturer warranty exceeds this minimum requirement, the manufacturer warranty will prevail. Any item(s) found to be defective will be replaced or repaired within seven working days at Vendor(s) expense.

### WITHDRAWAL OF BIDS

Any bidder may withdraw their bid at any time prior to the scheduled time for receipt of bids. No proposal may be withdrawn until after 45 days after bid opening.

### FIRM PRICING

Unit pricing will prevail when computing total quantity on bids. No price allowance or extra consideration on behalf of the bidder will subsequently be allowed by reason of error or oversight on the part of the bidder. The successful bidder(s) will hold bid prices firm for all purchase orders placed for a period of approximately one full year.

### PERMITS, FEES AND REGULATIONS

The Contractor shall obtain and pay for all permits, assessments, fees, bonds, and other charges as necessary to perform and complete the work of this contract, including disconnection charges, capping and unplugging utilities.

The Contractor shall be responsible for obtaining all permits and licenses necessary for the proper completion of project. Permits and licenses are available from the appropriate agencies having jurisdiction. The Contractor shall give all notices, pay all fees and comply with all laws, ordinances, rules and regulations bearing on the work. At the completion of the project, the Contractor will provide to the District all paperwork related to the full execution of the permits(s), including all payments and inspections.

If any of the work of the Contractor is done contrary to such laws, ordinance rules and regulations without such notice, he shall bear all costs arising therefrom. The Contractor shall include all cost and taxes in its bid, and make proper provisions for payment of all other State and Federal applicable taxes, fees or other costs.

### TAXES

Troy School District is not automatically exempt from State of Michigan Sales and Use Taxes. The District must pay these taxes when materials are to be incorporated into reality. Materials that are permanently attached i.e lockers, built-in, incorporated or otherwise made part of the structure all applicable taxes shall be paid by the Vendor. Troy School District shall not be responsible for any taxes that are imposed on the Vendor. Furthermore, the Vendor understands that it cannot claim exemption from taxes by virtue of any exemption that is provided to Troy School District.

### DELIVERY/INSTALLATION

Time of delivery is part of the consideration. It is understood that the bidder agrees to deliver prepaid to the schools, specified from the resulting contract, all items. All cost of delivery, drayage, freight, packing, unpacking, and setup are to be included in the prices bid.

The Contractor is responsible for removing from the project all waste materials and rubbish resulting from his operations and installation including all packing cartons and debris. Removal is to occur on a daily basis. Failure to do so will result in the Owner doing so and the cost thereof shall be charged to the Contractor as a deduction in his contract price.

The Contractor shall provide an adequate number of qualified, experienced installers, in harmony with other works at the site.

### BID BOND

Bid Bond or certified check, for an amount not less than five (5%) percent of the amount of the bid, must accompany each bid. The check or bond of each unsuccessful bidder will be returned within ten (10) days after the bid is awarded. Failure of any accepted bidder to enter into a contract to complete the specified work may forfeiture of his bid security. Failure to submit proper bid security shall constitute rejection of bid.

### PERFORMANCE BOND/PAYMENT BOND

Within fourteen (14) days after date of issuance of written notice of selection for the award of a contract, which shall be considered as the notice to proceed, the successful bidder shall enter into a contract with the Owner and shall execute and file with the Owner, the following in the amount 100% equal to full contract sum.

A performance bond shall be required for the project if the cost is in excess of \$50,000 and must be listed separately on the proposal form as an individual line item. The Performance Bond must insure the faithful performance of all provisions of the contract and satisfactory completion of the specified work, within the time agreed upon.

The payment bond must insure the payment and protection of claimants supplying labor or materials to the principal contractor or his subcontractors in the prosecution of the work provided for in the contract. The successful contractor's bond company must be listed by the State of Michigan as a licensed carrier and have an excellent or superior rating from AM Best Company.

### SAFETY

Under the "General Conditions of the Contract for Construction" of the contract to be awarded, the Contractor;

- a) shall be solely responsible for and have control over construction means, methods, techniques, sequences and procedures;
- b) shall be responsible for initiating, maintaining, and supervising all safety precautions and programs in connection with the performance of the contract;
- c) shall take reasonable precautions for safety of all persons who may be affected, including employees of the Contractor and Subcontractor; and
- d) shall have an accident prevention representative at the site.

The general conditions of the contract for construction and the agreement also require that the Contractor indemnify the Owner in the event of certain claims arising out of the performance of the work.

### INSURANCE REQUIREMENTS

The Contractor shall protect, defend and indemnify the Owner, its officers, agents, servants, volunteers, and employees from any and all liabilities, claims, liens, demands, and costs of whatsoever kind and nature which may result in injury or death to any persons, and for any result in injury or death to any person, and for loss or damage to any property, including property owned or in the care, custody, or control of the Owner in connection with or in any way incident to or arising out of the occupancy, use, with this Agreement resulting in whole or in part from negligent acts or omissions of the Contractor, any Subcontractor, or any employee, agent or representative of the Contractor or any Subcontractor.

The Contractor shall maintain, at its expense, during the term of this contract the following insurance:

- a) Worker's Compensation Insurance with statutory limits and Employer's Liability Insurance with a minimum limit of \$1,000,000 each occurrence.
- b) Comprehensive General Liability Insurance with a minimum combined single limit of \$1,000,000 per occurrence, \$1,000,000 aggregate, in the same amount made for bodily injury and property damage. The policy is to include products and completed operations, cross liability, broad form property damage, independent contractors, and contractual liability coverage. The policy shall be endorsed to provide sixty (60) days written notice to the District of any material change of coverage, cancellation, or non-renewal of coverage.
- c) If Subcontractors are likely to be used, the Comprehensive General Liability policy shall include coverage for independent Contractors.

- d) Owner's Contractor's Protective Policy-comprehensive in the name of the Owner, with a minimum combined single limit of \$1,000,000 per occurrence in the same amount for bodily injury or property damage.
- e) Automobile Liability insurance covering all owned, hired, and non-owned vehicles with personal protection insurance and property insurance to comply with the provisions of the Michigan no-fault Insurance Law, including residual liability insurance with a minimum combined single limit of \$1,000,000 each occurrence of bodily injury and property damage.
- f) All insurance policies shall be issued by companies licensed to do business in the State of Michigan. The companies issuing the policies must be domestic (on-shore) companies and have an A rating by AM Best.
- g) The Contractor shall be responsible for payment of all deductibles contained in any insurance policy required in this contract.

#### COMPLIANCE WITH SCHOOL SAFETY INITIATIVE LEGISLATION

Meeting the requirements of the School Safety Initiative Legislation, being MCL 380.1230, 80.1230a, 380.1230c, 380.1230d and 380.1230g.

The Bidder acknowledges and agrees that the Bidder will have any and all of its installation personnel (including sub-contractors) subjected to criminal history and background checks. **Personnel that fall into this group will be working on District premises for more than one continuous week.** Criminal history and background checks will be done within a year of the beginning of the project and should be completed before worked begins on this project.

The Bidder is required to provide written documentation listing all personnel who fall into the group indicated in the above paragraph. The documentation will also verify that none of the personnel have a "listed offense" as indicated below. This documentation is to be provided before the beginning of the project and updated as necessary for any additions or subtractions from the list as long as the project lasts.

The Bidder shall indemnify, defend and hold the District, its employees, Board of Education, and each member thereof, agents and consultants, harmless from and against any and all claims, counter-claims, suits, debts, demands, actions, judgments, liens, liabilities, costs, expenses, including actual attorney's fees and actual expert witness fees, arising out of or in connection with any violation of, or the Bidder's failure to comply with the above paragraphs.

The Bidder shall be responsible for all costs and expenses associated with the above-required criminal history and background checks.

#### LISTED OFFENSES

1. MCL 750.145a - Accosting, enticing or soliciting child (less than 16 years of age) for immoral purposes.
2. MCL 750.145b - Accosting, enticing or soliciting child (less than 16 years of age) immoral purposes – second or subsequent offenses.
3. MCL 750.145c - Involvement in child sexually abusive activity or material, including possession of child sexually abusive material ("child" is a person less than 18 years of age who has not been legally emancipated.)
4. MCL 750.158 - Crime against nature (i.e., sodomy and bestiality) if the victim is an individual less than 18 years of age.
5. A third of subsequent violation of any combination of the following:
  - a. MCL 750.167(1)(f) - indecent or obscene conduct in a public place;
  - b. MCL 750.335a - indecent exposure;

- c. A local ordinance of a municipality substantially corresponding to a section described in (a) or (b), *supra*.
- 6. Except for juvenile disposition or adjudication, a violation of:
  - a. MCL 750.338 - gross indecency between males; fellatio or masturbation;
  - b. MCL 750.338a - gross indecency between females; oral sex;
  - c. MCL 750.338b - gross indecency between male and female persons; if the victim is an individual less than 18 years of age.
- 7. MCL 750.349 - Kidnapping, if victim is an individual less than 18 years of age.
- 8. MCL 750.350 - Kidnapping; child under 14 years of age with intent to detain or conceal from child's parent or legal guardian.
- 9. MCL 750.448 - Soliciting or accosting by a person 16 years of age or older, if victim is an individual less than 18 years of age.
- 10. MCL 750.455 - Pandering
- 11. MCL 750.520b - First degree criminal sexual conduct.
- 12. MCL 750.520c - Second degree criminal sexual conduct.
- 13. MCL 750.520d - Third degree criminal sexual conduct.
- 14. MCL 750.520e - Fourth degree criminal sexual conduct.
- 15. MCL 750.520g - Assault with intent to commit criminal sexual conduct.
- 16. Any other violation of a law of the state or a local ordinance of municipality that by its nature constitutes a sexual offense against an individual who is less than 18 years of age.
- 17. MCL 750.10a - Offense by sexually delinquent person (i.e., "any person whose sexual behavior is characterized by repetitive or compulsive acts which indicate a disregard of consequences or the recognized rights of others, or by the use of force upon another person in attempting sexual relations of either a heterosexual or homosexual nature, or by the commission of sexual aggressions against children under the age of 16").
- 18. An attempt or conspiracy to commit an offense described in (1) through (17).
- 19. An offense substantially similar to an offense described in (1) through (17) under a law of the United States, any state, or any country or any tribal or military law.

#### TERMINATION BY THE DISTRICT FOR CONVENIENCE

The District may, at any time, terminate the Contract for the District's convenience and without cause.

Upon receipt of written notice from the District of such termination for the District's convenience, the Contractor shall:

- a) Cease operations as directed by the District in the notice;
- b) Take actions necessary, or that the District may direct, for the protection and preservation of the Work; and
- c) Except for Work directed to performed prior to the effective date of termination stated in the notice, terminate all existing subcontracts and purchase orders and enter into no further Subcontracts and purchase orders.

#### Owner Is An Equal Opportunity Employer

The Owner is an Equal Opportunity Employer. Pursuant to the Executive Order 11246 as amended, you are advised that under the provisions of this order, Contractors and Subcontractors are obligated to take affirmative action to provide equal opportunity without regard to race, creed, color, national origin, age or sex.

#### Michigan Right to Know Law

Troy School District will comply with the Michigan Right to Know Law by informing Contractors of hazardous chemicals to which they may be exposed. All Contractors will be required to provide Material Safety Data Sheets for any hazardous chemicals brought to the workplace. The Contractor shall comply with all applicable provisions of the Occupational Safety and Health Act for the duration of the specified work.

### Asbestos Hazard Emergency Response Act

As required by the Environmental Protection Agency Asbestos Hazard Emergency Response Act, each school district is responsible for providing contractors with information regarding locations of known or assumed asbestos containing material prior to the Contractor entering a building under the school district's jurisdiction. The successful bidder will be required to complete the school district's Contractor Notification forms.

### Notification of Assumed Lead-Containing Materials

The intent of this section is to formally notify all Contractors and Sub-Contractors applying for or bidding on work covered within this specification that, due to the age of the facilities within this District, there is the presumption that building components do contain lead-based paint pursuant to OSHA definition. The District has not conducted lead-based paint inspections. As a result, all Contractors and Sub-Contractors bidding must assume that building components do contain lead-based paint.

Furthermore, all awarded Contractors and Sub-Contractors shall be responsible to comply with all applicable Federal and Michigan State lead regulations including, but not limited to, 29 CFR Part 1926.62 of the OSHA Lead Construction Standard, (Part 603 of the Michigan State Standards). All costs associated with regulatory compliance shall be borne by the Contractor and/or Sub-Contractor.

### General Conditions

The District reserves the right to accept or reject any or all proposals, to waive irregularities, and to accept a proposal which, in the District's opinion, is in the District's best interest.

The District reserves the right to declare as non-responsive, and reject, any bid which is incomplete or where material information requested is not furnished, or where indirect or incomplete answers or information is provided.

In the event, the Administration Building is closed due to unforeseen circumstances on the day Proposals are due, Proposals will be due at the same time on the next day that the District and/or the Administration Building is open.

Negligence in preparation, improper preparation, errors in, or omissions from, proposal shall not relieve a bidder from fulfillment of any and all obligations and requirements of the proposed Contract Documents.

The District expects that the awarded bidder will complete the work as outlined in the specifications for the amount bid by the bidder. Any additional costs above the amount bid and awarded, must be approved by the District in advance of any work.

Voluntary alternates for bids are acceptable but should NOT be put in the space for the Base Bid on the Bid Response Form but on an attached sheet, clearly labeled Voluntary Alternative. Such Alternates should be described in enough detail for the District to understand the Bidder's intent.

Owner may choose to conduct testing to verify correct products and installation. If the materials and installation are found not to be per spec, owner will require subsequent tests to be performed by Owners testing company at contractors' expense.

Any exceptions to the terms and conditions contained in this RFP or any special considerations or conditions requested or required by the Contractor MUST be specifically enumerated by the Contractor and be submitted as part of its Proposal, together with an explanation as to the reason such terms and conditions of this RFP cannot be met by, or in the Contractor's opinion should not be applicable to, the Contractor. The Contractor shall be required and expected to meet the specifications and the requirements as set forth in this RFP in their entirety, except to the extent exceptions or special considerations or conditions are expressly set forth in the Contractor's Proposal and those exceptions or special considerations or conditions are expressly accepted by the District.

No responsibility shall attach to the District, or the authorized representatives of either one, for the premature opening of any proposal, which is not properly addressed and identified.

The Contract Documents, as outlined in the executed Agreement, shall imply the inclusion of the entire agreement between the parties thereto, and the Contractor shall not claim any modification thereof resulting from any representation or promise made at any time by an officer, agent or employee of the District or by any other person.

Include in your base bid at EACH school a \$2,000 allowance to be used at the owner's discretion.

#### Opening and Awarding of Bids

Bids will be publicly opened and read aloud at the Troy School District Administration Building, 4400 Livernois Road, Troy, MI 48098, no later than 1:00 pm, Thursday, November 29, 2018.

The recommendation for award will be submitted to the Board of Education at the regular Board of Education Meeting to be held on Tuesday, December 18, 2018.



## Scope of Work \ Specifications

### Troy School District – Corridor Locker Replacement Project

#### Scope of Work-

Demolition – For locker banks A through F remove existing lockers and any blocking or hardware. Dispose of legally off site.

#### For **each** school provide the following lockers;

Bank A – Approximate field dimension of concrete base 75' – 3". Provide (2) tier 15" X 15" X 72" high locker with sloped top and combination lock. Provide 58 top and 58 bottom plus 1 locker with fire extinguisher opening on top and locker on bottom at middle of run. Provide finished ends on lockers and sloped top provide fillers as required to ensure entire bank is as wide as existing lockers.

Bank B – Approximate field dimension of concrete base 99' – 4". Provide (2) tier 15" X 15" X 72" high locker with sloped top and combination lock. Provide 78 top and 78 bottom plus 1 locker with fire extinguisher opening on top and locker on bottom at middle of run. Provide finished ends on lockers and sloped top provide fillers as required to ensure entire bank is as wide as existing lockers.

Bank C – Approximate field dimension of concrete base 99' – 3". Provide (2) tier 15" X 15" X 72" high locker with sloped top and combination lock. Provide 78 top and 78 bottom plus 1 locker with fire extinguisher opening on top and locker on bottom at middle of run. Provide finished ends on lockers and sloped top provide fillers as required to ensure entire bank is as wide as existing lockers.

Bank D – Approximate field dimension of concrete base 99' – 3". Provide (2) tier 15" X 15" X 72" high locker with sloped top and combination lock. Provide 78 top and 78 bottom plus 1 locker with fire extinguisher opening on top and locker on bottom at middle of run. Provide finished ends on lockers and sloped top provide fillers as required to ensure entire bank is as wide as existing lockers.

Bank E – Approximate field dimension of concrete base 99' – 3". Provide (2) tier 15" X 15" X 72" high locker with sloped top and combination lock. Provide 78 top and 78 bottom plus 1 locker with fire extinguisher opening on top and locker on bottom at middle of run. Provide finished ends on lockers and sloped top provide fillers as required to ensure entire bank is as wide as existing lockers.

Bank F – Approximate field dimension of concrete base 99' – 3". Provide (2) tier 15" X 15" X 72" high locker with sloped top and combination lock. Provide 78 top and 78 bottom plus 1 locker with fire extinguisher opening on top and locker on bottom at middle of run. Provide finished ends on lockers and sloped top provide fillers as required to ensure entire bank is as wide as existing lockers.

Bank G - Boulan Park **ONLY** – At this location there are no existing lockers therefore there is no concrete base. Provide (2) tier 15" X 15" X 72" high locker with sloped top and combination lock. Provide 40 top and 40 bottom plus 1 locker with fire extinguisher opening on top and locker on bottom at middle of run. Provide finished boxed ends on lockers, wood base and continuous sloped top. Wood base to sit back ½" from face of locker frame. Owner will install rubber base on wood base provided.

**General Notes:**

1. Contractor to field verify existing dimensions and conditions.
2. Contractor to provide shop drawings.
3. Contractor to work with owner for final locker numbering.
4. Contractor to work with owner to provide locker combinations for each locker and a schedule for future combinations. Lockers must have minimum of 5 pre-set combinations.
5. Provide matching boxed end panels – 12 locations at Larson and 14 locations at Boulan Park.
6. Provide matching 20 ga continuous sloping top and end at all banks.
7. Provide metal closure piece at the top similar to the existing condition at all banks.
8. All dimensions are approximate contractor to field verify.
9. Contractor to field verify any limitations or obstructions at the walls.
10. Lockers to have standard combination lock except for 12 lockers at each school. Those 12 to have the ADA appropriate digital lock (see specifications).

Schedule – It is anticipated this work will be done second shift over the spring (second shift) or weekends (straight shift) and/or over spring break (straight shift). We expect the installation at each school will not take more than 2 weeks if done second shift, or three weekends if done on weekends or both schools during spring break. Each school has some storage on the existing pool deck that can be used for storage during this process. If working second shift, project requires what you remove in a day you are able to install that same number of new fully functioning lockers that same day. If project is completed over a weekend you remove in a weekend you are able to install that same number of new fully functioning lockers that same weekend. If project is completed over spring break all lockers must be complete and fully functioning by end of week.

END OF SCOPE

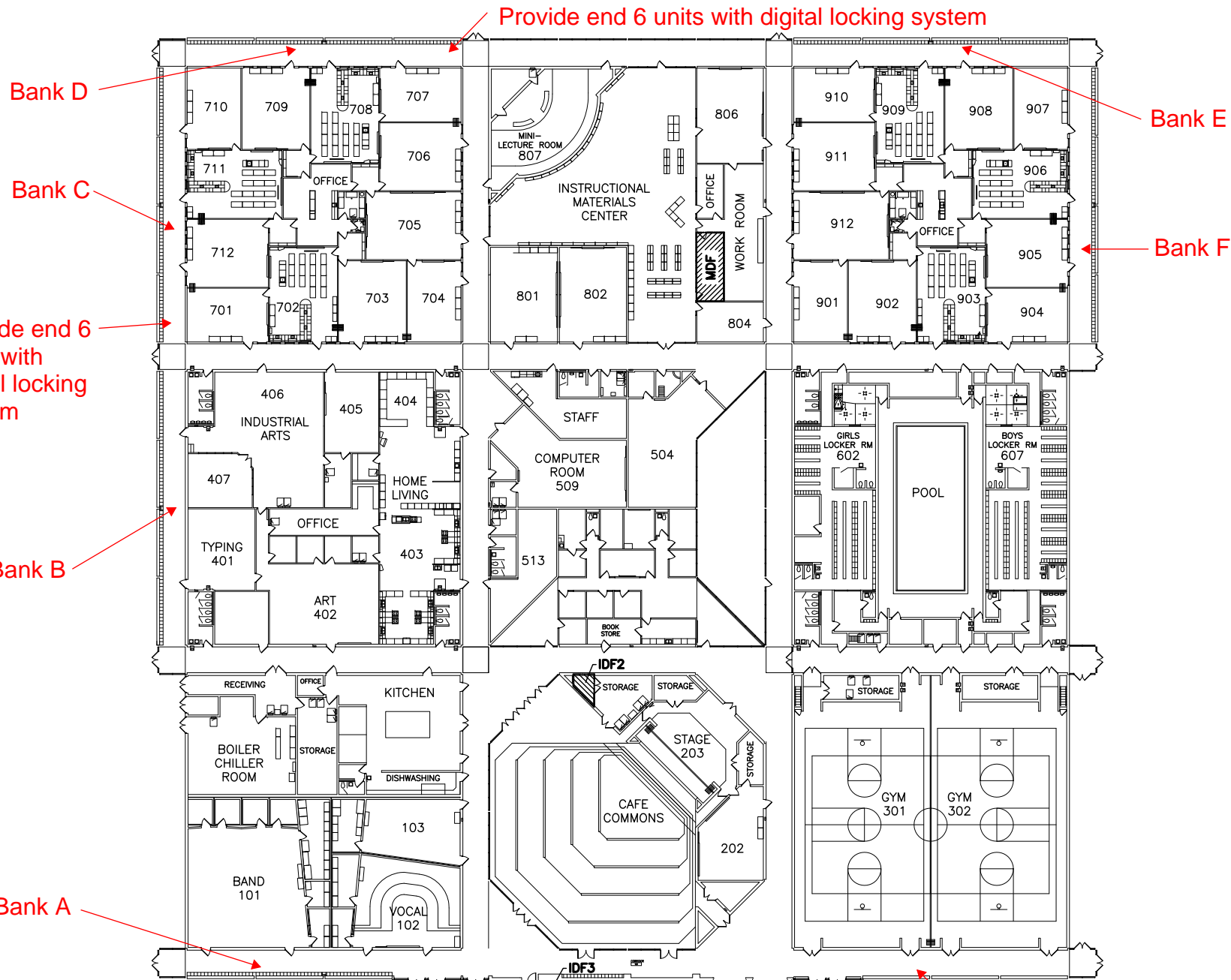

**Boulan Middle School  
Floor Plan -  
Not to scale**

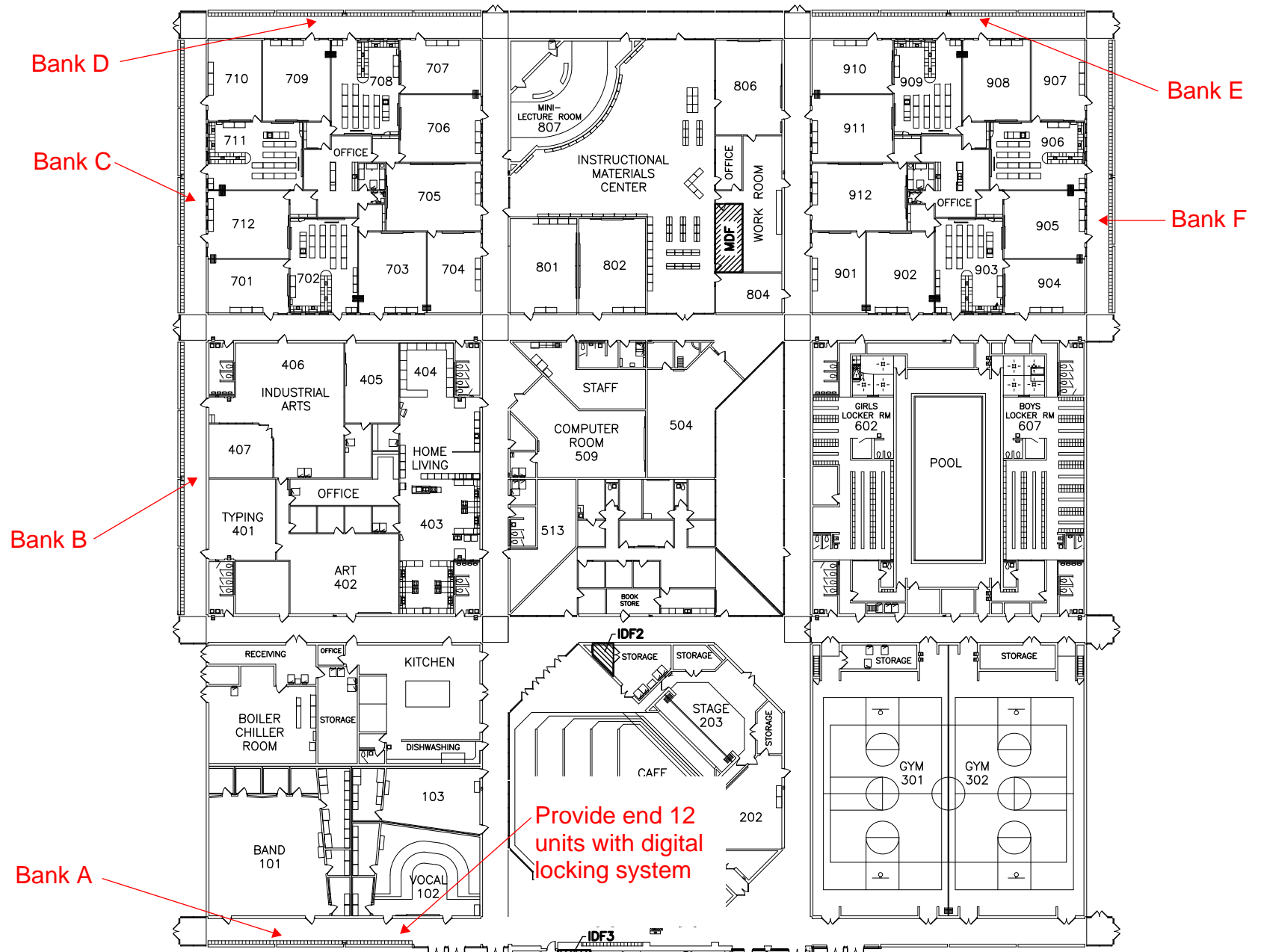

**Larson Middle School**  
**Floor Plan -**  
 Not to scale

# Specifications

## "STANDARD" LOCKER SPECIFICATIONS

### SECTION 10500 - METAL LOCKERS

#### PART 1- GENERAL

##### 1.1 RELATED DOCUMENTS:

##### 1.2 SCOPE:

Furnish and install new steel lockers for Boulan Park and Larson Middle Schools. Include all accessories and finish metal trim as shown on drawings or in written specification.

##### 1.2.1 SUBMITTALS:

Shop Drawings: Within 2 weeks of award, submit drawings showing locker types, sizes and quantities, including all necessary details relating to anchoring, trim installation, numbering and relationship to adjacent surfaces.

Numbering: The locker numbering sequence approval shall be provided by Troy School District and noted on the approved drawings returned to the locker contractor. Lockers to be numbered 1 to 902 and 1 to 983 clockwise starting at band room 101.

Color Charts: Provide samples of paint on metal at time of shop drawings.

Lock Combination Listings and Master Keys: Provide this schedule to the owner one month before locker installation begins.

##### 1.3 QUALITY ASSURANCE:

1.3.1 UNIFORMITY: Provide each type of metal locker as produced by a single manufacturer, including necessary accessories, fittings and fasteners.

1.3.2 JOB CONDITIONS: Protect from damage during delivery, handling, storage and installation.

#### PART 2- PRODUCTS

##### 2.1 MANUFACTURER:

1. Republic Metal
2. Lyon Metal
3. Penco

##### 2.2 LOCKERS:

##### **Larson -**

Style: Two tier lockers

Type: Corridor lockers

Size: Two units is 15" X 15" X 72"h. (each unit is 15" X 15" X 36'h.)

Color: Selected from manufactures standard colors

No. of Locker Frames: 454 (6 of which are fire extinguisher/locker combo)

No. of Locker Openings: 902 lockers + 6 fire extinguisher units

### **Boulan Park -**

Style: Two tier lockers

Type: Corridor lockers

Size: Two units is 15" X 15" X 72"h. (each unit is 15" X 15" X 36'h.)

Color: Selected from manufactures standard colors

No. of Locker Frames: 494 (7 of which are fire extinguisher/locker combo)

No. of Locker Openings: 983 lockers + 7 fire extinguisher units

## **2.3 FABRICATION - GENERAL:**

**2.3.1 MATERIAL:** All major steel parts shall be made of mild cold rolled steel, free from imperfections and capable of taking a high grade enamel or powder coat finish.

**ADD ALTERNATE 1:** For bottom and intermediate panels ONLY, Specified locker components shall be manufactured from Galvannealed steel and finished by manufacturer's standard process

**2.3.2 FINISH:** Surfaces of the steel shall be thoroughly cleaned, phosphatized and prepared for powder coat finish in accordance with paint manufacturer's instructions.

**2.3.3 CONSTRUCTION:** Lockers shall be built on the unit principle - each locker shall have an individual door and frame, an individual top, bottom, back and shelves with common intermediate uprights separating units. Base is an existing concrete/tile base.

**2.3.4 DOOR FRAMES:** Door frames shall be 16 gauge formed into 1" wide face channel shapes with a continuous vertical door strike, integral with the frame on both sides of the door opening. Cross frame members shall be 16 gauge channel shaped securely welded to vertical framing members to ensure a square and rigid assembly. Intermediate cross frame members are not required on box lockers.

**2.3.5 DOORS:** Shall be 16 gauge steel for short or narrow doors as required by manufacturer's design, formed with a full channel shape on the lock side to fully conceal the lock bar, channel formation on the hinge side and right angle formation across the top and bottom. Locker doors shall be ventilated by louvers on the face of each door, top and bottom.

**2.3.6 PRE- LOCKING DEVICE:** All lockers to include combination lock. Locks to have the ability to be changed to 5 preset combinations per the numbering/combination schedule. Base bid provide Master Lock locks. For 12 ADA lockers at each school use electronic key pad option.

**ADD ALTERNATE 2:** Provide alternate price for similar systems from Zephyr.

**2.3.7 LATCHING:** Latching shall be a one-piece, pre-lubricated spring steel latch, completely contained within the lock bar under tension to provide rattle-free operation. The lock bar shall be of pre-coated, double-channel steel construction. The lock bar shall be securely contained in the door channel by self-lubricating polyethylene guides that isolate the lock bar from metal-to-metal contact with the door. The lock bar travel is limited by contacting resilient high-quality elastomeric cushioning devices concealed inside the lock bar. Frame hooks to accept latching shall be of heavy gauge steel, set close in and welded to the door frame. Continuous vertical door strike shall protect frame hooks from door slam damage. A soft rubber silencer shall be securely installed on each frame hook to absorb the impact caused by closing of the door.

2.3.8 HANDLES: A non-protruding 14 gauge lifting trigger and slide plate shall transfer the lifting force for actuating the lock bar when opening the door. The exposed portion of the lifting trigger shall be encased in a molded ABS thermoplastic cover that provides isolation from metal-to-metal contact and be contained in a formed 20 gauge stainless steel recessed pocket. This stainless steel pocket shall contain a recessed area for the various lock types available and a mounting area for the number plate.

2.3.9 HINGES: Hinges shall be 2" high, 5-knuckle, full loop, tight pin style, securely welded to frame and double riveted to the inside of the door flange. Locker doors 42" high and less shall have two hinges.

2.3.10 BODY: The body of the locker consists of 24 gauge upright sheets, backs and top. Intermediate and bottom shelves to be **16 gauge**. Tops and bottoms are flanged on all four sides; backs are flanged on two sides. Uprights shall be offset at the front and flanged at the rear to provide a double lapped rear corner. All bolts and nuts shall be zinc plated.

2.3.11 INTERIOR EQUIPMENT: All lockers shall have two single prong wall hooks in each compartment. All hooks shall be made of steel, formed with ball points, zinc-plated and attached with two bolts or rivets.

2.3.12 NUMBER PLATES: Each locker shall have a polished aluminum number plate with black numerals not less than 1/2" high. Plates shall be attached with rivets to the lower surface within the recessed handle pocket or on the locker face.

2.3.13 COLOR: Doors and exposed body parts shall be finished in colors selected from Manufacturers standard colors. Finish shall be powder coated. Non-exposed body parts can be finished in neutral color (baked enamel).

2.3.14 ASSEMBLY: Assembly of all locker components shall be accomplished by the use of zinc plated, low round head, slotless, fin neck machine screws with hex nuts, producing a strong mechanical connection.

## PART 3 - EXECUTION

3.1 INSTALLATION: Lockers must be installed in accordance with manufacturer's approved drawings and assembly instructions. Installation shall be level and plumb with flush surfaces and rigid attachment to anchoring surfaces. Space fasteners at 36" O.C. or less, as recommended by manufacturer. Use fasteners appropriate to load and anchoring substratum. Use reinforcing plates wherever fasteners could distort metal. Various trim accessories where shown, such as sloping tops, fillers, bases, recessed trim, etc., shall be installed using concealed fasteners. Flush, hairline joints are provided at all abutting trim parts and at adjoining surfaces. For user safety, all lockers must be secured to the wall and/or floor prior to use.

3.2 ADJUSTMENT: Upon completion of installation, inspect lockers and adjust as necessary for proper door and locking mechanism operation.

## END OF SPECIFICATIONS

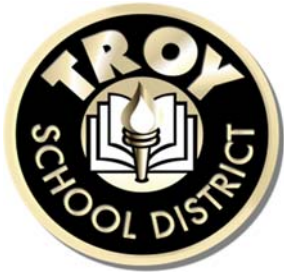

**DUE:** 1:00 pm., Thursday, November 29, 2018  
**PROPOSAL:** BID 9869 Corridor Locker Replacement

### PROPOSAL FORM

We propose to furnish all material, labor and equipment, to complete BID 9869 Corridor Locker Replacement at Boulan Park Middle and Larson Middle School, per the specifications, for the Troy School District. Include in base bid all bond costs and allowances.

Total Cost Boulan Park Middle School \$ \_\_\_\_\_

Total Cost Larson Middle School \$ \_\_\_\_\_

**TOTAL both schools** \$ \_\_\_\_\_

**Alternate 1** – Base bid includes standard finish on bottom and intermediate panels. For this alternate use galvanized metal.

Add/Deduct to base bid (both schools) \$ \_\_\_\_\_

**Alternate 2** – Base bid includes Master Lock brand combination locks. Provide cost to change to Zephyr lock system.

Add/Deduct to base bid (both schools) \$ \_\_\_\_\_

BIDDER'S FIRM NAME \_\_\_\_\_

ADDRESS \_\_\_\_\_

CITY/STATE \_\_\_\_\_ ZIP \_\_\_\_\_

CELL NUMBER \_\_\_\_\_ FAX # \_\_\_\_\_

SIGNED BY \_\_\_\_\_ TITLE \_\_\_\_\_

TYPED NAME \_\_\_\_\_ DATE \_\_\_\_\_

E-MAIL ADDRESS \_\_\_\_\_



**VENDOR: LIST FIVE RECENT REFERENCES, PREFERABLY SCHOOL DISTRICTS:**

School District	Person to Contact	Phone Number
School District	Person to Contact	Phone Number
School District	Person to Contact	Phone Number
School District	Person to Contact	Phone Number
School District	Person to Contact	Phone Number

**Interested vendors will note in this space only any additional information, criteria or contingencies affecting their proposal, understanding that this additional information, criteria or contingency may be utilized in the evaluation process and subsequent award.**

This image shows a single sheet of white paper with horizontal ruling lines. The lines are evenly spaced and run across the width of the page. There are no margins, text, or other markings on the paper.

**SWORN AND NOTARIZED FAMILIAL DISCLOSURE STATEMENT  
FAMILIAR DISCLOSURE AFFIDAVIT**

The undersigned, the owner or authorized office of the below-named contractor (the ‘Contractor’), pursuant to the familial disclosure requirement provided to Troy Schools, hereby represents and warrants that, excepts as provided below, no familial relationship exists between the owner or key employee of the Contractor, and any member of the Troy School Board or the Troy School Superintendent. A list of the School District’s Board of Education Members and its Superintendent may be found at <http://www.troy.k12.mi.us>.

List any Familial Relationships:

**Contractor:**

\_\_\_\_\_  
Print Name of Contractor

By: \_\_\_\_\_

Its: \_\_\_\_\_

Subscribed and sworn before me, this \_\_\_\_\_ Seal:

day of \_\_\_\_\_, 20 \_\_\_\_\_, a Notary Public

in and for \_\_\_\_\_ County, \_\_\_\_\_

\_\_\_\_\_  
(Signature)  
NOTARY PUBLIC

My Commission expires \_\_\_\_\_

#

#

## **CERTIFICATION OF COMPLIANCE – IRAN ECONOMIC SANCTIONS ACT**

Michigan Public Act No. 517 of 2012

The undersigned, the owner, or authorized officer of the below-named Company, pursuant to the compliance certification requirement provided in Troy School District's Request For Proposal, the "RFP", hereby certifies, represents, and warrants that the Company and its officers, directors and employees, is not an "Iran Linked Business" within the meaning of the Iran Economic Sanctions Act, Michigan Public Act No. 517 of 2012 (the "Act"), and that in the event the Company is awarded a contract by Troy School District as a result of the aforementioned RFP, the Company is not and will not become an "Iran Linked Business" at any time during the course of performing any services under the contract.

The Company further acknowledges that any person who is found to have submitted a false certification is responsible for a civil penalty of not more than \$250,000.00 or two (2) times the amount of the contract or proposed contract for which the false certification was made, whichever is greater, the cost of Troy School District's investigation, and reasonable attorney fees, in addition to the fine. Moreover, any person who submitted a false certification shall be ineligible to bid on a request for proposal for three (3) years from the date the it is determined that the person has submitted the false certification.

---

NAME OF COMPANY

---

NAME AND TITLE OF AUTHORIZED REPRESENTATIVE

---

SIGNATURE

---

DATE

Acceptance of Proposal

The undersigned agrees to execute a Contract for work covered by this Proposal provided that he is notified of its acceptance within thirty days after the opening of the Proposal.

It is agreed that this bid will not be withdrawn until after forty-five (45) days after receipt of bids.

The undersigned affirms that the bid was developed without any collusion, undertaking, or agreement, either directly or indirectly, with any other bidder(s) to maintain the prices of indicated work or prevent any other bidder(s) from bidding the work.

BIDDER’S FIRM NAME	_____
BUSINESS ADDRESS	_____ _____ _____
TELEPHONE NUMBER	_____
CELL NUMBER	_____
FAX NUMBER	_____
BY (SIGNATURE)	_____
PRINTED NAME	_____
TITLE	_____
SIGNED THIS	_____ DAY OF _____, 20 _____
E-MAIL ADDRESS	_____

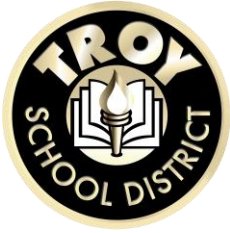

## **Addendum 1**

Project: **BID NO. 9869 CORRIDOR LOCKER REPLACEMENT BOULAN PARK AND LARSON MIDDLE SCHOOLS FOR TROY SCHOOL DISTRICT**

Bid Due date: 1:00PM Thursday, November 29, 2018 (UNCHANGED)

---

This Addendum is issued as modifications to the RFP previously issued to provide clarifications to the scope of work. This Addendum supersedes the original RFP. This along with the RFP becomes the bid documents.

1. Troy School District will entertain other locker manufactures as long as all areas of the specification are met.
2. Clarification on the fire extinguisher cabinet; The current unit is one frame with one door and a divider shelf at the midpoint. The new unit will be one frame with two doors. The door on bottom will be to a traditional locker and the door on top will have an opening similar to the existing unit (see picture A) with a latch but no lock.
3. See picture B of metal closure piece called for at the back of the sloped metal top.
4. All end panels to be boxed end panels.
5. Low bidder to be available for a post bid phone conference Monday, December 4<sup>th</sup>.

END



Existing lockers – Picture A



Existing closure piece at sloped top – Picture B

**Bid Tabulation**  
**BID 9869 Corridor Locker Replacement**  
**Boulan Park and Larson**  
**Middle Schools**

Vendors		Amounts	
	Boulan Park	Larson	
Brainard Enterprise, Inc.	\$95,700.00	\$87,290.00	\$182,990.00
<i>Alternate 1 - Use Galvannealed Metal</i>	<i>Add \$3,800</i>	<i>Add \$3,800</i>	
<i>Alternate 2 - Use Zephyr Lock System</i>	<i>Deduct \$1,200</i>	<i>Deduct \$1,200</i>	
Lyon LLC	\$86,250.00	\$86,250.00	\$172,500.00
<i>Alternate 1 - Use Galvannealed Metal</i>	<i>Add \$795</i>	<i>Add \$795</i>	
<i>Alternate 2 - Use Zephyr Lock System</i>	<i>Deduct \$2,750</i>	<i>Deduct \$2,750</i>	
Rayhaven Group	\$93,405.00	\$82,920.00	\$176,325.00
<i>Alternate 1 - Use Galvannealed Metal</i>	<i>Add \$3,875</i>	<i>Add \$3,875</i>	
<i>Alternate 2 - Use Zephyr Lock System</i>	<i>Deduct \$7,710</i>	<i>Deduct \$7,710</i>	
Steel Equipment Company	\$80,040.00	\$74,825.00	\$154,865.00
<i>Alternate 1 - Use Galvannealed Metal</i>	<i>Add \$1,400</i>	<i>Add \$1,400</i>	
<i>Alternate 2 - Use Zephyr Lock System</i>	<i>Deduct \$1,400</i>	<i>Deduct \$1,400</i>	