



**INVITATION TO BID
BID NO. 9871
2019 FLOORING REPLACEMENT PROGRAM
FOR TROY SCHOOL DISTRICT**

The Troy School District will receive firm, sealed bids for all labor, material, equipment and all other services to complete Bid No. 9871 Flooring Replacement at Boulan Park, Smith and Larson Middle Schools, as well as, Schroeder, Troy Union and Wattles Elementary Schools, for Troy Schools.

Specifications and proposal forms can be obtained online at <http://www.troy.k12.mi.us>. From the main page click the "Business Services" tab listed under "Departments", then click "Purchasing" and scroll down to locate and access the bid document.

Your proposal and two copies marked "**Bid No. 9871 Flooring Replacement Program**" must be delivered no later than 1:00 p.m., Tuesday, December 18, 2018, Troy School District Maintenance/Operations and Purchasing Offices, 1140 Rankin, Troy, MI 48083, at which time all bids will be publicly opened and read aloud immediately thereafter. Bid proposals received after this time will not be considered or accepted.

A pre-bid walk through has been scheduled for 3:30 p.m., Tuesday, December 11, 2018, at Smith Middle School 5835 Donaldson Drive, Troy MI 48085. All questions regarding the services specified, the bid specified, or the bid terms and conditions will be accepted in writing ONLY and subsequently answered through an addendum to all interested parties. Questions must be received no later than noon, Thursday, December 13, 2018; at no other time prior to the bid opening will questions/concerns be addressed or accepted and may be faxed to: 248.823.4077, or emailed as a Word document to: PurchasingOffice@troy.k12.mi.us.

All bidders must provide familial disclosure in compliance with MCL 380.1267 and attach this information to the bid proposal. The bid proposal will be accompanied by a sworn and notarized statement disclosing any familial relationship that exists between the owner or any employee of the bidder and any member of the Troy School Board or the Troy School Districts Superintendent. Also, a sworn and notarized Affidavit of compliance for the Iran Economic Sanctions Act certifying the vendor does and will comply with Public Act 517 of 2012 shall accompany all proposals. Both forms will be enclosed in the specification's booklet that shall be used for this purpose. The District will not accept a bid proposal that does not include these sworn and notarized disclosure statement.

In accordance with Michigan Compiled Laws Section 129.201, successful bidders whose proposals are \$50,000 or more, for any bid category, will be required to furnish a U.S. Treasury Listed Company Performance and Payment Bond in the amount of 100% of their bid. The cost of the Bond shall be identified within each proposal.

The Troy Board of Education reserves the right to accept or reject any or all bids, either in whole or in part; to award contract to other than the low bidder; to waive any irregularities and/or informalities; and in general to make awards in any manner deemed to be in the best interest of the owner.

Purchasing Department
Troy School District
1140 Rankin
Troy, MI 48083

INSTRUCTIONS TO BIDDERS

PROPOSAL/INTENT

1. The Troy School District will receive firm, sealed bids for all labor, material, equipment and all other services to complete Bid No. 9871 Flooring Replacement at Boulan Park, Smith and Larson Middle Schools, as well as, Schroeder, Troy Union and Wattles Elementary Schools.
2. Proposals for two different bid divisions will be submitted on the forms provided, will be enclosed in a sealed envelope marked with the name of the bidder, the title of the work and must be delivered to Troy School District Maintenance/Operations and Purchasing Offices, 1140 Rankin, Troy, MI 48083, no later than 1:00 pm, Tuesday, December 18, 2018, at which time all bids will be publicly opened and read aloud immediately thereafter. Bid proposals received after this time will not be considered or accepted. Oral, telephone, fax or electronic mail bids are invalid and will not receive consideration. Submit one original and one copy. Indicate on the envelope the bid division you are bidding on.
3. Proposals will be made in conformity with all the conditions set forth in the specifications. All products must conform to the specifications.
4. A pre-bid walk through has been scheduled at 3:30 p.m., December 11, 2018, at Smith Middle School 5835 Donaldson Drive, Troy MI 48085. Questions must be received no later than noon, Thursday, December 13, 2018.
5. Bidder shall be reputable and a recognized organization, with at least five (5) years successful experience on work of this type and scope, of equal or better quality than this project.
6. References in the specifications to any article, product, material, fixture, form or type of construction, etc., by proprietary name, manufacturer, make or catalog number will be interpreted as establishing a standard quality of design and will not be construed as limiting proposals.
7. Bid bond or certified check, for an amount not less than five (5%) percent of the amount of the bid, must accompany each bid. Failure to submit proper bid security shall constitute rejection of bid.
8. A performance bond shall be required for the project if the cost is in excess of \$50,000 and must be listed separately on the proposal form as an individual line item.
9. A completed Familial Disclosure and an Iran Economic Sanctions form must be included with each proposal submitted or the proposal will not be accepted, please note these forms must be notarized.
10. The Troy Board of Education reserves the right to accept or reject any or all proposals either in whole or in part; to waive any irregularities and/or informalities; and in general to make awards or cancel this proposal, if deemed to be in the best interests of the owner.

SCOPE

The two bids include flooring removal and installation per the attached documents. Proposals will be on a lump sum basis, according to the finish schedule included and where specified only the qualified products listed will be considered in this proposal.

WARRANTY

All material and equipment will be guaranteed to be free from defects in both workmanship and materials for no less than two years from date of receipt/installation. If manufacturer warranty exceeds this minimum requirement, the manufacturer warranty will prevail. Any item(s) found to be defective will be replaced or repaired within seven working days at Vendor(s) expense.

WITHDRAWAL OF BIDS

Any bidder may withdraw their bid at any time prior to the scheduled time for receipt of bids. No proposal may be withdrawn until after 45 days after bid opening.

FIRM PRICING

Unit pricing will prevail when computing total quantity on bids. No price allowance or extra consideration on behalf of the bidder will subsequently be allowed by reason of error or oversight on the part of the bidder. The successful bidder(s) will hold bid prices firm for all purchase orders placed for a period of approximately one full year.

PERMITS, FEES AND REGULATIONS

The Contractor shall obtain and pay for all permits, assessments, fees, bonds, and other charges as necessary to perform and complete the work of this contract, including disconnection charges, capping and unplugging utilities.

The Contractor shall be responsible for obtaining all permits and licenses necessary for the proper completion of project. Permits and licenses are available from the appropriate agencies having jurisdiction. The Contractor shall give all notices, pay all fees and comply with all laws, ordinances, rules and regulations bearing on the work. At the completion of the project, the Contractor will provide to the District all paperwork related to the full execution of the permits(s), including all payments and inspections.

If any of the work of the Contractor is done contrary to such laws, ordinance rules and regulations without such notice, he shall bear all costs arising therefrom. The Contractor shall include all cost and taxes in its bid, and make proper provisions for payment of all other State and Federal applicable taxes, fees or other costs.

TAXES

Troy School District is not automatically exempt from State of Michigan Sales and Use Taxes. The District must pay these taxes when materials are to be incorporated into reality. Materials that are permanently attached i.e lockers/flooring, built-in/attached, incorporated or otherwise made part of the structure all applicable taxes shall be paid by the Vendor. Troy School District shall not be responsible for any taxes that are imposed on the Vendor. Furthermore, the Vendor understands that it cannot claim exemption from taxes by virtue of any exemption that is provided to Troy School District.

DELIVERY/INSTALLATION

Time of delivery is part of the consideration. It is understood that the bidder agrees to deliver prepaid to the schools, specified from the resulting contract, all items. All cost of delivery, drayage, freight, packing, unpacking, and setup are to be included in the prices bid.

The Contractor is responsible for removing from the project all waste materials and rubbish resulting from his operations and installation including all packing cartons and debris. Removal is to occur on a daily basis. Failure to do so will result in the Owner doing so and the cost thereof shall be charged to the Contractor as a deduction in his contract price.

The Contractor shall provide an adequate number of qualified, experienced installers, in harmony with other works at the site.

BID BOND

Bid Bond or certified check, for an amount not less than five (5%) percent of the amount of the bid, must accompany each bid. The check or bond of each unsuccessful bidder will be returned within ten (10) days after the bid is awarded. Failure of any accepted bidder to enter into a contract to complete the specified work may forfeiture of his bid security. Failure to submit proper bid security shall constitute rejection of bid.

PERFORMANCE BOND/PAYMENT BOND

Within fourteen (14) days after date of issuance of written notice of selection for the award of a contract, which shall be considered as the notice to proceed, the successful bidder shall enter into a contract with the Owner and shall execute and file with the Owner, the following in the amount 100% equal to full contract sum.

A performance bond shall be required for the project if the cost is in excess of \$50,000 and must be listed separately on the proposal form as an individual line item. The Performance Bond must insure the faithful performance of all provisions of the contract and satisfactory completion of the specified work, within the time agreed upon.

The payment bond must insure the payment and protection of claimants supplying labor or materials to the principal contractor or his subcontractors in the prosecution of the work provided for in the contract. The successful contractor's bond company must be listed by the State of Michigan as a licensed carrier and have an excellent or superior rating from AM Best Company.

SAFETY

Under the "General Conditions of the Contract for Construction" of the contract to be awarded, the Contractor;

- a) shall be solely responsible for and have control over construction means, methods, techniques, sequences and procedures;
- b) shall be responsible for initiating, maintaining, and supervising all safety precautions and programs in connection with the performance of the contract;
- c) shall take reasonable precautions for safety of all persons who may be affected, including employees of the Contractor and Subcontractor; and
- d) shall have an accident prevention representative at the site.

The general conditions of the contract for construction and the agreement also require that the Contractor indemnify the Owner in the event of certain claims arising out of the performance of the work.

INSURANCE REQUIREMENTS

The Contractor shall protect, defend and indemnify the Owner, its officers, agents, servants, volunteers, and employees from any and all liabilities, claims, liens, demands, and costs of whatsoever kind and nature which may result in injury or death to any persons, and for any result in injury or death to any person, and for loss or damage to any property, including property owned or in the care, custody, or control of the Owner in connection with or in any way incident to or arising out of the occupancy, use, with this Agreement resulting in whole or in part from negligent acts or omissions of the Contractor, any Subcontractor, or any employee, agent or representative of the Contractor or any Subcontractor.

The Contractor shall maintain, at its expense, during the term of this contract the following insurance:

- a) Worker's Compensation Insurance with statutory limits and Employer's Liability Insurance with a minimum limit of \$1,000,000 each occurrence.
- b) Comprehensive General Liability Insurance with a minimum combined single limit of \$1,000,000 per occurrence, \$1,000,000 aggregate, in the same amount made for bodily injury and property damage. The policy is to include products and completed operations, cross liability, broad form property damage, independent contractors, and contractual liability coverage. The policy shall be endorsed to provide sixty (60) days written notice to the District of any material change of coverage, cancellation, or non-renewal of coverage.
- c) If Subcontractors are likely to be used, the Comprehensive General Liability policy shall include coverage for independent Contractors.

- d) Owner's Contractor's Protective Policy-comprehensive in the name of the Owner, with a minimum combined single limit of \$1,000,000 per occurrence in the same amount for bodily injury or property damage.
- e) Automobile Liability insurance covering all owned, hired, and non-owned vehicles with personal protection insurance and property insurance to comply with the provisions of the Michigan no-fault Insurance Law, including residual liability insurance with a minimum combined single limit of \$1,000,000 each occurrence of bodily injury and property damage.
- f) All insurance policies shall be issued by companies licensed to do business in the State of Michigan. The companies issuing the policies must be domestic (on-shore) companies and have an A rating by AM Best.
- g) The Contractor shall be responsible for payment of all deductibles contained in any insurance policy required in this contract.

COMPLIANCE WITH SCHOOL SAFETY INITIATIVE LEGISLATION

Meeting the requirements of the School Safety Initiative Legislation, being MCL 380.1230, 80.1230a, 380.1230c, 380.1230d and 380.1230g.

The Bidder acknowledges and agrees that the Bidder will have any and all of its installation personnel (including sub-contractors) subjected to criminal history and background checks. **Personnel that fall into this group will be working on District premises for more than one continuous week.** Criminal history and background checks will be done within a year of the beginning of the project and should be completed before worked begins on this project.

The Bidder is required to provide written documentation listing all personnel who fall into the group indicated in the above paragraph. The documentation will also verify that none of the personnel have a "listed offense" as indicated below. This documentation is to be provided before the beginning of the project and updated as necessary for any additions or subtractions from the list as long as the project lasts.

The Bidder shall indemnify, defend and hold the District, its employees, Board of Education, and each member thereof, agents and consultants, harmless from and against any and all claims, counter-claims, suits, debts, demands, actions, judgments, liens, liabilities, costs, expenses, including actual attorney's fees and actual expert witness fees, arising out of or in connection with any violation of, or the Bidder's failure to comply with the above paragraphs.

The Bidder shall be responsible for all costs and expenses associated with the above-required criminal history and background checks.

LISTED OFFENSES

1. MCL 750.145a - Accosting, enticing or soliciting child (less than 16 years of age) for immoral purposes.
2. MCL 750.145b - Accosting, enticing or soliciting child (less than 16 years of age) immoral purposes – second or subsequent offenses.
3. MCL 750.145c - Involvement in child sexually abusive activity or material, including possession of child sexually abusive material ("child" is a person less than 18 years of age who has not been legally emancipated.)
4. MCL 750.158 - Crime against nature (i.e., sodomy and bestiality) if the victim is an individual less than 18 years of age.
5. A third of subsequent violation of any combination of the following:
 - a. MCL 750.167(1)(f) - indecent or obscene conduct in a public place;
 - b. MCL 750.335a - indecent exposure;

- c. A local ordinance of a municipality substantially corresponding to a section described in (a) or (b), *supra*.
- 6. Except for juvenile disposition or adjudication, a violation of:
 - a. MCL 750.338 - gross indecency between males; fellatio or masturbation;
 - b. MCL 750.338a - gross indecency between females; oral sex;
 - c. MCL 750.338b - gross indecency between male and female persons; if the victim is an individual less than 18 years of age.
- 7. MCL 750.349 - Kidnapping, if victim is an individual less than 18 years of age.
- 8. MCL 750.350 - Kidnapping; child under 14 years of age with intent to detain or conceal from child's parent or legal guardian.
- 9. MCL 750.448 - Soliciting or accosting by a person 16 years of age or older, if victim is an individual less than 18 years of age.
- 10. MCL 750.455 - Pandering
- 11. MCL 750.520b - First degree criminal sexual conduct.
- 12. MCL 750.520c - Second degree criminal sexual conduct.
- 13. MCL 750.520d - Third degree criminal sexual conduct.
- 14. MCL 750.520e - Fourth degree criminal sexual conduct.
- 15. MCL 750.520g - Assault with intent to commit criminal sexual conduct.
- 16. Any other violation of a law of the state or a local ordinance of municipality that by its nature constitutes a sexual offense against an individual who is less than 18 years of age.
- 17. MCL 750.10a - Offense by sexually delinquent person (i.e., "any person whose sexual behavior is characterized by repetitive or compulsive acts which indicate a disregard of consequences or the recognized rights of others, or by the use of force upon another person in attempting sexual relations of either a heterosexual or homosexual nature, or by the commission of sexual aggressions against children under the age of 16").
- 18. An attempt or conspiracy to commit an offense described in (1) through (17).
- 19. An offense substantially similar to an offense described in (1) through (17) under a law of the United States, any state, or any country or any tribal or military law.

TERMINATION BY THE DISTRICT FOR CONVENIENCE

The District may, at any time, terminate the Contract for the District's convenience and without cause.

Upon receipt of written notice from the District of such termination for the District's convenience, the Contractor shall:

- a) Cease operations as directed by the District in the notice;
- b) Take actions necessary, or that the District may direct, for the protection and preservation of the Work; and
- c) Except for Work directed to performed prior to the effective date of termination stated in the notice, terminate all existing subcontracts and purchase orders and enter into no further Subcontracts and purchase orders.

Owner Is An Equal Opportunity Employer

The Owner is an Equal Opportunity Employer. Pursuant to the Executive Order 11246 as amended, you are advised that under the provisions of this order, Contractors and Subcontractors are obligated to take affirmative action to provide equal opportunity without regard to race, creed, color, national origin, age or sex.

Michigan Right to Know Law

Troy School District will comply with the Michigan Right to Know Law by informing Contractors of hazardous chemicals to which they may be exposed. All Contractors will be required to provide Material Safety Data Sheets for any hazardous chemicals brought to the workplace. The Contractor shall comply with all applicable provisions of the Occupational Safety and Health Act for the duration of the specified work.

Asbestos Hazard Emergency Response Act

As required by the Environmental Protection Agency Asbestos Hazard Emergency Response Act, each school district is responsible for providing contractors with information regarding locations of known or assumed asbestos containing material prior to the Contractor entering a building under the school district's jurisdiction. The successful bidder will be required to complete the school district's Contractor Notification forms.

Notification of Assumed Lead-Containing Materials

The intent of this section is to formally notify all Contractors and Sub-Contractors applying for or bidding on work covered within this specification that, due to the age of the facilities within this District, there is the presumption that building components do contain lead-based paint pursuant to OSHA definition. The District has not conducted lead-based paint inspections. As a result, all Contractors and Sub-Contractors bidding must assume that building components do contain lead-based paint.

Furthermore, all awarded Contractors and Sub-Contractors shall be responsible to comply with all applicable Federal and Michigan State lead regulations including, but not limited to, 29 CFR Part 1926.62 of the OSHA Lead Construction Standard, (Part 603 of the Michigan State Standards). All costs associated with regulatory compliance shall be borne by the Contractor and/or Sub-Contractor.

General Conditions

The District reserves the right to accept or reject any or all proposals, to waive irregularities, and to accept a proposal which, in the District's opinion, is in the District's best interest.

The District reserves the right to declare as non-responsive, and reject, any bid which is incomplete or where material information requested is not furnished, or where indirect or incomplete answers or information is provided.

In the event, the Administration Building is closed due to unforeseen circumstances on the day Proposals are due, Proposals will be due at the same time on the next day that the District and/or the Administration Building is open.

Negligence in preparation, improper preparation, errors in, or omissions from, proposal shall not relieve a bidder from fulfillment of any and all obligations and requirements of the proposed Contract Documents.

The District expects that the awarded bidder will complete the work as outlined in the specifications for the amount bid by the bidder. Any additional costs above the amount bid and awarded, must be approved by the District in advance of any work.

Voluntary alternates for bids are acceptable but should NOT be put in the space for the Base Bid on the Bid Response Form but on an attached sheet, clearly labeled Voluntary Alternative. Such Alternates should be described in enough detail for the District to understand the Bidder's intent.

Owner may choose to conduct testing to verify correct products and installation. If the materials and installation are found not to be per spec, owner will require subsequent tests to be performed by Owners testing company at contractors' expense.

Any exceptions to the terms and conditions contained in this RFP or any special considerations or conditions requested or required by the Contractor MUST be specifically enumerated by the Contractor and be submitted as part of its Proposal, together with an explanation as to the reason such terms and conditions of this RFP cannot be met by, or in the Contractor's opinion should not be applicable to, the Contractor. The Contractor shall be required and expected to meet the specifications and the requirements as set forth in this RFP in their entirety, except to the extent exceptions or special considerations or conditions are expressly set forth in the Contractor's Proposal and those exceptions or special considerations or conditions are expressly accepted by the District.

No responsibility shall attach to the District, or the authorized representatives of either one, for the premature opening of any proposal, which is not properly addressed and identified.

The Contract Documents, as outlined in the executed Agreement, shall imply the inclusion of the entire agreement between the parties thereto, and the Contractor shall not claim any modification thereof resulting from any representation or promise made at any time by an officer, agent or employee of the District or by any other person.

Opening and Awarding of Bids

Bids will be publicly opened and read aloud at the Troy School District Maintenance/Operations and Purchasing Offices, 1140 Rankin, Troy, MI 48083, at 1:00 p.m. Tuesday, December 18, 2018.

The recommendation for award will be submitted to the Board of Education at the regular Board of Education Meeting to be held on Tuesday, January 15, 2019.

Instruction to Bidders and Scope of work:**Bid Category 2 Wood Gym Floor****A. Includes**

- a. Except for those items (if any) specifically noted to be excluded as defined below, the work of this bid category shall include all of the work and contract requirements including all bid requirements and the Contract Documents. Should any conflict exist between this written scope of work and the scope of work inferred by the Division 1 General Requirements or the technical specifications listed below, the work required by this bid category description shall govern. Work of this bid category specifically includes the work of the technical specifications sections, in their entirety.

B. Clarifications

- a. Includes all demolition and slab preparation. Contractor to dispose of off-site legally.
- b. Include 6" wide solid aluminum thresholds at all doorways within this scope.
- c. Include 3/8" thick rubber flooring at entries (shown in orange on drawing).
- d. Include in bid removal and reinstallation of bleachers by certified installer.
- e. Provide and install Bleacher Blocking in closed position and wheel paths.
- f. Include Striping for all existing game-lines.
- g. Include 1' Baseline and 1' Sideline for Main Basketball Court.
- h. Include key stained in darker color.
- i. Include Center Circle Logo – 15' diameter. See below artwork.
- j. Provide Full-Color Floor Striping and Logo Diagram for Owner Approval as part of shop drawings.

C. Excludes

- a. Exclude the demo of any existing floor material, and any residual adhesive
- b. Exclude any grinding and leveling of concrete

D. Allowances

- a. Include in base bid \$5,000 to be used at owner's discretion.



Center Logo

Wood Athletic Flooring
Robbins Sportwood Ultra Star – Striaight Lay

Part 1-GENERAL – Specifications Bid 2**1.01 DESCRIPTION**

- A. Include all demolition, new material and labor necessary for this division.

1.02 QUALITY ASSURANCE**A. Floor System Manufacturer Qualifications**

1. Manufacturer shall be an established firm experienced in field and have been in business or a minimum of ten (10) years.
 - a. Second tier maple suppliers shall not be permitted.
2. Manufacturer will be a member in good standing of the Maple Flooring Manufacturers Association (MFMA).
 - a. Products manufactured by Erie Flooring of Canada will not be approved.

B. Floor Contractor/Installer Qualifications and Certifications

1. Flooring contractor shall be a firm with a minimum of 10 years experience in installing MFMA-PQ flooring and approved by the maple manufacturer.
2. Flooring contractor shall provide evidence of current MFMA- AI accreditation with bid documents
3. **Flooring contractor shall use certified and qualified labor to install flooring system.**
4. Submit a list of at least 10 completed projects of maple of similar magnitude and complexity.
5. Provide a joint warrantee from the maple flooring manufacturer and contractor covering material.

C. System Performance Requirements:

1. Flooring system meets or exceeds all 6 criteria of DIN 18032 Part II
2. Independent testing report shall be provided as part of the bid qualification process and submittal process if requested.

1.03 SUBMITTALS**A. Manufacturer's Product Data**

1. Suppliers shall submit certificates attesting that materials furnished will meet specifications for grade, quality, dryness and treatment, if required.
2. Submit certification that floor system to be provided has been tested by an independent agency verifying the flooring system meets or exceeds all six of the minimum standards as established by DIN 18032, part 2₂₀₀₁

B. Maintenance Literature

1. Submit copy of Maintenance Instructions.

1.04 DELIVERY, STORAGE AND HANDLING**A. Delivery of Materials**

1. Materials shall not be delivered, stored or installed until date approved by the owner. **Room temperature of 55-85 degrees Fahrenheit and relative humidity within reason.** Ideal installation/storage conditions are the same as those that will prevail when building is occupied.
2. Materials shall not be stored at the installation location if the moisture content of the concrete slab exceeds 4% or vapor transmission exceeds 4.5 pounds per 1,000 square feet (2.20 kg per 100 square meters).

1.05 JOB CONDITIONS-SEQUENCY

- A. Contractor is responsible to ensure slab is clean and free of all dirt and debris prior to floor installation beginning.

- B. Permanent heat, light and ventilation shall be installed and operating during and after installation. **Maintain a temperature range of 55 to 80 degrees Fahrenheit.** Consult MFMA guidelines for further information.

1.06 GUARANTEE

- A. Guarantee shall not cover damage caused in whole or in part by casualty, ordinary wear and tear, abuse, use for which material is not designed, faulty construction of the building, settlement of the building walls, failure of the

other contractors to adhere to specifications, separation of the concrete slab and excessive dryness or excessive moisture from humidity, spillage, migration through the slab or wall, or any other source.

- B. Manufacturer hereby warrants the material to be free from manufacturing defects for a period of 1 year. This warranty is in lieu of all other warranties, expressed or implied including but not limited to any warranty of merchantability or fitness for a particular purpose, and of any other obligations on the part of the manufacturer.

Part 2-PRODUCTS

2.01 MATERIALS

- A. Vapor Barriers
1. 6-mil polyethylene
- B. Subfloor
1. Robbins 7/16" Zero-G foam underlayment
 - a. Must be Open-Cell Full-Blanket Foam.
 - b. Individual Pads and/or Closed-Cell foam underlayment will not be accepted.
 - c. Approved Equals:
 - 1) Connor Sports – ½" Rezill Cushion, Rebonded Polyurethane, 8 PCF convoluted foam blanket
 - 2) Action Floor Systems - ½" open cell Performance Pad
 2. Subfloor material - 2 layers of 7/16" (11mm) oriented strand board (OSB), APA-rated Exposure 1. Or ½" CDX 4 ply plywood.
- C. Maple Flooring
1. 7/16" x .818" x 9" (11mm x 21mm x 229mm) MFMA-PQ Second & Better Square Edge, Edge Grain Kiln Dried Northern Hard Maple Flooring as manufactured by Robbins.
 - a. Approved Equals:
 - 1) 7/16" x .818" x 9" (11mm x 21mm x 229mm) MFMA-PQ Second & Better Square Edge, Edge Grain Kiln Dried Northern Hard Maple Flooring, milled in the U.S.A. by current MFMA Member Mill.
- D. Fasteners
1. Subfloor
 - a. 1" length, 7/16" (11mm) crown, coated staples or equivalent.
 - b. Construction adhesive, PL400 or equivalent.
 2. Flooring
 - a. Sika-Bond T-55 - Trowel Grade Polyurethane Elastic Adhesive for Solid Wood Flooring
 - 1) One-component, low-VOC, permanently elastic, crack bridging, polyurethane adhesive
- E. Finishing Materials
1. Bona Kemi All Court Finish oil-modified polyurethane sealer and finish.
 2. Bona Kemi Court-Lines paints.
- F. Perimeter Base – Shall be metal NOT vinyl.

Part 3-EXECUTION

3.01 INSPECTION

- A. Inspect concrete slab for proper tolerance and dryness, and report any discrepancies to the general contractor and architect in writing. Slab will be level to within 1/8" (3mm) in a 10' (3m). Moisture content of the concrete slab shall not exceed 4% or vapor transmission exceeds 4.5 pounds per 1,000 square feet (2.20 kg per 100 square meters).
1. Flooring Contractor will perform vapor transmission test to verify the transmission rate of the concrete slab is within the necessary requirements, using an Electronic Moisture/Humidity Meter for Concrete Slabs (Tramex or equivalent) / Calcium Chloride / In-Slab RH% Meter in at least 6 different locations on the slab.
- B. All work required to put the concrete subfloors in acceptable condition shall be the responsibility of the contractor.
- C. Concrete Subfloor shall be broom cleaned by contractor.
- D. Installer will determine if the slab is acceptable for the installation. Beginning the installation is an indication of the acceptance of the conditions.

3.02 INSTALLATION**A. Maple Floor System**

- a. Vapor Barrier
- b. Install polyethylene film, overlapping edges 6" with chemically welded seams.(150mm) minimum and turned up 4" (100mm) at the walls
- c. Subfloor
 - a. Install open-cell shock absorbing pad per manufacturer's recommendations.
 - b. Install the lower subfloor perpendicular to the intended finish flooring direction. All joints shall be staggered 4' and spaced 1/8" (3mm) apart.
 - c. Install solid blocking at doorways, under bleachers in the stacked position.
 - 1) Install Bleacher Blocking per manufacturer's recommendations.
 - d. Install the upper subfloor diagonal to the lower subfloor panels staggering joints 4' and spacing 1/8" (3mm) apart. Secure these panels using PL400 adhesive (Double Box X pattern) and 1" (25mm) staples placed 6" (150mm) On Center (O.C.) at panel perimeter and 12" (300mm) O.C. throughout interior. **Subfloor must be glued and stapled throughout.**
- d. Maple Flooring
 - a. Trowel on Sika-Bond T55 adhesive. Approximately 50 square feet (4.6 square meters) per gallon.
 - b. Install maple flooring in Sika-Bona adhesive, laying in specified pattern end to end.
 - 1) **Pattern to be Straight lay.**
 - c. Maple shall be laid with fine hairline joints and not driven tightly. Provide 2" (50mm) expansion void at perimeter and at all vertical obstructions.

3.03 FINISHING**A. Sanding**

1. Sand per manufacturer's recommendations.
2. After sanding, buff entire floor using 100 grit screen or equal grit sandpaper, with a heavy-duty buffing machine.
3. Inspect entire area of floor to insure the floor presents a smooth surface without drum stop marks, gouges, streaks or shiners.
4. Vacuum and/or tack floor before first coat of seal.

B. Finishing

1. Apply specified combination of seal, game line paint, and finish in accordance with manufacturer's instructions.
2. Seal and Finish shall be Bona Kemi All Court Sealer and Finish. Apply two sealer coats and two finish coats minimum.
3. Buff and vacuum and/or tack between each coat after it dries.
4. Apply game lines accurately after the buffing and vacuuming the coated surfaces. Layout in accordance with drawings. For game lines, use current rules of NFHS. Lines shall be straight with sharp edges in colors selected by owner.

3.04 WALL BASE INSTALLATION

1. Install metal vented cove base anchored to walls with base cement or screws and anchors. Use pre-molded outside corners and neatly mitered inside corners.

3.05 CLEANING

1. Clean up all unused material and debris and remove it from the premises.

Flooring Scope of Work

Project consists of:

Removal and installation of flooring materials at Boulan Park Middle School, Larson Middle School, Smith Middle School, Wattles Elementary School, Troy Union Elementary School and Schroeder Elementary School. For each building there is a composite plan showing the areas of work – shaded by color and a room finish schedule. Note: see room finish schedule for information on existing and new materials. Some existing flooring is asbestos containing. These spaces will be abated by TSD. As such do not include demolition of these rooms. Spaces indicated on the room finish schedule in the demolition column with a “yes” means you are to include demolition in your bid.

Note: Project is divided into two bid divisions. Bid division 1 is all the flooring except the gym floor At Larson Middle School. Bid division 2 is the gym floor complete.

Drawing Index:

A1 Wattles Elementary School

A2 Schroeder Elementary School

A3 Troy Union Elementary School

A4 Boulan Park Middle School

A5 Larson Middle School

A6 Smith Middle School

Scope of work:

Wattles - Remove and replace flooring in cafeteria and corridor as shown.

Troy Union and Schroeder - Remove and replace flooring in shaded rooms. For gymnasiums use Taraflex Sport M Plus Standard (95%RH) as the base bid and Sport M Plus Drytex (100%RH) as the add alternate.

Boulan Park – Remove and replace flooring in shaded room.

Larson – Remove and replace flooring in shaded rooms as part of bid 1. For Larson gymnasium replace door entry areas with 3/8” thick sports rubber floor and wood floor with Robbins Sportwood Ultra Star as part of Bid 2.

Smith Middle School – Remove and replace flooring in shaded rooms. Note for both tiered music rooms – install nora rubber Grano series. Install 4 1/2” rubber base at walls and 6” rubber base on face of steps. Provide and install Roppe rubber nosing #1 at all steps.

Specifications:

Demolition – VCT and Carpet Areas

1. Remove existing flooring and base as noted in room finish schedule – dispose of legally off site.
2. It is essential that all substrates be permanently dry, clean, smooth, and structurally sound. Substrates shall be free of all foreign materials such as dust, solvent, paint, wax, grease, oil, residual adhesive, adhesive removers, curing, sealing, hardening, or parting compounds, alkaline salts, excessive carbonation or laitance, mold, mildew, and other foreign materials that might prevent adhesive bond. Substrate preparation should be done while the permanent HVAC is set at a minimum 68°F. Vacuuming the substrates with a commercial shop vacuum is a preferred method of removing dirt and dust. For concrete floors, damp mopping is an excellent way to remove fine dust. A clean substrate is essential for proper bonding of the adhesive to the substrate.

Installation – Rubber Flooring (Pink – Smith, Boulan and Larson Middle Schools)

1. Provide new Grano 39" tile as shown on drawings. Colors TBD.
2. All installation will be per the manufacturer's specification for this product.
3. Grind smooth existing surface.
4. Skim coat all areas with Ardex or similar to receive nora product.
5. Check Rh for 60 days prior to install.
6. Provide nosing and base at risers per scope.
7. Product will be installed with nora 485 one part adhesive.
8. Provide new 4 1/2" H Roppe rubber base color; TBD
9. See manufactures specifications for proper installation of product.

Installation – Walk off carpet (Yellow – Troy Union and Schroeder)

1. Provide new Forbo Coral Brush 24" X 24" tile. Color Hurricane Grey - extent as shown on drawings.
2. All installation will be per the manufacturer's specification for this product.
3. Grind smooth existing surface.
4. Skim coat all areas with Ardex or similar to receive Forbo product.
5. Check Rh for 60 days prior to install.
6. Product will be installed using Forbo Sustain 885 adhesive.
7. Provide new 4 1/2" H Roppe rubber base color; TBD
8. See manufactures specifications for proper installation of product.

Installation – Luxury tile (Gray – multiple schools)

1. Mipolam Troplan 100 Tile as the base bid and Mipolam Premium Drytex (100% RH) as the alternate.
2. All installation will be per the manufacturer's specification for this product.
3. Grind smooth existing surface.
4. Skim coat all areas with Ardex or similar to receive Gerflor product.
5. Check Rh for 60 days prior to install.
6. Product will be installed with manufacturer's recommended adhesive.
7. Provide new 4 1/2" H Roppe rubber base color; TBD.
8. See manufactures specifications for proper installation of product.

Installation – Flotex (Blue – multiple schools)

1. Provide new Forbo Flotex modular v1.01 20" X 20" or 10" X 40" - extent as shown on drawings.
2. All installation will be per the manufacturer's specification for this product.
3. Grind smooth existing surface.
4. Skim coat all areas with Ardex or similar to receive Forbo product.
5. Check Rh for 60 days prior to install.
6. Product will be installed with 540 Eurosafe Special adhesive.
7. Provide new 4 1/2" H Roppe rubber base color; TBD.
8. See attached specifications.

Installation – Taraflex Gymnasium Flooring (Purple – multiple schools)

1. Gerflor Taraflex Sport M Plus Sports Flooring base bid and Mipolam Premium Drytex (100% RH) as the alternate.
2. All installation will be per the manufacturer's specification for this product.
3. Grind smooth existing surface.
4. Skim coat all areas with Ardex or similar that is acceptable to the Gerflor product.
5. Check Rh for 60 days prior to install.
6. Product will be installed with manufacturer's full-spread adhesive.
7. For alternate install with Gerpur high-moisture tolerance full-spread adhesive.
8. Provide new 6" H Roppe rubber base color; TBD.
9. Provide game lines to match existing - system complete including primer, compatible with flooring and installed per manufactures standards. Picture provided.
10. Field to be "wood" finish outside baseline to be solid color.
11. Contractor to provide game line shop drawing.
12. See manufactures specifications for proper installation of product.

Installation – Stair treads and risers (Troy Union and Schroeder)

1. Provide new Johnsonite combo treads/risers with hammered finish. Treads to be full width. If a seam is required (due to limitations of product) it will be in the middle.
2. Grind smooth existing surface.
3. All installation to be per the manufacturer's specification for this product.
4. Skim coat all areas with Ardex or similar to receive Johnsonite product.
5. Check Rh for 60 days prior to install.
6. Provide matching material at the mid landing for all locations.
7. Provide new 4 1/2" H Roppe rubber base color; TBD
8. Existing material is rubber.
9. See attached specifications.

Schedule:

Information will be discussed at Pre-bid meeting. It is anticipated non ACM containing rooms could begin immediately after school ends June 15, 2018. It is also possible to complete some work over Spring Break. This will be discussed further depending on material availability and logistics.

TSD will address all moving needs.

Color schedule will be issued as an addendum.

Contractor to provide rubber transitions strips by Tandus MetalEdge at all transitions from soft to hard surface, height differences or at the edge of exposed flooring. Contractor to verify locations with owner prior to install. Color TBD.

For all rooms being abated by TSD include in your bid grinding of all existing NON ACM mastic prior to installing any floor prep.

For rooms with moveable partitions – carpet will extend under the partitions. TSD will open partitions.

END



Elementary gym lines



Smith music



Smith music



Boulan music room – Larson similar

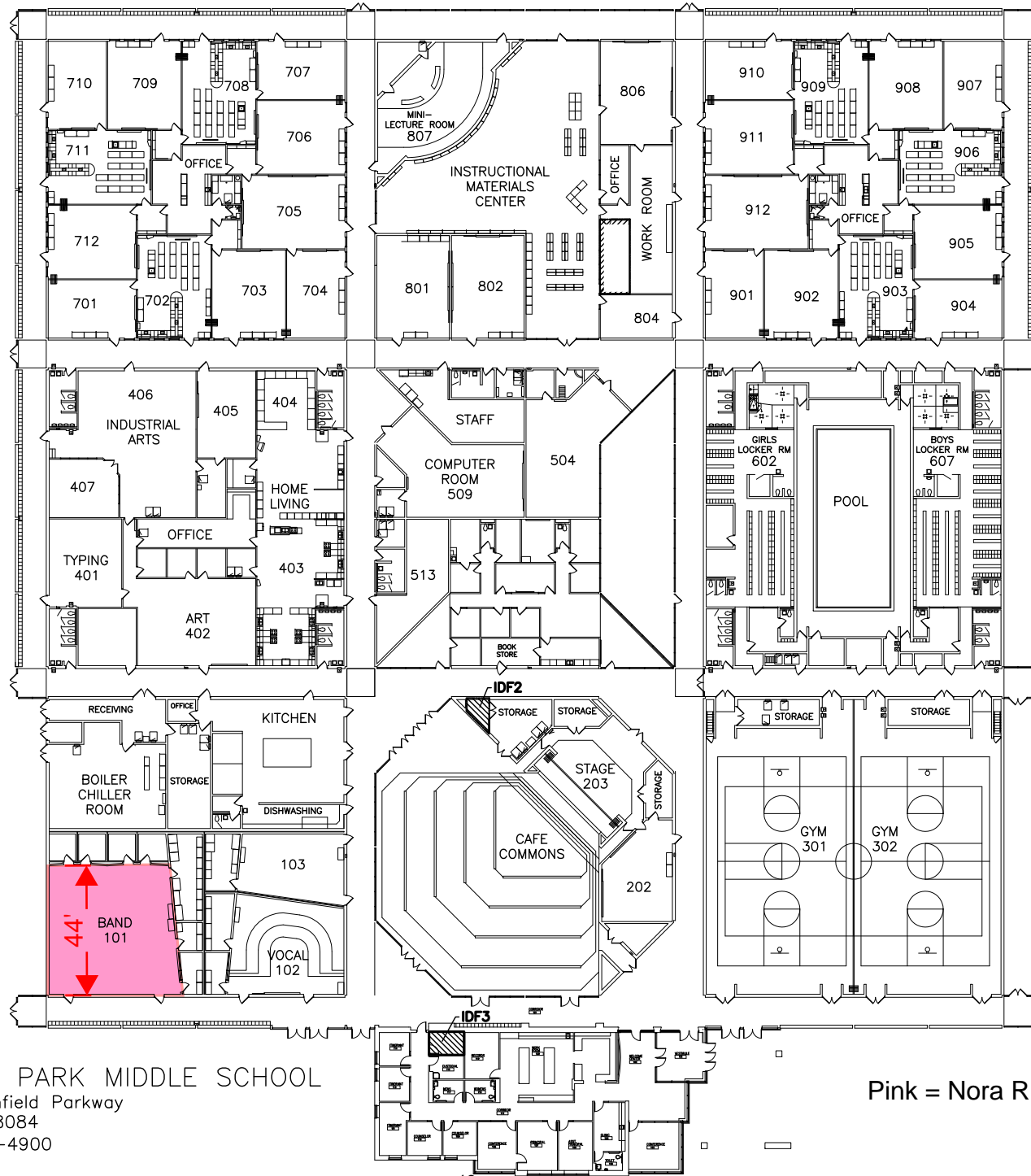

BOULAN PARK MIDDLE SCHOOL
 3570 Northfield Parkway
 Troy, MI 48084
 (248) 823-4900

Pink = Nora Rubber

A4

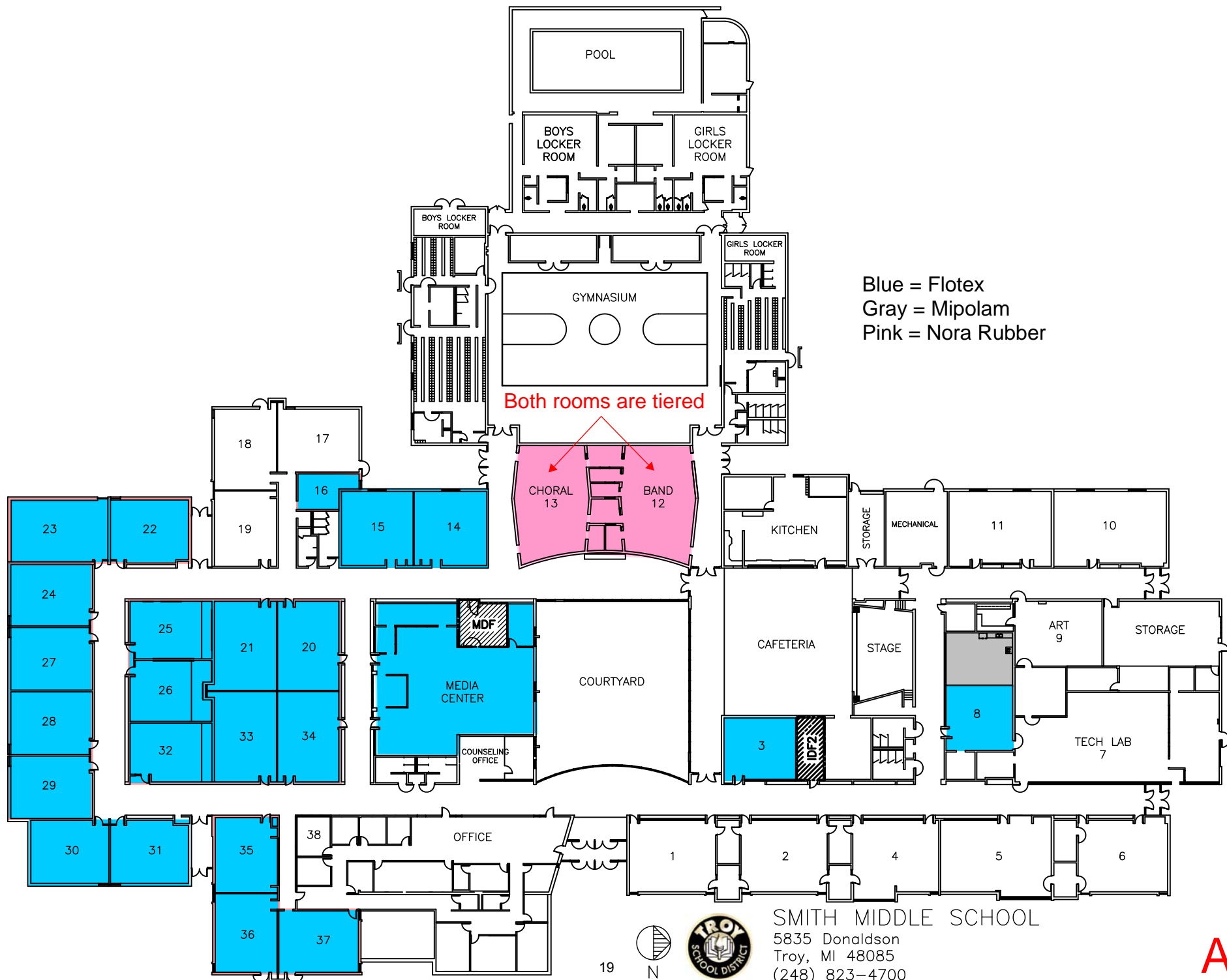

Both rooms are tiered

Blue = Flotex
Gray = Mipolam
Pink = Nora Rubber



SMITH MIDDLE SCHOOL
5835 Donaldson
Troy, MI 48085
(248) 823-4700

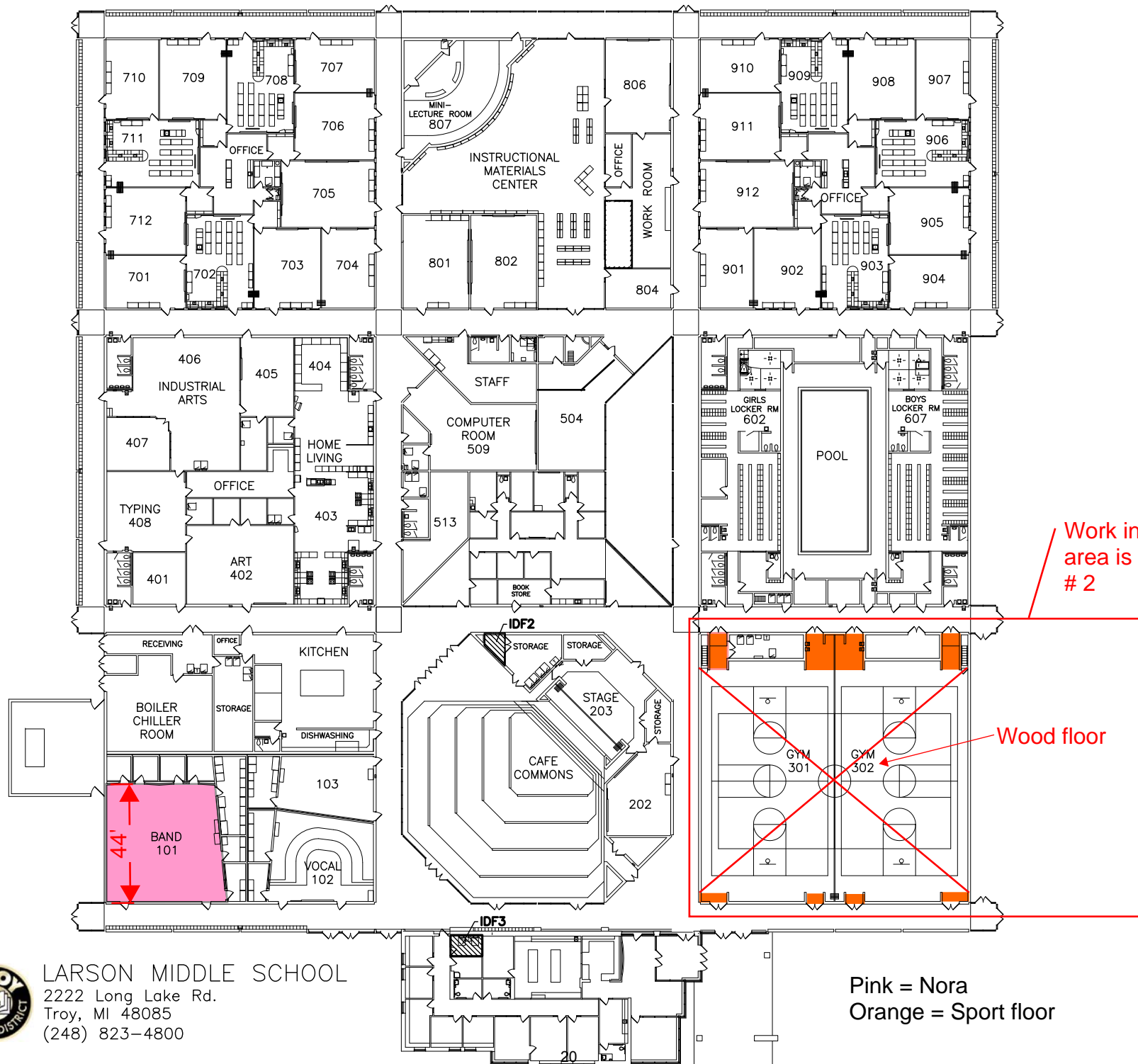

LARSON MIDDLE SCHOOL
 2222 Long Lake Rd.
 Troy, MI 48085
 (248) 823-4800

Pink = Nora
 Orange = Sport floor

A5



SCHROEDER ELEMENTARY SCHOOL

3541 Jack Dr.
Troy, MI 48084
(248) 823-3600



Gym lines to match picture

21

A2

For Kindergarten rooms provide 20'X20' of Flotex location TBD
20' of Coral Brush

6' strip of Mipolam

Same as rooms 2 and 3

Same as room K rooms

Provide combo treads and risers from Johnsonite

6' strip of Mipolam (typical this wing)

4' strip of Mipolam

These rooms same as opposite wing

12' of Coral Brush

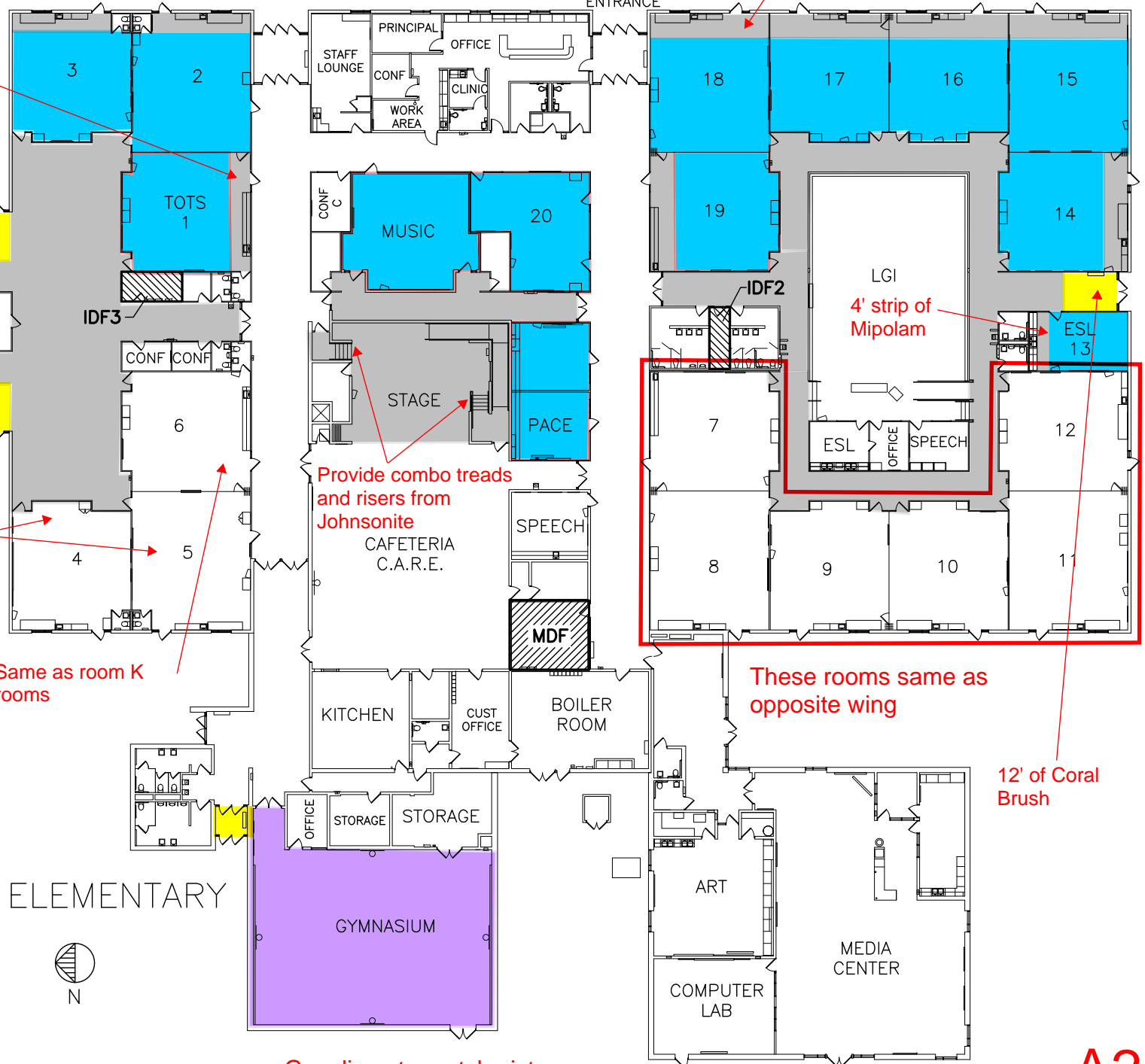
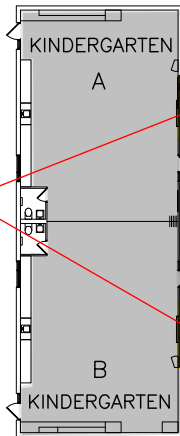

Blue = Flotex
 Gray = Mipolam
 Purple = Taraflex
 Yellow = Coral Brush

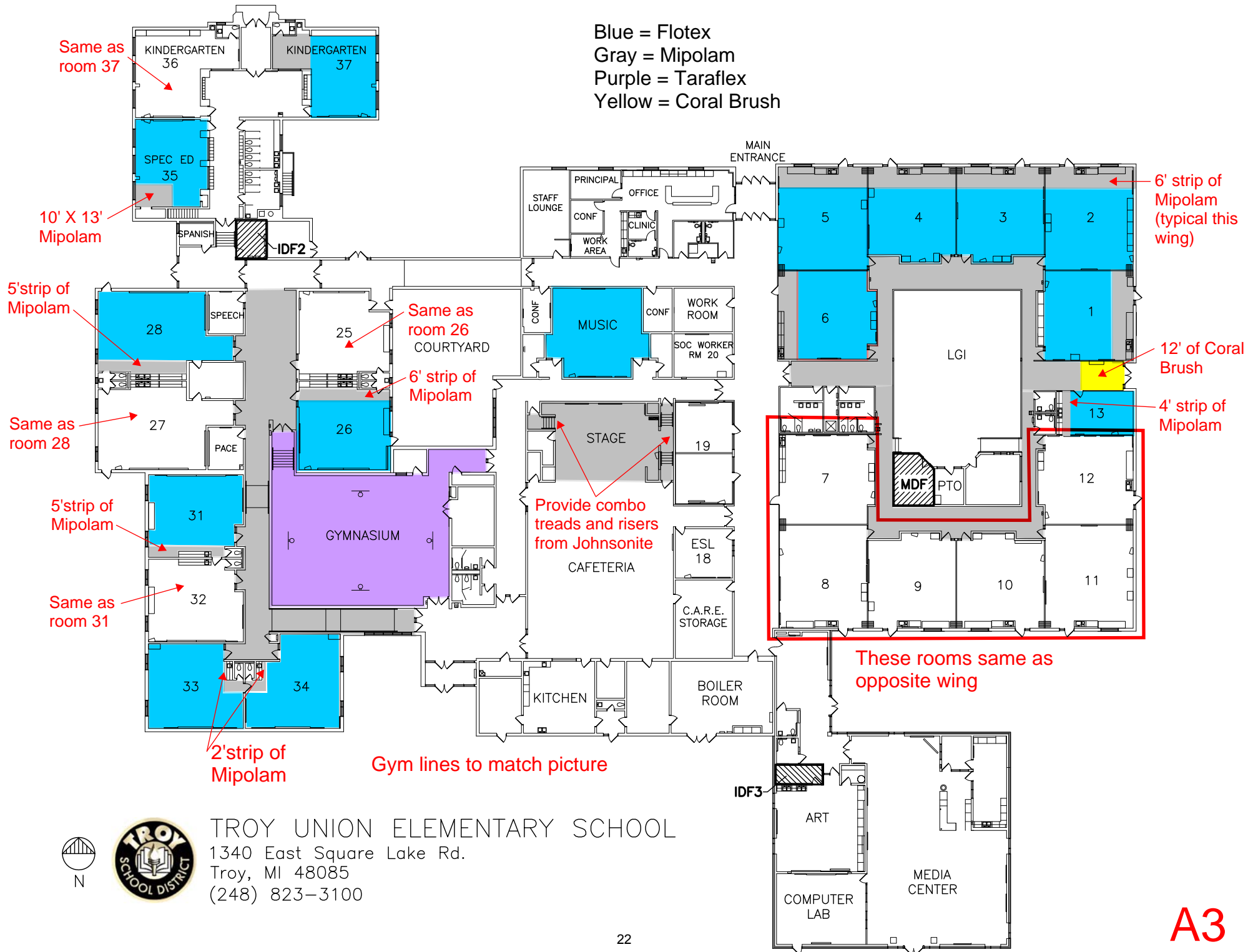

TROY UNION ELEMENTARY SCHOOL
 1340 East Square Lake Rd.
 Troy, MI 48085
 (248) 823-3100

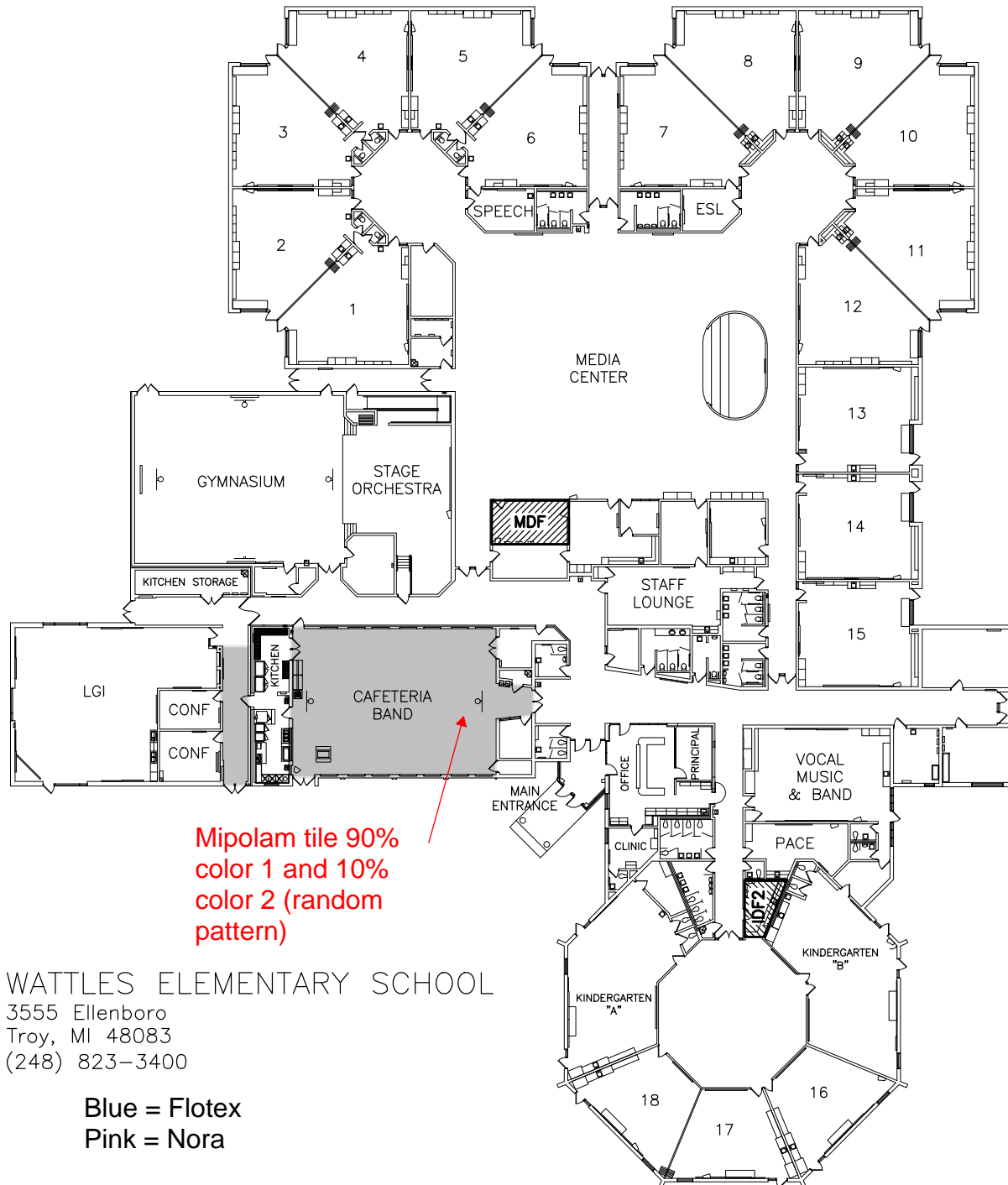

Mipolam tile 90%
color 1 and 10%
color 2 (random
pattern)



WATTLES ELEMENTARY SCHOOL
3555 Ellenboro
Troy, MI 48083
(248) 823-3400

Blue = Flotex
Pink = Nora

A1

Troy Union Elementary School

Room type	Room number	Abatement	Demolition	New Finish	Base	Base bid or alternate
Classroom	1	Yes	No	LVT1/CPT1	Rubber	Base bid
Classroom	2	Yes	No	LVT1/CPT1	Rubber	Base bid
Classroom	3	Yes	No	LVT1/CPT1	Rubber	Base bid
Classroom	4	Yes	No	LVT1/CPT1	Rubber	Base bid
Classroom	5	Yes	No	LVT1/CPT1	Rubber	Base bid
Classroom	6	Yes	No	LVT1/CPT1	Rubber	Base bid
Classroom	7	Yes	No	LVT1/CPT1	Rubber	Base bid
Classroom	8	Yes	No	LVT1/CPT1	Rubber	Base bid
Classroom	9	Yes	No	LVT1/CPT1	Rubber	Base bid
Classroom	10	Yes	No	LVT1/CPT1	Rubber	Base bid
Classroom	11	Yes	No	LVT1/CPT1	Rubber	Base bid
Classroom	12	Yes	No	LVT1/CPT1	Rubber	Base bid
Classroom	13	Yes	No	LVT1/CPT1	Rubber	Base bid
Classroom	25	Yes	No	LVT1/CPT1	Rubber	Base bid
Classroom	26	Yes	No	LVT1/CPT1	Rubber	Base bid
Classroom	27	Yes	No	LVT1	Rubber	Base bid
Classroom	28	Yes	No	LVT1	Rubber	Base bid
Classroom	31	No	Yes	LVT1/CPT1	Rubber	Base bid
Classroom	32	No	Yes	LVT1/CPT1	Rubber	Base bid
Classroom	33	No	Yes	LVT1/CPT1	Rubber	Base bid
Classroom	34	No	Yes	LVT1/CPT1	Rubber	Base bid
Classroom	35	No	Yes	LVT1	Rubber	Base bid
Classroom	36	No	Yes	LVT1	Rubber	Base bid
Classroom	37	No	Yes	LVT1	Rubber	Base bid
GYMNASIUM	Gymnasium	No	Yes	Taraflex	Rubber	Base bid
STAGE	Stage	Yes	No	LVT1	Rubber	Alternate
Corridor one	Hallway by LGI	No	Yes	LVT1	Rubber	Alternate
Corridor two	Hallway by GYM	Yes	No	LVT1	Rubber	Alternate

Schroeder Elementary School

Room type	Room number	Abatement	Demolition	New Finish	Base	Base bid or alternate
Classroom	1	No	Yes	LVT1/CPT1	Rubber	Base bid
Classroom	2	No	Yes	LVT1/CPT1	Rubber	Base bid
Classroom	3	No	Yes	LVT1/CPT1	Rubber	Base bid
Classroom	4	No	Yes	LVT1/CPT1	Rubber	Base bid
Classroom	5	No	Yes	LVT1/CPT1	Rubber	Base bid
Classroom	6	No	Yes	LVT1/CPT1	Rubber	Base bid
Classroom	7	No	Yes	LVT1/CPT1	Rubber	Base bid
Classroom	8	No	Yes	LVT1/CPT1	Rubber	Base bid
Classroom	9	No	Yes	LVT1/CPT1	Rubber	Base bid
Classroom	10	No	Yes	LVT1/CPT1	Rubber	Base bid
Classroom	11	No	Yes	LVT1/CPT1	Rubber	Base bid
Classroom	12	No	Yes	LVT1/CPT1	Rubber	Base bid
Classroom	13	No	Yes	LVT1/CPT1	Rubber	Base bid
Classroom	14	No	Yes	LVT1/CPT1	Rubber	Base bid







Classroom	15	No	Yes	LVT1/CPT1	Rubber	Base bid
Classroom	16	No	Yes	LVT1/CPT1	Rubber	Base bid
Classroom	17	No	Yes	LVT1/CPT1	Rubber	Base bid
Classroom	18	No	Yes	LVT1/CPT1	Rubber	Base bid
Classroom	19	No	Yes	LVT1/CPT1	Rubber	Base bid
Classroom	20	No	Yes	CPT1	Rubber	Base bid
Classroom	21	No	Yes	CPT1	Rubber	Base bid
Classroom	22	No	Yes	CPT1	Rubber	Base bid
KINDERGARTEN A	KA	No	Yes	LVT1	Rubber	Base bid
KINDERGARTEN B	KB	No	Yes	LVT1	Rubber	Base bid
Vestibule	Vest by gym	No	Yes	CPT2	Rubber	Base bid
GYMNASIUM	Gymnasium	No	Yes	Taraflex	Rubber	Base bid
Corridor one	Hallway by stage	No	Yes	LVT1	Rubber	Base bid
Corridor two	Hallway by LGI	No	Yes	LVT1	Rubber	Alternate
Corridor three	Centrum by K	No	Yes	LVT1	Rubber	Alternate
STAGE	Stage	No	Yes	LVT1	Rubber	Alternate

Smith Middle School

Room type	Room number	Abatement	Demolition	New Finish	Base	Base bid or alternate
Classroom	3	Yes	No	CPT1	Rubber	Base bid
Classroom	8	Yes	No	CPT1	Rubber	Base bid
Classroom	14	Yes	No	CPT1	Rubber	Base bid
Classroom	15	Yes	No	CPT1	Rubber	Base bid
Classroom	16	No	Yes	CPT1	Rubber	Base bid
Classroom	20	Yes	No	CPT1	Rubber	Base bid
Classroom	21	Yes	No	CPT1	Rubber	Base bid
Classroom	22	No	Yes	CPT1	Rubber	Base bid
Classroom	23	No	Yes	CPT1	Rubber	Base bid
Classroom	24	No	Yes	CPT1	Rubber	Base bid
Classroom	25	No	Yes	CPT1	Rubber	Base bid
Classroom	26	No	Yes	CPT1	Rubber	Base bid
Classroom	27	No	Yes	CPT1	Rubber	Base bid
Classroom	28	No	Yes	CPT1	Rubber	Base bid
Classroom	29	No	Yes	CPT1	Rubber	Base bid
Classroom	30	No	Yes	CPT1	Rubber	Base bid
Classroom	31	No	Yes	CPT1	Rubber	Base bid
Classroom	32	No	Yes	CPT1	Rubber	Base bid
Classroom	33	Yes	No	CPT1	Rubber	Base bid
Classroom	34	Yes	No	CPT1	Rubber	Base bid
Classroom	35	No	Yes	CPT1	Rubber	Base bid
Classroom	36	No	Yes	CPT1	Rubber	Base bid
Classroom	37	No	Yes	CPT1	Rubber	Base bid
Classroom	38	No	Yes	CPT1	Rubber	Base bid
Classroom	12 band	No	Yes	1RUB	Rubber	Alternate 1
Classroom	13 Choral	No	Yes	1RUB	Rubber	Alternate 1
Media Center	MC	No	Yes	CPT1	Rubber	Alternate 2

Wattles Elementary School						
Room type	Room number	Abatement	Demolition	New Finish	Base	Base bid or alternate
Cafeteria	Café	Yes	No	LVT1	None	Base bid
Corridor one	Hall by kit A-B	No	No	Rub1	Rubber	Base bid
Larson Middle School						
Room type	Room number	Abatement	Demolition	New Finish	Base	Base bid or alternate
Classroom	101 band	Yes	No	Rub1	Rubber	Base bid
GYM	301/302	?	?	WOOD	Alum	Base bid
Boulan Park Middle School						
Room type	Room number	Abatement	Demolition	New Finish	Base	Base bid or alternate
Classroom	101 band	Yes	No	Rub1	LVT1	Base bid

Flooring Key

	=	RUB1	Nora Rubber
	=	LVT1	Taraflex Mipolam
	=	CPT1	Forbo Flotex
	=	CPT2	Forbo Coral Brush
	=	GYM1	Taraflex
	=	GYM2	Wood floor (Larson only)



DUE: 1:00 pm., Tuesday, December 18, 2018
PROPOSAL: BID 9871 2019 Flooring Replacement Program

We propose to furnish all material, labor and equipment, as per the specifications, for the Troy School District. and all other services to complete BID 9871 2019 Flooring Replacement.

NOTE – There are 2 bid divisions you do NOT have to bid on both divisions. However, you must bid on all schools included in Bid 1.

Bid 1

Total Cost – Boulan Park Middle School \$ _____ no alternates
Total Cost – Smith Middle School \$ _____ Alt 1 _____ Alt 2 _____
Total Costs – Larson Middle School \$ _____ **(without GYM)**
Total Costs – Schroeder Elementary School \$ _____ Alt 1 _____ Alt 2 _____ Alt 3 _____
Total Costs – Troy Union Elementary School \$ _____ Alt 1 _____ Alt 2 _____ Alt 3 _____
Total Costs – Wattles Elementary School \$ _____ no alternates
Bond Costs – All Schools Combined \$ _____

Grand Total (w/o alts) \$ _____ Total with alternates \$ _____

Bid 2 – Gym only

Total Costs – Larson Middle School \$ _____
Bond Costs – Larson Middle School \$ _____

Grand Total \$ _____

Alternate Pricing:

Nora Rubber nTx sf cost \$ _____ (add to above costs/sf)

Taraflex Sport M Drytex cost \$ _____ (total add to above cost for each gymnasium)

Provide labor rate per hour \$ _____

Provide per classroom cost for 900sf of removal, prep and installation of Flotex \$ _____

Provide per classroom cost for 900sf of removal, prep and installation of Mipolam tile \$ _____

BIDDER'S FIRM NAME _____
NAME _____
ADDRESS _____
CITY/STATE _____ ZIP _____
CELL NUMBER _____ FAX # _____
SIGNED BY _____ TITLE _____
TYPED NAME _____ DATE _____
E-MAIL ADDRESS _____

VENDOR: LIST FIVE RECENT REFERENCES, PREFERABLY SCHOOL DISTRICTS:

_____ School District	_____ Person to Contact	_____ Phone Number
_____ School District	_____ Person to Contact	_____ Phone Number
_____ School District	_____ Person to Contact	_____ Phone Number
_____ School District	_____ Person to Contact	_____ Phone Number
_____ School District	_____ Person to Contact	_____ Phone Number

Interested vendors will note in this space only any additional information, criteria or contingencies affecting their proposal, understanding that this additional information, criteria or contingency may be utilized in the evaluation process and subsequent award.

**SWORN AND NOTARIZED FAMILIAL DISCLOSURE STATEMENT
FAMILIAR DISCLOSURE AFFIDAVIT**

The undersigned, the owner or authorized office of the below-named contractor (the ‘Contractor’), pursuant to the familial disclosure requirement provided to Troy Schools, hereby represents and warrants that, excepts as provided below, no familial relationship exists between the owner or key employee of the Contractor, and any member of the Troy School Board or the Troy School Superintendent. A list of the School District’s Board of Education Members and its Superintendent may be found at <http://www.troy.k12.mi.us>.

List any Familial Relationships:

Contractor:

Print Name of Contractor

By: _____

Its: _____

Subscribed and sworn before me, this _____ Seal:

day of _____, 20 _____, a Notary Public

in and for _____ County, _____

(Signature)
NOTARY PUBLIC

My Commission expires _____

CERTIFICATION OF COMPLIANCE – IRAN ECONOMIC SANCTIONS ACT

Michigan Public Act No. 517 of 2012

The undersigned, the owner, or authorized officer of the below-named Company, pursuant to the compliance certification requirement provided in Troy School District's Request For Proposal, the "RFP", hereby certifies, represents, and warrants that the Company and its officers, directors and employees, is not an "Iran Linked Business" within the meaning of the Iran Economic Sanctions Act, Michigan Public Act No. 517 of 2012 (the "Act"), and that in the event the Company is awarded a contract by Troy School District as a result of the aforementioned RFP, the Company is not and will not become an "Iran Linked Business" at any time during the course of performing any services under the contract.

The Company further acknowledges that any person who is found to have submitted a false certification is responsible for a civil penalty of not more than \$250,000.00 or two (2) times the amount of the contract or proposed contract for which the false certification was made, whichever is greater, the cost of Troy School District's investigation, and reasonable attorney fees, in addition to the fine. Moreover, any person who submitted a false certification shall be ineligible to bid on a request for proposal for three (3) years from the date the it is determined that the person has submitted the false certification.

NAME OF COMPANY

NAME AND TITLE OF AUTHORIZED REPRESENTATIVE

SIGNATURE

DATE

Acceptance of Proposal

The undersigned agrees to execute a Contract for work covered by this Proposal provided that he is notified of its acceptance within thirty days after the opening of the Proposal.

It is agreed that this bid will not be withdrawn until after forty-five (45) days after receipt of bids.

The undersigned affirms that the bid was developed without any collusion, undertaking, or agreement, either directly or indirectly, with any other bidder(s) to maintain the prices of indicated work or prevent any other bidder(s) from bidding the work.

BIDDER’S FIRM NAME	_____
BUSINESS ADDRESS	_____ _____ _____
TELEPHONE NUMBER	_____
CELL NUMBER	_____
FAX NUMBER	_____
BY (SIGNATURE)	_____
PRINTED NAME	_____
TITLE	_____
SIGNED THIS	_____ DAY OF _____, 20 _____
E-MAIL ADDRESS	_____



Addendum 1

Project: **BID NO. 9871 2019 FLOORING REPLACEMENT PROGRAM FOR TROY SCHOOL DISTRICT**

Bid Due date: 1:00PM Tuesday, December 18, 2018 (UNCHANGED)

This Addendum is issued as modifications to the RFP previously issued to provide clarifications to the scope of work. This Addendum supersedes the original RFP. This along with the RFP becomes the bid documents.

1. At Troy Union Elementary School add two additional rooms – Pace and Speech. For these rooms demo by owner, install new Flotex flooring and rubber base.
2. At Troy Union Elementary School – note the mechanical units will be removed and replaced with smaller units in rooms 25, 26 and 27.
3. At Troy Union and Schroeder Elementary Schools provide 6" rubber base at gyms.
4. At Troy Union and Schroeder Elementary Schools assume existing gymnasium wood system is 3" thick. Contractor to provide cementitious fill with pea gravel or smaller stone compared to traditional aggregate for first 2 – 2 ½" with ½" of Ardex k-15 over that top. Contractor to protect access point and path to gym for this process.
5. At Smith Middle School provide 4 combo treads/risers at room 12.
6. At Troy Union Elementary School in the gymnasium provide new Johnsonite combo treads and risers at all steps.
7. At Smith Middle School at room 12 – contractor to work around existing railings.
8. At tiered rooms constructed of wood at Smith Middle School, contractor to include \$2,000 in their base bid for potential patching of wood on steps. Contractor to include minor patching and skim coating in base bid.
9. Rubber base to be 4 ½" high unless noted otherwise.
10. Contractor must use certified Forbo and nora certified installers. Minimum of two on site.

Questions from bidders;

11. For the Mipolam Troplan Modular materials, can Sheet Goods be installed in lieu of tiles, to cut down on heat welded seams?

Questions from bidders con't

Heat welding for tile is not necessary. TSD does not want sheet goods.

12. There are not enough spaces for alternate bids for Mipolam Premijm Drytex Option at Schroeder ES and Troy ES.

Attach a separate sheet for the Drytex alternate.

13. For the Flotex Modular, will Forbo FRT 950 Adhesive be acceptable?

Yes – this is the preferred adhesive.

14. Is there any attic stock required?

Yes provide 1% of each.

15. What is required completion date?

Projects to be completed in a staged fashion with final project complete August 19, 2019.

16. What are the available working hours for installation during summer break?

6:30 AM to 7:00PM

17. Would you please include a list of pre-bid attendees with your response?

Attendees were; Conventional Carpet, Continental Flooring, Six Brother Construction and Dean Flooring Services.

END



Addendum 2

Project: **BID NO. 9871 2019 FLOORING REPLACEMENT PROGRAM FOR TROY SCHOOL DISTRICT**

Bid Due date: 1:00PM Tuesday, December 18, 2018 (UNCHANGED)

This Addendum is issued as modifications to the RFP previously issued to provide clarifications to the scope of work. This Addendum supersedes the original RFP. This along with the RFP becomes the bid documents.

1. Bid division 2 – wood floor project. Include all demolition and disposal in your bid.

END

**Bid Tabulation
BID 9871 Flooring Replacement
Program**

Vendors	Boulan Park Middle School	Smith Middle School	Larson Middle School	Schroeder Elementary School	Troy Union Elementary School	Wattles Elementary School	Bond All Locations	Gym Floor + Bond Costs Larson Middle School	Grand Total
<i>Division One</i>									
Continental Flooring Company	\$29,005.00	\$163,450.00	\$29,005.00	\$325,012.00	\$308,330.00	\$30,805.00	\$13,660.00	No Bid	\$899,267.00
Conventional Carpet, Inc.	\$26,524.00	\$153,895.00	\$26,524.00	\$304,317.00	\$291,658.00	\$16,792.00	\$9,888.03	No Bid	\$829,598.03
Shock Brothers Floorcovering, Inc.	\$29,800.00	\$155,350.00	\$29,800.00	\$302,300.00	\$302,200.00	\$34,800.00	\$6,200.00	No Bid	\$860,450.00
<i>Division Two - Gym Floor Only</i>									
Foster Specialty Floors	No Bid	No Bid	No Bid	No Bid	No Bid	No Bid	No Bid	\$123,050.00	\$123,050.00
Kuhn Specialty Flooring	No Bid	No Bid	No Bid	No Bid	No Bid	No Bid	No Bid	\$112,500.00	\$112,500.00