

General Floor Plan

With rental of the facility, a number of spaces are available for your use.

Easy load-in through the scene shop which is at ground level and is accessible through a roll-up door that is just 30 feet to stage left.

Three dressing rooms are available on stage left and stage right. Dressing Room "A" has a sink, lockers and lit mirror stations. Dressing Room "B" has a private bathroom with shower, sink, lockers, and lit mirror stations. Our largest is Dressing Room "C" which has two private bathrooms with showers, two sinks, lockers, television monitor, and lit mirror stations.

A Green Room is available off of stage right and has a full-size refrigerator, sink, microwave, soft seating, and a television monitor. Just outside the Green Room is a bathroom with shower.

Also available is the Box Office, which has two ticketing positions, one of these positions has an external window.

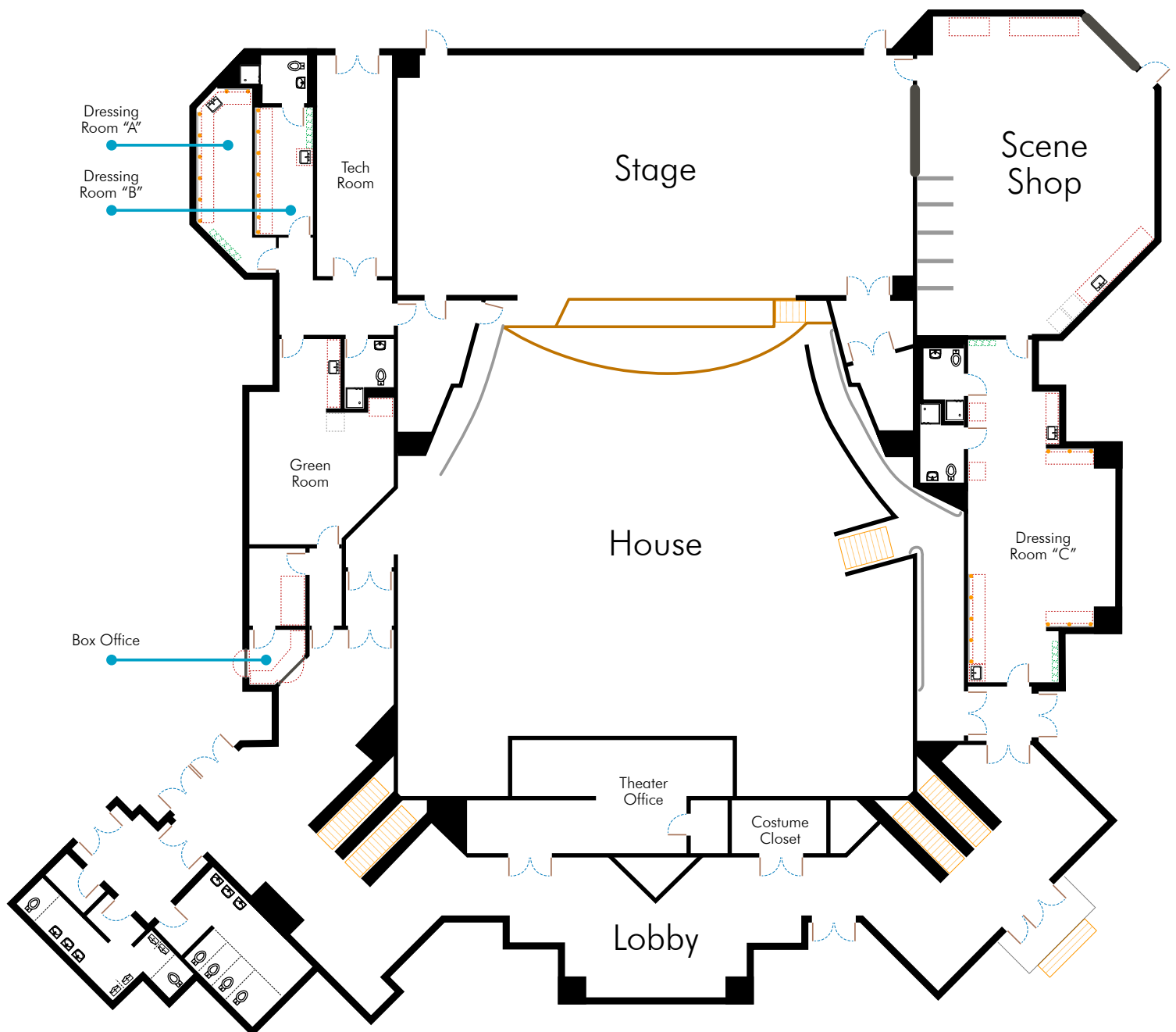

This drawing is not to scale.