

April 3, 2019

SOLICITATION ADDENDUM NO. 1

ITB 19-0013

General Contractor for Montclair Elementary School Classroom Re-Flooring

THE FOLLOWING CHANGES/ADDITIONS TO THE ABOVE CITED SOLICITATION ARE ANNOUNCED:

This Addendum modifies the Invitation to Bid (ITB) document(s) only to the extent indicated herein. All other areas not changed or otherwise modified by this Addendum shall remain in full force and effect. This Addendum is hereby made an integral part of the ITB document. Bidder must be responsive to any requirements of this Addendum as if the requirements were set forth in the ITB. Failure to do so may result in Bid rejection. See the ITB regarding requests for clarification or change and protests of this Addendum, and the deadlines for the foregoing.

This addendum is to be acknowledged in the space provided on the Bidder Certification form supplied in the solicitation document. Failure to acknowledge receipt of this addendum may be cause to reject your offer.

The closing date **REMAINS UNCHANGED: April 24, 2019 at 2:00 PM Pacific Time**

CHANGES:

1. Attachment K – Montclair Floor Plan replaced with Attachment K – Montclair Floor Plan Addendum 1.

CLARIFICATIONS:

Clarifications and Questions from March 28, 2019 Pre-Bid Conference

Question: Does the Contractor need to move the furniture and other items?

Answer: No. The District will move all necessary items before work begins.

Question: The floor is concrete underneath?

Answer: Yes.

Question: Is this room [108] the only room with a partition?

Answer: No. The drawings show all rooms with a partition.

Question: High traffic areas will need a better transition due to the new carpet being thicker than existing due to wear.

Answer: A low profile rubber or vinyl transition strip may be used where new carpet meets existing carpet. Please note the site map has been amended to show the transition in the N. Hallway ending at the narrowest point to ensure minimal use of a transition in this high traffic area.

Question: What is the plan for the transition in the doorway? Do we run the new modular carpet and get out to the other piece of carpet or do we leave a three (3) inch piece in the doorway? Or what about an aluminum threshold?

Answer: A low profile, non-ferrous, aluminum threshold must be installed at all doorways where new carpet meets old carpet. Threshold must be mechanically fastened.

-END of Addendum

Justin Sweet
Contract Specialist

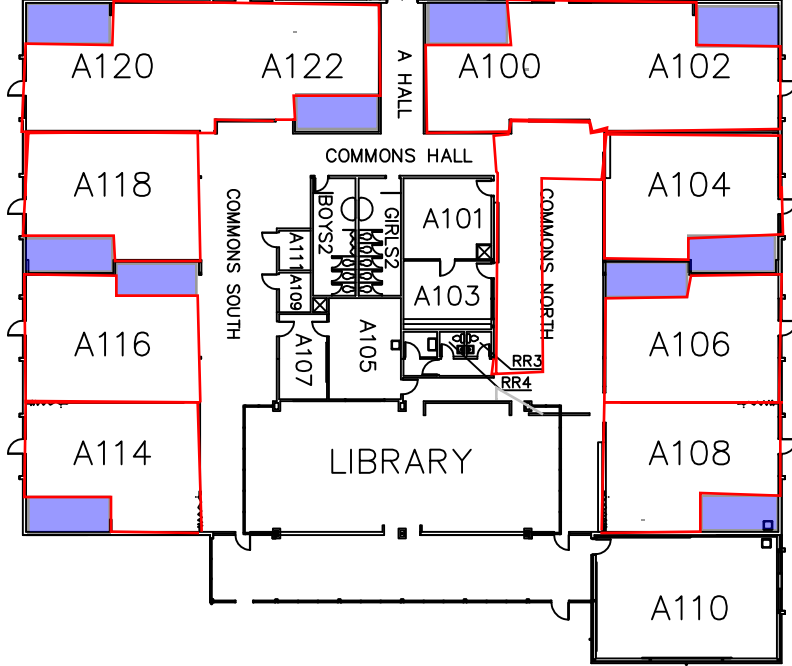

Red - Classroom re-floor, 8,102 sq. ft.

Green - ALT 1 - 596 sq. ft. - school funded

Blue - existing VCT that will remain.

