

# Hunters Creek Elementary School

## Replacement School PAT Meeting #5 – 03.20.19



**pfluger**

# Hunters Creek Elementary School

## PAT Charge

The goal of the PAT is to ensure that parents, staff and community members have the opportunity to take part in the planning and design of the new school.

The PAT members will serve as communicators to and from the community during the schematic design and design development phases of the project and participate in discussions that will lead to recommendations. The PAT concludes its work once construction begins.

All recommendations must be in alignment with the District's Educational Specifications and Design and Construction Standards.



# Hunters Creek Elementary School

## PAT Charge (continued)

The PAT will **reach a proposed recommendation through consensus**.

Any concerns identified by the PAT members should immediately be brought to the attention of the SBISD Project Manager.

These **recommendations will be presented** by the project's architects:

1. to the **Superintendent of Schools**, and based on approval from the Superintendent,
2. to the **Board of Trustees** for their approval.

**The Board of Trustees may act upon the recommendations developed with PAT input by approving, amending, altering or not approving all or any part of the recommendations.**



# Hunters Creek PAT Engagement Process

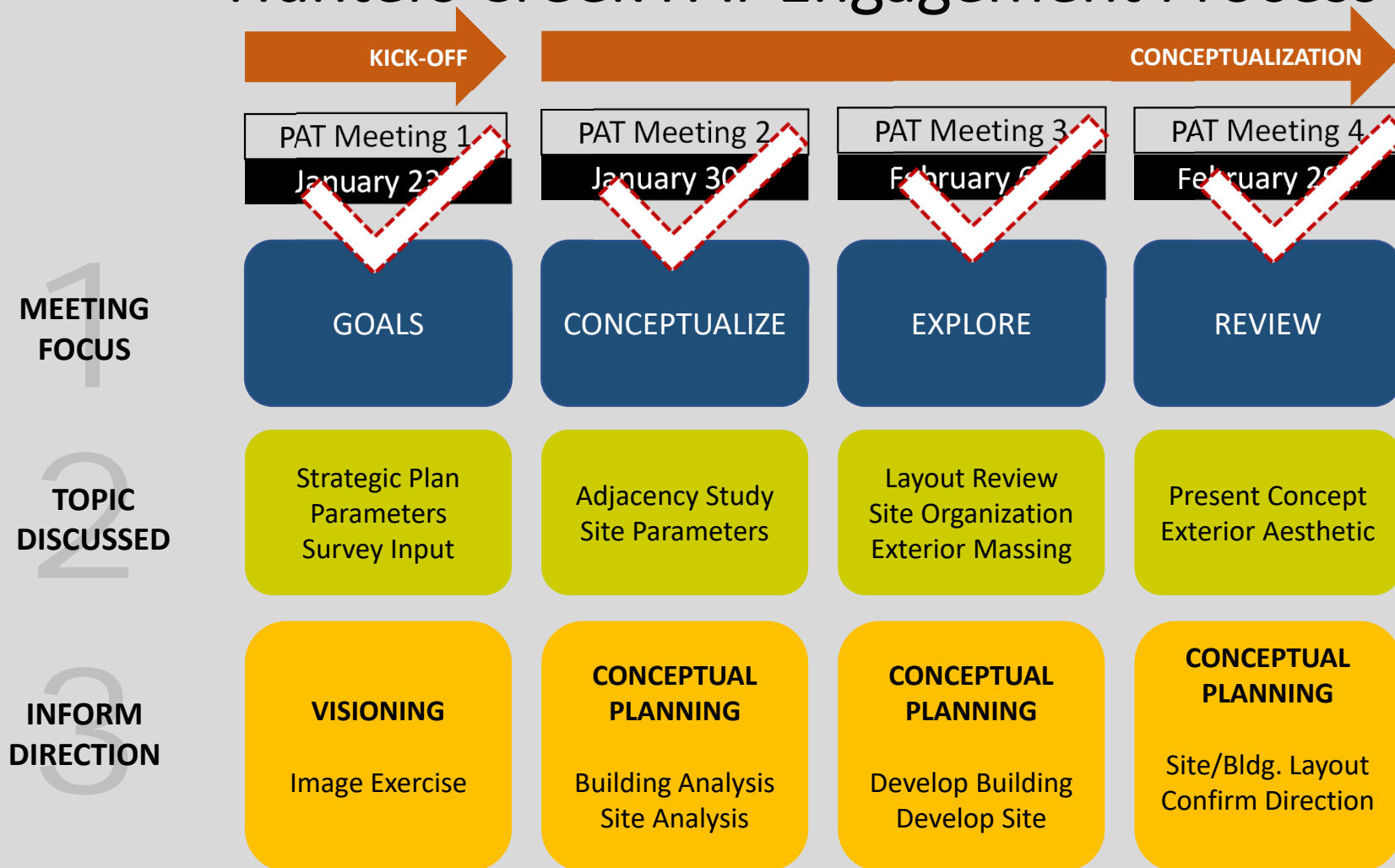

# Hunters Creek PAT Engagement Process

**1**  
MEETING  
FOCUS

**2**  
TOPICS  
DISCUSSED

**3**  
INFORM  
DIRECTION

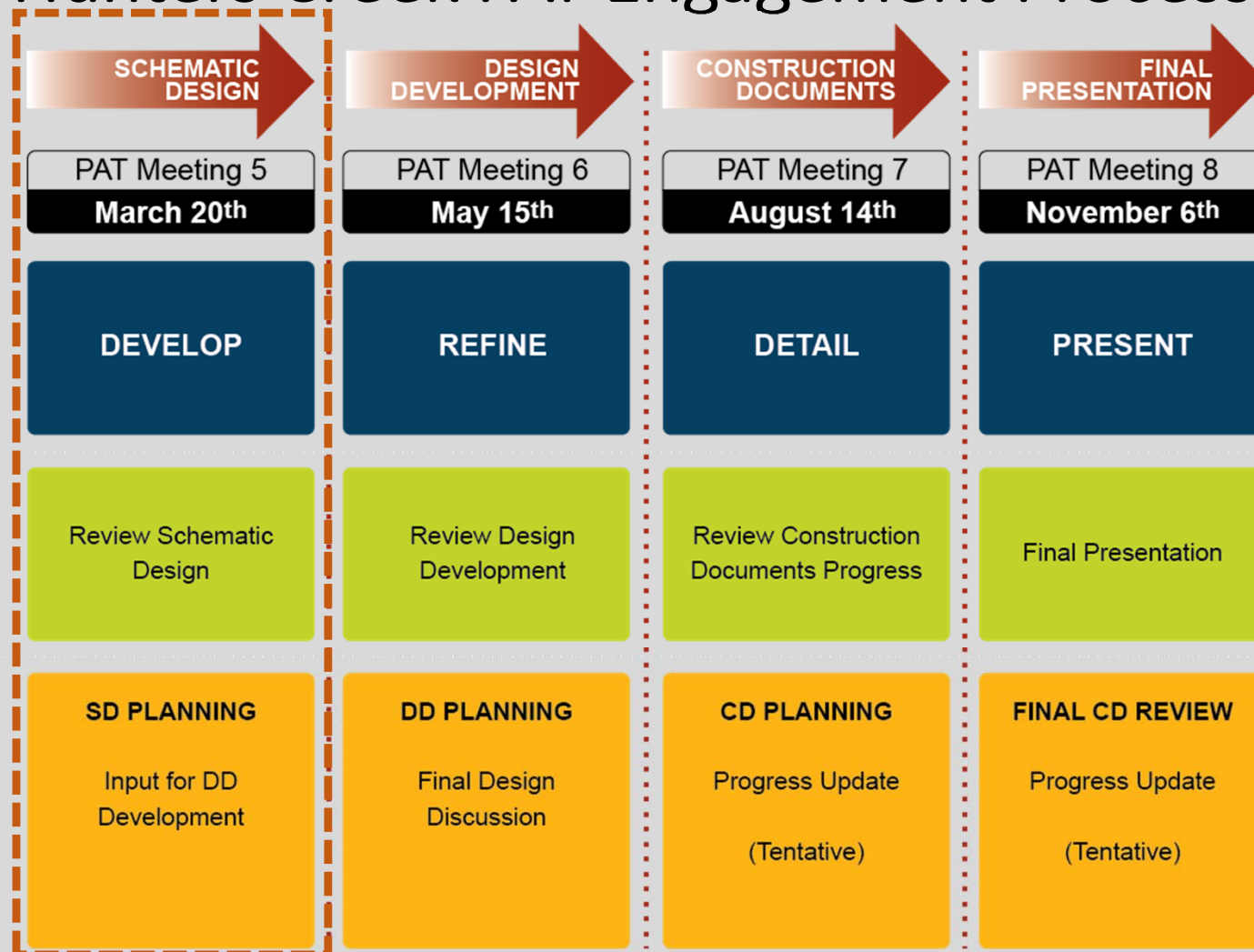

## Option 4 – Café & Gym

### What you liked:

- Connection from Courtyard to Play Fields
- Outdoor Dining Opportunities

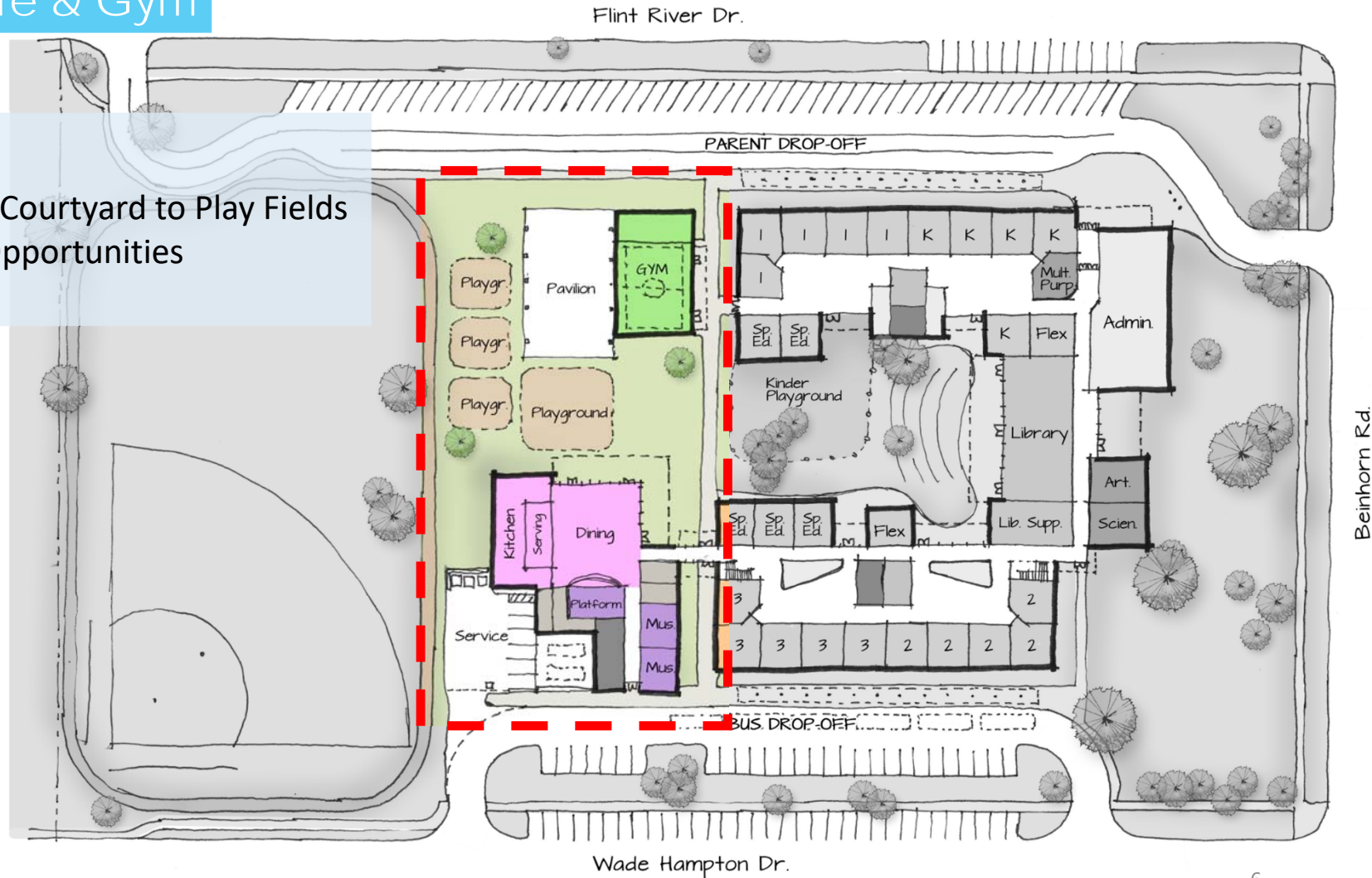



## Option 5 – Academics, Admin & Media

### What you liked:

- Setback off parent/bus drive, in scale with neighborhood, breaks up elevations
- Additional green space for landscape

### What could be improved:

- Location of Multi-purpose at Front Door
- Kinder Playground not accessible after hours to community
- Kinder/First Grades are not located near the Administration
- Front Door addressing Beinhorn Rd.

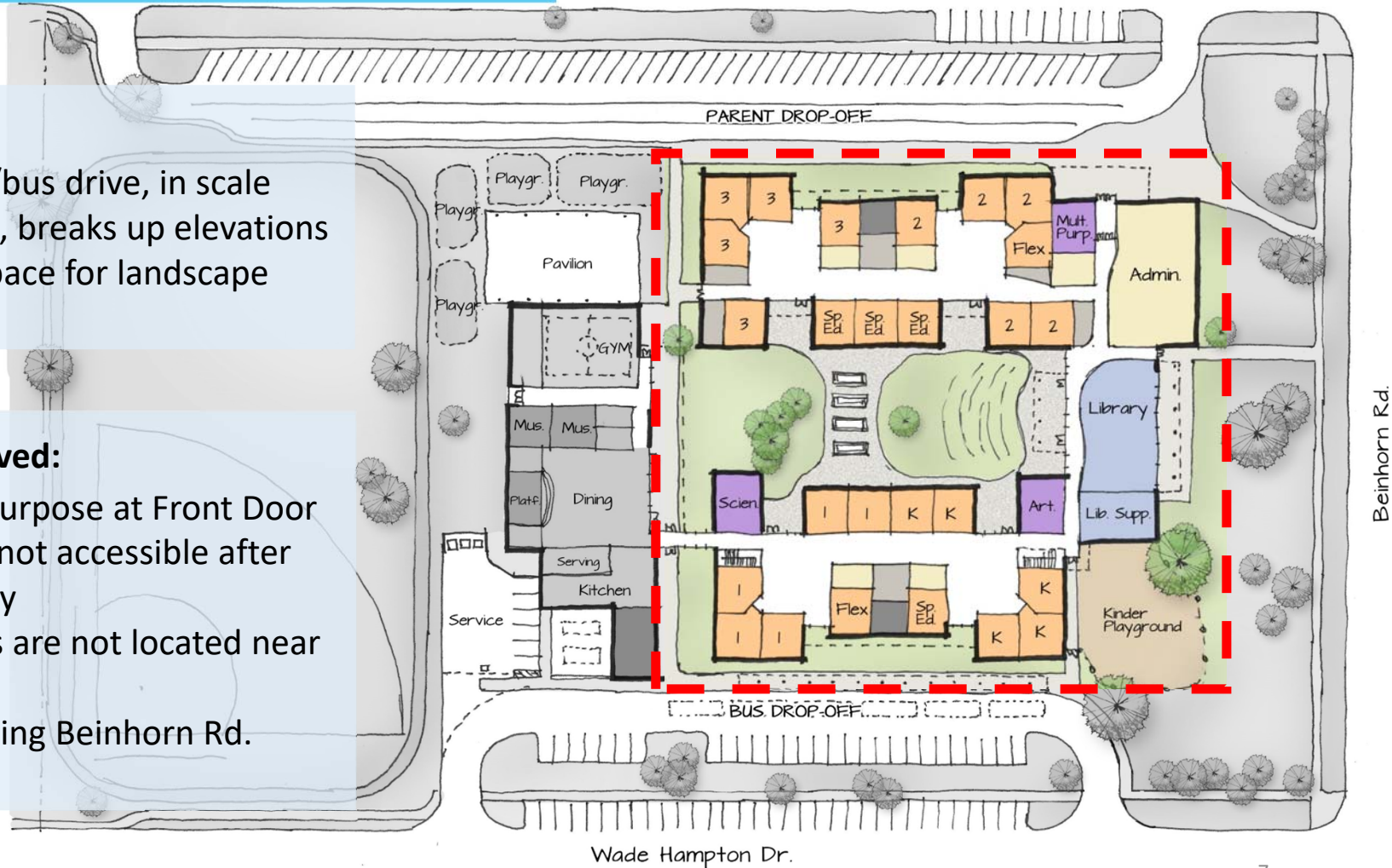

## Option 4/5 Hybrid

### What you liked:

- Connection of Courtyard to Play Fields
- Parent Drive exit onto Beinhorn

### What could be improved:

- Front Entry does not address Beinhorn
- Limited Visitor parking at front
- Entry drive cuts into Play Fields
- Eliminate head-in parking directly off Flint River Dr.
- Fire truck access to Courtyard is a challenge
- No overflow Dining expansion





## Refinement of Option 4/5 into Option 6

### Goals for Site:

- Maximize green space and preserve trees
- Provide Visibility/Connectivity
- Preserve existing Play Fields
- Improve Parking and Circulation Drives

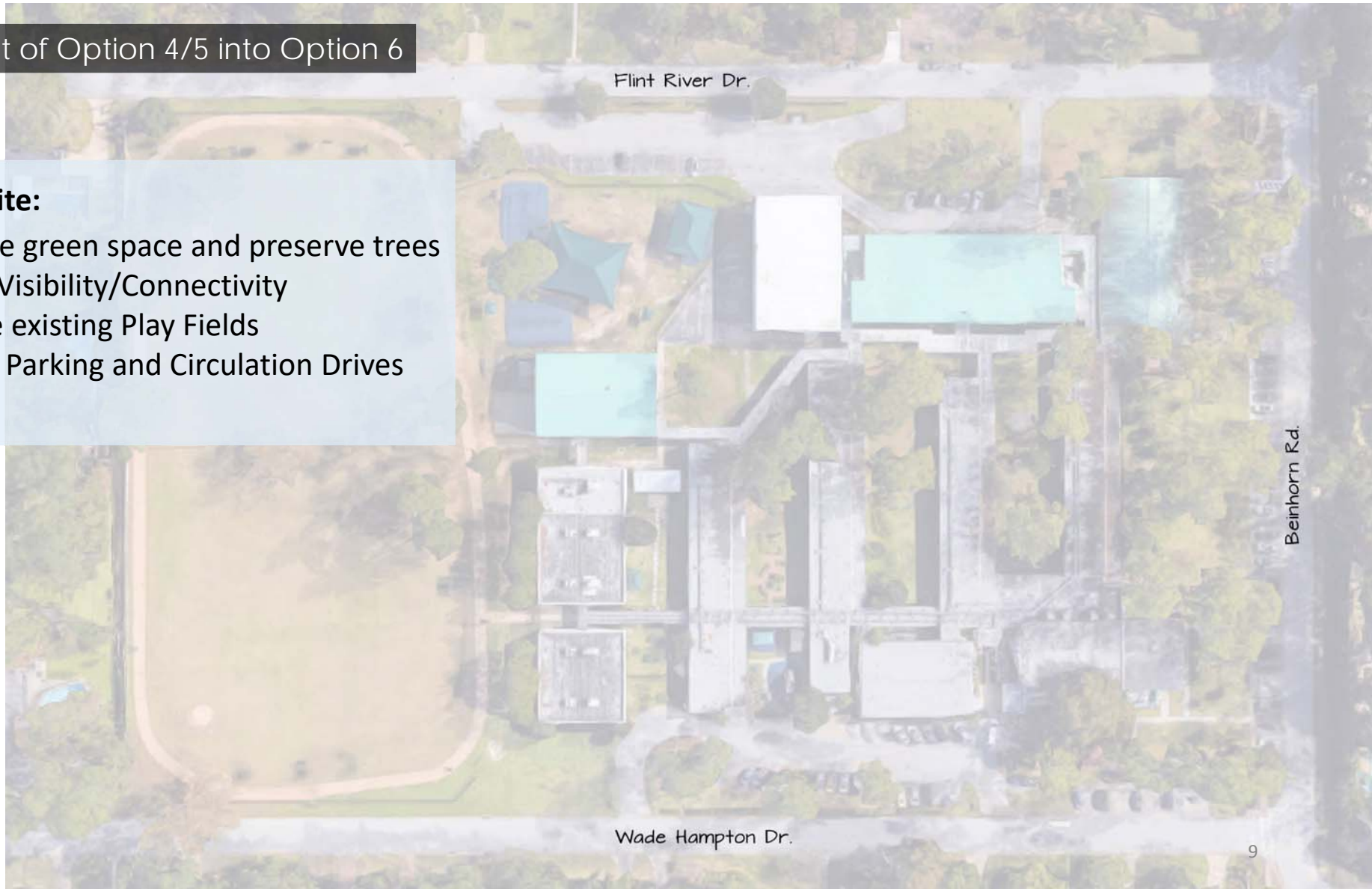

## Identifying "Heritage" trees – Option 6

### Goals for Trees:

- Preserve existing trees
- Buffer the school from Beinhorn Rd. with setback and trees





## Defining the School Entrance – Option 6

### Goals for Main Entry:

- Visibility/Identity from Beinhorn
- Main Entry addresses Beinhorn
- Provide Multi-purpose Room located off of secure entry vestibule

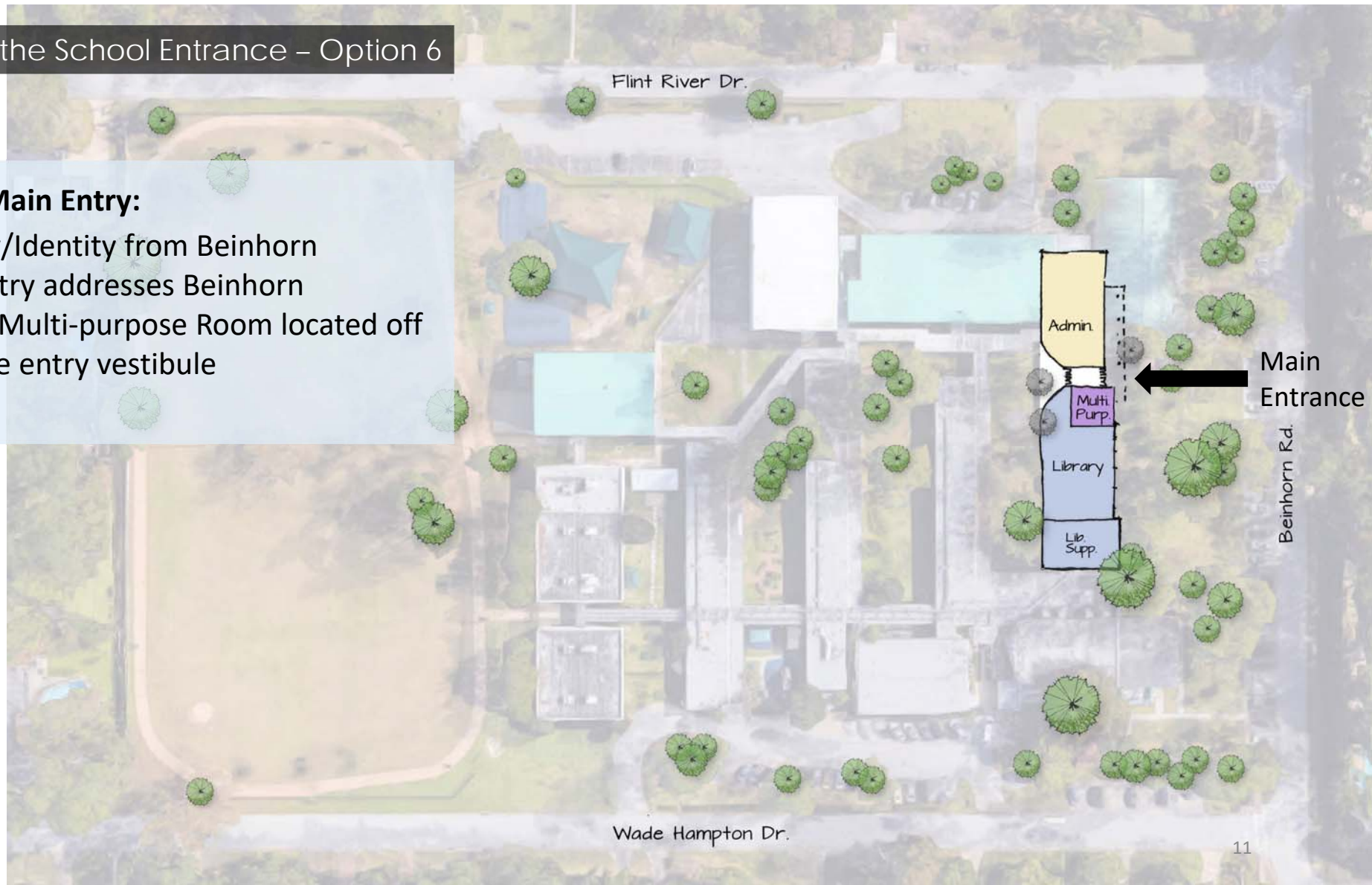

## Classroom Wing (Kinder & 1st) – Option 6

### Goals for K - 1<sup>st</sup> Classroom Wing:

- Located near Admin/Main Entry
- Interior Collaborative Space/Commons for each grade level
- Visibility and Access to Courtyard
- Grade Level support

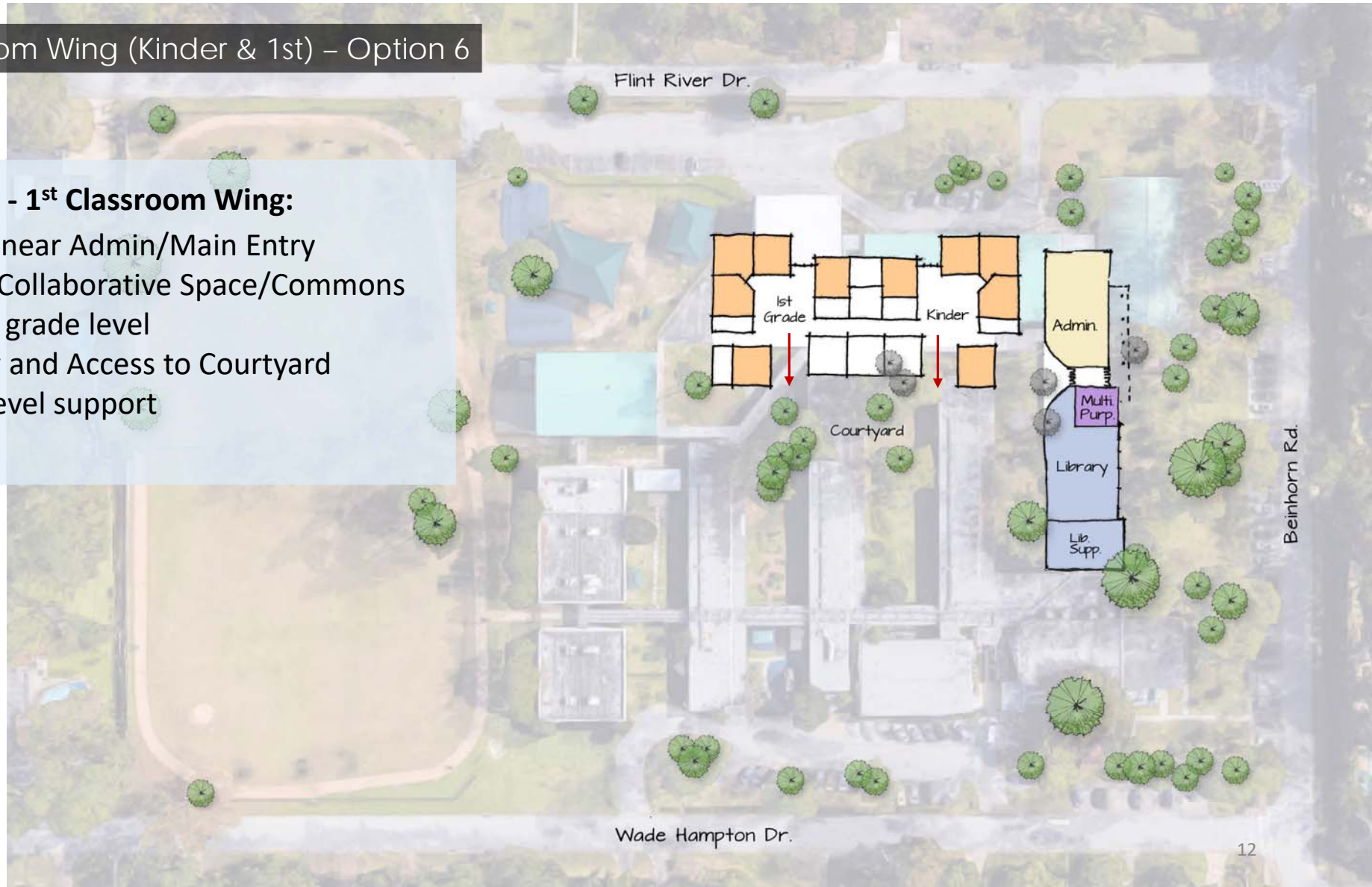



## Classroom Wing (Kinder & 1st) – Option 6

### Goals for K - 1<sup>st</sup> Classroom Wing:

- Located near Admin/Main Entry
- Interior Collaborative Space/Commons for each grade level
- Visibility and Access to Courtyard
- Grade Level support

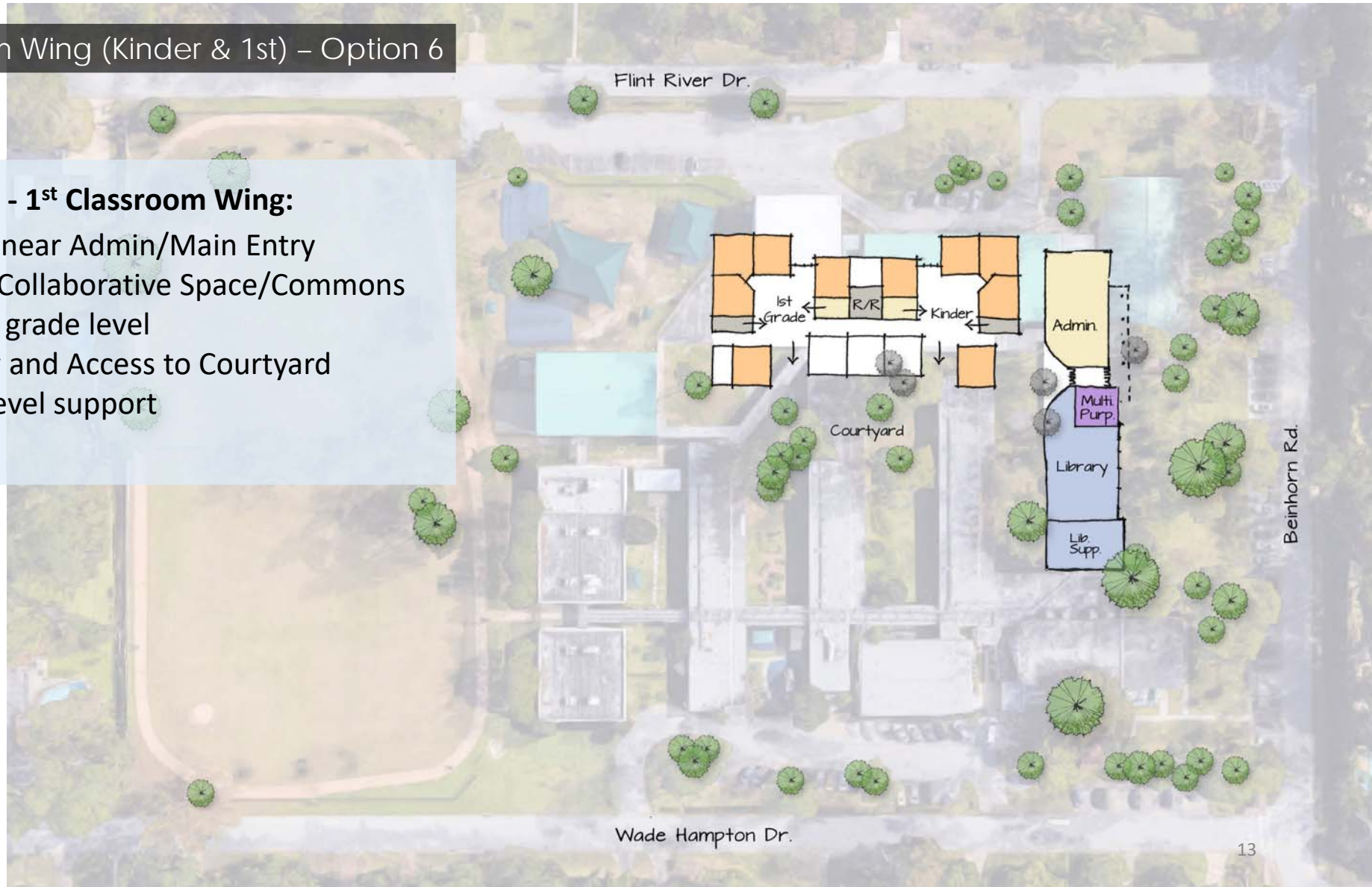



## Classroom Wing (2nd & 3rd) – Option 6

### Goals for 2<sup>nd</sup> – 3<sup>rd</sup> Classroom Wing:

- Interior Collaborative Space/Commons for each grade level
- Visibility and Access to Courtyard
- Grade Level support



## Classroom Wing (4th & 5th) – Option 6

### Goals for 4<sup>th</sup> – 5<sup>th</sup> Classroom Wing:

- Interior Collaborative Space/Commons for each grade level
- Visibility and Access to Courtyard
- Grade Level support

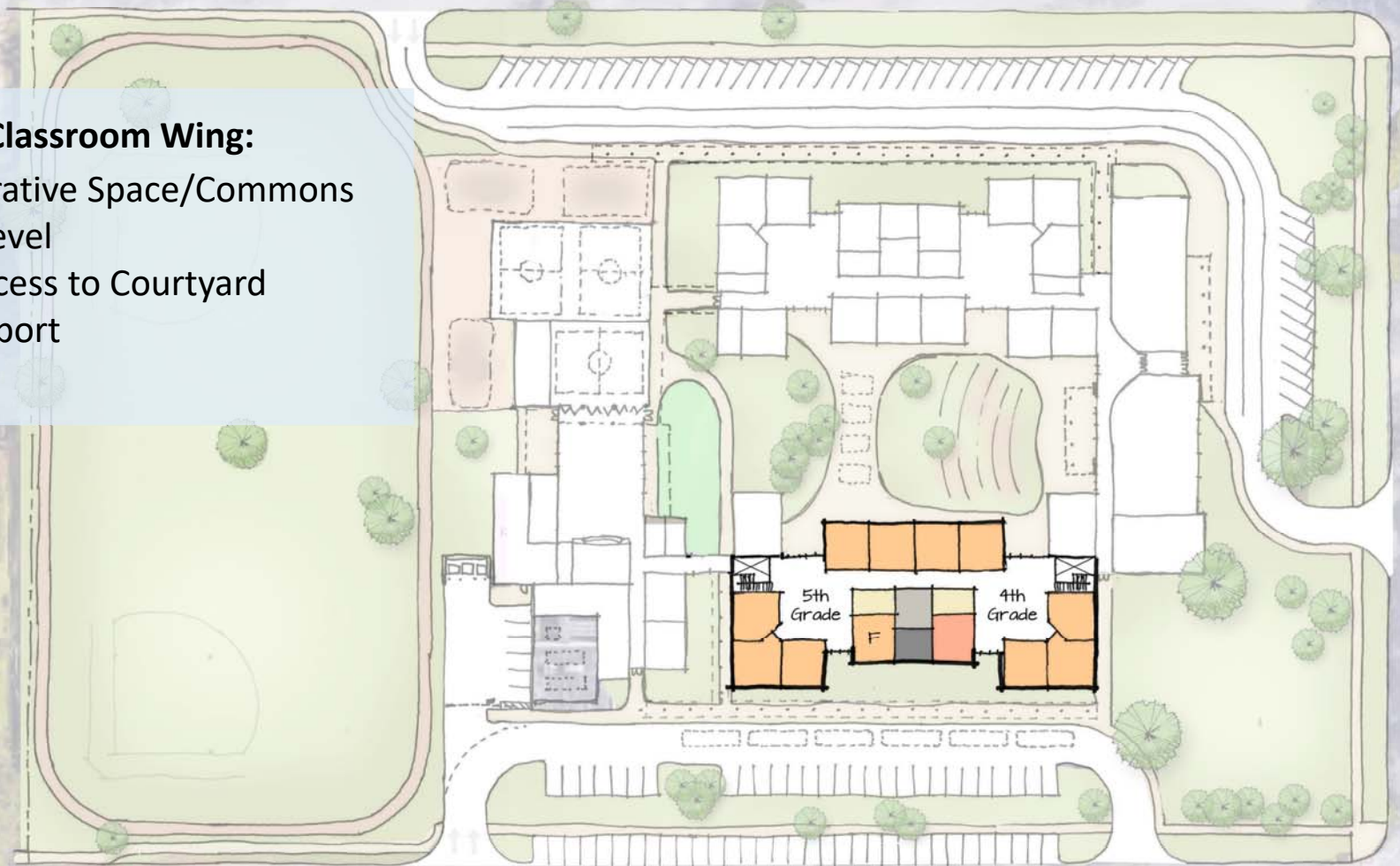



## Shared Spaces – Option 6

### Goals for Shared Spaces:

- Prime central location on Courtyard
- North light for Art Studio
- Exterior space for Art and Science
- Multi-purpose located at Front Door within secured vestibule

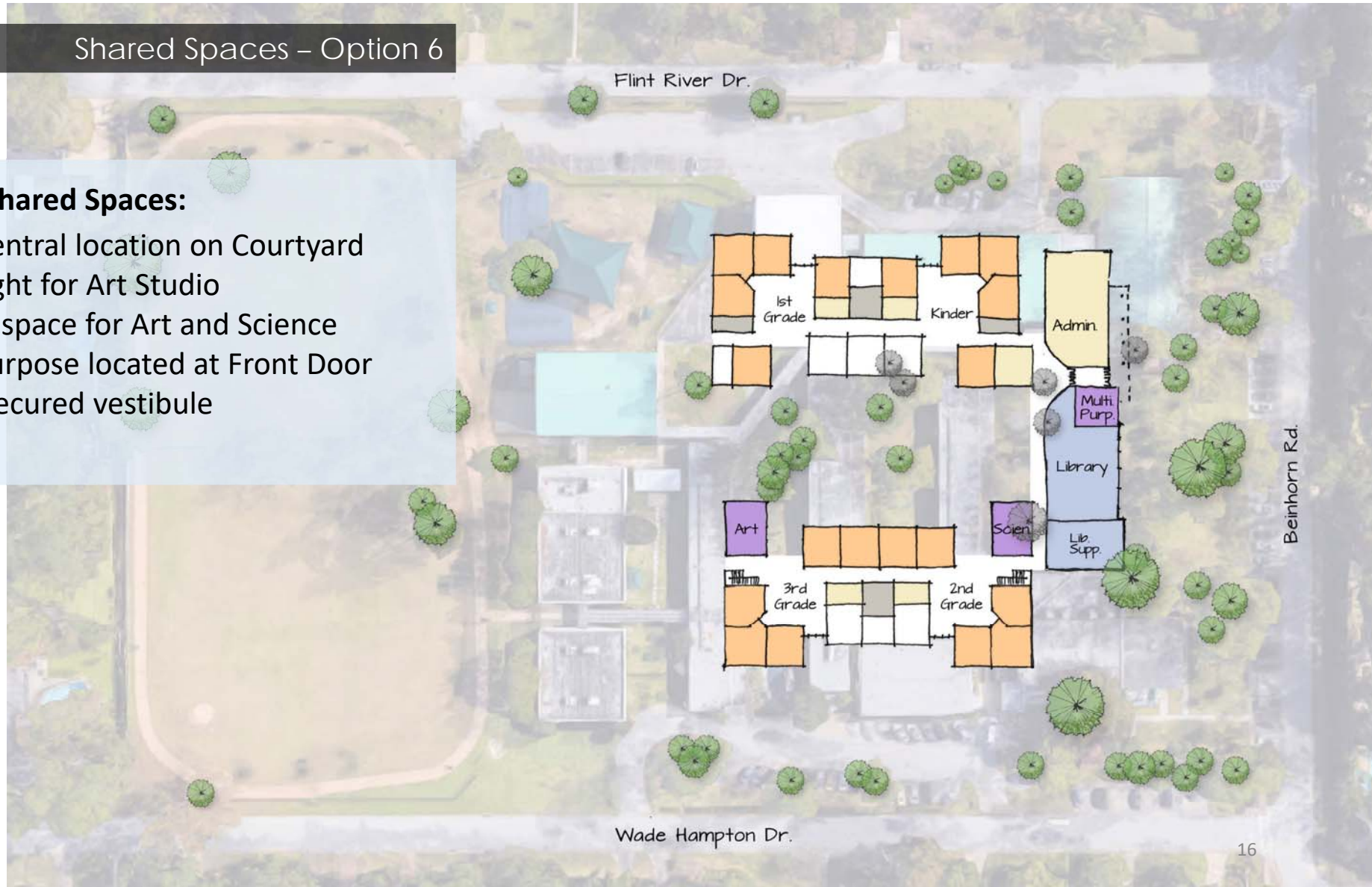

## Special Education – Option 6

### Goals for Special Education:

- Self-contained classrooms need to be located together
- Self-contained classrooms should be located near the clinic
- Resource classrooms should be distributed to grade level areas





## Gymnasium – Option 6

### Goals for Gymnasium:

- Maintain exiting Gym and save \$1M (PAT's second choice option); save only foundation and structure
- Provide connection from Courtyard to Play Fields
- Provide direct access from Gym to both the Pavilion and Play Fields

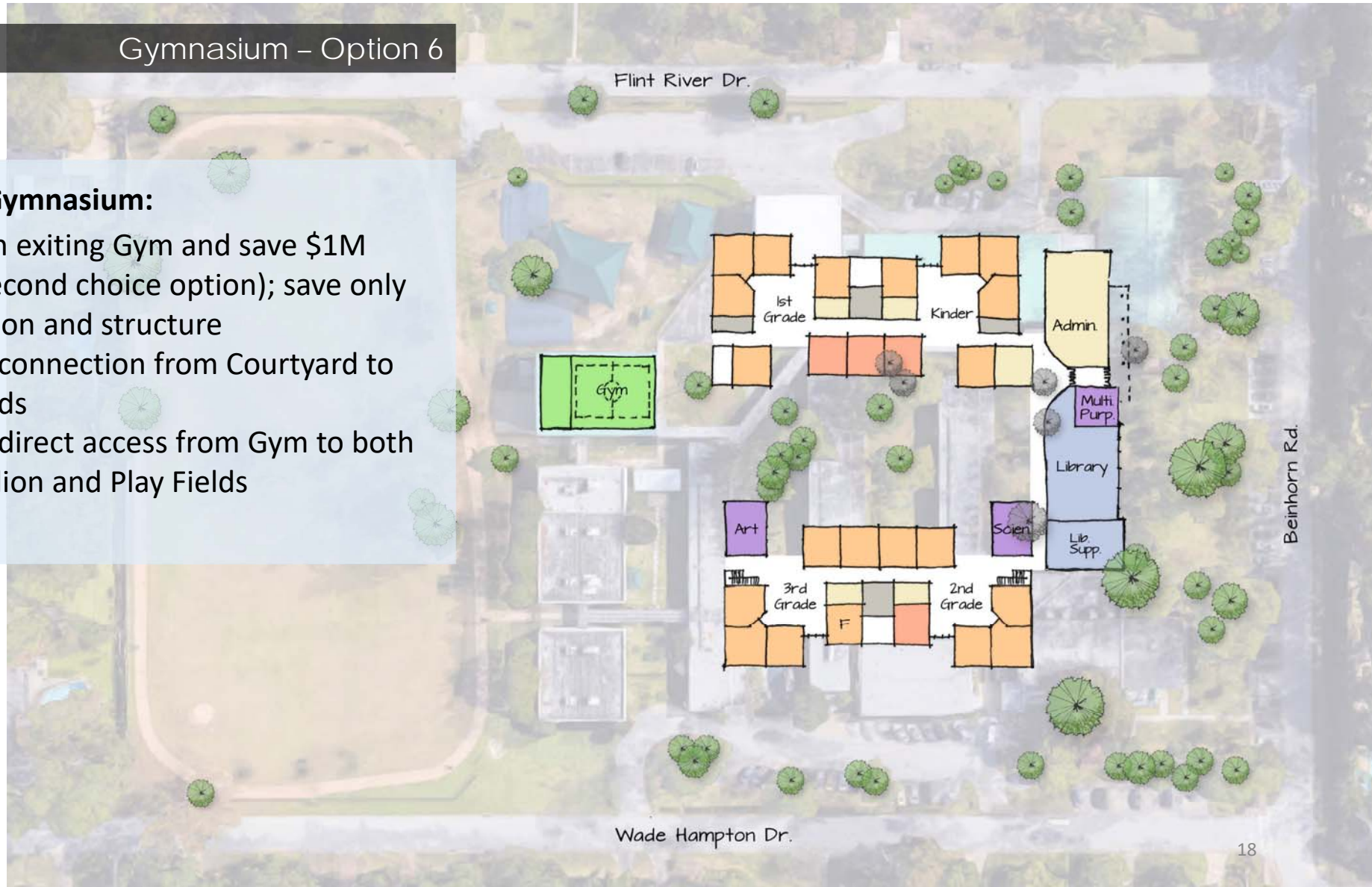



## Cafeteria – Option 6

### Goals for Cafeteria:

- Provide visual connection from Courtyard to Play Fields
- Provide opportunities for Outdoor Dining
- Provide for expansion of Cafeteria during large programs/events
- Provide for expansion of Gym during large programs/events
- Locate Music classrooms back of Stage for support

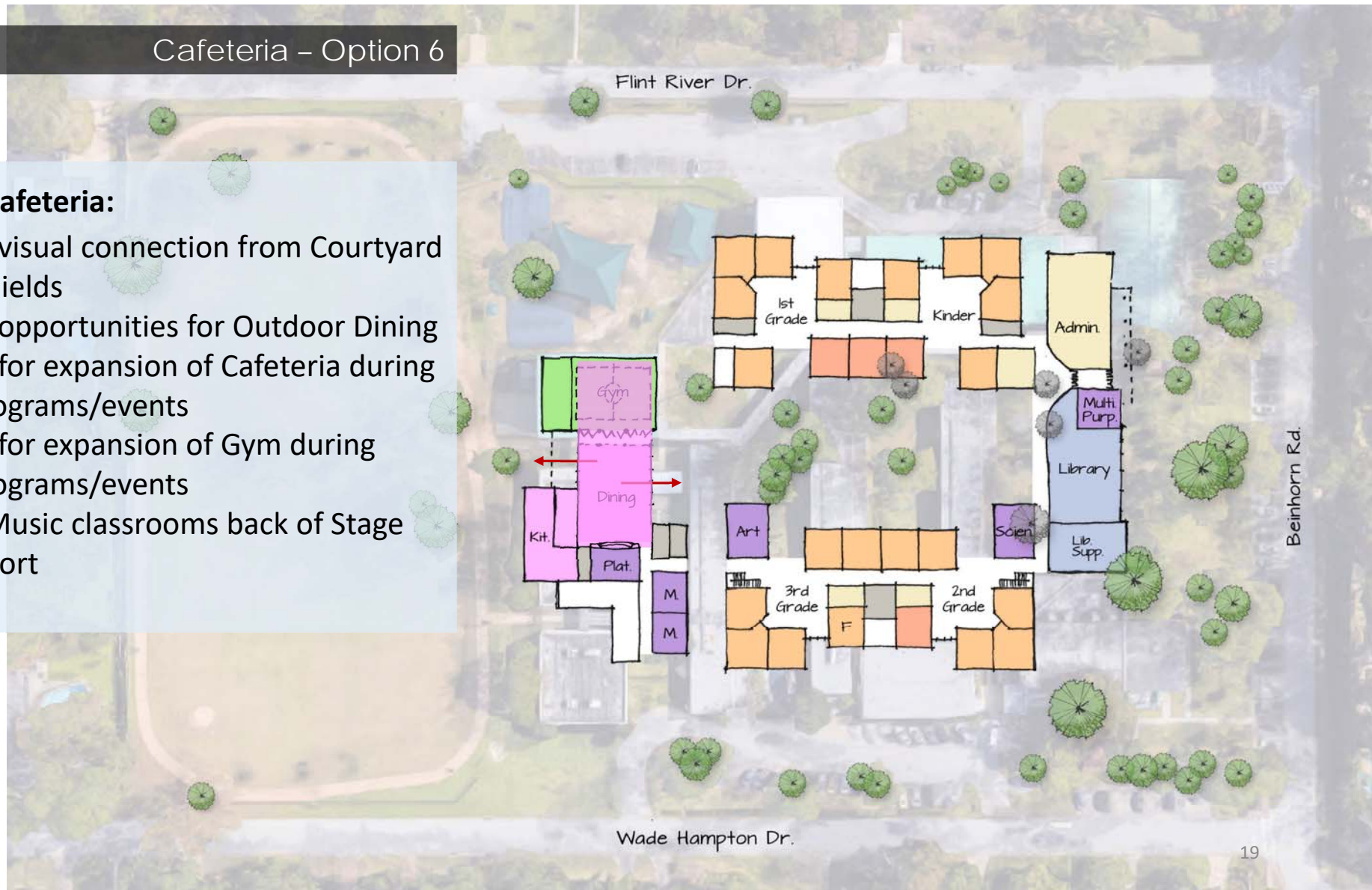

## Parent Drop-off – Option 6

### Goals for Parent Drop-off:

- Minimize impact to Play Fields and Walking Trail/Track
- Provide main drive exit onto Beinhorn
- Provide Front Entry onto Beinhorn and visitor parking at Front Entry
- Accommodate lots of space for queuing at drop-off and pick-up times

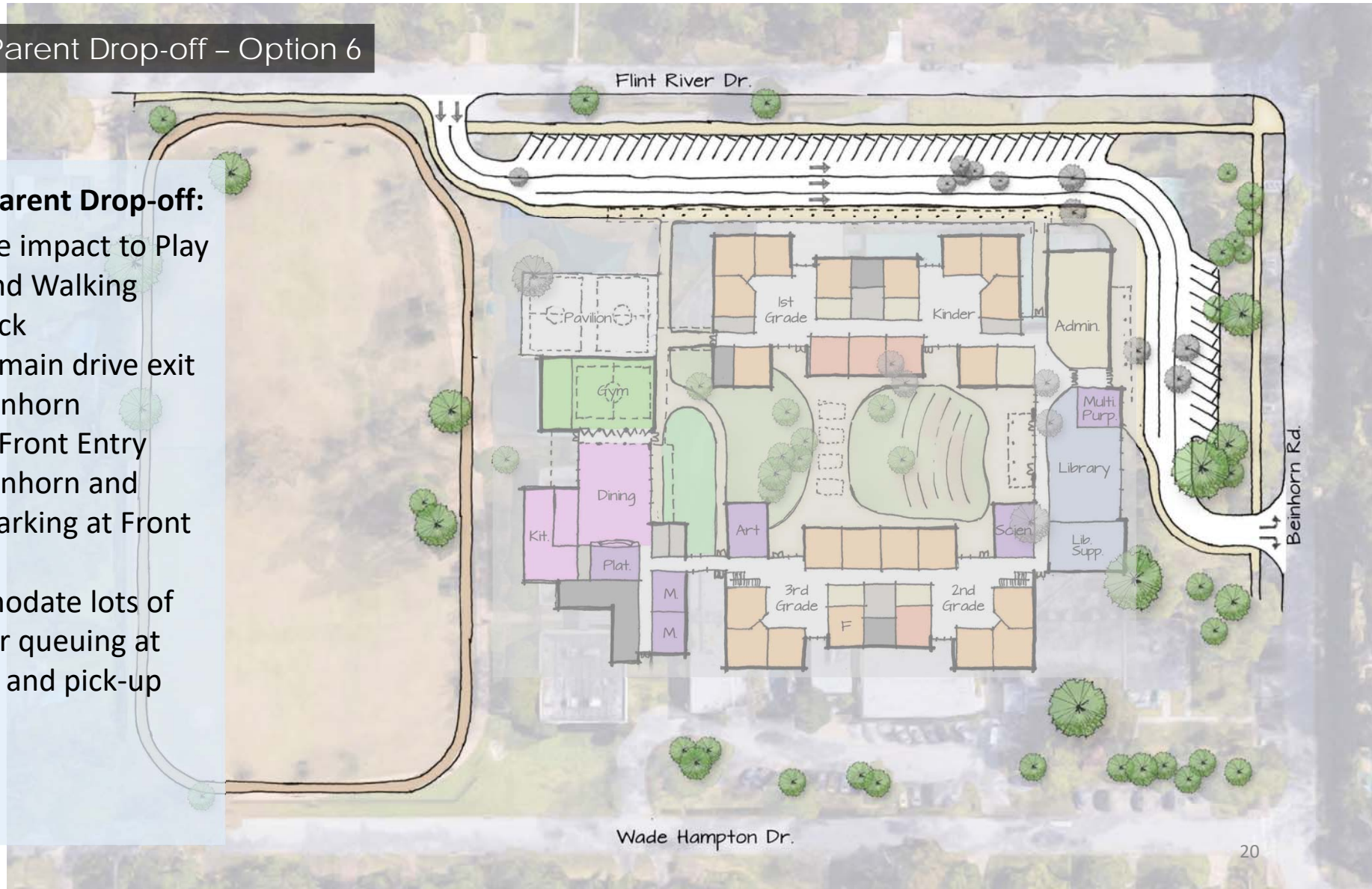



## Bus Drop-off – Option 6

### Goals for Bus Drop-off:

- Provide queuing space for buses and vans
- Provide buffer from Wade Hampton in trees and landscape
- Provide setback in building with additional landscape

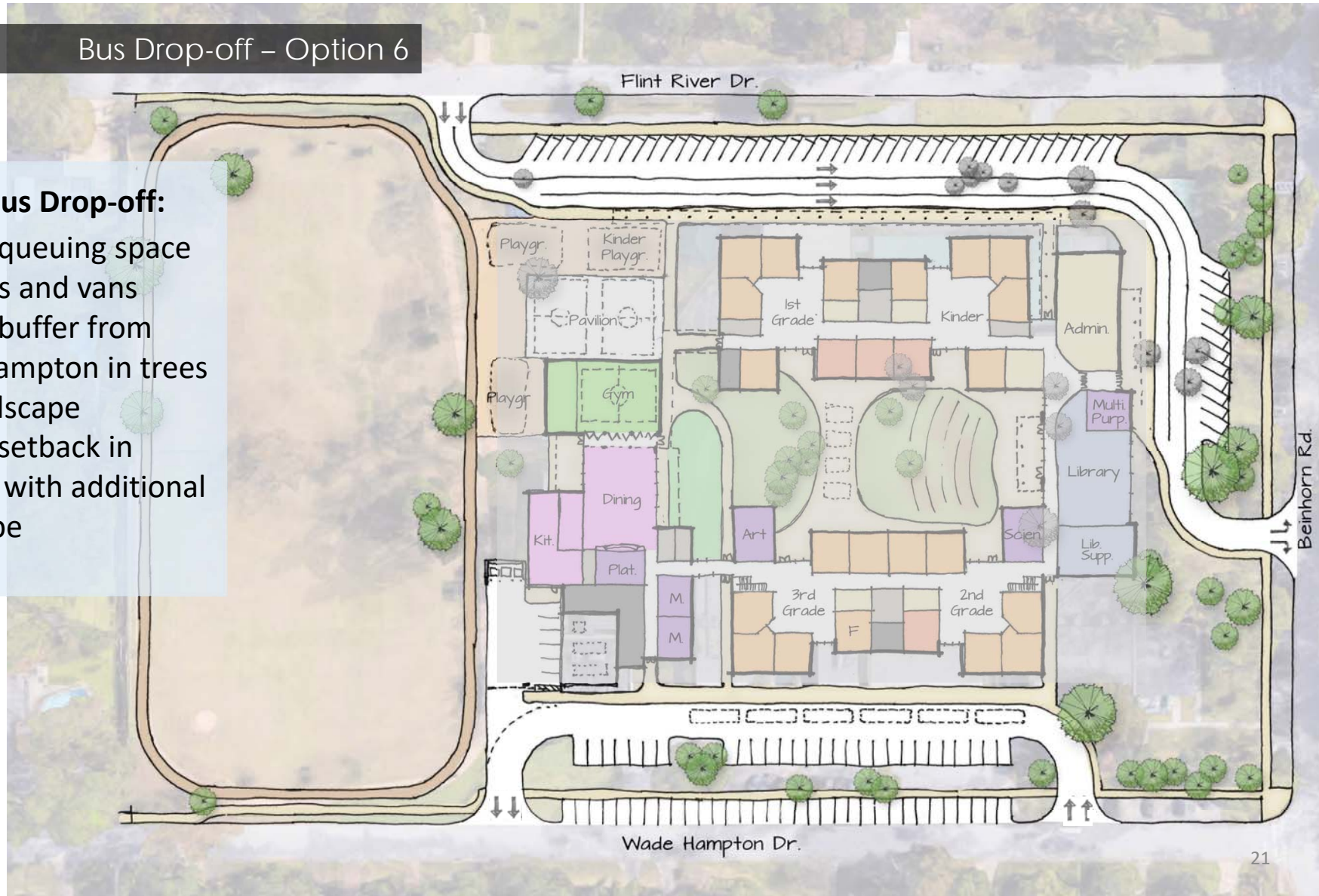

## Play Fields + Walking Trail – Option 6

### Goals for Play Fields:

- Maintain existing Play Fields and Walking Trail /Track
- Continue to provide after hours access to the community
- Secure the Play Fields during school hours

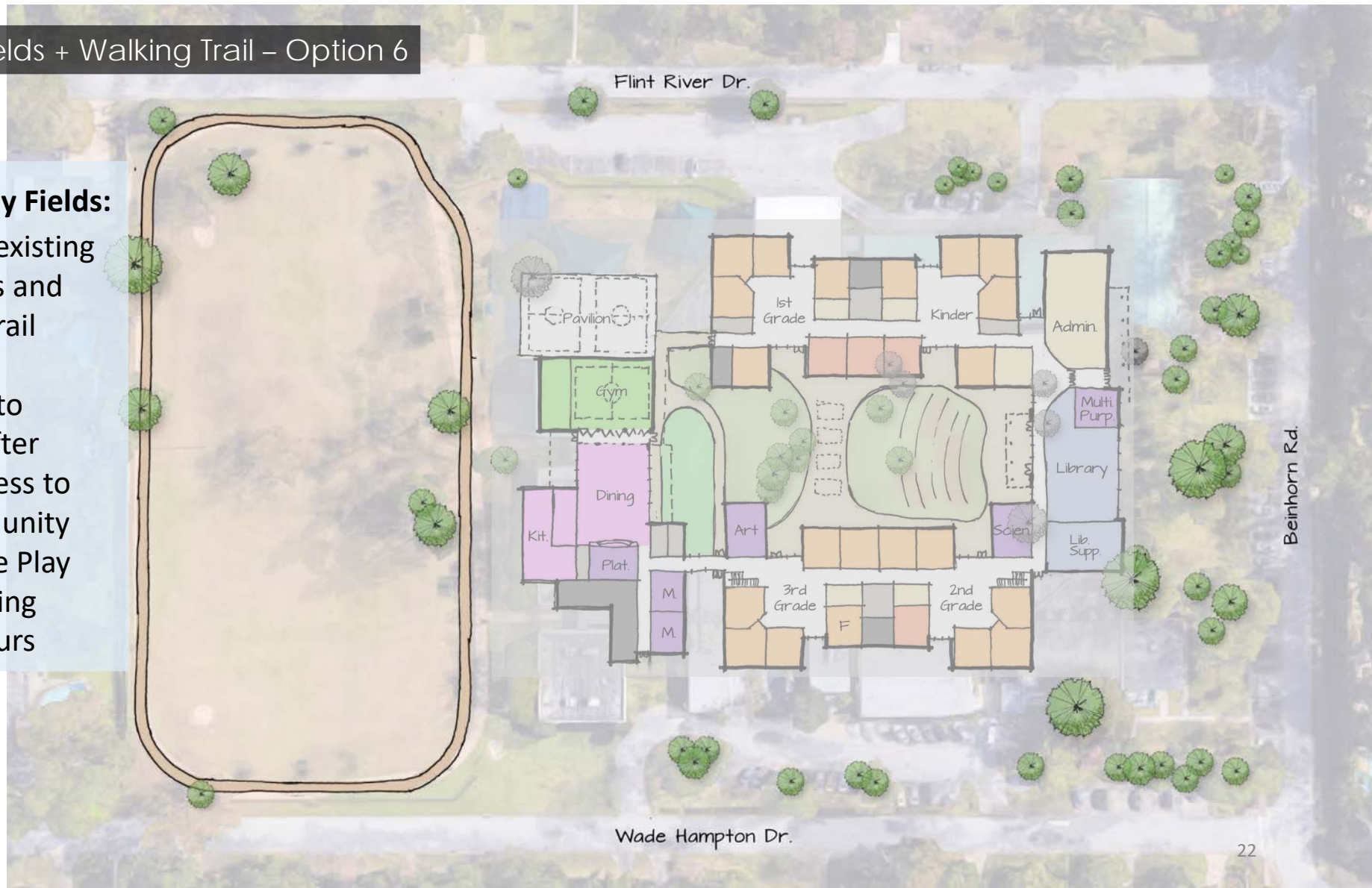



## Playgrounds – Option 6

### Goals for Playgrounds:

- Locate Kinder Playground close to Kinder – 1<sup>st</sup> classrooms
- Provide after hours access to the Playgrounds, Pavilion & Play Fields (a combined sports complex)
- Secure the Playgrounds and Pavilion during school hours

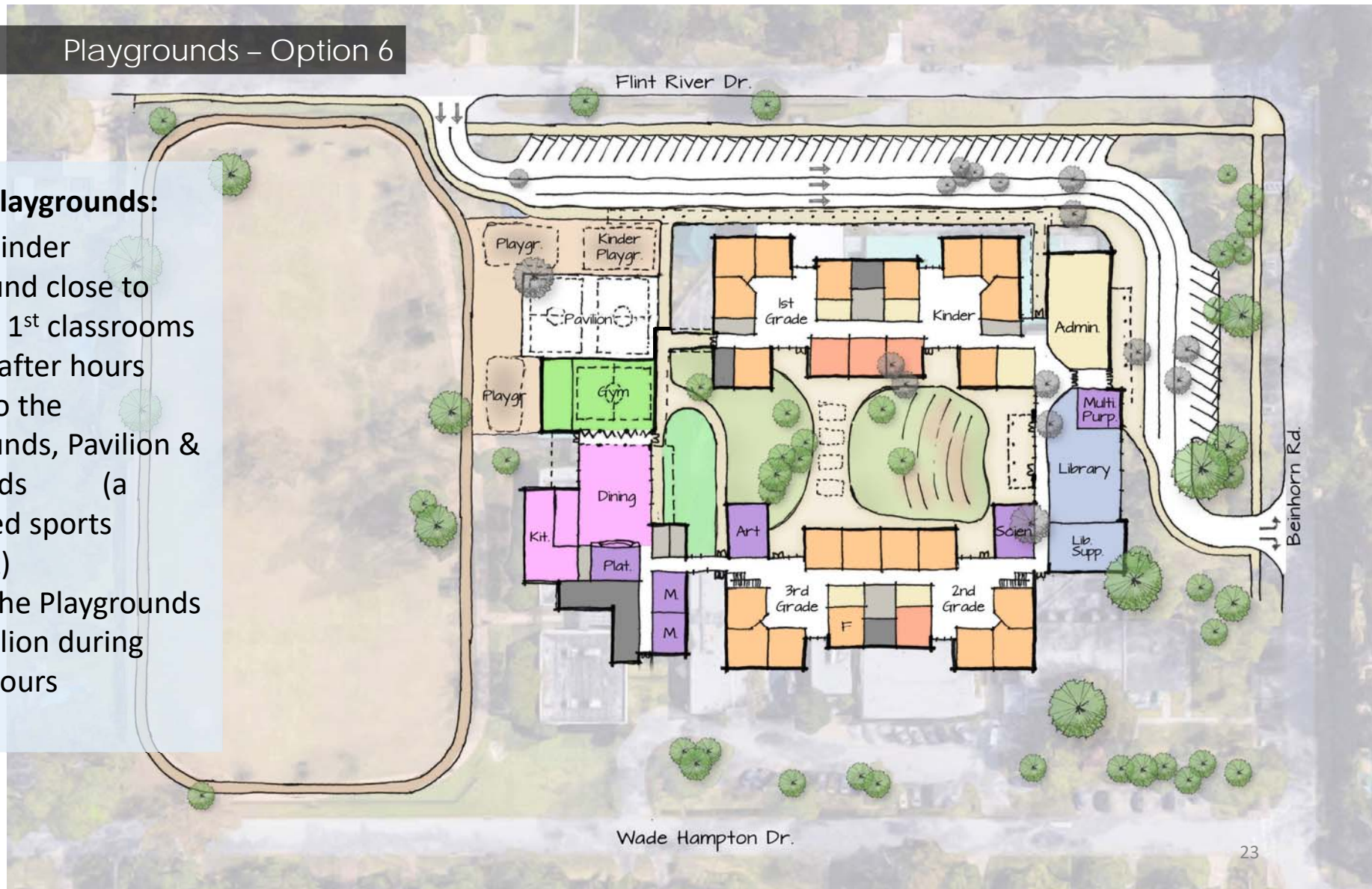



## Secured perimeter – Option 6

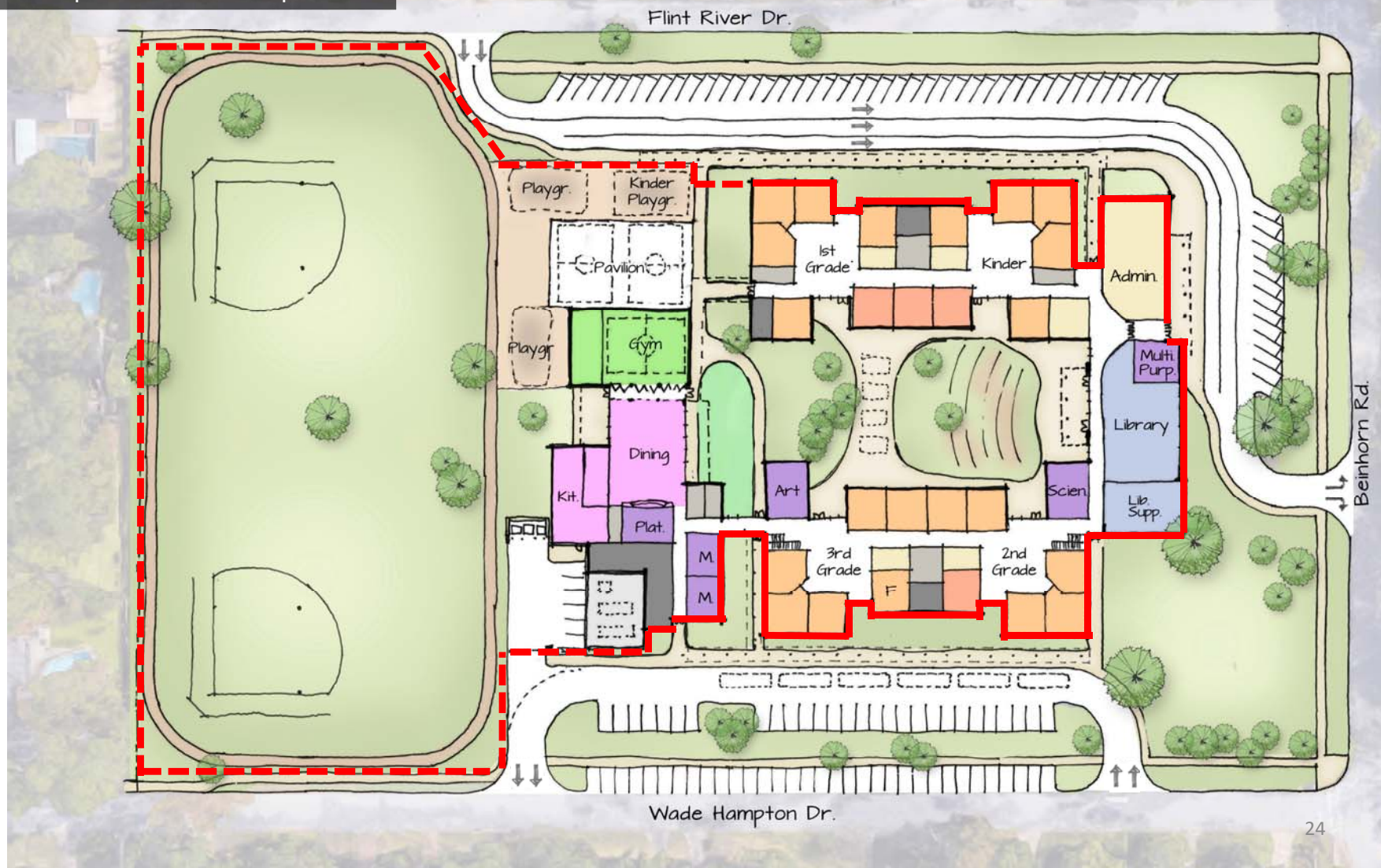

Front Entry – Option A





Beinhorn & Wade Hampton – Option A



Front Entry/Library – Option A





## Parent Drive – Option A





## Bus Drive – Option A





Beinhorn & Flint River – Option A





## Wade Hampton – Option A





Beinhorn Elevation – Option A



## Flint River Elevation – Option A





## Wade Hampton Elevation – Option A





Aerial – Option A





Front Entry – Option B





Beinhorn & Wade Hampton – Option B





## Parent Drive – Option B





## Bus Drive – Option B





Beinhorn & Flint River – Option B





## Wade Hampton – Option B





Beinhorn Elevation – Option B



## Flint River Elevation – Option B





Wade Hampton Elevation – Option B



## Site Section

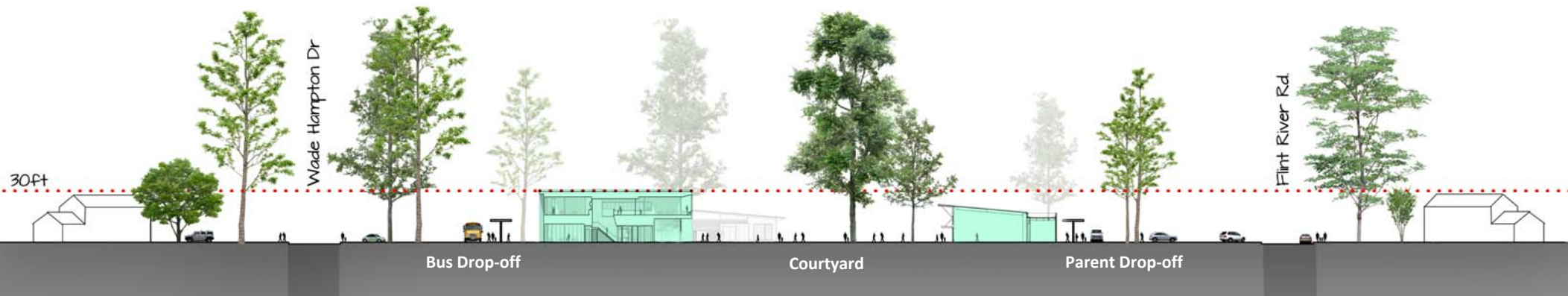
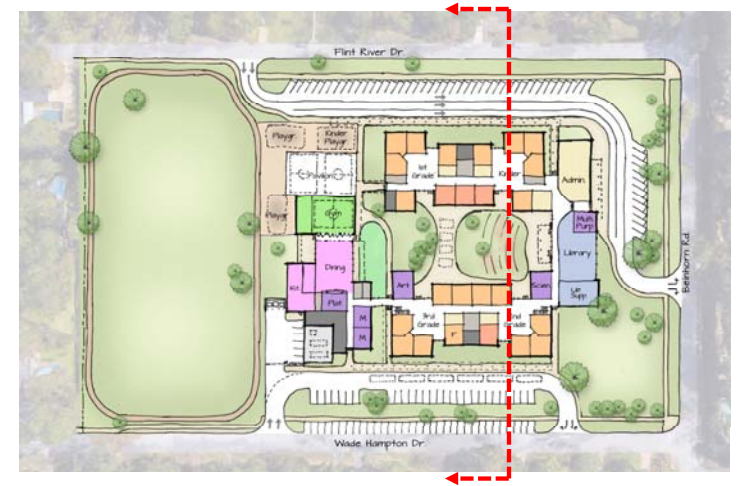



# Hunters Creek Elementary School

## Next Steps

PAT Meeting Schedule: all meetings are at 3:20pm at HCE

■ <b>Meeting #5</b>	<b>March 20, 2019</b>	<b>Schematic Progress Update</b>
■ Meeting #6	May 15, 2019	Design Development Update
■ Meeting #7	August 14, 2019	Construction Documents Update
■ Meeting #8	November 6, 2019	Final Review Presentation



## QUESTIONS?

**pfluger**