



CREATING AN INSPIRED SPACE FOR LEARNING & COMMUNITY





During any lunchtime at Aspen Academy, you can walk into our cafeteria space and be greeted with an explosion of laughter, expressions of joy, and engaging conversations about home and school. What you're really hearing are memories being made. After 90 minutes, the students depart; the space sits silent waiting for the next day.

This space can be so much more than a place kids go to have lunch. It can be the heart of Aspen Academy: changing the way we grow, learn, lead and providing more opportunities to connect, cultivate, and create community. We envision a space:

- Where our students can develop meaningful relationships and forge friendships that will last a lifetime;
- Where they will learn lifelong skills through increased educational opportunities;
- And, where our community can celebrate and connect.

"Food is not just fuel. Food is about family, food is about community, food is about identity. And we nourish all those things when we eat well." – Michael Pollan

**BUILDING
COMMUNITY**





TRANSFORMING LEARNING

Speech, Debate, & Performance

This space creates opportunities for showcasing a greater number of class projects, speech, debate, and performances. Having a smaller venue for speaking engagements will enable Aspen Academy to better accommodate grade-level events.

Proposed components: Stage lighting, acoustic panels and sound equipment to help us better hear our students, friends, and guest speakers.

Science & Mathematics

Growing gardens and the instructional kitchen provide students more opportunities to explore agriculture, nutrition, cooking sciences and space to grow, prepare, and cook food.

Proposed components: Outdoor raised and wall gardens and composting area; commercial refrigerator, freezer, stoves, and ovens.

Health & Wellness

Outdoor seating will be added, giving students more (much needed) time outside for al fresco dining and connecting. Inside, the space will bring the outdoors in, with increased natural lighting.

Proposed components: Outdoor seating space, and furnishings adjacent to the cafeteria; Sustainable recycling and trash system*; New, energy efficient HVAC system*.

Community Strength & Service

Great memories are shared around a table. Our community is filled with amazing people and this space enables us to share with one another even more, engaging in potlucks, cultural events, and community celebrations.

Proposed components: commercial kitchen and serving islands.

*Critical elements to support Green Ribbon School application



STAGE

Total Sponsorship: \$30,000

Stage Lighting
Acoustic Panels
Sound System
Video Panels

INDOOR

Total Sponsorship: \$75,000

Natural Lighting & Windows
Additional Exits
Energy-efficient HVAC
LED Lighting
Fans

OUTDOOR

Total Sponsorship: \$75,000

Outdoor Gardens
Wall Gardens
Picnic Tables
North Patio
South Patio

KITCHEN

(see adjacent)

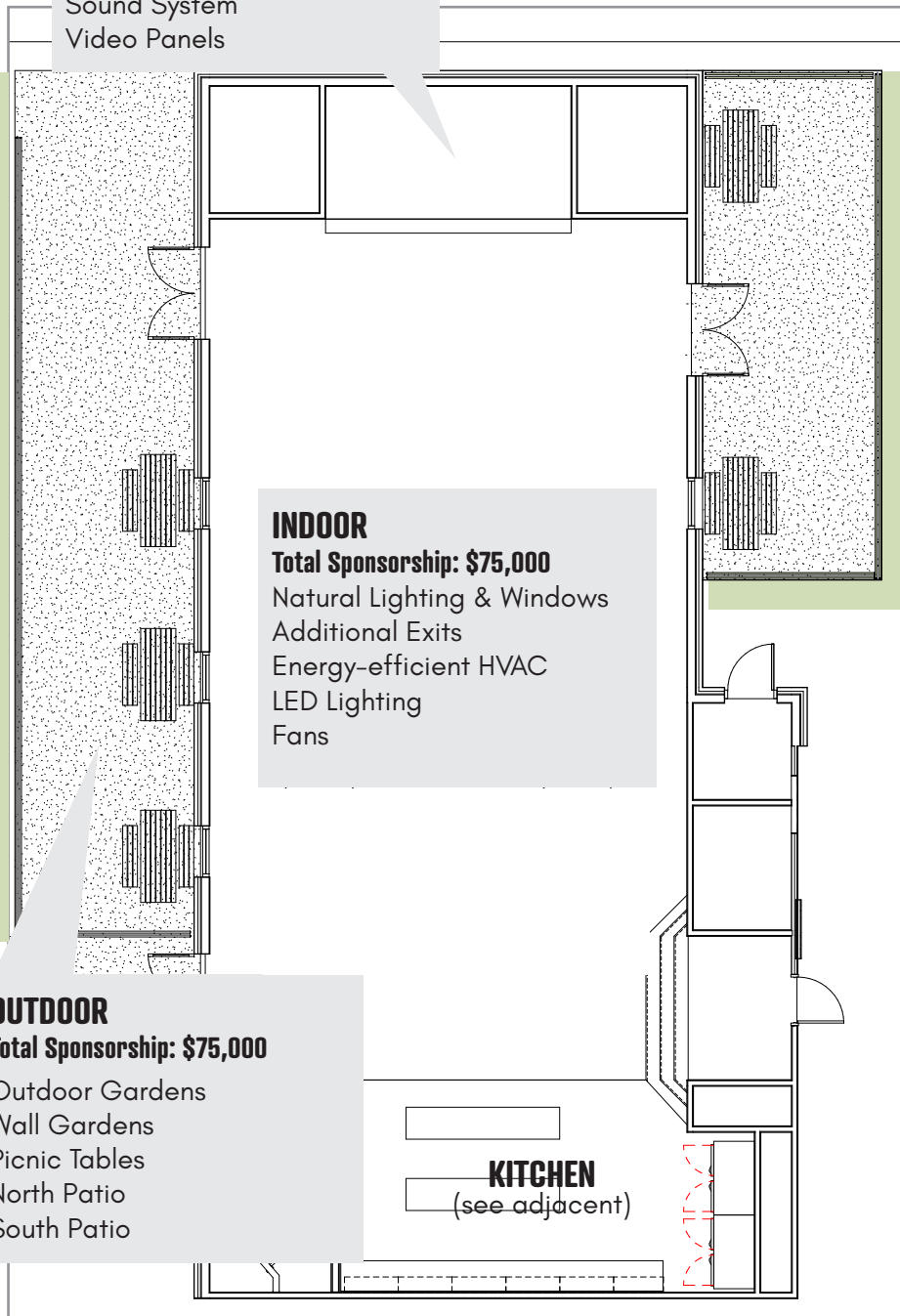

"I think most people would agree that **the kitchen is the heart of the home.** In fact, in most homes the kitchen wears many hats—it's the center of the family team huddle, the place for bantering with friends, the computer room, an entertainment center, a children's art museum and let's not forget its original purpose—a place to enjoy good food with family and friends.

This should be no different at Aspen. I'm truly excited for the creation of a space that will not only improve the everyday life of students but enhance opportunities to learn about food access and preparation.

Couple that with vast opportunities for fostering community support, engagement and potential for new business revenue we can't underestimate the impact a project like this would have for the families and the school for many years to come."

- James Park, CEO Garbanzo Mediterranean Fresh, Aspen Academy Trustee & Parent

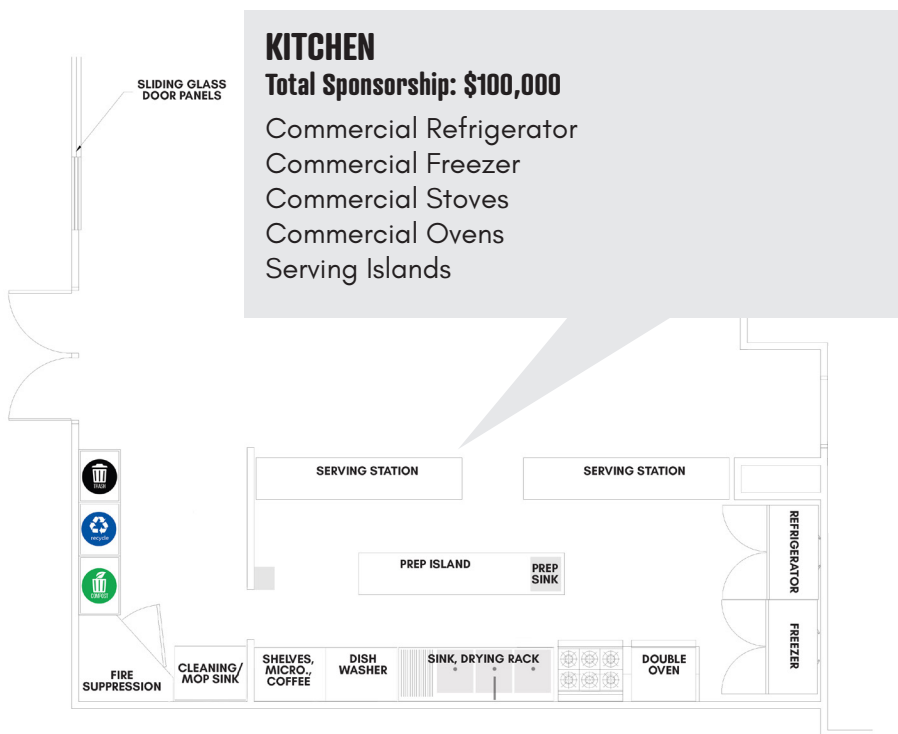

"The kitchen is a special place: a place where, often without planning it, memories and new traditions are created; and cookbooks are passed on. **The kitchen is a wonderful place for children. It serves as the arena in which they learn not only the how tos of cooking but develop the confidence and sense of pride that come from making something for others.**"

- Kathleen Harper, Kindergarten Instructor,
Student Leadership & Entrepreneurship Coach



Rendering of North Patio, including entrance, outdoor seating, wall gardens and growing gardens.

DESIGN IDEAS

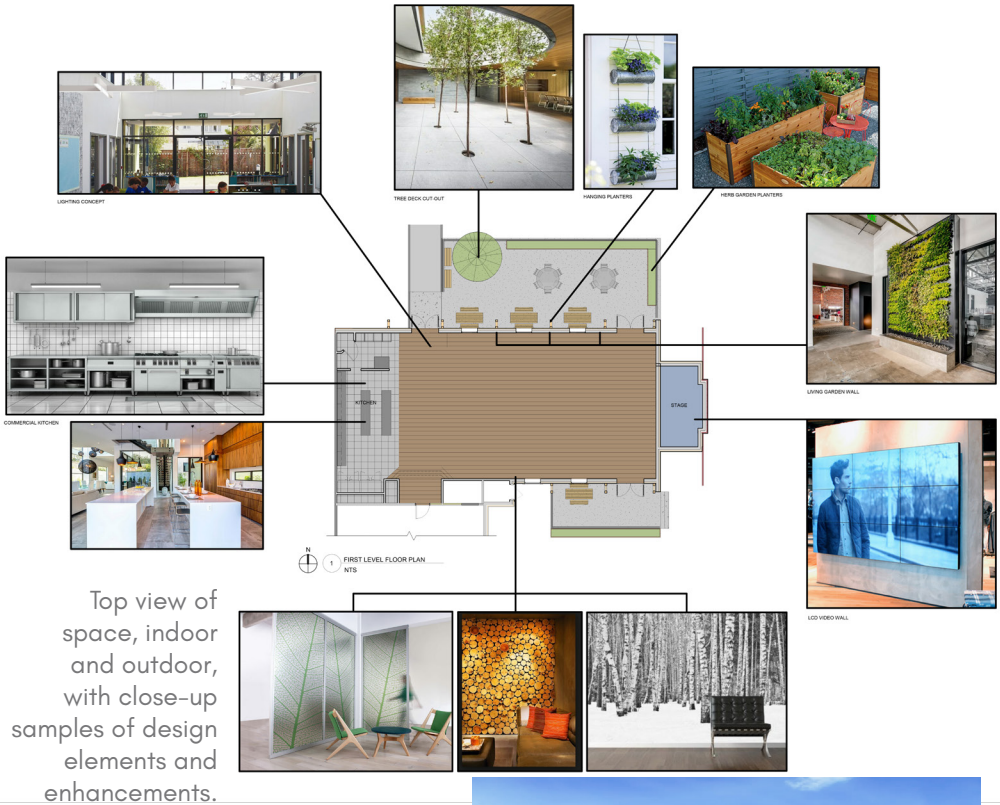

Elevation drawing of North Patio, including entrance, outdoor seating, and growing gardens.



Support the vision, contribute today!

Contact Trevor Garrett, Development Manager
303-346-6500, Ext. 111 | trevor.garrett@aspenacademy.org