

FURNISHINGS SPECIFICATIONS:

PROJECT:

FURNISHINGS AT:

BOULAN PARK MIDDLE SCHOOL ADDITION – 13170  
LARSON MIDDLE SCHOOL ADDITION – 13171

2013 BOND PROGRAM  
BID PACKAGE #6

OWNER:

TROY SCHOOL DISTRICT  
4400 Livernois  
Troy, MI 48098

TMP PROJECT NO.:13170 & 13171

DATE: June 9, 2015

ISSUED FOR BIDS

ARCHITECT

TMP ARCHITECTURE, INC.  
1191 West Square Lake Road  
Bloomfield Hills, Michigan 48302-0374

PH (248) 338-4561  
FX (248) 338-0223  
Email [info@tmp-architecture.com](mailto:info@tmp-architecture.com)

TABLE OF CONTENTS

TITLE PAGE

TABLE OF CONTENTS

BID REQUIREMENTS

001113-F	Advertisement for Bids
002113-F	Instructions to Bidders
004113-F	Bid Proposal Form
007000-F	General Conditions
	Prevailing Wages
008050-F	Contractor Code of Conduct
013300-F	Submittal Procedures

INFORMATION AVAILABLE TO BIDDERS

Availability of Electronic Files

FURNISHING SPECIFICATIONS

SPECIFICATIONS

Bid Category A:	Hon
Bid Category B:	Bailey Manufacturing Co.
Bid Category C:	Peter Pepper

LIST OF DRAWINGS

A12.1	Furniture Floor Plan – Boulan Park Middle School – 13170
A12.1	Furniture Floor Plan – Larson Middle School – 13171

\*\*END OF SECTION\*\*

ADVERTISEMENT FOR BID

Notice is hereby given that sealed bids will be received by Troy School District, 4400 Livernois, Troy, MI 48098 for:

2013 BOND PROGRAM  
BID PACKAGE #6  
BOULAN PARK MIDDLE SCHOOL ADDITION &  
LARSON MIDDLE SCHOOL ADDITION  
FURNISHINGS

Proposals are to be submitted in accordance with contract documents prepared by TMP Architecture, Inc. 1191 W. Square Lake Road, Bloomfield Hills, Michigan 48302-0374 dated June 9, 2015.

1. DOCUMENT AVAILABILITY

- A. Bidding Documents will be available for examination and distribution on or after **June 9, 2015**. Examination may be made at the Office of the Architect, TMP ARCHITECTURE, INC., or the CONSTRUCTION ASSOCIATION OF MICHIGAN (CAM), Bloomfield Hills, MI.
- B. Qualified Bidders may obtain bidding documents via email from the Architect's office, consisting of one (1) set of Drawings and Specifications.

2. DUE DATE

- A. Bid Proposals will be received until the time and the place, as follows, where and when they will be publicly opened and read aloud.

Date and Time: June 23, 2015, at 1:30 P.M.

Place: Troy School District Operations Building  
1140 Rankin  
Troy, MI 48083

3. GENERAL INFORMATION

- A. Bidder shall agree not to withdraw Bid Proposal for a period on ninety (90) days after date for receipt of bids. A 5% bid bond is required in accordance with the Section 002113-F - Instructions to Bidders (See Page 002113-F-1, Paragraph 2.G.).
- B. Accepted Bidder shall be required to enter into a contract with Troy School District and furnish satisfactory Performance Bond in accordance with the Section 002113-F - Instructions to Bidders. (See Page 002113-F-3, Paragraph 3.H.).
- C. The Owner reserves the right to accept or reject any or all Bids in whole or in part, or to waive any informalities therein. If in the Owner's opinion it is in their best interest, the contract may be awarded to other than the lowest bidder, for reasons of establishing uniformity, delivery time, etc.
- D. Accepted bidder shall be required to provide temporary furniture of similar style and performance if specified furniture can not be delivered by the install date mentioned in this document.

\*\*END OF SECTION\*\*

INSTRUCTIONS TO BIDDERS

1. PROJECT LOCATION

- A. Boulan Park Middle School  
3570 Northfield Parkway  
Troy, MI 48084
- B. Larson Middle School  
2222 E. Long Lake Rd.  
Troy, MI 48084

2. BID REQUIREMENTS

- A. Bids shall be submitted in duplicate (two (2) copies) in a sealed manila-type envelope.
- B. Bidders shall submit their bids on the enclosed Bid Proposal Form (Section 004113-F), attaching any and all information required by that form:
  - 1. Bid Security (Refer to Page 002113-F-1, Paragraph 2.G.)
  - 2. Storage Costs (Refer to Page 002113-F-3, Paragraph 3.C.)
  - 3. Deposit Requirements, if required. (Refer to Page 007000-F-3, Paragraph 6.A.)
  - 4. Familial Relationship Disclosure Statement (included with Proposal Form)
  - 5. Non-Collusion Affidavit (included with Proposal Form)
  - 6. Certification of Compliance – Iran Economic Sanctions Act (Included with Proposal Form)
  - 7. Unit Pricing
  - 8. Warranties
- C. Send or deliver two (2) copies of the bid, clearly marked 2013 BOND PROGRAM, BIDPACKAGE #6, BOULAN PARK MIDDLE SCHOOL ADDITION & LARSON MIDDLE SCHOOL ADDITION FURNISHINGS to be delivered not later than June 23, 2015 at 1:30 P.M. to:

Troy School District  
Mr. Todd Hensley  
1140 Rankin  
Troy, MI 48083

One copy will be for the Owner and the second is for the Architect.

- D. A bid received after the due date and time will be unacceptable.
- E. Facsimiles (FAX'S) or electronic copy (PDF) of bids will not be accepted.

- F. The Owner and Architect shall not be responsible for any cost or expense the Bidder incurs during the preparation of this bid. Additional copies of the bid documents will be furnished at the Bidder's expense.
- G. The Owner reserves the right to hold the bids for ninety (90) days; to accept or reject any or all bids; to omit or accept any informalities in any bid and to make such awards as it considers in its best interest, whether low bid or not.
1. A 5% bid bond or certified check must accompany the bid for those bids greater than \$1,500.00 (All submitted bid categories must be totaled together).
  2. Included on the Bid Proposal Form shall be the cost of a Performance Bond as described in paragraph 3.H, below.
- H. Bidders are requested to submit a bid on any category(s) that they are able to supply as specified. Substitutions will be considered as voluntary alternates. All voluntary alternates must be pre-approved prior to bid submittal. Bidders must submit model numbers and finish samples for each item number in the specified format. Literature and isometric drawings noting proposed changes to the documents must also be included. Products for consideration must comply with bid category "general notes" and identify discrepancies where product does not meet or exceed the specified (basis of design) product for design, finish, and quality.
- I. Bidders must submit pricing for all items within any given Bid Category. Incomplete bid categories will not be considered.
- J. A sworn and notarized statement disclosing any familial relationship existing between the bidder and any member of the school board, school superintendents, or chief executives must accompany each bid, as well as the Non-Collusion Affidavit and a signed Certification of Compliance – Iran Economic Sanctions Act. A board shall not accept a bid that does not include these statements, which are included in the proposal execution form.
- K. Should a Bidder find discrepancies in, or omissions from the specifications, plans, drawings, details, instructions and bid proposal form, or should the bidder be in doubt as to the meaning, the bidder should notify, at once, the Architect who will send written instructions to all appropriate Bidders. The Owner and Architect shall not be responsible for any oral instructions.
1. It is the Bidder's responsibility to note any detail or specification that, in his opinion, is not practical or functional.
  2. Bidders are required to verify product description to model numbers during bidding. Any discrepancies shall be brought to the attention of the Architect. (Refer to General Conditions, Page 007000-F-2, Paragraph 3.B.3.)
  3. Interpretations and supplemental instructions will be issued by Addenda. No Bidder shall rely on any interpretations or corrections given by any other method. Interpretations, corrections, or changes of the Bidding Documents made in any other manner will not be binding.
  4. Copies of addenda will be made available for inspection wherever Bidding Documents are on file.
  5. Submit requests for clarification or interpretation of the Bidding Documents in writing on bidders letterhead stationery, PDF format. The cut-off date for

submission of clarifications, interpretations, ambiguities, inconsistencies, and or errors discovered is June 16, 2015.

6. Submit request for clarification as noted above to:

Name: Danielle O'Grady  
Title: Interior Design Group  
Firm: TMP Architecture, Inc.  
Email: dogrady@tmp-architecture.com

7. Addenda will not be issued later than three (3) days, (72 hrs) prior to the date of receipt of bids (excluding weekends and holidays), except an addendum withdrawing the request for bids or postponing the bid date.
8. Failure of Bidder to receive such addenda shall not relieve him from any obligation under his bid as submitted.
9. Failure to comply with instructions stated in this section may result in rejection of bid.

- L. All information issued prior to the close of the bidding period shall be included in returned bid proposals and acknowledged on the Bid Proposal Form.
- M. For those contracts of \$10,000.00 or greater, the Contract shall be awarded when a Bidder has been issued a Purchase Order, but the terms of the Contract shall not be deemed to have been perfected until a Certificate of Insurance is delivered to the Owner. If Owner chooses to have a Performance Bond, this shall be required on Bid Proposal Form by category.

For those contracts under \$10,000.00, the contract shall be awarded when a Bidder has been issued a Purchase Order. A performance bond will not be required for contracts of less than \$10,000.00.

- N. After a contract agreement has been executed, the Bidder shall not be allowed any sum over and above the price(s) specified in the contract agreement.

3. PRICING

- A. Totaled bid category prices are to be entered on the Bid Proposal Form. All pricing is to include unit cost, freight, delivery, and installation. In all cases Bidder must observe the established Bid Proposal Form for bidding. (See Section 004113-F).
- B. "Lump Sum" on the Bid Proposal Form means the total of all the unit prices within the Furniture Category. "Unit Price" means the price of one item delivered, freighted, and installed. Bidder shall provide either a typed list of unit pricing (each unit price to include freight, delivery and installation) for each furniture item included in the bid or bidder may photocopy furnishings specification sheets and insert unit pricing in that format.
- C. Bidder shall also provide an attachment indicating the cost of storage (expressed in cost per dollar by week) to be used in the event of a delay in the construction of the building. The costs for extra handling required shall also be provided.

- D. Bid pricing for the installation of furnishings shall include all panel to panel electrical connections as well as panel to power source connections. Panel to power source connections are to be done by a licensed electrician. (Refer to General Conditions, Page 007000-F-3, Paragraph 3.D.5.)
  - E. Pricing shall include the receiving of furnishings and installation at job site(s). Drop shipping is unacceptable.
  - F. Bid pricing for the installation of furnishings shall include the return to the job after Owner occupies to manage and conceal all telephone, power, computer wires.
  - G. All furniture items specified for a "COM" covering shall be priced with that covering. The Contractor shall order coverage and have it delivered to the Manufacturer at the appropriate time.
  - H. Cost of a Performance Bond, equal to 100% of the contract price for Furniture Packages over \$10,000.00, shall be stated on the Bid Proposal Form. Owner shall decide at the time of award of contract whether to proceed with a Performance Bond.
4. ORDER DELETIONS
- A. Owner reserves the right to add or deduct item quantities from the original specification, up to 10% of the original quantities without any effect on the unit prices submitted for a period of 12 months.
5. TAXES
- A. The Owner is a federally constituted government body and is not subjected to Michigan State or Federal excise taxes.
6. INSURANCE REQUIREMENTS
- A. At the time of contract award, Contractor shall obtain the following insurance, at its own expense, to be maintained until completion of the Work or its final acceptance.
    - 1. Comprehensive General Liability and Automobile Liability insurance covering personal injury of death in the amount of \$1,000,000 per person, \$1,000,000 per occurrence, and property damage of \$1,000,000 per occurrence, unless otherwise specified by Owner, and Workmen's Compensation and Employer's Liability insurance in accordance with applicable law; and to indemnify and hold Owner harmless against damages, claims, losses, and expenses, including reasonable attorney's fees and court costs, resulting from injuries or damages, including death, to persons or property arising from Contractor's performance under contract.
    - 2. Certificates of insurance, in duplicate, indicating the job site and evidencing all required coverage must be submitted to and approved by Owner's Agent and Owner prior to the commencement of any of the work.
    - 3. All policies shall expressly require thirty (30) days written notice to the Owner, at the above address, of the cancellation or material alteration of such policy, and the Certificates of Insurance shall so provide.
    - 4. Certificates of Insurance shall specifically name Troy School District as the insured.
    - 5. Certificates of Insurance are to be submitted at the time of contract award.

7. PREVAILING WAGE RATES

- A. Contractor must comply with all current prevailing wage rates for Oakland County.

**\*\*END OF SECTION\*\***



BID PROPOSAL FORM

1. NAME OF BIDDER

Firm Name: \_\_\_\_\_  
Address: \_\_\_\_\_  
Telephone: \_\_\_\_\_

2. PROJECT NAME

Project Name: 2013 BOND PROGRAM, BID PACKAGE #6, BOULAN PARK MIDDLE SCHOOL ADDITION & LARSON MIDDLE SCHOOL ADDITION FURNISHINGS

3. AGREEMENTS

- A. The undersigned understands that the Owner reserves the right to reject any and all bids and to waive informalities in bidding.
- B. Owner also reserves the right to withhold bids for a period of ninety (90) days from bid closing date.
- C. The Owner reserves the right to accept or reject any or all Bids in whole or in part, or to waive any informalities therein. If in the Owners opinion it is in their best interest, the contract may be awarded to other than the lowest bidder, for reasons of establishing uniformity, delivery time, etc.
- D. If award is made to us under this proposal, we agree to enter into an Agreement with Troy School District to furnish furniture, and installation service, in strict accordance with this proposal, bid documents and all pertinent portions of plans, drawings and specifications.
- E. The undersigned understands that Performance Bond information is required within the Bid Proposal Form by category and will not be accepted after the bids are opened.
- F. The undersigned understands that a Certificate of Insurance shall be required five (5) days after notification of award of contract.

4. ADDENDA

A. The undersigned acknowledges receipt of the following addenda:

Addendum Number	_____	Dated	_____
Addendum Number	_____	Dated	_____
Addendum Number	_____	Dated	_____

5. ATTACHMENTS TO BID PROPOSAL FORM

A. The undersigned acknowledges the following are included with the Bid Proposal Form:

1. Bid Security: Yes / No
2. Performance Bond: Yes / No
3. Storage Costs: Yes / No
4. Deposit Information: Yes / No
5. Familial Relationship Disclosure Statement: Yes / No
6. Non-Collusion Affidavit: Yes / No
7. Certification of Compliance – Iran Economic Sanctions Act: Yes / No
8. Unit Pricing: Yes / No
9. Warranties: Yes / No

6. BID CATEGORIES

A. Bids for the following bid categories are included:

\_\_\_\_\_

7. LEGAL STATUS OF BIDDER

A. A Corporation organized and existing under the laws of the State of \_\_\_\_\_

B. Name, title and signature of individual duly authorized to execute contracts:

Name: \_\_\_\_\_

Title: \_\_\_\_\_

Signature: \_\_\_\_\_

8. BID PROPOSAL FORM

A. BID CATEGORY A: HON

1. TOTAL LUMP SUM BID FOR BID CATEGORY A \$ \_\_\_\_\_
2. PERFORMANCE BOND \$ \_\_\_\_\_

B. BID CATEGORY B: BAILEY MANUFACTURING CO.

1. TOTAL LUMP SUM BID FOR BID CATEGORY B \$ \_\_\_\_\_
2. PERFORMANCE BOND \$ \_\_\_\_\_

C. BID CATEGORY C: PETER PEPPER

1. TOTAL LUMP SUM BID FOR BID CATEGORY C \$ \_\_\_\_\_

2. PERFORMANCE BOND \$ \_\_\_\_\_

FAMILIAL RELATIONSHIP DISCLOSURE STATEMENT

As required by Public Act 232 of 2005, all bids shall be accompanied by a sworn and notarized statement disclosing any familial relationship that exists between the owner or any employee of the bidder and any member of the Troy School District Board of Education or the Superintendent of Schools. The Board of Education shall not accept a bid that does not include this sworn and notarized disclosure statement.

The undersigned, the owner or authorized officer of \_\_\_\_\_ (the "Bidder"), pursuant to the familial disclosure requirement provided in the Troy School District advertisement for construction bids, hereby represent and warrant, except as provided below, that no familial relationships exist between the owner(s) or any employee of the company and any member of the Troy School District Board of Education or the Administration. If such a relationship exists, please explain:

\_\_\_\_\_  
\_\_\_\_\_  
\_\_\_\_\_

Attach additional pages if necessary

By: \_\_\_\_\_ (Bidder Signature)

Title: \_\_\_\_\_ (type or print)

Date: \_\_\_\_\_

Subscribed and Sworn to Before Me:

This \_\_\_\_\_ day of \_\_\_\_\_, 20\_\_\_\_ A.D., in and for the

County of \_\_\_\_\_, Michigan.

My Commission expires \_\_\_\_\_.

\_\_\_\_\_  
Signature of Notary

(Return this completed form with bid package)

NON-COLLUSION AFFIDAVIT

STATE OF MICHIGAN        )  
                                  )  
OAKLAND                    )        ss:

The undersigned bidder or agent, being duly sworn on oath, says that he/she has not, nor has any other member, representative, or agent of the firm, company, corporation or partnership represented by him/her, entered into any combination, collusion or agreement with any person relative to the price to be bid by anyone at such letting nor to prevent any person from bidding nor to induce anyone to refrain from bidding, and that this bid is made without reference to any other bid and without any agreement, understanding or combination with any other person in reference to such bidding.

He/she further says that no person or persons, firms, or corporation has, have or will receive directly or indirectly, any rebate, gift, fee, commission or thing of value on account of such sale.

\_\_\_\_\_  
Bidder (Firm)

\_\_\_\_\_  
Signature of Bidder or Agent

Subscribed and sworn to before me this \_\_\_\_\_ day of \_\_\_\_\_, 20\_\_.

My commission expires: \_\_\_\_\_

County of residence: \_\_\_\_\_

\_\_\_\_\_  
Notary Public Signature

Seal

(Return this completed form with bid package)

CERTIFICATION OF COMPLIANCE – IRAN ECONOMIC SANCTIONS ACT  
Michigan Public Act No. 517 of 2012

The undersigned, the owner, or authorized officer of the below-named company (the “Company”), pursuant to the compliance certification requirement provided in the Troy School District’s Request For Proposal (the “RFP”), hereby certifies, represents, and warrants that the Company (which includes its officers, directors and employees) is not an “Iran Linked Business” within the meaning of the Iran Economic Sanctions Act, Michigan Public Act No. 517 of 2012 (the “Act”), and that in the event the Company is awarded a contract by the Troy School District as a result of the aforementioned RFP, the Company is not and will not become an “Iran Linked Business” at any time during the course of performing any services under the contract.

The Company further acknowledges that any person who is found to have submitted a false certification is responsible for a civil penalty of not more than \$250,000.00 or two (2) times the amount of the contract or proposed contract for which the false certification was made, whichever is greater, the cost of the Troy School District’s investigation, and reasonable attorney fees, in addition to the fine. Moreover, any person who submitted a false certification shall be ineligible to bid on a request for proposal for three (3) years from the date that it is determined that the person has submitted the false certification.

\_\_\_\_\_  
Name of Company

\_\_\_\_\_  
Name and Title of Authorized Representative

\_\_\_\_\_  
Signature

\_\_\_\_\_  
Date

(Return this completed form with bid package)

\*\*END OF SECTION\*\*

GENERAL CONDITIONS

1. OWNER RESPONSIBILITIES

A. The Owner is defined as:

Troy School District  
Michelle Kerns  
1140 Rankin  
Troy, MI 48083

B. The Owner and the Architect shall reserve the authority to stop work on a given segment of work or item to ensure proper interpretation and execution of the requirements of this specification.

C. Owner shall familiarize himself/herself with and follow Manufacturer's recommended guidelines for maintenance and cleaning.

D. The Owner's representative will accept items being delivered. The Owner's representative will inform the Architect of missing or damaged items. All paperwork noting condition of furnishings will come through the Architect.

E. The Owner and Architect shall conduct a final inspection of all merchandise ordered to assure that all items meet specifications, are in new and undamaged condition, are assembled or installed properly and placed in their properly designated locations.

2. ARCHITECT RESPONSIBILITIES

A. The Architect is defined as:

TMP ARCHITECTURE, INC.  
1191 W. Square Lake Road  
Bloomfield Hills, MI 48302-0374

B. The Architect shall be the interpreter of all work covered in this bid document.

C. The Architect shall visit the project periodically to inspect the work. After installation, final inspection of all furniture will be made and the Architect shall work with the Owner in establishing a punch list of necessary corrections to furniture.

D. Approval of all materials, fabrics, finishes, colors and details shall be made by the Architect.

3. CONTRACTOR RESPONSIBILITIES

A. The Contractor is defined as:

1. The bidder(s) awarded the contract(s) to provide, manufacture, deliver, and/or install furniture at the project location(s) detailed in Instructions to Bidders, Page 002113-F-1, Paragraph 1.

B. DOCUMENTS

1. The Contract Documents contemplate a finished piece work of such character and quality as is described therein and is reasonably inferable from them. The Contractor agrees that the Contract Sum for the work hereunder includes sufficient money allowance to make his work complete and operable, fitting with the work of other

Contractors and the Owner, and in compliance with good practice. He agrees that minor discrepancies or omissions, the failure to show repeated details, or the repetition on any drawings of the figures or notes given on another shall not be the cause for additional charges or claims.

2. The drawings are intended to show the general arrangement, design and extent of the work and are partly diagrammatic. They are not intended to be scaled for roughing-in measurements or to serve as shop drawings.
3. In the case of an inconsistency between Drawings and Specifications or within either Document not clarified by addendum, the better quality or greater quantity of Work shall be provided in accordance with the Architect's interpretation.

C. FABRICS

1. All same pattern and color fabrics must be supplied from the same dye lot.
2. Where "COM" fabric is specified, the Contractor shall order the specified fabric and have it delivered to the Furniture Manufacturer at the appropriate time.
  - a. It is the Contractor's responsibility to submit a sample of the specified "COM" fabric to the manufacturer to obtain required yardage requirements.
  - b. Upon receipt and before application of the fabric, the Manufacturer shall inspect and advise Contractor of any flaws. The replacement of any flawed fabric will be the responsibility of the Contractor.

D. INSTALLATION

1. Any metal files shall be leveled horizontally and plumbed vertically; no bolting necessary.
2. The Contractor shall identify one person from his installation crew, acceptable to Owner, who shall act as liaison with the Owner and Architect. This person shall have the authority to direct installation changes/modifications.
3. The Contractor is responsible for removing from the project all the waste materials and rubbish resulting from his operations and installation including all packing cartons and debris. **Removal is to occur on a daily basis. Failure to do so will result in the Owner doing so and the cost thereof shall be charged to the Contractor as a deduction in his contract price.**
4. The Contractor shall provide an adequate number of qualified, experienced installers, in harmony with other works at the site.
5. The Contractor shall obtain and provide any and all permits necessary to complete the installation, billing the cost directly to the Owner as it occurs.
6. The Contractor shall be responsible for final cleaning of all the furniture items installed by his crew. All protective materials shall be removed, all surfaces cleaned of dirt, smears, fingerprints, etc. All items are to be prepared for final acceptance by Owner.

4. DELIVERY AND INSTALLATION SCHEDULES

- A. Contractor shall guarantee delivery between 8:00 a.m. and 4:00 p.m. on September 15, 2015 through October 6, 2015. **The Owner will not accept early delivery.**
- B. Installation must be completed by October 6, 2015.



1. These dates are subject to change depending on construction schedule of the building(s). See paragraph D below in reference to the Pre-Installation Notice.
  - C. The Contractor shall work with the Manufacturer(s) and its representative to establish production and delivery schedules in keeping with the dates set above.
  - D. Approximately three (3) to four (4) weeks prior to required installation date, a pre-installation notice will be issued by the Architect. The purpose of this notice is to confirm actual installation dates.
  - E. Upon receipt of the Pre-Installation notice the Furnishings Contractor shall be responsible for contacting the Building Contractor to coordinate the use of loading dock and staging areas with other building trades on the project.
  - F. Once the actual dates are confirmed in the Pre-Installation Notice, it is the Contractor's responsibility to provide any storage or handling required at no extra cost to the Owner. Storage and extra handling required after the dates confirmed in the Pre-Installation Notice shall be provided by the Contractor at the costs provided on the Bid Proposal Form.
  - G. It is the Contractor's responsibility to receive furnishings delivered from the Manufacturer and to deliver those furnishings to the job site(s) at the time of installation. **Drop shipping is unacceptable** and if it occurs, will result in a deduction in the Contractor's contract price in the amount of cost incurred by the Owner or Owner's representative receiving and handling the drop shipment.
  - H. If a delivery truck is turned away from the installation site by anyone other than the Architect, before leaving the site, a representative from the contractor, or delivery company must contact the Architect to validate the order. If a delivery truck leaves the site without contacting the Architect, the contractor is responsible for any additional delivery costs incurred.
5. DAMAGES
- A. The Manufacturer/Contractor is responsible for all damages and losses until the installation has been completed and accepted by the Owner and Architect. The Owner will judge the damage.
  - B. Damaged or defective furniture shall be replaced and/or repaired at no cost to Owner.
  - C. Contractor shall provide all protection necessary to carpeting, walls, and other surfaces.
  - D. Any Damage to the Owner's property shall be repaired by the Owner and billed to the Contractor.
6. PAYMENT TERMS
- A. The Owner will pay a deposit, if required by the successful bidder for custom or specialty items. The deposit sum shall be mutually agreed upon by the Owner and contractor prior to contract award. Deposit requirements shall be noted on the Bid Proposal Form (Section 004113) by the Bidder.
  - B. Upon completion of installation and Architect's initial punch list, an amount to total 80% of the total bid category will be paid to the Contractor.
  - C. Upon final approval from the Architect, based on substantial completion of the punch list items, final and complete payment will be made.

- D. Invoices shall be formatted by Bid Category and clearly labeled and shall be sent directly to:

Michelle Kerns  
Troy School District  
1140 Rankin  
Troy, MI 48083

7. NO ADVERTISING CLAUSE

- A. No written publication or photographs will be allowed without written approval of Troy School District.

8. WAGE AND BENEFIT - REQUIREMENTS

- A. The Contractor shall pay the prevailing wage and fringe benefits in accordance with Michigan Act No. 166, Public Acts of 1965, as amended 1979 for contracts performed on State projects. Any Contractor who is awarded a subcontract shall furnish any and all information that may be requested by TMP Architecture, Inc., to include certified payroll, and submit to an independent audit (if requested) of all its books and records for the purpose of verifying that it is complying with all applicable prevailing wage statutes and ordinances. If the Department of Consumer and Industry Services determines that the Contractor is in violation of the Prevailing Wagers Act, that will constitute a material breach of contract.
- B. The Contractor shall be financially responsible for the payment of prevailing wages by all subcontractors contracted by him for work on the project.
- C. If there is a dispute between any Contractor and the unions, the Contractor will be required to meet with TMP Architecture, Inc. and the Union involved to try to resolve the issue.
- D. Refer to Michigan Prevailing Wage Rate (Attached) for Oakland County, as issued by the Michigan Department of Consumer and Industry Services, Wage and Hour Division. All requests for additional information, clarifications or questions should be directed to the Wage and Hour Division.

9. WARRANTIES

- A. The Contractor shall provide written documentation from the Manufacturer, which guarantees items against defects in materials, manufacture and workmanship, for a period of one (1) year from the day of project completion and Owner acceptance. Upon notification from the Owner, the Contractor or Manufacturer shall, by repair, replacement, or otherwise, place the item in a condition satisfactory to the Owner in every respect. Usual wear and tear and results of Owner's accidents are exempted from the requirements of this guarantee. Everything required to fulfill this guarantee shall be done without additional cost to the Owner. The products or workmanship of any Subcontractor are to be covered in the primary Manufacturer's guarantee.
- B. The following shall be considered defects, without being limited thereto:
1. Permanent etching, staining, discoloration, fading, and other deterioration of finishes.
  2. Operational failures, binding, and the like, in finish cabinet hardware.
  3. Deformation, warpage, opening up of joints, telegraphing of cores, delamination of veneers, or other finishing materials, failures in fastening and anchorage, sagging of panels.

\*\*END OF SECTION\*\*



RICK. SNYDER  
GOVERNOR



## STATE OF MICHIGAN

Prevailing Wages  
PO Box 30476  
Lansing, MI 48909  
517-322-1825

### *Informational Sheet: Prevailing Wages on State Projects*

#### REQUIREMENTS OF THE PREVAILING WAGES ON STATE PROJECTS ACT, PUBLIC ACT 166 OF 1965

The State of Michigan determines prevailing rates pursuant to the Prevailing Wages on State Projects Act, Public Act 166 of 1965, as amended. The purpose of establishing prevailing rates is to provide minimum rates of pay that must be paid to workers on construction projects for which the state or a school district is the contracting agent and which is financed or financially supported by the state. By law, prevailing rates are compiled from the rates contained in collectively bargained agreements which cover the locations of the state projects. The official prevailing rate schedule provides an hourly rate which includes *wage and fringe benefit totals* for designated construction mechanic classifications. The overtime rates also include *wage and fringe benefit totals*. Please pay special attention to the overtime and premium pay requirements. Prevailing wage is satisfied when wages plus fringe benefits paid to a worker are equal to or greater than the required rate.

#### **State of Michigan responsibilities under the law:**

- The department establishes the prevailing rate for each classification of construction mechanic **requested by a contracting agent** prior to contracts being let out for bid on a state project.

#### **Contracting agent responsibilities under the law:**

- If a contract is not awarded or construction does not start within 90 days of the date of the issuance of rates, a re-determination of rates must be requested by the contracting agent.
- Rates for classifications needed but not provided on the Prevailing Rate Schedule, **must** be obtained **prior** to contracts being let out for bid on a state project.
- The contracting agent, by written notice to the contractor and the sureties of the contractor known to the contracting agent, may terminate the contractor's right to proceed with that part of the contract, for which less than the prevailing rates have been or will be paid, and may proceed to complete the contract by separate agreement with another contractor or otherwise, and the original contractor and his sureties shall be liable to the contracting agent for any excess costs occasioned thereby.

#### **Contractor responsibilities under the law:**

- Every contractor and subcontractor shall keep posted on the construction site, in a conspicuous place, a copy of all prevailing rates prescribed in a contract.
- Every contractor and subcontractor shall keep an accurate record showing the name and occupation of and the actual wages and benefits paid to each construction mechanic employed by him in connection including certified payroll, as used in the industry, with said contract. This record shall be available for reasonable inspection by the contracting agent or the department.
- Each contractor or subcontractor is separately liable for the payment of the prevailing rate to its employees.
- The prime contractor is responsible for advising all subcontractors of the requirement to pay the prevailing rate prior to commencement of work.
- The prime contractor is secondarily liable for payment of prevailing rates that are not paid by a subcontractor.
- A construction mechanic *shall only* be paid the apprentice rate if registered with the United States Department of Labor, Bureau of Apprenticeship and Training and the rate is included in the contract.

#### **Enforcement:**

A person who has information of an alleged prevailing wage violation on a state project may file a complaint with the State of Michigan. The department will investigate and attempt to resolve the complaint informally. During the course of an investigation, if the requested records and posting certification are not made available in compliance with Section 5 of Act 166, the investigation will be concluded and a referral to the Office of Attorney General for civil action will be made. The Office of Attorney General will pursue costs and fees associated with a lawsuit if filing is necessary to obtain records.



RICK. SNYDER  
GOVERNOR

## STATE OF MICHIGAN

Prevailing Wages  
PO Box 30476  
Lansing, MI 48909  
517-322-1825



### Informational Sheet: Prevailing Wages on State Projects

#### General Information Regarding Fringe Benefits

**Certain** fringe benefits **may** be credited toward the payment of the Prevailing Wage Rate:

- If a fringe benefit is paid directly to a construction mechanic
- If a fringe benefit contribution or payment is made on behalf of a construction mechanic
- If a fringe benefit, which may be provided to a construction mechanic, is pursuant to a written contract or policy
- If a fringe benefit is paid into a fund, for a construction mechanic

When a fringe benefit is not paid by an hourly rate, the hourly credit will be calculated based on the annual value of the fringe benefit divided by 2080 hours per year (52 weeks @ 40 hours per week).

The following is an example of the types of fringe benefits allowed and how an hourly credit is calculated:

Vacation	40 hours X \$14.00 per hour = \$560/2080 =	\$0.27
Dental insurance	\$31.07 monthly premium X 12 mos. = \$372.84 /2080 =	\$0.18
Vision insurance	\$5.38 monthly premium X 12 mos. = \$64.56/2080 =	\$0.03
Health insurance	\$230.00 monthly premium X 12 mos. = \$2,760.00/2080 =	\$1.33
Life insurance	\$27.04 monthly premium X 12 mos. = \$324.48/2080 =	\$0.16
Tuition	\$500.00 annual cost/2080 =	\$0.24
Bonus	4 quarterly bonus/year x \$250 = \$1000.00/2080 =	\$0.48
401k Employer Contribution	\$2000.00 total annual contribution/2080 =	\$0.96
Total Hourly Credit		<u>\$3.65</u>

Other examples of the types of fringe benefits allowed:

- Sick pay
- Holiday pay
- Accidental Death & Dismemberment insurance premiums

The following are examples of items that **will not** be credited toward the payment of the Prevailing Wage Rate

- Legally required payments, such as:
  - Unemployment Insurance payments
  - Workers' Compensation Insurance payments
  - FICA (Social Security contributions, Medicare contributions)
- Reimbursable expenses, such as:
  - Clothing allowance or reimbursement
  - Uniform allowance or reimbursement
  - Gas allowance or reimbursement
  - Travel time or payment
  - Meals or lodging allowance or reimbursement
  - Per diem allowance or payment
- Other payments to or on behalf of a construction mechanic that are not wages or fringe benefits, such as:
  - Industry advancement funds
  - Financial or material loans



**State of Michigan**  
 DEPARTMENT OF LICENSING AND REGULATORY AFFAIRS  
 MICHIGAN OCCUPATIONAL SAFETY AND HEALTH ADMINISTRATION  
 MARTHA B. YODER  
 DIRECTOR

**OVERTIME PROVISIONS for MICHIGAN PREVAILING WAGE RATE COMMERCIAL SCHEDULE**

- Overtime is represented as a nine character code. Each character represents a certain period of time after the first 8 hours Monday thru Friday.

	Monday thru Friday	Saturday	Sunday & Holidays	Four 10s
First 8 Hours		4	8	9
9th Hour	1	5		
10th Hour	2	6		
Over 10 hours	3	7		

Overtime for Monday thru Friday after 8 hours:

the 1st character is for time worked in the 9th hour (8.1 - 9 hours)  
 the 2nd character is for time worked in the 10th hour (9.1 - 10 hours)  
 the 3rd character is for time worked beyond the 10th hour (10.1 and beyond)

Overtime on Saturday:

the 4th character is for time worked in the first 8 hours on Saturday (0 - 8 hours)  
 the 5th character is for time worked in the 9th hour on Saturday (8.1 - 9 hours)  
 the 6th character is for time worked in the 10th hour (9.1 - 10 hours)  
 the 7th character is for time worked beyond the 10th hour (10.01 and beyond)

Overtime on Sundays & Holidays

The 8th character is for time worked on Sunday or on a holiday

Four Ten Hour Days

The 9th character indicates if an optional 4-day 10-hour per day workweek can be worked **between Monday and Friday without paying overtime after 8 hours worked, unless otherwise noted in the rate schedule. To utilize a 4 ten workweek, notice is required from the employer to employee prior to the start of work on the project.**

- Overtime Indicators Used in the Overtime Provision:

H - means TIME AND ONE-HALF due  
 X - means TIME AND ONE-HALF due after 40 HOURS worked  
 D - means DOUBLE PAY due  
 Y - means YES an optional 4-day 10-hour per day workweek can be worked without paying overtime after 8 hours worked  
 N - means NO an optional 4-day 10-hour per day workweek *can not* be worked without paying overtime after 8 hours worked

- EXAMPLES:

HHHHHHHDN - This example shows that the 1½ rate must be used for time worked after 8 hours Monday thru Friday (characters 1 - 3); for all hours worked on Saturday, 1½ rate is due (characters 4 - 7). Work done on Sundays or holidays must be paid double time (character 8). The N (character 9) indicates that 4 ten-hour days is not an acceptable workweek at regular pay.

XXXHHHHDY - This example shows that the 1½ rate must be used for time worked after 40 hours are worked Monday thru Friday (characters 1-3); for hours worked on Saturday, 1½ rate is due (characters 4 – 7). Work done on Sundays or holidays must be paid double time (character 8). The Y (character 9) indicates that 4 ten-hour days is an acceptable alternative workweek.

LARA is an equal opportunity employer.  
 Auxiliary aids, services and other reasonable accommodations are available upon request to individuals with disabilities.

## ENGINEERS - CLASSES OF EQUIPMENT LIST

### UNDERGROUND ENGINEERS

#### **CLASS I**

Backfiller Tamper, Backhoe, Batch Plant Operator, Clam-Shell, Concrete Paver (2 drums or larger), Conveyor Loader (Euclid type), Crane (crawler, truck type or pile driving), Dozer, Dragline, Elevating Grader, End Loader, Gradall (and similar type machine), Grader, Power Shovel, Roller (asphalt), Scraper (self propelled or tractor drawn), Side Broom Tractor (type D-4 or larger), Slope Paver, Trencher (over 8' digging capacity), Well Drilling Rig, Mechanic, Slip Form Paver, Hydro Excavator.

#### **CLASS II**

Boom Truck (power swing type boom), Crusher, Hoist, Pump (1 or more 6" discharge or larger gas or diesel powered by generator of 300 amps or more, inclusive of generator), Side Boom Tractor (smaller than type D-4 or equivalent), Tractor (pneu-tired, other than backhoe or front end loader), Trencher (8' digging capacity and smaller), Vac Truck.

#### **CLASS III**

Air Compressors (600 cfm or larger), Air Compressors (2 or more less than 600 cfm), Boom Truck (non-swinging, non-powered type boom), Concrete Breaker (self-propelled or truck mounted, includes compressor), Concrete Paver (1 drum, ½ yard or larger), Elevator (other than passenger), Maintenance Man, Mechanic Helper, Pump (2 or more 4" up to 6" discharge, gas or diesel powered, excluding submersible pump), Pumpcrete Machine (and similar equipment), Wagon Drill Machine, Welding Machine or Generator (2 or more 300 amp or larger, gas or diesel powered).

#### **CLASS IV**

Boiler, Concrete Saw (40HP or over), Curing Machine (self-propelled), Farm Tractor (w/attachment), Finishing Machine (concrete), Firemen, Hydraulic Pipe Pushing Machine, Mulching Equipment, Oiler (2 or more up to 4", exclude submersible), Pumps (2 or more up to 4" discharge if used 3 hrs or more a day-gas or diesel powered, excluding submersible pumps), Roller (other than asphalt), Stump Remover, Vibrating Compaction Equipment (6' wide or over), Trencher (service) Sweeper (Wayne type and similar equipment), Water Wagon, Extend-a-Boom Forklift.

### HAZARDOUS WASTE ABATEMENT ENGINEERS

#### **CLASS I**

Backhoe, Batch Plant Operator, Clamshell, Concrete Breaker when attached to hoe, Concrete Cleaning Decontamination Machine Operator, Concrete Pump, Concrete Paver, Crusher, Dozer, Elevating Grader, Endloader, Farm Tractor (90 h.p. and higher), Gradall, Grader, Heavy Equipment Robotics Operator, Hydro Excavator, Loader, Pug Mill, Pumpcrete Machines, Pump Trucks, Roller, Scraper (self-propelled or tractor drawn), Side Boom Tractor, Slip Form Paver, Slope Paver, Trencher, Ultra High Pressure Waterjet Cutting Tool System Operator, Vactors, Vacuum Blasting Machine Operator, Vertical Lifting Hoist, Vibrating Compaction Equipment (self-propelled), and Well Drilling Rig.

#### **CLASS II**

Air Compressor, Concrete Breaker when not attached to hoe, Elevator, End Dumps, Equipment Decontamination Operator, Farm Tractor (less than 90 h.p.), Forklift, Generator, Heater, Mulcher, Pigs (Portable Reagent Storage Tanks), Power Screens, Pumps (water), Stationary Compressed Air Plant, Sweeper, Water Wagon and Welding Machine.

**State of Michigan**

WHPWRequest@michigan.gov

**Official Request #:** 743

**Requestor:** Troy School District

**Project Description:** Boulan Park & Larson Middle School Interior Remodel/Upgrades

**Project Number:** 2013 Bond Program, Series 1, BID 9812

**Oakland County**

**Official 2015 Prevailing Wage Rates for State Funded Projects**

**Issue Date:** 6/1/2015

**Contract must be awarded by:** 8/30/2015

**Page 1 of 35**

<u>Classification</u>		Last Updated	Straight Hourly	Time and Half	a Double Time	Overtime Provision
Name	Description					
<b>Asbestos &amp; Lead Abatement Laborer</b>						
Asbestos & Lead Abatement Laborer	MLDC	10/1/2014	\$40.25	\$53.64	\$67.03	H H H X X X X D Y
4 ten hour days @ straight time allowed Monday-Saturday, must be consecutive						

**Asbestos & Lead Abatement, Hazardous Material Handler**

Asbestos and Lead Abatement, Hazardous Material Handler	AS207	10/1/2014	\$40.25	\$53.58	\$66.90	H H H X X X X D Y
4 ten hour days @ straight time allowed Monday-Saturday, must be consecutive						

**Boilermaker**

Boilermaker	BO169	2/17/2015	\$54.70	\$81.08	\$107.45	H H H H H H D Y
-------------	-------	-----------	---------	---------	----------	-----------------

**Apprentice Rates:**

1st 6 months	\$40.31	\$59.49	\$78.67
2nd 6 months	\$41.45	\$61.21	\$80.95
3rd 6 months	\$42.57	\$62.88	\$83.19
4th 6 months	\$43.69	\$64.57	\$85.43
5th 6 months	\$44.81	\$66.24	\$87.67
6th 6 months	\$48.63	\$72.50	\$96.36
7th 6 months	\$49.32	\$73.01	\$96.69
8th 6 months	\$51.58	\$76.40	\$101.21

Official Request #: 743

Requestor: Troy School District

Project Description: Boulan Park & Larson Middle School Interior

Project Number: 2013 Bond Program, Series 1, BID 9812

County: Oakland

**Official Rate Schedule**

Every contractor and subcontractor shall keep posted on the construction site, in a conspicuous place, a copy of all prevailing wage and fringe benefit rates prescribed in a contract.

# Official 2015 Prevailing Wage Rates for State Funded Projects

**Issue Date:** 6/1/2015

**Contract must be awarded by:** 8/30/2015

**Page 2 of 35**

Classification Name	Description		Last Updated	Straight Hourly	Time and Half	a Double Time	Overtime Provision
<b>Bricklayer</b>							
Bricklayer, stone mason, pointer, cleaner,		BR1	10/15/2014	\$52.43	\$78.65	\$104.86	H H D H D D D D Y
	<i>Make up day allowed comment</i>						
	Saturday for 5 day 8 hour week						
	Friday for 4 day 10 hour week						
	4 10s allowed M-TH						

**Apprentice Rates:**

First 6 months	\$31.87	\$47.81	\$63.74
2nd 6 months	\$33.72	\$50.60	\$67.44
3rd 6 months	\$35.57	\$53.37	\$71.14
4th 6 months	\$37.42	\$56.14	\$74.84
5th 6 months	\$39.27	\$58.92	\$78.54
6th 6 months	\$41.12	\$61.70	\$82.24
7th 6 months	\$42.97	\$64.46	\$85.94
8th 6 months	\$44.82	\$67.24	\$89.64

**Carpenter**

Diver		CA 687 D	6/25/2014	\$64.65	\$93.14	\$121.63	X X H X X H H D Y
	Four 10s allowed M-Sat; double time due when over 12 hours worked per day						
	<i>Make up day allowed comment</i>						
	Saturday						

Official Request #: 743

Requestor: Troy School District

Project Description: Boulan Park & Larson Middle School Interior

Project Number: 2013 Bond Program, Series 1, BID 9812

County: Oakland

**Official Rate Schedule**

**Every contractor and subcontractor shall keep posted on the construction site, in a conspicuous place, a copy of all prevailing wage and fringe benefit rates prescribed in a contract.**



# Official 2015 Prevailing Wage Rates for State Funded Projects

**Issue Date:** 6/1/2015

**Contract must be awarded by:** 8/30/2015

**Page 3 of 35**

Classification Name Description		Last Updated	Straight Hourly	Time and Half	a Double Time	Overtime Provision
Carpet and Resilient Floor Layer, (does not include installation of prefabricated formica & parquet flooring which is to be paid carpenter rate)	CA1045	6/12/2014	\$49.21	\$70.18	\$91.14	X X H X X X D Y

**Apprentice Rates:**

1st 6 months	\$24.23	\$32.71	\$41.18
2nd 6 months	\$28.25	\$38.73	\$49.22
3rd 6 months	\$30.35	\$41.88	\$53.42
4th 6 months	\$32.44	\$45.02	\$57.60
5th 6 months	\$34.54	\$48.17	\$61.80
6th 6 months	\$36.63	\$51.31	\$65.98
7th 6 months	\$38.74	\$54.48	\$70.20
8th 6 months	\$40.82	\$57.59	\$74.36

Carpenter four 10s allowed Mon-Sat; double time due when over 12 hours worked per day <i>Make up day allowed comment</i> Saturdays	CA687Z1	6/24/2014	\$55.24	\$79.04	\$102.84	X X H X X H H D Y
---	---------	-----------	---------	---------	----------	-------------------

**Apprentice Rates:**

1st year	\$33.82	\$46.92	\$60.00
3rd 6 months	\$36.21	\$50.49	\$64.78
4th 6 months	\$38.58	\$54.05	\$69.52
5th 6 months	\$40.97	\$57.64	\$74.30
6th 6 months	\$43.33	\$61.17	\$79.02
7th 6 months	\$45.72	\$64.77	\$83.80
8th 6 months	\$48.09	\$68.32	\$88.54

Official Request #: 743

Requestor: Troy School District

Project Description: Boulan Park & Larson Middle School Interior

Project Number: 2013 Bond Program, Series 1, BID 9812

County: Oakland

**Official Rate Schedule**

**Every contractor and subcontractor shall keep posted on the construction site, in a conspicuous place, a copy of all prevailing wage and fringe benefit rates prescribed in a contract.**

# Official 2015 Prevailing Wage Rates for State Funded Projects

**Issue Date:** 6/1/2015

**Contract must be awarded by:** 8/30/2015

**Page 4 of 35**

Classification Name Description	Last Updated	Straight Hourly	Time and Half	a Double Time	Overtime Provision
Piledriver Four 10s allowed Monday-Saturday; double time due when over 12 hours worked per day <i>Make up day allowed comment</i> Saturday	CA687Z1P 6/24/2014	\$55.24	\$79.04	\$102.84	X X H X X H H D Y

**Apprentice Rates:**

1st 6 months	\$33.82	\$46.92	\$60.00
2nd 6 months	\$38.58	\$54.05	\$69.52
3rd 6 months	\$43.33	\$61.17	\$79.02
4th 6 months	\$48.09	\$68.32	\$88.54

Subdivision of county

**Cement Mason**

Cement Mason	br1cm 10/15/2014	\$50.05	\$71.17	\$92.28	X X H H H H H D N
--------------	------------------	---------	---------	---------	-------------------

**Apprentice Rates:**

1st 6 months	\$29.13	\$39.45	\$49.77
2nd 6 months	\$31.20	\$42.54	\$53.87
3rd 6 months	\$35.31	\$48.67	\$62.01
4th 6 months	\$39.46	\$54.85	\$70.23
5th 6 months	\$41.52	\$57.91	\$74.30
6th 6 months	\$45.67	\$64.10	\$82.52

Cement Mason	CE514 11/10/2011	\$46.30	\$64.89	\$83.48	H H D H H H H D N
--------------	------------------	---------	---------	---------	-------------------

**Apprentice Rates:**

1st 6 months	\$26.77	\$36.07	\$45.36
2nd 6 months	\$28.68	\$38.91	\$49.13
3rd 6 months	\$32.50	\$44.59	\$56.66
4th 6 months	\$36.32	\$50.26	\$64.19
5th 6 months	\$38.24	\$53.11	\$67.98
6th 6 months	\$42.06	\$58.79	\$75.51

Official Request #: 743  
 Requestor: Troy School District  
 Project Description: Boulan Park & Larson Middle School Interior  
 Project Number: 2013 Bond Program, Series 1, BID 9812  
 County: Oakland

**Official Rate Schedule**  
**Every contractor and subcontractor shall keep posted on the construction site, in a conspicuous place, a copy of all prevailing wage and fringe benefit rates prescribed in a contract.**

# Official 2015 Prevailing Wage Rates for State Funded Projects

**Issue Date:** 6/1/2015

**Contract must be awarded by:** 8/30/2015

**Page 5 of 35**

Classification Name	Description	Last Updated	Straight Hourly	Time and Half	a Double Time	Overtime Provision
------------------------	-------------	-----------------	--------------------	------------------	------------------	-----------------------

## Drywall

Drywall Taper	PT-22-D	9/5/2014	\$44.41	\$57.66	\$70.91	H H D H D D D D Y
Four 10s allowed Monday-Thursday						
<i>Make up day allowed comment</i>						
Friday make-up day for bad weather or holidays						

**Apprentice Rates:**

First 3 months	\$31.16	\$37.79	\$44.41
Second 3 months	\$33.81	\$41.76	\$49.71
Second 6 months	\$36.46	\$45.73	\$55.01
Third 6 months	\$39.11	\$49.71	\$60.31
4th 6 months	\$40.43	\$51.69	\$62.95

## Electrician

Inside Wireman	EC-58-IW	10/2/2014	\$58.91	\$77.39	\$95.87	H H H H H H D N
----------------	----------	-----------	---------	---------	---------	-----------------

**Apprentice Rates:**

0-1000 hours	\$36.73	\$44.12	\$51.51
1000-2000 hours	\$38.58	\$46.89	\$55.21
2000-3500 hours	\$40.43	\$49.67	\$58.91
3500-5000 hours	\$42.27	\$52.44	\$62.59
5000-6500 hours	\$45.97	\$57.98	\$69.99
6500-8000 hours	\$49.67	\$63.53	\$77.39

Sound and Communication Installer/Technician	EC-58-SC	10/2/2014	\$37.48	\$50.29	\$63.09	H H H H H H D N
--	----------	-----------	---------	---------	---------	-----------------

**Apprentice Rates:**

Period 1	\$24.67	\$31.07	\$37.47
Period 2	\$25.95	\$32.99	\$40.03
Period 3	\$27.24	\$34.93	\$42.61
Period 4	\$28.51	\$36.83	\$45.15
Period 5	\$29.79	\$38.75	\$47.71
Period 6	\$31.07	\$40.67	\$50.27

Official Request #: 743  
 Requestor: Troy School District  
 Project Description: Boulan Park & Larson Middle School Interior  
 Project Number: 2013 Bond Program, Series 1, BID 9812  
 County: Oakland

**Official Rate Schedule**  
**Every contractor and subcontractor shall keep posted on the construction site, in a conspicuous place, a copy of all prevailing wage and fringe benefit rates prescribed in a contract.**

# Official 2015 Prevailing Wage Rates for State Funded Projects

**Issue Date:** 6/1/2015

**Contract must be awarded by:** 8/30/2015

**Page 6 of 35**

Classification Name Description		Last Updated	Straight Hourly	Time and Half	a Double Time	Overtime Provision
Lineman/Technician outside utility and commercial power and high voltage pipe type cable work and electrical underground.	EC-876	11/18/2009	\$47.05	\$68.11	\$89.17	H H H H H H D Y

Four 10s allowed Monday-Thursday with Friday makeup or Tuesday-Friday with Monday

**Apprentice Rates:**

1st period	\$30.20	\$42.69	\$55.26
2nd period	\$32.32	\$46.02	\$59.70
3rd period	\$34.42	\$49.16	\$63.90
4th period	\$36.53	\$52.33	\$68.12
5th period	\$38.63	\$55.47	\$72.32
6th period	\$40.74	\$58.64	\$76.54
7th period	\$42.84	\$61.79	\$80.74

Subdivision of county Holly Township only

**Elevator Constructor**

Elevator Constructor	EL 36	8/7/2007	\$56.46	\$94.99	D D D D D D D Y
Elevator Constructor					
<i>Make up day allowed</i>					

**Apprentice Rates:**

1st Year Apprentice	\$37.74	\$58.93
2nd Year Apprentice	\$41.90	\$66.94
3rd Year Apprentice	\$43.98	\$70.95
4th Year Apprentice	\$48.14	\$78.96

Official Request #: 743  
 Requestor: Troy School District  
 Project Description: Boulan Park & Larson Middle School Interior  
 Project Number: 2013 Bond Program, Series 1, BID 9812  
 County: Oakland

**Official Rate Schedule**  
**Every contractor and subcontractor shall keep posted on the construction site, in a conspicuous place, a copy of all prevailing wage and fringe benefit rates prescribed in a contract.**

# Official 2015 Prevailing Wage Rates for State Funded Projects

Issue Date: 6/1/2015

Contract must be awarded by: 8/30/2015

Page 7 of 35

Classification Name	Description	Last Updated	Straight Hourly	Time and Half	a Double Time	Overtime Provision
------------------------	-------------	-----------------	--------------------	------------------	------------------	-----------------------

## Glazier

Glazier	GL-357	10/2/2014	\$47.35	\$65.97	\$84.58	H H H H H H H D Y
---------	--------	-----------	---------	---------	---------	-------------------

If a four 10 hour day workweek is scheduled, four 10s must be consecutive, M-F.

### Apprentice Rates:

1st 6 months	\$32.45	\$43.62	\$54.78
2nd 6 months	\$33.94	\$45.85	\$57.76
3rd 6 months	\$36.92	\$50.33	\$63.72
4th 6 months	\$38.41	\$52.56	\$66.70
5th 6 months	\$39.90	\$54.79	\$69.68
6th 6 months	\$41.39	\$57.03	\$72.66
7th 6 months	\$42.88	\$59.27	\$75.64
8th 6 months	\$45.86	\$63.73	\$81.60

## Heat and Frost Insulator

Spray Insulation	AS25S	3/5/2007	\$20.14	\$29.14	H H H H H H H H N
------------------	-------	----------	---------	---------	-------------------

## Heat and Frost Insulator and Asbestos Worker

Heat and Frost Insulators and Asbestos Workers	AS25	1/29/2014	\$60.25	\$76.00	\$91.74	H H H H H H H D Y
--	------	-----------	---------	---------	---------	-------------------

Four 10s must be worked for a minimum of 2 weeks consecutively, Monday thru Thursday. All hours worked in excess of 10 will be paid at double time. All hours worked on the fifth day,

*comment*

Four 10s must be worked for a minimum of 2 consecutive weeks. OVERTIME is different on a four 10 week. OT is 2x for hours beyond 10. All hours on fifth day, M-F require time and one half. Sat first 8 hours, 1.5, all hours after 8 require double time.

### Apprentice Rates:

1st Year	\$46.08	\$54.74	\$63.40
2nd Year	\$49.23	\$59.46	\$69.70
3rd Year	\$50.80	\$61.82	\$72.84
4th Year	\$53.95	\$66.54	\$79.14

Official Request #: 743  
 Requestor: Troy School District  
 Project Description: Boulan Park & Larson Middle School Interior  
 Project Number: 2013 Bond Program, Series 1, BID 9812  
 County: Oakland

**Official Rate Schedule**  
**Every contractor and subcontractor shall keep posted on the construction site, in a conspicuous place, a copy of all prevailing wage and fringe benefit rates prescribed in a contract.**

# Official 2015 Prevailing Wage Rates for State Funded Projects

**Issue Date:** 6/1/2015

**Contract must be awarded by:** 8/30/2015

**Page 8 of 35**

Classification Name	Description	Last Updated	Straight Hourly	Time and Half	a Double Time	Overtime Provision
<b>Ironworker</b>						
	Fence, Sound Barrier & Guardrail erection/installation and Exterior Signage work Four ten hour work days may be worked during Monday-Saturday.	IR-25-F1 2/24/2015	\$34.65	\$46.65	\$58.65	X X H X X X H D Y

**Apprentice Rates:**

60% Level	\$24.25	\$31.45	\$38.65
65% Level	\$25.55	\$33.35	\$41.15
70% Level	\$26.86	\$35.26	\$43.66
75% Level	\$28.15	\$37.15	\$46.15
80% Level	\$29.45	\$39.05	\$48.65
85% Level	\$30.75	\$40.95	\$51.15

	Siding, Glazing, Curtain Wall 4 tens may be worked Monday thru Thursday @ straight time. <i>Make up day allowed comment</i> Friday	IR-25-GZ2 9/4/2014	\$46.41	\$58.07	\$69.73	X X H H H H D D Y
--	---	-----------------------	---------	---------	---------	-------------------

**Apprentice Rates:**

Level 1	\$29.48	\$36.09	\$42.68
Level 2	\$31.59	\$38.83	\$46.05
Level 3	\$33.71	\$41.58	\$49.44
Level 4	\$35.83	\$44.33	\$52.82
Level 5	\$37.94	\$47.07	\$56.20
Level 6	\$40.06	\$49.82	\$59.58

Official Request #: 743  
 Requestor: Troy School District  
 Project Description: Boulan Park & Larson Middle School Interior  
 Project Number: 2013 Bond Program, Series 1, BID 9812  
 County: Oakland

**Official Rate Schedule**  
**Every contractor and subcontractor shall keep posted on the construction site, in a conspicuous place, a copy of all prevailing wage and fringe benefit rates prescribed in a contract.**

# Official 2015 Prevailing Wage Rates for State Funded Projects

**Issue Date:** 6/1/2015

**Contract must be awarded by:** 8/30/2015

**Page 9 of 35**

Classification Name Description		Last Updated	Straight Hourly	Time and Half	a Double Time	Overtime Provision
Pre-engineered Metal Work <i>Make up day allowed comment</i> 4 tens allowed M-Th with Saturday make up day	IR-25-PE-Z1	6/3/2014	\$45.24	\$55.53	\$65.81	X X H X X X X D Y
<b>Apprentice Rates:</b>						
1st Year			\$26.11	\$31.58	\$37.06	
3rd 6 month period			\$28.23	\$34.46	\$40.68	
4th 6 month period			\$30.36	\$37.35	\$44.33	
5th 6 month period			\$32.48	\$40.21	\$47.95	
6th 6 month period			\$34.61	\$43.99	\$53.37	
Reinforced Iron Work <i>Make up day allowed</i>	IR-25-RF	9/3/2014	\$55.36	\$82.91	\$110.45	H H D H D D D D N
<b>Apprentice Rates:</b>						
Level 1			\$36.01	\$53.89	\$71.75	
Level 2			\$38.38	\$57.43	\$76.49	
Level 3			\$40.74	\$60.98	\$81.21	
Level 4			\$43.28	\$64.78	\$86.29	
Level 5			\$45.81	\$68.59	\$91.35	
Level 6			\$48.35	\$72.39	\$96.43	
Rigging Work	IR-25-RIG	9/3/2014	\$61.33	\$91.67	\$122.00	H H H H H H D N
<b>Apprentice Rates:</b>						
Level 1 & 2			\$36.63	\$54.59	\$72.55	
Level 3			\$39.46	\$58.84	\$78.21	
Level 4			\$42.28	\$63.07	\$83.85	
Level 5			\$45.11	\$67.31	\$89.51	
Level 6			\$47.94	\$71.56	\$95.17	

Official Request #: 743  
 Requestor: Troy School District  
 Project Description: Boulan Park & Larson Middle School Interior  
 Project Number: 2013 Bond Program, Series 1, BID 9812  
 County: Oakland

**Official Rate Schedule**  
**Every contractor and subcontractor shall keep posted on the construction site, in a conspicuous place, a copy of all prevailing wage and fringe benefit rates prescribed in a contract.**

# Official 2015 Prevailing Wage Rates for State Funded Projects

**Issue Date:** 6/1/2015

**Contract must be awarded by:** 8/30/2015

**Page 10 of 35**

Classification Name Description		Last Updated	Straight Hourly	Time and Half	a Double Time	Overtime Provision
Decking 4 tens may be worked Monday thru Thursday @ straight time. If bad weather, Friday may be a make up day. If holiday celebrated on a Monday, 4 10s may be worked Tuesday thru Friday. Work in excess of 12 hours per day must be paid @ double time. <i>Make up day allowed comment</i> Friday for 4 tens M-Th Saturday for 5 eights M-F	IR-25-SD	9/4/2014	\$53.29	\$79.63	\$105.96	X X H H H H D D Y
Structural, ornamental, welder and pre-cast 4 tens may be worked Monday thru Thursday @ straight time. If bad weather, Friday may be a make up day. If holiday celebrated on a Monday, 4 10s may be worked Tuesday thru Friday. Work in excess of 12 hours per day must be paid @ double time. <i>Make up day allowed</i>	IR-25-STR	9/3/2014	\$61.46	\$91.84	\$122.21	H H H H H H D D Y
<b>Apprentice Rates:</b>						
Levels 1 & 2			\$36.05	\$54.01	\$71.97	
Level 3			\$38.88	\$58.26	\$77.63	
Level 4			\$41.70	\$62.49	\$83.27	
Level 5			\$44.53	\$66.73	\$88.93	
Level 6			\$47.36	\$70.98	\$94.59	
Level 7			\$50.18	\$75.20	\$100.23	
Level 8			\$53.01	\$79.46	\$105.89	
Industrial Door erection & construction <i>Make up day allowed comment</i> Friday for bad weather when 4 tens scheduled for M-Th. If holiday celebrated on M, 4 tens may be worked T-F. Work in excess of 12 hours per day must be paid @ double time.	IR-25-STR-D	9/4/2014	\$42.02	\$62.68	\$83.33	H H H H H H D D Y

Official Request #: 743  
 Requestor: Troy School District  
 Project Description: Boulan Park & Larson Middle School Interior  
 Project Number: 2013 Bond Program, Series 1, BID 9812  
 County: Oakland

**Official Rate Schedule**  
**Every contractor and subcontractor shall keep posted on the construction site, in a conspicuous place, a copy of all prevailing wage and fringe benefit rates prescribed in a contract.**



# Official 2015 Prevailing Wage Rates for State Funded Projects

**Issue Date:** 6/1/2015

**Contract must be awarded by:** 8/30/2015

**Page 11 of 35**

Classification Name	Description	Last Updated	Straight Hourly	Time and Half	a Double Time	Overtime Provision
------------------------	-------------	-----------------	--------------------	------------------	------------------	-----------------------

**Laborer**

Construction Laborer, Demolition Laborer, Mason Tender, Carpenter Tender, Drywall Handler, Concrete Laborer, Cement Finisher tender, concrete chute and concrete Bucket Handler, Concrete Laborer	L1076-A-A	6/13/2013	\$43.54	\$61.94	\$80.33	H H H H H H D Y
---	-----------	-----------	---------	---------	---------	-----------------

If conditions beyond the employer/employee's control prevent one or more hours of working during Mon-Fri, the employer may choose to work up to 10 hour straight time weekdays. Work may be scheduled up to 10 hours per Mon-Fri for the purpose of reaching 40 hours @ straight time. Make up days may also include 8 hours of work on Saturdays @ straight time.

*Make up day allowed comment*  
Saturday

**Apprentice Rates:**

0-1,000 work hours	\$37.60	\$53.03	\$68.45
1,001-2,000 work hours	\$38.79	\$54.81	\$70.83
2,001-3,000 work hours	\$39.98	\$56.60	\$73.21
3,001-4,000 work hours	\$42.35	\$60.15	\$77.95

Signal man (on sewer & caisson work); air,electric or gasoline tool operator (including concrete vibrator operator,acetylene torch & air hammer operator); scaffold builder, caisson worker	L1076-A-B	6/13/2013	\$43.80	\$62.33	\$80.85	H H H H H H D Y
---	-----------	-----------	---------	---------	---------	-----------------

If conditions beyond the employer/employee's control prevent one or more hours of working during Mon-Fri, the employer may choose to work up to 10 hour straight time weekdays. Work may be scheduled up to 10 hours per Mon-Fri for the purpose of reaching 40 hours @ straight time. Make up days may also include 8 hours of work on Saturdays @ straight time.

*Make up day allowed comment*  
Saturday

Official Request #: 743  
 Requestor: Troy School District  
 Project Description: Boulan Park & Larson Middle School Interior  
 Project Number: 2013 Bond Program, Series 1, BID 9812  
 County: Oakland

**Official Rate Schedule**  
**Every contractor and subcontractor shall keep posted on the construction site, in a conspicuous place, a copy of all prevailing wage and fringe benefit rates prescribed in a contract.**

# Official 2015 Prevailing Wage Rates for State Funded Projects

**Issue Date:** 6/1/2015

**Contract must be awarded by:** 8/30/2015

**Page 12 of 35**

Classification Name	Description	Last Updated	Straight Hourly	Time and Half	a Double Time	Overtime Provision
Lansing Burner, Blaster & Powder Man	L1076-A-C	6/13/2013	\$44.29	\$63.06	\$81.83	H H H H H H D Y

If conditions beyond the employer/employee's control prevent one or more hours of working during Mon-Fri, the employer may choose to work up to 10 hour straight time weekdays. Work may be scheduled up to 10 hours per Mon-Fri for the purpose of reaching 40 hours @ straight time. Make up days may also include 8 hours of work on Saturdays @ straight time.

*Make up day allowed comment*  
Saturday

Furnance battery heater tender, burning bar & oxy-acetylene gun	L1076-A-D	6/13/2013	\$44.04	\$62.69	\$81.33	H H H H H H D Y
---	-----------	-----------	---------	---------	---------	-----------------

If conditions beyond the employer/employee's control prevent one or more hours of working during Mon-Fri, the employer may choose to work up to 10 hour straight time weekdays. Work may be scheduled up to 10 hours per Mon-Fri for the purpose of reaching 40 hours @ straight time. Make up days may also include 8 hours of work on Saturdays @ straight time.

*Make up day allowed comment*  
Saturday

Cleaner/ sweeper laborer, furniture laborer	L1076-A-E	6/13/2013	\$38.09	\$53.76	\$69.43	H H H H H H D Y
---	-----------	-----------	---------	---------	---------	-----------------

If conditions beyond the employer/employee's control prevent one or more hours of working during Mon-Fri, the employer may choose to work up to 10 hour straight time weekdays. Work may be scheduled up to 10 hours per Mon-Fri for the purpose of reaching 40 hours @ straight time. Make up days may also include 8 hours of work on Saturdays @ straight time.

*Make up day allowed comment*  
Saturday

Official Request #: 743  
 Requestor: Troy School District  
 Project Description: Boulan Park & Larson Middle School Interior  
 Project Number: 2013 Bond Program, Series 1, BID 9812  
 County: Oakland

**Official Rate Schedule**  
**Every contractor and subcontractor shall keep posted on the construction site, in a conspicuous place, a copy of all prevailing wage and fringe benefit rates prescribed in a contract.**

# Official 2015 Prevailing Wage Rates for State Funded Projects

**Issue Date:** 6/1/2015

**Contract must be awarded by:** 8/30/2015

**Page 13 of 35**

Classification Name	Description	Last Updated	Straight Hourly	Time and Half	a Double Time	Overtime Provision
Expediter man, topman and/or bottom man (blast furnace work or battery work)	L1076-A-F	6/13/2013	\$44.79	\$63.81	\$82.83	H H H H H H H D Y

If conditions beyond the employer/employee's control prevent one or more hours of working during Mon-Fri, the employer may choose to work up to 10 hour straight time weekdays. Work may be scheduled up to 10 hours per Mon-Fri for the purpose of reaching 40 hours @ straight time. Make up days may also include 8 hours of work on Saturdays @ straight time.

*comment*

Saturday

Plasterer Tender, Plastering Machine Operator	LPT-1	10/25/2013	\$43.54	\$61.94	\$80.33	X X H H H H H D Y
---	-------	------------	---------	---------	---------	-------------------

If conditions beyond the employer/employee's control prevent one or more hours of working during Mon-Fri, the employer may choose to work up to 10 hour straight time weekdays. Work may be scheduled up to 10 hours per Mon-Fri for the purpose of reaching 40 hours @ straight time. Make up days may also include 8

*Make up day allowed comment*

Saturday

**Apprentice Rates:**

0 - 1,000 hours	\$37.60	\$53.03	\$68.45
1,001 - 2,000 hours	\$38.79	\$54.81	\$70.83
2,001 - 3,000 hours	\$39.98	\$56.60	\$73.21
3,001 - 4,000 hours	\$42.35	\$60.15	\$77.95

Official Request #: 743  
 Requestor: Troy School District  
 Project Description: Boulan Park & Larson Middle School Interior  
 Project Number: 2013 Bond Program, Series 1, BID 9812  
 County: Oakland

**Official Rate Schedule**  
**Every contractor and subcontractor shall keep posted on the construction site, in a conspicuous place, a copy of all prevailing wage and fringe benefit rates prescribed in a contract.**

# Official 2015 Prevailing Wage Rates for State Funded Projects

**Issue Date:** 6/1/2015

**Contract must be awarded by:** 8/30/2015

**Page 14 of 35**

Classification Name	Description	Last Updated	Straight Hourly	Time and Half	a Double Time	Overtime Provision
------------------------	-------------	-----------------	--------------------	------------------	------------------	-----------------------

**Laborer - Hazardous**

Class A Laborer - performing work in conjunction with site preparation and other preliminary work prior to actual removal, handling, or containment of hazardous waste substances not requiring use of personal protective equipment required by state or federal regulations; or a laborer performing work in conjunction with the removal, handling, or containment of hazardous waste substances when used of personal protective equipment level "D" is required.	LHAZ-Z2-A	11/1/2013	\$43.54	\$61.94	\$80.33	H H H H H H D Y
---	-----------	-----------	---------	---------	---------	-----------------

*Make up day allowed comment*

4 10s allowed M-Th or T-F; inclement weather makeup day Friday

**Apprentice Rates:**

0-1,000 work hours	\$37.60	\$53.03	\$68.45
1,001-2,000 work hours	\$38.79	\$54.81	\$70.83
2,001-3,000 work hours	\$39.98	\$56.60	\$73.21
3,001-4,000 work hours	\$42.35	\$60.15	\$77.95

Class B Laborer - performing work in conjunction with the removal, handling, or containment of hazardous waste substances when the use of personal protective equipment levels "A", "B" or "C" is required.	LHAZ-Z2-B	11/7/2014	\$44.54	\$63.44	\$82.33	H H H H H H D Y
---	-----------	-----------	---------	---------	---------	-----------------

*Make up day allowed comment*

4 10s allowed M-Th or T-F; inclement weather makeup day Friday

**Apprentice Rates:**

0-1,000 work hours	\$38.36	\$54.17	\$69.97
1,001-2,000 work hours	\$39.59	\$56.01	\$72.43
2,001-3,000 work hours	\$40.83	\$57.87	\$74.91
3,001-4,000 work hours	\$43.30	\$61.58	\$79.85

Official Request #: 743  
 Requestor: Troy School District  
 Project Description: Boulan Park & Larson Middle School Interior  
 Project Number: 2013 Bond Program, Series 1, BID 9812  
 County: Oakland

**Official Rate Schedule**  
**Every contractor and subcontractor shall keep posted on the construction site, in a conspicuous place, a copy of all prevailing wage and fringe benefit rates prescribed in a contract.**

# Official 2015 Prevailing Wage Rates for State Funded Projects

**Issue Date:** 6/1/2015

**Contract must be awarded by:** 8/30/2015

**Page 15 of 35**

Classification Name	Description	Last Updated	Straight Hourly	Time and Half	a Double Time	Overtime Provision
------------------------	-------------	-----------------	--------------------	------------------	------------------	-----------------------

**Laborer Underground - Tunnel, Shaft & Caisson**

Class I - Tunnel, shaft and caisson laborer, dump man, shanty man, hog house tender, testing man (on gas), and watchman.	LAUCT-Z1-1	9/6/2013	\$37.87	\$48.66	\$59.44	X X X X X X X D Y
--	------------	----------	---------	---------	---------	-------------------

**Apprentice Rates:**

0-1,000 work hours	\$33.05	\$41.43	\$49.80
1,001-2,000 work hours	\$34.02	\$42.88	\$51.74
2,001-3,000 work hours	\$34.98	\$44.32	\$53.66
3,001-4,000 work hours	\$36.91	\$47.21	\$57.52

Class II - Manhole, headwall, catch basin builder, bricklayer tender, mortar man, material mixer, fence erector, and guard rail builder.	LAUCT-Z1-2	9/6/2013	\$37.98	\$48.82	\$59.66	X X X X X X X D Y
--	------------	----------	---------	---------	---------	-------------------

**Apprentice Rates:**

0-1,000 work hours	\$33.14	\$41.56	\$49.98
1,001-2,000 work hours	\$34.10	\$43.00	\$51.90
2,001-3,000 work hours	\$35.07	\$44.45	\$53.84
3,001-4,000 work hours	\$37.01	\$47.37	\$57.72

Official Request #: 743  
 Requestor: Troy School District  
 Project Description: Boulan Park & Larson Middle School Interior  
 Project Number: 2013 Bond Program, Series 1, BID 9812  
 County: Oakland

**Official Rate Schedule**  
**Every contractor and subcontractor shall keep posted on the construction site, in a conspicuous place, a copy of all prevailing wage and fringe benefit rates prescribed in a contract.**

# Official 2015 Prevailing Wage Rates for State Funded Projects

**Issue Date:** 6/1/2015

**Contract must be awarded by:** 8/30/2015

**Page 16 of 35**

Classification Name	Description	Last Updated	Straight Hourly	Time and Half	a Double Time	Overtime Provision
=====						
Class III - Air tool operator (jack hammer man, bush hammer man and grinding man), first bottom man, second bottom man, cage tender, car pusher, carrier man, concrete man, concrete form man, concrete repair man, cement invert laborer, cement finisher, concrete shoveler, conveyor man, floor man, gasoline and electric tool operator, gunnite man, grout operator, welder, heading dinky man, inside lock tender, pea gravel operator, pump man, outside lock tender, scaffold man, top signal man, switch man, track man, tugger man, utility man, vibrator man, winch operator, pipe jacking man, wagon drill and air track operator and concrete saw operator (under 40 h.p.).	LAUCT-Z1-3	9/6/2013	\$38.04	\$48.91	\$59.78	X X X X X X D Y

**Apprentice Rates:**

0-1,000 work hours	\$33.18	\$41.62	\$50.06
1,001-2,000 work hours	\$34.15	\$43.07	\$52.00
2,001-3,000 work hours	\$35.12	\$44.53	\$53.94
3,001-4,000 work hours	\$37.07	\$47.45	\$57.84

Class IV - Tunnel, shaft and caisson mucker, bracer man, liner plate man, long haul dinky driver and well point man.	LAUCT-Z1-4	9/6/2013	\$38.22	\$49.18	\$60.14	X X X X X X D Y
--	------------	----------	---------	---------	---------	-----------------

**Apprentice Rates:**

0-1,000 work hours	\$33.32	\$41.83	\$50.34
1,001-2,000 work hours	\$34.30	\$43.30	\$52.30
2,001-3,000 work hours	\$35.28	\$44.77	\$54.26
3,001-4,000 work hours	\$37.24	\$47.71	\$58.18

Official Request #: 743

Requestor: Troy School District

Project Description: Boulan Park & Larson Middle School Interior

Project Number: 2013 Bond Program, Series 1, BID 9812

County: Oakland

**Official Rate Schedule**

**Every contractor and subcontractor shall keep posted on the construction site, in a conspicuous place, a copy of all prevailing wage and fringe benefit rates prescribed in a contract.**

# Official 2015 Prevailing Wage Rates for State Funded Projects

**Issue Date:** 6/1/2015

**Contract must be awarded by:** 8/30/2015

**Page 17 of 35**

Classification Name	Description	Last Updated	Straight Hourly	Time and Half	a Double Time	Overtime Provision
------------------------	-------------	-----------------	--------------------	------------------	------------------	-----------------------

Class V - Tunnel, shaft and caisson miner, drill runner, keyboard operator, power knife operator, reinforced steel or mesh man (e.g. wire mesh, steel mats, dowel bars)	LAUCT-Z1-5	9/6/2013	\$38.47	\$49.56	\$60.64	X X X X X X X D Y
---	------------	----------	---------	---------	---------	-------------------

**Apprentice Rates:**

0-1,000 work hours	\$33.50	\$42.10	\$50.70
1,001-2,000 work hours	\$34.50	\$43.60	\$52.70
2,001-3,000 work hours	\$35.49	\$45.09	\$54.68
3,001-4,000 work hours	\$37.48	\$48.07	\$58.66

Class VI - Dynamite man and powder man.	LAUCT-Z1-6	9/6/2013	\$38.80	\$50.05	\$61.30	X X X X X X X D Y
---	------------	----------	---------	---------	---------	-------------------

**Apprentice Rates:**

0-1,000 work hours	\$33.75	\$42.47	\$51.20
1,001-2,000 work hours	\$34.76	\$43.99	\$53.22
2,001-3,000 work hours	\$35.77	\$45.51	\$55.24
3,001-4,000 work hours	\$37.79	\$48.53	\$59.28

Class VII - Restoration laborer, seeding, sodding, planting, cutting, mulching and topsoil grading and the restoration of property such as replacing mail boxes, wood chips, planter boxes and flagstones.	LAUCT-Z1-7	9/6/2013	\$32.08	\$39.97	\$47.86	X X X X X X X D Y
--	------------	----------	---------	---------	---------	-------------------

**Apprentice Rates:**

0-1,000 work hours	\$28.71	\$34.91	\$41.12
1,001-2,000 work hours	\$29.38	\$35.92	\$42.46
2,001-3,000 work hours	\$30.06	\$36.94	\$43.82
3,001-4,000 work hours	\$31.41	\$38.97	\$46.52

Official Request #: 743  
 Requestor: Troy School District  
 Project Description: Boulan Park & Larson Middle School Interior  
 Project Number: 2013 Bond Program, Series 1, BID 9812  
 County: Oakland

**Official Rate Schedule**  
**Every contractor and subcontractor shall keep posted on the construction site, in a conspicuous place, a copy of all prevailing wage and fringe benefit rates prescribed in a contract.**

# Official 2015 Prevailing Wage Rates for State Funded Projects

**Issue Date:** 6/1/2015

**Contract must be awarded by:** 8/30/2015

**Page 18 of 35**

Classification Name	Description	Last Updated	Straight Hourly	Time and Half	a Double Time	Overtime Provision
------------------------	-------------	-----------------	--------------------	------------------	------------------	-----------------------

## Landscape Laborer

Landscape Specialist includes air, gas, and diesel equipment operator, skidsteer (or equivalent), lawn sprinkler installer on landscaping work where seeding, sodding, planting, cutting, trimming, backfilling, rough grading or maintenance of landscape projects occurs.	LLAN-Z1-A	6/26/2014	\$28.58	\$39.49	\$50.39	X X H X X X H D Y
---	-----------	-----------	---------	---------	---------	-------------------

Sundays paid at time & one half. Holidays paid at double time.

Skilled Landscape Laborer: small power tool operator, lawn sprinkler installers' tender, material mover, truck driver when seeding, sodding, planting, cutting, trimming, backfilling, rough grading or maintaining of landscape projects occurs	LLAN-Z1-B	6/26/2014	\$24.36	\$33.16	\$41.95	X X H X X X H D Y
--	-----------	-----------	---------	---------	---------	-------------------

Sundays paid at time & one half. Holidays paid at double time.

## Marble Finisher

Marble Finisher A 4 ten workweek may be worked Monday thru Thursday or Tuesday thru Friday.	BR1-MF	10/20/2014	\$43.48	\$54.29	\$65.10	H H D H D D D D Y
--	--------	------------	---------	---------	---------	-------------------

### Apprentice Rates:

Level 1	\$19.04	\$25.12	\$31.20
Level 2	\$20.24	\$26.92	\$33.60
Level 3	\$27.01	\$33.96	\$40.90
Level 4	\$28.47	\$36.14	\$43.82
Level 5	\$29.99	\$37.84	\$45.70
Level 6	\$31.61	\$39.86	\$48.10
Level 7	\$33.30	\$41.59	\$49.87
Level 8	\$34.79	\$43.48	\$52.17

Official Request #: 743  
 Requestor: Troy School District  
 Project Description: Boulan Park & Larson Middle School Interior  
 Project Number: 2013 Bond Program, Series 1, BID 9812  
 County: Oakland

**Official Rate Schedule**  
**Every contractor and subcontractor shall keep posted on the construction site, in a conspicuous place, a copy of all prevailing wage and fringe benefit rates prescribed in a contract.**



# Official 2015 Prevailing Wage Rates for State Funded Projects

**Issue Date:** 6/1/2015

**Contract must be awarded by:** 8/30/2015

**Page 19 of 35**

Classification Name	Description	Last Updated	Straight Hourly	Time and Half	a Double Time	Overtime Provision
------------------------	-------------	-----------------	--------------------	------------------	------------------	-----------------------

## Marble Mason

Marble Mason	BR1-MM	10/17/2014	\$50.29	\$64.51	\$78.72	H H D H D D D D Y
--------------	--------	------------	---------	---------	---------	-------------------

A 4 ten workweek may be worked Monday thru Thursday or Tuesday thru Friday.

### Apprentice Rates:

Level 1	\$25.14	\$32.65	\$40.15
Level 2	\$28.20	\$36.49	\$44.78
Level 3	\$33.41	\$41.97	\$50.53
Level 4	\$36.15	\$45.66	\$55.17
Level 5	\$38.42	\$48.17	\$57.92
Level 6	\$42.07	\$53.56	\$65.05
Level 7	\$42.74	\$54.38	\$66.02
Level 8	\$43.67	\$55.78	\$67.88

## Operating Engineer

Crane with boom & jib or leads 120' or longer	EN-324-A120	6/12/2014	\$57.11	\$74.62	\$92.13	X X H H D D D D Y
---	-------------	-----------	---------	---------	---------	-------------------

*comment*

Double time after 12 hours M-F

Crane with boom & jib or leads 140' or longer	EN-324-A140	6/12/2014	\$57.93	\$75.85	\$93.77	X X H H D D D D Y
---	-------------	-----------	---------	---------	---------	-------------------

Work in excess of 12 per day M-F shall be paid at double time.

Crane with boom & jib or leads 220' or longer	EN-324-A220	6/12/2014	\$58.23	\$76.30	\$94.37	X X H H D D D D Y
---	-------------	-----------	---------	---------	---------	-------------------

Work in excess of 12 per day M-F shall be paid at double time.

Crane with boom & jib or leads 300' or longer	EN-324-A300	6/12/2014	\$59.73	\$78.55	\$97.37	X X H H D D D D Y
---	-------------	-----------	---------	---------	---------	-------------------

Work in excess of 12 per day M-F shall be paid at double time.

Official Request #: 743  
 Requestor: Troy School District  
 Project Description: Boulan Park & Larson Middle School Interior  
 Project Number: 2013 Bond Program, Series 1, BID 9812  
 County: Oakland

**Official Rate Schedule**  
**Every contractor and subcontractor shall keep posted on the construction site, in a conspicuous place, a copy of all prevailing wage and fringe benefit rates prescribed in a contract.**

# Official 2015 Prevailing Wage Rates for State Funded Projects

**Issue Date:** 6/1/2015

**Contract must be awarded by:** 8/30/2015

**Page 20 of 35**

Classification Name Description		Last Updated	Straight Hourly	Time and Half	a Double Time	Overtime Provision
Crane with boom & jib or leads 400' or longer Work in excess of 12 per day M-F shall be paid at double time.	EN-324-A400	6/12/2014	\$61.23	\$80.80	\$100.37	X X H H D D D D Y
Compressor or welding machine Work in excess of 12 per day M-F shall be paid at double time.	EN-324-CW	6/12/2014	\$46.26	\$58.35	\$70.43	X X H H D D D D Y
Forklift, lull, extend-a-boom forklift Work in excess of 12 per day M-F shall be paid at double time.	EN-324-FL	6/12/2014	\$53.57	\$69.31	\$85.05	X X H H D D D D Y
Fireman or oiler Work in excess of 12 per day M-F shall be paid at double time.	EN-324-FO	6/12/2014	\$45.23	\$56.80	\$68.37	X X H H D D D D Y
Regular crane, job mechanic, concrete pump with boom  Work in excess of 12 per day M-F shall be paid at double time.	EN-324-RC	6/12/2014	\$56.25	\$73.33	\$90.41	X X H H D D D D Y
Regular engineer, hydro-excavator, remote controlled concrete breaker Work in excess of 12 per day M-F shall be paid at double time.	EN-324-RE	6/12/2014	\$55.28	\$71.88	\$88.47	X X H H D D D D Y

**Apprentice Rates:**

0-999 hours	\$44.32	\$55.94	\$67.55
1,000-1,999 hours	\$45.99	\$58.45	\$70.89
2,000-2,999 hours	\$47.64	\$60.92	\$74.19
3,000-3,999 hours	\$49.30	\$63.41	\$77.51
4,000-4,999 hours	\$50.96	\$65.90	\$80.83
5,000-5,999 hours	\$52.62	\$68.39	\$84.15

Official Request #: 743

Requestor: Troy School District

Project Description: Boulan Park & Larson Middle School Interior

Project Number: 2013 Bond Program, Series 1, BID 9812

County: Oakland

**Official Rate Schedule**

**Every contractor and subcontractor shall keep posted on the construction site, in a conspicuous place, a copy of all prevailing wage and fringe benefit rates prescribed in a contract.**

# Official 2015 Prevailing Wage Rates for State Funded Projects

**Issue Date:** 6/1/2015

**Contract must be awarded by:** 8/30/2015

**Page 21 of 35**

Classification Name Description	Last Updated	Straight Hourly	Time and Half	a Double Time	Overtime Provision
------------------------------------	-----------------	--------------------	------------------	------------------	-----------------------

**Operating Engineer - DIVER**

Diver/Wet Tender/Tender/Rov Pilot/Rov Tender	GLF-D	4/2/2014	\$52.80	\$79.20	\$105.60	H H H H H H H D N
--	-------	----------	---------	---------	----------	-------------------

**Operating Engineer - Marine Construction**

Diver/Wet Tender, Engineer (hydraulic dredge)	GLF-1	2/12/2014	\$65.00	\$84.85	\$104.70	X X H H H H H D Y
---	-------	-----------	---------	---------	----------	-------------------

*Make up day allowed*

Subdivision of county all Great Lakes, islands therein, & connecting & tributary waters

Crane/Backhoe Operator, 70 ton or over Tug Operator, Mechanic/Welder, Assistant Engineer (hydraulic dredge), Leverman (hydraulic dredge), Diver Tender	GLF-2	2/12/2014	\$63.50	\$82.60	\$101.70	X X H H H H H D Y
--	-------	-----------	---------	---------	----------	-------------------

Holiday pay = \$120.80 per hour, wages &

*Make up day allowed*

Subdivision of county All Great Lakes, islands therein, & connecting & tributary waters

Friction, Lattice Boom or Crane License Certification	GLF-2B	2/12/2014	\$64.50	\$84.10	\$103.70	X X H H H H H D Y
---	--------	-----------	---------	---------	----------	-------------------

Holiday pay = \$123.30

*Make up day allowed*

Subdivision of county All Great Lakes, islands, therein, & connecting & tributary waters

Deck Equipment Operator, Machineryman, Maintenance of Crane (over 50 ton capacity) or Backhoe (115,000 lbs or more), Tug/Launch Operator, Loader, Dozer on Barge, Deck Machinery	GLF-3	2/12/2014	\$59.30	\$76.30	\$93.30	X X H H H H H D Y
--	-------	-----------	---------	---------	---------	-------------------

Holiday pay = \$110.30 per hour, wages &

*Make up day allowed*

Subdivision of county All Great Lakes, islands therein, & connecting & tributary waters

Official Request #: 743  
 Requestor: Troy School District  
 Project Description: Boulan Park & Larson Middle School Interior  
 Project Number: 2013 Bond Program, Series 1, BID 9812  
 County: Statewide

**Official Rate Schedule**  
**Every contractor and subcontractor shall keep posted on the construction site, in a conspicuous place, a copy of all prevailing wage and fringe benefit rates prescribed in a contract.**

# Official 2015 Prevailing Wage Rates for State Funded Projects

**Issue Date:** 6/1/2015

**Contract must be awarded by:** 8/30/2015

**Page 22 of 35**

Classification Name Description		Last Updated	Straight Hourly	Time and Half	a Double Time	Overtime Provision
Deck Equipment Operator, (Machineryman/Fireman), (4 equipment units or more), Off Road Trucks, Deck Hand, Tug Engineer, & Crane Maintenance 50 ton capacity and under or Backhoe 115,000 lbs or less, Assistant Tug Operator	GLF-4	2/12/2014	\$53.60	\$67.75	\$81.90	X X H H H H H D Y

Holiday pay = \$96.05 per hour, wages & fringes

*Make up day allowed*

Subdivision of county All Great Lakes, islands therein, & connecting & tributary waters

## Operating Engineer Steel Work

Forklift, 1 Drum Hoist <i>Make up day allowed comment</i> 4 10s allowed M-Th with Friday makeup day because of bad weather	EN-324-ef	9/5/2014	\$58.16	\$76.37	\$94.58	H H D H H H D D Y
Crane w/ 120' boom or longer <i>Make up day allowed comment</i> 4 10s allowed M-Th with Friday makeup day because of bad weather	EN-324-SW120	9/5/2014	\$60.86	\$80.42	\$99.98	H H D H H H D D Y
Crane w/ 120' boom or longer w/ Oiler D <i>Make up day allowed comment</i> 4 10s allowed M-Th with Friday makeup day because of bad weather	EN-324-SW120-O Y	9/5/2014	\$61.86	\$81.92	\$101.98	H H D H H H D
Crane w/ 140' boom or longer <i>Make up day allowed comment</i> 4 10s allowed M-Th with Friday makeup day because of bad weather	EN-324-SW140	9/5/2014	\$62.04	\$82.19	\$102.34	H H D H H H D D Y
Crane w/ 140' boom or longer W/ Oiler D <i>Make up day allowed comment</i> 4 10s allowed M-Th with Friday makeup day because of bad weather	EN-324-SW140-O Y	9/5/2014	\$63.04	\$83.69	\$104.34	H H D H H H D
Boom & Jib 220' or longer <i>Make up day allowed comment</i> 4 10s allowed M-Th with Friday makeup day because of bad weather	EN-324-SW220	9/5/2014	\$62.31	\$82.60	\$102.88	H H D H H H D D Y
Crane w/ 220' boom or longer w/ Oiler D <i>Make up day allowed comment</i> 4 10s allowed M-Th with Friday makeup day because of bad weather	EN-324-SW220-O Y	9/5/2014	\$63.31	\$84.10	\$104.88	H H D H H H D

Official Request #: 743

Requestor: Troy School District

Project Description: Boulan Park & Larson Middle School Interior

Project Number: 2013 Bond Program, Series 1, BID 9812

County: Oakland

## Official Rate Schedule

**Every contractor and subcontractor shall keep posted on the construction site, in a conspicuous place, a copy of all prevailing wage and fringe benefit rates prescribed in a contract.**

# Official 2015 Prevailing Wage Rates for State Funded Projects

**Issue Date:** 6/1/2015

**Contract must be awarded by:** 8/30/2015

**Page 23 of 35**

Classification Name Description	Last Updated	Straight Hourly	Time and Half	a Double Time	Overtime Provision
Boom & Jib 300' or longer <i>Make up day allowed comment</i> 4 10s allowed M-Th with Friday makeup day because of bad weather	EN-324-SW300 9/5/2014	\$63.81	\$84.85	\$105.88	H H D H H H D D Y
Crane w/ 300' boom or longer w/ Oiler D <i>Make up day allowed comment</i> 4 10s allowed M-Th with Friday makeup day because of bad weather	EN-324-SW300-O Y	9/5/2014	\$64.81	\$86.35	\$107.88 H H D H H H D
Boom & Jib 400' or longer <i>Make up day allowed comment</i> 4 10s allowed M-Th with Friday makeup day because of bad weather	EN-324-SW400 9/5/2014	\$65.31	\$87.10	\$108.88	H H D H H H D D Y
Crane w/ 400' boom or longer w/ Oiler D <i>Make up day allowed comment</i> 4 10s allowed M-Th with Friday makeup day because of bad weather	EN-324-SW400-O Y	9/5/2014	\$66.31	\$88.60	\$110.88 H H D H H H D
Crane Operator, Job Mechanic, 3 Drum Hoist & Excavator <i>Make up day allowed comment</i> 4 10s allowed M-Th with Friday makeup day because of bad weather	EN-324-SWCO 9/5/2014	\$60.50	\$79.88	\$99.26	H H D H H H D D Y
<b>Apprentice Rates:</b>					
	0-999 hours	\$47.87	\$61.43	\$75.00	
	1,000-1,999 hours	\$49.81	\$64.35	\$78.88	
	2,000-2,999 hours	\$51.74	\$67.24	\$82.74	
	3,000-3,999 hours	\$53.68	\$70.15	\$86.62	
	4,000-4,999 hours	\$55.62	\$73.07	\$90.50	
	5,000 hours	\$57.56	\$75.97	\$94.38	
Crane Operator w/ Oiler D <i>Make up day allowed comment</i> 4 10s allowed M-Th with Friday makeup day because of bad weather	EN-324-SWCO-O Y	9/5/2014	\$61.50	\$81.38	\$101.26 H H D H H H D
Compressor or Welder Operator <i>Make up day allowed comment</i> 4 10s allowed M-Th with Friday makeup day because of bad weather	EN-324-SWCW 9/5/2014	\$53.15	\$68.86	\$84.56	H H D H H H D D Y

Official Request #: 743  
 Requestor: Troy School District  
 Project Description: Boulan Park & Larson Middle School Interior  
 Project Number: 2013 Bond Program, Series 1, BID 9812  
 County: Oakland

**Official Rate Schedule**  
**Every contractor and subcontractor shall keep posted on the construction site, in a conspicuous place, a copy of all prevailing wage and fringe benefit rates prescribed in a contract.**

# Official 2015 Prevailing Wage Rates for State Funded Projects

**Issue Date:** 6/1/2015

**Contract must be awarded by:** 8/30/2015

**Page 24 of 35**

Classification Name Description	Last Updated	Straight Hourly	Time and Half	a Double Time	Overtime Provision
Hoisting Operator, 2 Drum Hoist, & Rubber Tire Backhoe <i>Make up day allowed comment</i> 4 10s allowed M-Th with Friday makeup day because of bad weather	EN-324-SWHO 9/5/2014	\$59.86	\$78.92	\$97.98	H H D H H H D D Y
Oiler <i>Make up day allowed comment</i> 4 10s allowed M-Th with Friday makeup day because of bad weather	EN-324-SWO 9/5/2014	\$51.64	\$66.59	\$81.54	H H D H H H D D Y
Tower Crane & Derrick where work is 50' or more above first level <i>Make up day allowed comment</i> 4 10s allowed M-Th with Friday makeup day because of bad weather	EN-324-SWTD50 Y	9/5/2014	\$61.59	\$81.52	\$101.44 H H D H H H D
Tower Crane & Derrick 50' or more w/ Oiler where work station is 50' or more above first <i>Make up day allowed comment</i> 4 10s allowed M-Th with Friday makeup day because of bad weather	EN-324-SWTD50-O Y	9/5/2014	\$62.59	\$83.02	\$103.44 H H D H H H D

## Operating Engineer Underground

Class I Equipment EN-324A1-UC1 10/14/2014 \$51.74 \$66.98 \$82.22 H H H H H H H D Y

### Apprentice Rates:

0-999 hours	\$41.79	\$52.45	\$63.12
1,000-1,999 hours	\$43.32	\$54.75	\$66.18
2,000-2,999 hours	\$44.84	\$57.03	\$69.22
3,000-3,999 hours	\$46.36	\$59.31	\$72.26
4,000-4,999 hours	\$47.89	\$61.61	\$75.32
5,000-5,999 hours	\$49.41	\$63.89	\$78.36

Class II Equipment EN-324A1-UC2 10/14/2014 \$47.01 \$59.89 \$72.76 H H H H H H H D Y

Class III Equipment EN-324A1-UC3 10/14/2014 \$46.28 \$58.79 \$71.30 H H H H H H H D Y

Official Request #: 743

Requestor: Troy School District

Project Description: Boulan Park & Larson Middle School Interior

Project Number: 2013 Bond Program, Series 1, BID 9812

County: Oakland

### Official Rate Schedule

**Every contractor and subcontractor shall keep posted on the construction site, in a conspicuous place, a copy of all prevailing wage and fringe benefit rates prescribed in a contract.**

# Official 2015 Prevailing Wage Rates for State Funded Projects

**Issue Date:** 6/1/2015

**Contract must be awarded by:** 8/30/2015

**Page 25 of 35**

Classification Name Description	Last Updated	Straight Hourly	Time and Half	a Double Time	Overtime Provision
Class IV Equipment	EN-324A1-UC4 10/14/2014	\$45.71	\$57.94	\$70.16	H H H H H H H D Y
Master Mechanic Y	EN-324A1-UMM	10/14/2014	\$51.99	\$67.81	\$83.63 H H H H H H H D

**Painter**

Painter (8 hours of repaint work performed on Sunday shall be paid time & one half rate) PT-22-P 10/8/2014 \$42.82 \$55.63 \$68.43 H H D H D D D D Y

Four 10s allowed Monday-Thursday with Friday makeup day if job down due to weather, holiday or other conditions beyond the control of the employer.

*Make up day allowed comment*  
Fridays for bad weather or holidays

**Apprentice Rates:**

First 6 months	\$30.02	\$36.43	\$42.83
Second 6 months	\$33.86	\$42.19	\$50.51
Third 6 months	\$35.14	\$44.11	\$53.07
Fourth 6 months	\$36.42	\$46.03	\$55.63
Fifth 6 months	\$37.70	\$47.95	\$58.19
Final 6 months	\$38.98	\$49.87	\$60.75

**Pipe and Manhole Rehab**

General Laborer for rehab work or normal cleaning and cctv work-top man, scaffold man, CCTV assistant, jetter-vac assistant TM247 4/17/2015 \$28.20 \$38.20 H H H H H H H H N

Tap cutter/CCTV Tech/Grout Equipment Operator: unit driver and operator of CCTV; grouting equipment and tap cutting equipment TM247-2 4/17/2015 \$32.70 \$44.95 H H H H H H H H N

Official Request #: 743  
Requestor: Troy School District  
Project Description: Boulan Park & Larson Middle School Interior  
  
Project Number: 2013 Bond Program, Series 1, BID 9812  
County: Statewide

**Official Rate Schedule**  
Every contractor and subcontractor shall keep posted on the construction site, in a conspicuous place, a copy of all prevailing wage and fringe benefit rates prescribed in a contract.

# Official 2015 Prevailing Wage Rates for State Funded Projects

**Issue Date:** 6/1/2015

**Contract must be awarded by:** 8/30/2015

**Page 26 of 35**

Classification Name Description		Last Updated	Straight Hourly	Time and Half	a Double Time	Overtime Provision
CCTV Technician/Combo Unit Operator: unit driver and operator of cctv unit or combo unit in connection with normal cleaning and televising work	TM247-3	4/17/2015	\$31.45	\$43.07		H H H H H H H H N
Boiler Operator: unit driver and operator of steam/water heater units and all ancillary equipment associated	TM247-4	4/17/2015	\$33.20	\$45.70		H H H H H H H H N
Combo Unit driver & Jetter-Vac Operator	TM247-5	4/17/2015	\$33.20	\$45.70		H H H H H H H H N
Pipe Bursting & Slip-lining Equipment Operator	TM247-6	4/17/2015	\$34.20	\$47.20		H H H H H H H H N

**Pipefitter**

Pipefitter	PF-636	6/30/2014	\$66.73	\$87.93	\$105.13	H H D H D D D D Y
------------	--------	-----------	---------	---------	----------	-------------------

*comment*

Four 10s allowed during the week preceding, following and/or the week of a holiday.

**Apprentice Rates:**

1st & 2nd periods	\$26.93	\$35.28	\$42.28
3rd period	\$28.93	\$38.28	\$46.28
4th period	\$30.18	\$40.16	\$48.78
5th period	\$31.43	\$42.03	\$51.28
6th period	\$32.68	\$43.90	\$53.78
7th period	\$33.93	\$45.78	\$56.28
8th period	\$34.93	\$47.28	\$58.28
9th period	\$35.93	\$48.78	\$60.28
10th period	\$37.36	\$50.92	\$63.14

Official Request #: 743

Requestor: Troy School District

Project Description: Boulan Park & Larson Middle School Interior

Project Number: 2013 Bond Program, Series 1, BID 9812

County: Oakland

**Official Rate Schedule**

**Every contractor and subcontractor shall keep posted on the construction site, in a conspicuous place, a copy of all prevailing wage and fringe benefit rates prescribed in a contract.**



# Official 2015 Prevailing Wage Rates for State Funded Projects

**Issue Date:** 6/1/2015

**Contract must be awarded by:** 8/30/2015

**Page 27 of 35**

Classification Name	Description	Last Updated	Straight Hourly	Time and Half	a Double Time	Overtime Provision
------------------------	-------------	-----------------	--------------------	------------------	------------------	-----------------------

**Plasterer**

Plasterer	BR1P	11/1/2012	\$45.04	\$67.56	\$90.08	H H H H H H D N
<i>Make up day allowed comment</i>						
Saturday						

**Apprentice Rates:**

1st 6 months	\$32.11	\$48.17	\$64.22
2nd 6 months	\$33.40	\$50.10	\$66.80
3rd 6 months	\$34.69	\$52.04	\$69.38
4th 6 months	\$37.28	\$55.92	\$74.56
5th 6 months	\$39.87	\$59.81	\$79.74
6th 6 months	\$42.45	\$63.68	\$84.90

Plasterer	PL67	9/8/2010	\$44.72	\$60.11	\$75.50	H H H X D D D D N
-----------	------	----------	---------	---------	---------	-------------------

**Apprentice Rates:**

1st 6 months	\$29.33	\$37.02	\$44.72
2nd 6 months	\$30.87	\$39.34	\$47.80
3rd 6 months	\$32.41	\$41.64	\$50.88
4th 6 months	\$35.49	\$46.26	\$57.04
5th 6 months	\$38.56	\$51.16	\$63.76
6th 6 months	\$41.64	\$55.49	\$69.34

Official Request #: 743  
 Requestor: Troy School District  
 Project Description: Boulan Park & Larson Middle School Interior  
 Project Number: 2013 Bond Program, Series 1, BID 9812  
 County: Oakland

**Official Rate Schedule**  
**Every contractor and subcontractor shall keep posted on the construction site, in a conspicuous place, a copy of all prevailing wage and fringe benefit rates prescribed in a contract.**

# Official 2015 Prevailing Wage Rates for State Funded Projects

**Issue Date:** 6/1/2015

**Contract must be awarded by:** 8/30/2015

**Page 28 of 35**

Classification Name	Description	Last Updated	Straight Hourly	Time and Half	a Double Time	Overtime Provision
------------------------	-------------	-----------------	--------------------	------------------	------------------	-----------------------

## Plumber

Plumber	PL-98	7/18/2013	\$64.45	\$84.87	\$101.29	H H D H D D D D Y
---------	-------	-----------	---------	---------	----------	-------------------

*comment*

4 tens allowed M-Th or T-F; OT of time and one half required on 11th & 12th hour of any ten hour days

### Apprentice Rates:

Period 1	\$19.93	\$26.43	\$32.93
Period 2	\$23.90	\$31.40	\$38.90
Period 3	\$30.60	\$39.19	\$47.77
Period 4	\$31.23	\$40.13	\$49.03
Period 5	\$32.39	\$41.87	\$51.35
Period 6	\$33.54	\$43.59	\$53.65
Period 7	\$34.69	\$45.32	\$55.95
Period 8	\$35.86	\$47.07	\$58.29
Period 9	\$37.01	\$48.80	\$60.59
Period 10	\$38.16	\$50.53	\$62.89

## Rofer

Commercial Roofer	RO-149-WOM	8/18/2008	\$48.46	\$62.29	\$76.62	H H D H H H D D N
-------------------	------------	-----------	---------	---------	---------	-------------------

Straight time is not to exceed ten (10) hours per day or forty (40) hours per week.

*Make up day allowed*

### Apprentice Rates:

Apprentice 1	\$32.62	\$39.86	\$48.04
Apprentice 2	\$36.80	\$44.80	\$53.30
Apprentice 3	\$38.22	\$46.93	\$56.14
Apprentice 4	\$39.25	\$48.48	\$58.20
Apprentice 5	\$40.47	\$50.30	\$60.64
Apprentice 6	\$41.87	\$52.40	\$63.44

## Sewer Relining

Class I-Operator of audio visual CCTV system including remote in-ground cutter and other equipment used in conjunction with CCTV	SR-I	11/3/2014	\$42.76	\$57.75	\$72.74	H H H H H H H D N
--	------	-----------	---------	---------	---------	-------------------

Official Request #: 743  
 Requestor: Troy School District  
 Project Description: Boulan Park & Larson Middle School Interior  
  
 Project Number: 2013 Bond Program, Series 1, BID 9812  
 County: Statewide

**Official Rate Schedule**  
**Every contractor and subcontractor shall keep posted on the construction site, in a conspicuous place, a copy of all prevailing wage and fringe benefit rates prescribed in a contract.**

# Official 2015 Prevailing Wage Rates for State Funded Projects

**Issue Date:** 6/1/2015

**Contract must be awarded by:** 8/30/2015

**Page 29 of 35**

Classification Name	Description	Last Updated	Straight Hourly	Time and Half	a Double Time	Overtime Provision
	Class II-Operator of hot water heaters and circulation system; water jetters; and vacuum and mechanical debris removal systems and those assisting.	SR-II 11/3/2014	\$41.23	\$55.46	\$69.68	H H H H H H D N

**Sheet Metal Worker**

Sheet Metal Worker	SHM-80	9/9/2014	\$61.83	\$78.74	\$95.65	H H D X H H H D Y
A 4 10 schedule may be worked, 4 consecutive days Monday thru Friday.						

**Apprentice Rates:**

1st & 2nd Periods Indentured after 6-1-11	\$39.18	\$46.79	\$54.40
3rd & 4th Periods Indentured after 6-1-11	\$40.88	\$49.34	\$57.80
5th & 6th Periods Indentured after 6-1-11	\$42.56	\$51.86	\$61.16
7th & 8th Periods Indentured after 6-1-11	\$44.25	\$54.40	\$64.54
9th & 10th Periods Indentured before 6-1-11	\$51.92	\$64.44	\$76.96

Siding and decking <i>Make up day allowed</i>	SHM-80-SD	1/13/2014	\$42.07	\$54.28	\$66.48	H H H H H H D Y
--	-----------	-----------	---------	---------	---------	-----------------

Official Request #: 743  
 Requestor: Troy School District  
 Project Description: Boulan Park & Larson Middle School Interior  
 Project Number: 2013 Bond Program, Series 1, BID 9812  
 County: Oakland

**Official Rate Schedule**  
**Every contractor and subcontractor shall keep posted on the construction site, in a conspicuous place, a copy of all prevailing wage and fringe benefit rates prescribed in a contract.**

# Official 2015 Prevailing Wage Rates for State Funded Projects

Issue Date: 6/1/2015

Contract must be awarded by: 8/30/2015

Page 30 of 35

Classification Name      Description		Last Updated	Straight Hourly	Time and Half	a Double Time	Overtime Provision
<b>Sprinkler Fitter</b>						
Sprinkler Fitter		SP 704	12/19/2014	\$64.92	\$86.15	\$107.38 H H D H D D D D Y
4 ten hour days allowed Monday-Friday						
Double time pay due after 12 hours worked M-F						

**Apprentice Rates:**

1st Period	\$28.29	\$36.78	\$45.27
2nd Period	\$41.57	\$51.12	\$60.68
3rd Period	\$43.69	\$54.30	\$64.92
4th Period	\$45.81	\$57.48	\$69.16
5th Period	\$47.94	\$60.68	\$73.42
6th Period	\$50.06	\$63.86	\$77.66
7th Period	\$52.18	\$67.04	\$81.90
8th Period	\$54.30	\$70.22	\$86.14
9th Period	\$56.43	\$73.42	\$90.40
10th Period	\$58.55	\$76.60	\$94.64

**Terrazzo**

Terrazzo Finisher		BR1-TRF	10/17/2014	\$43.97	\$55.03	\$66.08 H H D H D D D D Y
A 4 ten workweek may be worked Monday thru Thursday or Tuesday thru Friday.						

**Apprentice Rates:**

Level 1	\$19.04	\$25.12	\$31.20
Level 2	\$20.24	\$26.92	\$33.60
Level 3	\$27.01	\$33.96	\$40.90
Level 4	\$28.47	\$36.14	\$43.82
Level 5	\$29.99	\$37.84	\$45.70
Level 6	\$31.61	\$39.86	\$48.10
Level 7	\$33.30	\$41.59	\$49.87
Level 8	\$34.79	\$43.48	\$52.17

Official Request #: 743

Requestor: Troy School District

Project Description: Boulan Park & Larson Middle School Interior

Project Number: 2013 Bond Program, Series 1, BID 9812

County: Oakland

**Official Rate Schedule**

Every contractor and subcontractor shall keep posted on the construction site, in a conspicuous place, a copy of all prevailing wage and fringe benefit rates prescribed in a contract.

# Official 2015 Prevailing Wage Rates for State Funded Projects

**Issue Date:** 6/1/2015

**Contract must be awarded by:** 8/30/2015

**Page 31 of 35**

Classification Name	Description	Last Updated	Straight Hourly	Time and Half	a Double Time	Overtime Provision
Terrazzo Worker	BR1-TRW	10/17/2014	\$49.73	\$63.67	\$77.60	H H D H D D D D Y
A 4 ten workweek may be worked Monday thru Thursday or Tuesday thru Friday.						

**Apprentice Rates:**

Level 1	\$25.14	\$32.65	\$40.15
Level 2	\$28.20	\$36.49	\$44.78
Level 3	\$33.41	\$41.97	\$50.53
Level 4	\$36.15	\$45.66	\$55.17
Level 5	\$38.42	\$48.17	\$57.92
Level 6	\$42.07	\$53.56	\$65.05
Level 7	\$42.74	\$54.38	\$66.02
Level 8	\$43.67	\$55.78	\$67.88

**Tile**

Tile Finisher	BR1-TF	10/17/2014	\$43.50	\$54.32	\$65.14	H H D H D D D D Y
A 4 ten workweek may be worked Monday thru Thursday or Tuesday thru Friday.						

**Apprentice Rates:**

Level 1	\$19.04	\$25.12	\$31.20
Level 2	\$20.24	\$26.92	\$33.60
Level 3	\$27.01	\$33.96	\$40.90
Level 4	\$28.47	\$36.14	\$43.82
Level 5	\$29.99	\$37.84	\$45.70
Level 6	\$31.61	\$39.86	\$48.10
Level 7	\$33.30	\$41.59	\$49.87
Level 8	\$34.79	\$43.48	\$52.17

Official Request #: 743

Requestor: Troy School District

Project Description: Boulan Park & Larson Middle School Interior

Project Number: 2013 Bond Program, Series 1, BID 9812

County: Oakland

**Official Rate Schedule**

**Every contractor and subcontractor shall keep posted on the construction site, in a conspicuous place, a copy of all prevailing wage and fringe benefit rates prescribed in a contract.**

# Official 2015 Prevailing Wage Rates for State Funded Projects

**Issue Date:** 6/1/2015

**Contract must be awarded by:** 8/30/2015

**Page 32 of 35**

Classification Name	Description	Last Updated	Straight Hourly	Time and Half	a Double Time	Overtime Provision
Tile Layer	BR1-TL	10/17/2014	\$49.68	\$63.59	\$77.50	H H D H D D D D Y
A 4 ten workweek may be worked Monday thru Thursday or Tuesday thru Friday.						

**Apprentice Rates:**

Level 1	\$25.14	\$32.65	\$40.15
Level 2	\$28.20	\$36.49	\$44.78
Level 3	\$33.41	\$41.97	\$50.53
Level 4	\$36.15	\$45.66	\$55.17
Level 5	\$38.42	\$48.17	\$57.92
Level 6	\$42.07	\$53.56	\$65.05
Level 7	\$42.74	\$54.38	\$66.02
Level 8	\$43.67	\$55.78	\$67.88

**Truck Driver**

on all trucks of 8 cubic yard capacity or less (except dump trucks of 8 cubic yard capacity or over, tandem axle trucks, transit mix and semis, euclid type equipment, double bottoms and low boys)	TM-RB1	8/8/2013	\$41.92	\$37.85		H H H H H H H H Y
---	--------	----------	---------	---------	--	-------------------

of all trucks of 8 cubic yard capacity or over	TM-RB1A	8/8/2013	\$41.30	\$38.00		H H H H H H H H Y
--	---------	----------	---------	---------	--	-------------------

on euclid type equipment <i>Make up day allowed</i>	TM-RB1B	8/8/2013	\$41.45	\$38.23		H H H H H H H H Y
--	---------	----------	---------	---------	--	-------------------

Official Request #: 743  
 Requestor: Troy School District  
 Project Description: Boulan Park & Larson Middle School Interior  
 Project Number: 2013 Bond Program, Series 1, BID 9812  
 County: Oakland

**Official Rate Schedule**  
**Every contractor and subcontractor shall keep posted on the construction site, in a conspicuous place, a copy of all prevailing wage and fringe benefit rates prescribed in a contract.**

# Official 2015 Prevailing Wage Rates for State Funded Projects

Issue Date: 6/1/2015

Contract must be awarded by: 8/30/2015

Page 33 of 35

Classification Name	Description	Last Updated	Straight Hourly	Time and Half	a Double Time	Overtime Provision
------------------------	-------------	-----------------	--------------------	------------------	------------------	-----------------------

## Underground Laborer Open Cut, Class I

Construction Laborer	LAUC-Z1-1	9/5/2013	\$37.72	\$48.43	\$59.14	X X X X X X X D Y
----------------------	-----------	----------	---------	---------	---------	-------------------

### Apprentice Rates:

0-1,000 work hours	\$32.94	\$41.26	\$49.58
1,001-2,000 work hours	\$33.90	\$42.70	\$51.50
2,001-3,000 work hours	\$34.85	\$44.13	\$53.40
3,001-4,000 work hours	\$36.76	\$46.99	\$57.22

## Underground Laborer Open Cut, Class II

Mortar and material mixer, concrete form man, signal man, well point man, manhole, headwall and catch basin builder, guard rail builders, headwall, seawall, breakwall, dock builder and fence erector.	LAUC-Z1-2	10/25/2013	\$37.83	\$48.60	\$59.36	X X X X X X X D Y
---	-----------	------------	---------	---------	---------	-------------------

### Apprentice Rates:

0-1,000 work hours	\$33.02	\$41.38	\$49.74
1,001-2,000 work hours	\$33.98	\$42.82	\$51.66
2,001-3,000 work hours	\$34.95	\$44.27	\$53.60
3,001-4,000 work hours	\$36.87	\$47.15	\$57.44

## Underground Laborer Open Cut, Class III

Air, gasoline and electric tool operator, vibrator operator, drillers, pump man, tar kettle operator, bracers, rodder, reinforced steel or mesh man (e.g. wire mesh, steel mats, dowel bars, etc.), cement finisher, welder, pipe jacking and boring man, wagon drill and air track operator and concrete saw operator (under 40 h.p.), windlass and tugger man, and directional boring man.	LAUC-Z1-3	9/5/2013	\$37.88	\$48.67	\$59.46	X X X X X X X D Y
--	-----------	----------	---------	---------	---------	-------------------

### Apprentice Rates:

0-1,000 work hours	\$33.06	\$41.44	\$49.82
1,001-2,000 work hours	\$34.02	\$42.88	\$51.74
2,001-3,000 work hours	\$34.99	\$44.33	\$53.68
3,001-4,000 work hours	\$36.92	\$47.23	\$57.54

Official Request #: 743  
 Requestor: Troy School District  
 Project Description: Boulan Park & Larson Middle School Interior  
 Project Number: 2013 Bond Program, Series 1, BID 9812  
 County: Oakland

**Official Rate Schedule**  
**Every contractor and subcontractor shall keep posted on the construction site, in a conspicuous place, a copy of all prevailing wage and fringe benefit rates prescribed in a contract.**

# Official 2015 Prevailing Wage Rates for State Funded Projects

Issue Date: 6/1/2015

Contract must be awarded by: 8/30/2015

Page 34 of 35

Classification Name	Description	Last Updated	Straight Hourly	Time and Half	a Double Time	Overtime Provision
------------------------	-------------	-----------------	--------------------	------------------	------------------	-----------------------

## Underground Laborer Open Cut, Class IV

Trench or excavating grade man.	LAUC-Z1-4	9/5/2013	\$37.96	\$48.79	\$59.62	X X X X X X X D Y
---------------------------------	-----------	----------	---------	---------	---------	-------------------

### Apprentice Rates:

0-1,000 work hours	\$33.12	\$41.53	\$49.94
1,001-2,000 work hours	\$34.09	\$42.99	\$51.88
2,001-3,000 work hours	\$35.06	\$44.44	\$53.82
3,001-4,000 work hours	\$36.99	\$47.33	\$57.68

## Underground Laborer Open Cut, Class V

Pipe Layer	LAUC-Z1-5	9/5/2013	\$38.02	\$48.88	\$59.74	X X X X X X X D Y
------------	-----------	----------	---------	---------	---------	-------------------

### Apprentice Rates:

0-1,000 work hours	\$33.16	\$41.59	\$50.02
1,001-2,000 work hours	\$34.14	\$43.06	\$51.98
2,001-3,000 work hours	\$35.11	\$44.51	\$53.92
3,001-4,000 work hours	\$37.05	\$47.43	\$57.80

## Underground Laborer Open Cut, Class VI

Grouting man, top man assistant, audio visual television operations and all other operations in connection with closed circuit television inspection, pipe cleaning and pipe relining work and the installation and repair of water service pipe and appurtenances.	LAUC-Z1-6	9/5/2013	\$35.47	\$45.06	\$54.64	X X X X X X X D Y
---	-----------	----------	---------	---------	---------	-------------------

### Apprentice Rates:

0-1,000 work hours	\$31.25	\$38.73	\$46.20
1,001-2,000 work hours	\$32.10	\$40.00	\$47.90
2,001-3,000 work hours	\$32.94	\$41.26	\$49.58
3,001-4,000 work hours	\$34.63	\$43.79	\$52.96

Official Request #: 743  
 Requestor: Troy School District  
 Project Description: Boulan Park & Larson Middle School Interior  
 Project Number: 2013 Bond Program, Series 1, BID 9812  
 County: Oakland

**Official Rate Schedule**  
 Every contractor and subcontractor shall keep posted on the construction site, in a conspicuous place, a copy of all prevailing wage and fringe benefit rates prescribed in a contract.



# Official 2015 Prevailing Wage Rates for State Funded Projects

**Issue Date:** 6/1/2015

**Contract must be awarded by:** 8/30/2015

**Page 35 of 35**

<u>Classification</u>	Last	Straight	Time and	a Double	Overtime
Name	Updated	Hourly	Half	Time	Provision
Description					
<b>Underground Laborer Open Cut, Class VII</b>					
Restoration laborer, seeding, sodding, planting, cutting, mulching and topsoil grading and the restoration of property such as replacing mail boxes, wood chips, planter boxes, flagstones etc.	LAUC-Z1-7 9/5/2013	\$32.09	\$39.99	\$47.88	X X X X X X D Y

**Apprentice Rates:**

0-1,000 work hours	\$28.72	\$34.93	\$41.14
1,001-2,000 work hours	\$29.39	\$35.93	\$42.48
2,001-3,000 work hours	\$30.07	\$36.95	\$43.84
3,001-4,000 work hours	\$31.42	\$38.98	\$46.54

Official Request #: 743

Requestor: Troy School District

Project Description: Boulan Park & Larson Middle School Interior

Project Number: 2013 Bond Program, Series 1, BID 9812

County: Oakland

**Official Rate Schedule**

**Every contractor and subcontractor shall keep posted on the construction site, in a conspicuous place, a copy of all prevailing wage and fringe benefit rates prescribed in a contract.**

CONTRACTOR CODE OF CONDUCT

1. CONTRACTOR CODE OF CONDUCT

- A. The purpose of the Troy School District and its employees is to provide a safe, positive learning environment for the students of the District. In providing that environment it is mandatory that all employees, visitors, and contractors follow certain levels of conduct, dress, and demeanor. This Code of Conduct outlines the expectations of the Troy School District for persons both contemplating performing work and performing work for Troy School District in the capacity of a contractor or subcontractor. These rules will become part of the mandatory working conditions of the contract and failure to comply by the any contractor, subcontractor, management, employee, or contracted consultant may result in the cancellation of the contract.
- B. In general it is expected that everyone entering a Troy School District facility, whether a school, support facility, or the surrounding grounds, must dress, act, and talk in a manner that is conducive to the education process of children while assuring their overall safety and security. The following rules have been established to assure that this is done:
1. Every contractor employee that enters or leaves the building must sign in and out at either the school office or the building engineer's office as designated by the school administrator. This sign-in sheet must record the name, time in and out, the firm, and the signature of the individual.
  2. All contractors shall be furnished by their company a badge or identification that is to be worn while in the building. Such identification shall clearly indicate the individual's name and the name of the firm they are working for.
  3. Prior to the beginning of a job, the contractor shall furnish the building engineer with a list of individuals expected to be on the job, contact persons with phone numbers, and a schedule of the activities to take place.
  4. The contractor shall provide the building engineer with a scope of work and check with him prior to drilling or penetrating any walls, floors, or ceilings.
  5. Each person working in a school building or on school property shall comply with the following:
    - a. No drinking or possession of liquor or alcoholic beverages and or possession of any kind of illicit drugs or narcotics.
    - b. No use of District facilities or equipment including telephone, computers, internet access, fax, kitchen, maintenance or office equipment.
    - c. No smoking or use of any tobacco products anywhere within the building at anytime nor outside the school on District property during normal school hours (This is a law and punishable as a civil infraction by local authorities).

- d. A reasonable standard of dress must be followed. Within the educational facilities where students and parents are or can be present, this is to mean clothing or attire must be suitable for the work and must not bear images or writing depicting anything to be construed as obscene in nature or promoting or portraying alcoholic beverages or use, drugs, narcotics, tobacco or establishments that serve or promote the use of these substances.
  - e. There shall be no use of profanity or obscene language or gestures.
  - f. Language, gestures, or other actions that depict sexual or ethnic harassment or intimidation will not be permitted.
6. The contractor is responsible for a clean and safe workplace. To that end the following will be adhered to:
- a. All work areas, walkways, and stairs must be kept clear of debris and loosely scattered materials.
  - b. Material storage is to be in an area designated by the Building Engineer
  - c. All work areas are to be cleaned by the contractor prior to leaving. Building staff will not be responsible for cleaning work areas.
  - d. All trash, debris, and material must be removed from the worksite each day and disposed of off site. District dumpsters and trash containers are not to be used by contractors for disposal.
  - e. All contractor tools and equipment must be kept in good working order, with guards and safety devices in place and working. Defective tools must be taken out of service. District tools and equipment will not be loaned to contractors.
  - f. Contractors are to provide and use required protective safety equipment and comply with all local, state, and federal safety laws and regulations.
  - g. Contractors are responsible for the reporting of accidents both to the District and their management and to obtain any emergency treatment that may be required.
  - h. Upon leaving a jobsite all doors and windows must be locked, secured, or left as they were found prior to beginning the work.
  - i. Contractors are to provide their own site safety plan for areas that they are working in.
  - j. Contractors are reminded that there may be asbestos insulation in our buildings. They are not to disturb any insulation or enter any areas that contain asbestos containing building materials. If they have any questions, contact the building engineer for direction.
  - k. Contractor is not to disable or interfere with any fire or burglary system equipment or telephone lines servicing such equipment. If equipment needs to be removed, relocated, or temporarily disabled, the contractor needs to coordinate this with the building engineer.

7. The District will not tolerate acts of theft, vandalism, fighting, or abuse of the facilities or activities that threaten the security and safety of the school environment and its students, staff, and employees.
- C. In summary, good judgment must be used to protect the learning environment. **Failure to comply with the above or to exhibit conduct which is deemed not in the best interest of the Troy School District will be grounds for immediate removal from the building and the project.**

**\*\*END OF SECTION\*\***

SUBMITTAL PROCEDURES

PART 1 - GENERAL

1.1 SUBMITTAL PROCEDURES

- A. Use the transmittal form, located at the back of this section, with each shop drawing submittal.
- B. Coordination: Coordinate preparation and processing of submittals with performance of construction activities.
  - 1. Coordinate each submittal with fabrication, purchasing, testing, delivery, other submittals, and related activities that require sequential activity.
  - 2. Coordinate transmittal of different types of submittals for related parts of the Work so processing will not be delayed because of need to review submittals concurrently for coordination.
    - a. Architect reserves the right to withhold action on a submittal requiring coordination with other submittals until related submittals are received.
- C. Processing Time: Allow enough time for submittal review, including time for resubmittals. Time for review shall commence on Architect's receipt of submittal. No extension of the Contract Time will be authorized because of failure to transmit submittals enough in advance of the Work to permit processing, including resubmittals.
  - 1. Allow 15 working days for initial review of each submittal. Allow additional time if coordination with subsequent submittals is required.
  - 2. Resubmittal Review: Allow 15 working days for review of each resubmittal.
- D. Identification: Place a permanent label or title block on each submittal for identification.
  - 1. Clearly state which bid category and Item No. the submittal references.
- E. Samples:
  - 1. Where a custom or special finish is specified, the Contractor shall submit a minimum of two (2) samples, (6" x 6" or larger) to match Architect's control sample, for Architect's approval. This may include but is not limited to wood, fabric, metal, plastic laminate, etc.
- F. WARRANTIES
  - 1. The Contractor shall provide written documentation from the Manufacturer, which guarantees items against defects in materials, manufacture and workmanship, for a period of one (1) year from the day of final settlement with Owner for the item. Final settlement shall not relieve the Manufacturer from liability for such defects, and upon notification from Owner, the Contractor or Manufacturer shall, by repair, replacement, or otherwise, place the item in a condition satisfactory to the Owner in every respect. Usual wear and tear and results of Owner's accidents are exempted from the requirements of this guarantee. Everything required to fulfill this guarantee shall be

done without additional cost to the Owner. The products or workmanship of any Subcontractor are to be covered in the primary Manufacturer's guarantee.

2. The following shall be considered defects, without being limited thereto:
  - a. Permanent etching, staining, discoloration, fading, and other deterioration of finishes.
  - b. Operational failures, binding, and the like, in finish cabinet hardware.
  - c. Deformation, warpage, opening up of joints, telegraphing of cores, delamination of veneers, or other finishing materials, failures in fastening and anchorage, sagging of panels.

G. Maintenance Instructions

1. The Contractor shall provide Maintenance and Cleaning Instructions as written by the Manufacturer for each item of furniture.

# TMP SHOP DRAWING AND SAMPLE TRANSMITTAL FORM

CONTRACTOR/CONST. MANAGER:  _____ _____ _____	PROJECT TITLE AND LOCATION:  _____ _____ _____	DATE SUBMITTED: _____ NEW _____ SUB. NO. _____  CHECKER: _____ RESUB. _____ RESUB. NO. _____  TMP PROJECT NO. _____
---	--	---

SPEC SECTION NO.	NO. PRINT	NO. SEPI	NO. CAT.	NO. SAMPLES	SUBCONTRACTOR/MFR.	ITEM DESCRIPTION	*ACTION CODE	DATE CHECKED	DATE RETURNED	NO. COPIES

The undersigned certifies that the above submitted items have been reviewed in detail and are correct and in strict conformance with the contract documents except as otherwise noted. NOTE: Approval of items submitted does not relieve contractor from complying with all requirements of the contract documents.		<b>* ACTION DEFINITION</b>  R = REVIEWED – NO EXCEPTIONS NOTED RN = REVIEWED WITH CORRECTIONS NOTED RR = REVISE AND SEND RECORD COPY X = NOT APPROVED – RESUBMIT NA = NO ACTION REQ'D
CONTRACTOR'S COMMENTS:   ARCHITECT'S COMMENTS:	_____ CONTRACTOR'S NAME  _____ SIGNATURE  cc:   Owner Consultant	

AVAILABILITY OF ELECTRONIC FILES (FURNISHINGS)

PART 1 – GENERAL

1.1 POLICY

- A. As a service to bidders, contractors, subcontractor, vendors, material suppliers and others needing electronic copies of drawing files, the Architect will provide CAD files in the form of a CD-ROM in accordance with the following policy:
1. By acceptance it is understood and agreed that the data and medium being supplied is to be used only for the project referenced.
  2. It is further understood and agreed that the undersigned will hold TMP Architecture harmless and indemnify TMP Architecture from all claims, liabilities, losses, etc., including attorney's fees arising out of the use or misuse of the transferred items.
  3. It is understood and agreed that the items transmitted are prepared from CAD files current at the time of preparation. All files are AutoCAD 2004.
  4. This information does not waive the need to verify and review current field conditions and the status of Addenda and/or Bulletin documentation.
  5. As a record of information to be transmitted, TMP Architecture will prepare a duplicate back-up for its files, which may be electronic or hard-copy.
  6. Compensation for providing this material will be as follows:
    - a. Base Fee of \$250 for 1 to 3 drawings.
    - b. Base Fee of \$500 for 4 to 10 drawings.
    - c. For each additional drawing after 10 the fee is \$40.00 per drawing (i.e., 11 drawings = \$540).
  7. Payment must be provided along with a signed copy of the Release Letter before files will be released.

1.2 REQUEST PROCEDURE

- A. To receive files the attached Release Letter must be completed in full and submitted to the Construction Manager (or General Contractor) to be forwarded to the Project Manager at TMP Architecture.
1. An original signed copy of the Release Letter must be submitted; faxed or emailed copies will not be accepted.
  2. Upon remittance of the signed Release Letter and Fee, allow five working days for processing.
  3. No email transmissions of documents will be provided.



AVAILABILITY OF  
ELECTRONIC  
FILES  
(FURNISHINGS)

Date: \_\_\_\_\_

Firm Requesting Files:

Name: \_\_\_\_\_

Company: \_\_\_\_\_

Address: \_\_\_\_\_

City, State, Zip: \_\_\_\_\_

Re: Letter of Authorization for CAD File Transfers

Furnishings Project Name: \_\_\_\_\_

TMP Project No. : \_\_\_\_\_ Bid Pack No. : \_\_\_\_\_

Dear Sir:

Per your request, TMP Architecture will transmit the requested CAD files in the form of CD-ROM upon receipt of an original signed copy of this letter with conditions of agreement as stated.

1. By acceptance it is understood and agreed that the data and medium being supplied is to be used only for the project referenced.
2. It is further understood and agreed that the undersigned will hold TMP Architecture harmless and indemnify TMP Architecture from all claims, liabilities, losses, etc., including attorney's fees arising out of the use or misuse of the transferred items.
3. It is understood and agreed that the items transmitted are prepared from CAD files current at the time of preparation. All files are AutoCAD 2004.
4. This information does not waive the need to verify and review current field conditions and the status of Addenda and/or Bulletin documentation.
5. As a record of information to be transmitted, we will prepare a duplicate back-up for our files, which may be electronic or hard-copy.
6. Compensation for providing this material will be as follows: Base Fee of \$250 for 1 to 3 drawings and a Base Fee of \$500 for 4 to 10 drawings; for each additional drawing after 10 the fee is \$40.00 per drawing (i.e., 11 drawings = \$540). Payment must be provided along with a signed copy of this form before files will be released. Please remit to TMP Architecture and allow five working days for processing.

Fee: \$ \_\_\_\_\_ Drawings: \_\_\_\_\_

Signed: \_\_\_\_\_ Printed Name/Title: \_\_\_\_\_

Firm Requesting: \_\_\_\_\_

Phone: \_\_\_\_\_ Fax: \_\_\_\_\_

*To Be Completed By TMP Architecture, Inc.*

Released (signed by): \_\_\_\_\_ TMP Architecture, Inc.

Printed Name/Title: \_\_\_\_\_ Date: \_\_\_\_\_

**\*\*END OF SECTION\*\***

**BID CATEGORY A:**

**HON**

BP #6 Furnishings  
Troy School District  
TMP Project Nos: 13170/13171  
June 9, 2015 BIDS

BID CATEGORY A: HON

Page No. 1 of 20

Item	Total		Manufacturer	Model No.	Location		Unit Cost *	Extended Cost
	Qty				Qty	Description		

*\*(to include freight, delivery and installation)*

**Workstation General Notes:**

1. Dealer is responsible for providing all misc. connectors and support pieces required to erect workstations as shown on drawings.
2. Dealer is responsible for providing all necessary hardware for unit to stand alone or attach counter tops and panels as required for stability.
3. Dealer is responsible for field verification measurements.
4. Dealer is responsible for providing right-hand and left-hand workstations as required by drawings.
5. Dealer is required to submit isometric drawings from at least two viewing angles of each workstation type with bid proposal forms.

**Workstation Keying:**

1. All "individual" workstations shall be keyed alike, but different from the next.
2. Dealer is responsible for creating and providing a keying schedule.
3. Dealer to provide two (2) master keys per building to the owner.

**Workstation Finishes:**

All Worksurfaces and Lateral File Tops: Harbor Teak  
 All Worksurfaces and Lateral File Top edges: Harbor Teak  
 Modesty Panel: Silver Mesh  
 All Door and Drawer Fronts: Harbor Teak  
 All Storage Chassis Components: Silver Mesh  
 All Support and End Panels: Silver Mesh  
 Metal Pulls: Platinum Metallic (refer to drawings for mounting locations at workstations)  
 Metal Supports: Platinum Metallic  
 Grommets: Platinum Metallic  
 Metal at Storage Cube and Drawer Organizer: Citron  
 Tackboard Fabric: Hon, Lucy Snowdrop LC28  
 Electrical Power Hub: Standard Black

BP #6 Furnishings  
Troy School District  
TMP Project Nos: 13170/13171  
June 9, 2015 BIDS

BID CATEGORY A: HON

<b>Item</b>	<b>Total Qty</b>	<b>Manufacturer</b>	<b>Model No.</b>	<b>Location Qty</b>	<b>Description</b>	<b>Unit Cost *</b>	<b>Extended Cost</b>
<i>*(to include freight, delivery and installation)</i>							
A1	18	Hon	HISB6.F.M		<b>Ignition Multi-Purpose Sled Base Guest Chair</b> with fixed arms and mesh back.		
					<b><i>Finishes:</i></b> <u>Boulan Park &amp; Larson Middle Schools</u> Frame: Black Mesh Back: Black Upholstered Seat: Hon,Quadrille, Mystic QD90		
					<b><i>Location:</i></b> <u>Boulan Park Middle School (13170)</u>		
				9	Welcome Center 102		
					<u>Larson Middle School (13171)</u>		
				9	Welcome Center 102		

BP #6 Furnishings  
Troy School District  
TMP Project Nos: 13170/13171  
June 9, 2015 BIDS

BID CATEGORY A: HON

Item	Total		Model No.	Location		Description	Unit Cost *	Extended Cost
	Qty	Manufacturer		Qty				
<i>*(to include freight, delivery and installation)</i>								
A2	92	Hon	HIGS6.F.E.M			<b>Ignition Four-Leg Guest Chair</b> with fixed arms, mesh back and all surface casters.		
<b><i>Finishes:</i></b>								
<u>Boulan Park &amp; Larson Middle Schools</u>								
Frame: Black								
Mesh Back: Black								
Upholstered Seat: Hon, Appoint, Espresso PNS003								
<b><i>Location:</i></b>								
<u>Boulan Park Middle School (13170)</u>								
				14		Conference 103		
				4		Asst. Principal 106		
				4		Principal 107		
				10		Conference 108		
				2		Cousenlor 109		
				2		Counselor 110		
				4		Itinerant 111		
				3		Itinerant 113		
				3		Itinerant 114		

BP #6 Furnishings  
Troy School District  
TMP Project Nos: 13170/13171  
June 9, 2015 BIDS

BID CATEGORY A: HON

Item	Total		Model No.	Location		Description	Unit Cost *	Extended Cost
	Qty	Manufacturer		Qty				

\*(to include freight, delivery and installation)

Larson Middle School (13171)

14	Conference 103
4	Asst. Principal 106
4	Principal 107
10	Conference 108
2	Cousenlor 109
2	Counselor 110
4	Itinerant 111
3	Itinerant 113
3	Itinerant 114

A3a      16      Hon      HIWM2.A.H.M

**Ignition Work Mid-Back Task Chair** with height and width adjustable arms, height adjustable mesh back, and hard casters for carpet.

***Finishes:***

Boulan Park & Larson Middle Schools

Frame: Black

Base: Black

Mesh Back: Black

Upholstered Seat: Momentum, Knack, Reed

BP #6 Furnishings  
Troy School District  
TMP Project Nos: 13170/13171  
June 9, 2015 BIDS

BID CATEGORY A: HON

Item	Total Qty	Manufacturer	Model No.	Location Qty	Description	Unit Cost *	Extended Cost
<i>*(to include freight, delivery and installation)</i>							
<b>Location:</b>							
<u>Boulan Park Middle School (13170)</u>							
	1			1	Clinic 104		
	1			1	Asst. Principal 106		
	1			1	Principal 107		
	1			1	Cousenlor 109		
	1			1	Counselor 110		
	1			1	Itinerant 111		
	1			1	Itinerant 113		
	1			1	Itinerant 114		
<u>Larson Middle School (13171)</u>							
	1			1	Clinic 104		
	1			1	Asst. Principal 106		
	1			1	Principal 107		
	1			1	Cousenlor 109		
	1			1	Counselor 110		
	1			1	Itinerant 111		
	1			1	Itinerant 113		
	1			1	Itinerant 114		

BP #6 Furnishings  
Troy School District  
TMP Project Nos: 13170/13171  
June 9, 2015 BIDS

BID CATEGORY A: HON

Item	Total Qty	Manufacturer	Model No.	Location Qty	Description	Unit Cost *	Extended Cost
<i>*(to include freight, delivery and installation)</i>							
A3b	6	Hon	HIWM2.A.H.M		<p><b>Ignition Work Mid-Back Task Chair</b> with height and width adjustable arms, height adjustable mesh back, and hard casters for carpet.</p> <p><b><i>Finishes:</i></b>  <u>Boulan Park &amp; Larson Middle Schools</u>            Frame: Black            Base: Black            Mesh Back: Black            Upholstered Seat: Momentum, Knack, Brisk</p> <p><b><i>Location:</i></b>  <u>Boulan Park Middle School (13170)</u>            3 Welcome Center 102</p> <p><u>Larson Middle School (13171)</u>            3 Welcome Center 102</p>		



BP #6 Furnishings  
Troy School District  
TMP Project Nos: 13170/13171  
June 9, 2015 BIDS

BID CATEGORY A: HON

Item	Total		Model No.	Location		Description	Unit Cost *	Extended Cost
	Qty	Manufacturer		Qty				
<i>*(to include freight, delivery and installation)</i>								
A4	2	Hon	Voi Desking			<b>Workstation No. 1 - Assistant Principal</b> (1) Rudder Worksurface 30"/38"Dx72"W w/ Grommets (1) 20"Dx72"W Rectangular Worksurface w/ Grommets (1) 24"Dx72"W Rectangular Worksurface w/ Grommets (1) 60"Wx14"H Laminate Floating Modesty Panel (1) 28"H Post Leg (1) 14.25"Dx72"Wx35"H Stack-on Storage with Sliding Door (1) 24"Dx28" Box/Box/File Pedestal Support (1) 24"Dx36"Wx29.5"H Freestanding 2-Drawer Lateral File (1) Tackboard for 72"W Stack-on Storage (1) 31" LED Fixture with 2.5 amp Power Supply (1) Softwire Power Hub 3" Grommet Mount (1) 12"x12" Storage Cube (1) Drawer Organizer for Box Drawer		
						<b>Location:</b> <u>Boulan Park Middle School (13170)</u> 1 Asst. Principal 106		
						<u>Larson Middle School (13171)</u> 1 Asst. Principal 106		

BP #6 Furnishings  
Troy School District  
TMP Project Nos: 13170/13171  
June 9, 2015 BIDS

BID CATEGORY A: HON

Item	Total		Model No.	Location		Description	Unit Cost *	Extended Cost
	Qty	Manufacturer		Qty				
<i>*(to include freight, delivery and installation)</i>								
A5	2	Hon	Voi Desking			<b>Work Station No. 2 - Principal</b> (1) Rudder Worksurface 30"/38"Dx72"W w/ Grommets (1) 20"Dx72"W Rectangular Worksurface w/ Grommets (1) 24"Dx72"W Rectangular Worksurface w/ Grommets (1) 60"Wx14"H Laminate Floating Modesty Panel (1) 28"H Post Leg (1) 14.25"Dx72"Wx35"H Stack-on Storage with Sliding Door (1) 24"Dx28" Box/Box/File Pedestal Support (4) 24"Dx36"Wx29.5"H Freestanding 2-Drawer Lateral File (2) 14"Dx36"Wx35"H Bookcase Hutch (no doors) (1) Tackboard for 72"W Stack-on Storage (1) 31" LED Fixture with 2.5 amp Power Supply (1) Softwire Power Hub 3" Grommet Mount (1) 12"x12" Storage Cube (1) Drawer Organizer for Box Drawer		
						<b>Location:</b> <u>Boulan Park Middle School (13170)</u> 1 Principal 107		
						<u>Larson Middle School (13171)</u> 1 Principal 107		

BP #6 Furnishings  
Troy School District  
TMP Project Nos: 13170/13171  
June 9, 2015 BIDS

BID CATEGORY A: HON

Item	Total		Model No.	Location		Description	Unit Cost *	Extended Cost
	Qty	Manufacturer		Qty				
<i>*(to include freight, delivery and installation)</i>								
A6	4	Hon	Voi Desking			<b>Work Station No. 3 - Counselor</b>		
						(1) 30"Dx60"W Rectangular Worksurface w/ Grommets		
						(1) O-Leg Support for Worksurface		
						(1) 24"Dx72"W Rectangular Worksurface w/ Grommets		
						(1) 14.25"Dx72"Wx35"H Stack-on Storage with Doors		
						(1) 24"Dx28" Box/Box/File Pedestal Support		
						(1) 14"Dx36"Wx35"H Bookcase Hutch (no doors)		
						(1) 24"Dx36"Wx29.5"H Freestanding 2-Drawer Lateral File		
						(1) 24"Dx24"Wx65"H Personal Storage Tower		
						(1) Tackboard for 72"W Stack-on Storage		
						(1) 36" LED Fixture with 2.5 amp Power Supply		
						(1) Softwire Power Hub 3" Grommet Mount		
						(1) 12"x12" Storage Cube		
						(1) Drawer Organizer for Box Drawer		
						<b>Location:</b>		
						<u>Boulan Park Middle School (13170)</u>		
				1		Counselor 109		
				1		Counselor 110		
						<u>Larson Middle School (13171)</u>		
				1		Counselor 109		
				1		Counselor 110		

BP #6 Furnishings  
Troy School District  
TMP Project Nos: 13170/13171  
June 9, 2015 BIDS

BID CATEGORY A: HON

Item	Total		Model No.	Location		Description	Unit Cost *	Extended Cost
	Qty	Manufacturer		Qty				
<i>*(to include freight, delivery and installation)</i>								
A7	2	Hon	Voi Desking			<p><b>Work Station No. 5 - Itinerant 1</b></p> <p>(1) 36"Dx72"W Rectangular Worksurface w/ Grommets w/ full end panel support</p> <p>(1) 24"Dx48"W Rectangular Worksurface w/ Grommets</p> <p>(1) 24"Dx72"W Rectangular Worksurface w/ Grommets</p> <p>(1) Half Height Modesty at Desk Front</p> <p>(1) 14.25"Dx72"Wx35"H Stack-on Storage with Doors</p> <p>(1) 24"Dx28" Box/Box/File Pedestal Support</p> <p>(1) 24"Dx28" File/File Pedestal Support</p> <p>(1) 24"Dx30"Wx29.5"H Freestanding 2-Drawer Lateral File</p> <p>(1) Tackboard for 72"W Stack-on Storage</p> <p>(1) 31" LED Fixture with 2.5 amp Power Supply</p> <p>(1) Softwire Power Hub 3" Grommet Mount</p> <p>(1) 12"x12" Storage Cube</p> <p>(1) Drawer Organizer for Box Drawer</p> <p>Note: an approximate 6" overhang shall be provided at Desk Front.</p>		
						<p><b>Location:</b></p> <p><u>Boulan Park Middle School (13170)</u></p> <p>1 Itinerant 111</p> <p><u>Larson Middle School (13171)</u></p> <p>1 Itinerant 111</p>		

BP #6 Furnishings  
Troy School District  
TMP Project Nos: 13170/13171  
June 9, 2015 BIDS

BID CATEGORY A: HON

Item	Total		Model No.	Location		Unit Cost *	Extended Cost
	Qty	Manufacturer		Qty	Description		
<i>*(to include freight, delivery and installation)</i>							
A8	4	Hon	Voi Desking	<b>Work Station No. 6 - Itinerant 2</b>			
					(1) 30"Dx60"W Rectangular Worksurface w/ Grommets		
					(1) O-Leg Support for Worksurface		
					(1) 30"Dx28" Box/Box/File Pedestal Support		
					(1) Softwire Power Hub 3" Grommet Mount		
					(1) Drawer Organizer for Box Drawer		
				<b><i>Location:</i></b>			
				<u>Boulan Park Middle School (13170)</u>			
				1	Itinerant 113		
				1	Itinerant 114		
				<u>Larson Middle School (13171)</u>			
				1	Itinerant 113		
				1	Itinerant 114		

BP #6 Furnishings  
Troy School District  
TMP Project Nos: 13170/13171  
June 9, 2015 BIDS

BID CATEGORY A: HON

Item	Total		Model No.	Location		Description	Unit Cost *	Extended Cost
	Qty	Manufacturer		Qty				
<i>*(to include freight, delivery and installation)</i>								
A9	10	Hon	HTLD42 with (1) HTXLEG			<b>Preside Round Guest Table</b> with painted aluminum x-leg, 42" overall diameter and flat edge.		
<b><i>Finishes:</i></b>								
<u>Boulan Park &amp; Larson Middle Schools</u>								
Table Top: Harbor Teak								
Table Edge: Match Harbor Teak								
Table Base: Black								
<b><i>Location:</i></b>								
<u>Boulan Park Middle School (13170)</u>								
				1		Asst. Principal 106		
				1		Principal 107		
				1		Itinerant 111		
				1		Itinerant 113		
				1		Itinerant 114		
<u>Larson Middle School (13171)</u>								
				1		Asst. Principal 106		
				1		Principal 107		
				1		Itinerant 111		
				1		Itinerant 113		
				1		Itinerant 114		

BP #6 Furnishings  
Troy School District  
TMP Project Nos: 13170/13171  
June 9, 2015 BIDS

BID CATEGORY A: HON

<b>Item</b>	<b>Total Qty</b>	<b>Manufacturer</b>	<b>Model No.</b>	<b>Location Qty</b>	<b>Description</b>	<b>Unit Cost *</b>	<b>Extended Cost</b>
<i>*(to include freight, delivery and installation)</i>							
A10	6	Hon	HFTLD26		<b>Flock Cylinder Table</b> with 26" overall diameter.		
					<b><i>Finishes:</i></b>		
					<u>Boulan Park &amp; Larson Middle Schools</u>		
					Table Top Laminate: Harbor Teak		
					Metal Feet: P6N Textured Statin Chrome		
					<b><i>Location:</i></b>		
					<u>Boulan Park Middle School (13170)</u>		
				3	Welcome Center 102		
					<u>Larson Middle School (13171)</u>		
				3	Welcome Center 102		

BP #6 Furnishings  
 Troy School District  
 TMP Project Nos: 13170/13171  
 June 9, 2015 BIDS

BID CATEGORY A: HON

<b>Total</b>				<b>Location</b>			
<b>Item</b>	<b>Qty</b>	<b>Manufacturer</b>	<b>Model No.</b>	<b>Qty</b>	<b>Description</b>	<b>Unit Cost *</b>	<b>Extended Cost</b>
<i>*(to include freight, delivery and installation)</i>							
A11					NOT USED		



BP #6 Furnishings  
Troy School District  
TMP Project Nos: 13170/13171  
June 9, 2015 BIDS

BID CATEGORY A: HON

Item	Total Qty	Manufacturer	Model No.	Location Qty	Description	Unit Cost *	Extended Cost
<i>*(to include freight, delivery and installation)</i>							
A12	12	Hon	HMT3060G with (1) HMBPOST		<b>Huddle Multi-Purpose Table</b> with 30"Dx60"W rectangular fixed top and post legs with locking casters.		
					<b><i>Finishes:</i></b> <u>Boulan Park &amp; Larson Middle Schools</u> Table Top Laminate: Harbor Teak 2mm Edge: to match Harbor Teak Base Color: Black		
					<b><i>Location:</i></b> <u>Boulan Park Middle School (13170)</u> 6 Conference 103		
					<u>Larson Middle School (13171)</u> 6 Conference 103		

BP #6 Furnishings  
Troy School District  
TMP Project Nos: 13170/13171  
June 9, 2015 BIDS

BID CATEGORY A: HON

Page No. 16 of 20

<b>Item</b>	<b>Total Qty</b>	<b>Manufacturer</b>	<b>Model No.</b>	<b>Location Qty</b>	<b>Description</b>	<b>Unit Cost *</b>	<b>Extended Cost</b>
<i>*(to include freight, delivery and installation)</i>							
A13	2	Hon	HTLA54120 with (2) HTTLEG120		<b>Preside Laminate Conference Table</b> with 120"Wx54"D Racetrack shaped top, knife edge, and aluminum T-leg bases. No cutouts.		
<b><i>Finishes:</i></b>							
<u>Boulan Park &amp; Larson Middle Schools</u>							
Table Top Laminate: Harbor Teak HART							
Base Color: Black (P)							
<b><i>Location:</i></b>							
<u>Boulan Park Middle School (13170)</u>							
				1	Conference 108		
<u>Larson Middle School (13171)</u>							
				1	Conference 108		

BP #6 Furnishings  
Troy School District  
TMP Project Nos: 13170/13171  
June 9, 2015 BIDS

BID CATEGORY A: HON

Item	Total		Model No.	Location		Description	Unit Cost *	Extended Cost
	Qty	Manufacturer		Qty				
<i>*(to include freight, delivery and installation)</i>								
A14	6	Hon	H19720N			<p><b>Flagship Standard Height Freestanding Support Pedestal - Box/Box/File</b> with (1) pencil tray insert each. Key alike and same as Items A15 and A16 at Welcome Center 102.</p> <p><b>Finishes:</b> <u>Boulan Park &amp; Larson Middle Schools</u> Pull: Integral Metal Color: Lt. Gray</p> <p><b>Location:</b> <u>Boulan Park Middle School (13170)</u></p>		
				3		Welcome Center 102		
				3		<p><u>Larson Middle School (13171)</u> Welcome Center 102</p>		

BP #6 Furnishings  
Troy School District  
TMP Project Nos: 13170/13171  
June 9, 2015 BIDS

BID CATEGORY A: HON

Item	Total		Model No.	Location		Description	Unit Cost *	Extended Cost
	Qty	Manufacturer		Qty				
<i>*(to include freight, delivery and installation)</i>								
A15	2	Hon	H9170N			<p><b>Flagship 18" Deep Standard Height Lateral File - 2 Drawer</b> with 18"Dx30"W overall size. Key alike and same as Items A14 and A16 at Welcome Center 102.</p> <p><b>Finishes:</b> <u>Boulan Park &amp; Larson Middle Schools</u> Pull: Integral Metal Color: Lt. Gray</p> <p><b>Location:</b> <u>Boulan Park Middle School (13170)</u> 1 Welcome Center 102</p> <p><u>Larson Middle School (13171)</u> 1 Welcome Center 102</p>		

BP #6 Furnishings  
Troy School District  
TMP Project Nos: 13170/13171  
June 9, 2015 BIDS

BID CATEGORY A: HON

<b>Item</b>	<b>Total Qty</b>	<b>Manufacturer</b>	<b>Model No.</b>	<b>Location Qty</b>	<b>Description</b>	<b>Unit Cost *</b>	<b>Extended Cost</b>
<i>*(to include freight, delivery and installation)</i>							
A16	2	Hon	Flagship Series H9170N HFC18730N		<b>Reception Storage Island</b> (2) Standard Height Lateral File - 2 Drawer (2) Standard Height Personal File Center with File/Box/Box/Lateral (2) Pencil Tray inserts for Box Drawer (1) Common laminate top to fit assembled file units Key alike and same as Items A14 and A15 at Welcome Center 102.		
<b><i>Finishes:</i></b>							
<u>Boulan Park &amp; Larson Middle Schools</u>							
Pull: Integral							
Metal Color: Lt. Gray							
Plastic Laminate: Nevamar, Aged Elements, EM6001T							
PVC Edgeband: to match Doellken-Woodtape, Slate Grey 2431							
<b><i>Location:</i></b>							
<u>Boulan Park Middle School (13170)</u>							
				1	Welcome Center 102		
<u>Larson Middle School (13171)</u>							
				1	Welcome Center 102		

BP #6 Furnishings  
Troy School District  
TMP Project Nos: 13170/13171  
June 9, 2015 BIDS

BID CATEGORY A: HON

Item	Total		Model No.	Location		Unit Cost *	Extended Cost
	Qty	Manufacturer		Qty	Description		
<i>*(to include freight, delivery and installation)</i>							
A17	16	Hon	H9183N		<b>Flagship 18" Deep Lateral File - 3 Drawer</b> with 18"Dx36"Wx39 1/8"H overall size. Key alike, but different from all other items.		
					<b><i>Finishes:</i></b> <u>Boulan Park &amp; Larson Middle Schools</u> Pull: Integral Metal Color: Lt. Gray		
					<b><i>Location:</i></b> <u>Boulan Park Middle School (13170)</u>		
				8	Records 119		
					<u>Larson Middle School (13171)</u>		
				8	Records 119		

BP #6 Furnishings  
Troy School District  
TMP Project Nos: 13170/13171  
June 9, 2015 BIDS

BID CATEGORY A: HON

<b>Item</b>	<b>Total Qty</b>	<b>Manufacturer</b>	<b>Model No.</b>	<b>Location Qty</b>	<b>Description</b>	<b>Unit Cost *</b>	<b>Extended Cost</b>
<i>*(to include freight, delivery and installation)</i>							
A18	8	Hon	H515704		<b>Lateral File Accessories - Dividers (10/pack)</b> To be installed two (2) dividers per drawer at Item A17. Evenly space dividers within each drawer.		
					<b><i>Finishes:</i></b> <u>Boulan Park &amp; Larson Middle Schools</u> Metal Color: Gray		
					<b><i>Location:</i></b> <u>Boulan Park Middle School (13170)</u>		
				4	Records 119		
					<u>Larson Middle School (13171)</u>		
				4	Records 119		

**BID CATEGORY B:**

**BAILEY MANUFACTURING CO.**



BP #6 Furnishings  
Troy School District  
TMP Project Nos: 13170/13171  
June 9, 2015 BIDS

BID CATEGORY B: BAILEY MANUFACTURING CO.

Item	Total		Location		Description	Unit Cost *	Extended Cost
	Qty	Manufacturer	Model No.	Qty			

\*(to include freight, delivery and installation)

B1	2	Bailey	496		Lounge with 22" adjustable headrest.		
----	---	--------	-----	--	--------------------------------------	--	--

***Finishes:***

Boulan Park & Larson Middle Schools

Upholstery: Black

Wood Legs: Natural Finish

***Location:***

Boulan Park Middle School (13170)

1 Clinic 104

Larson Middle School (13171)

1 Clinic 104

**BID CATEGORY C:**

**PETER PEPPER**

BP #6 Furnishings  
Troy School District  
TMP Project Nos: 13170/13171  
June 9, 2015 BIDS

BID CATEGORY C: PETER PEPPER

Item	Total		Model No.	Location		Unit Cost *	Extended Cost
	Qty	Manufacturer		Qty	Description		
<i>*(to include freight, delivery and installation)</i>							
C1	2	Peter Pepper	One (1) 605 with three (3) 612 and six (6) 610		<b>Literature Rack</b> with wood frame and nine (9) pockets. Provide three pocket dividers and six paper stops.		
<b><i>Finishes:</i></b>							
<u>Boulan Park &amp; Larson Middle Schools</u>							
Frame: Medium Oak							
Back Panel: Black							
Front Pocket Panels: Clear Acrylic							
<b><i>Location:</i></b>							
<u>Boulan Park Middle School (13170)</u>							
				1	Welcome Center 102		
<u>Larson Middle School (13171)</u>							
				1	Welcome Center 102		

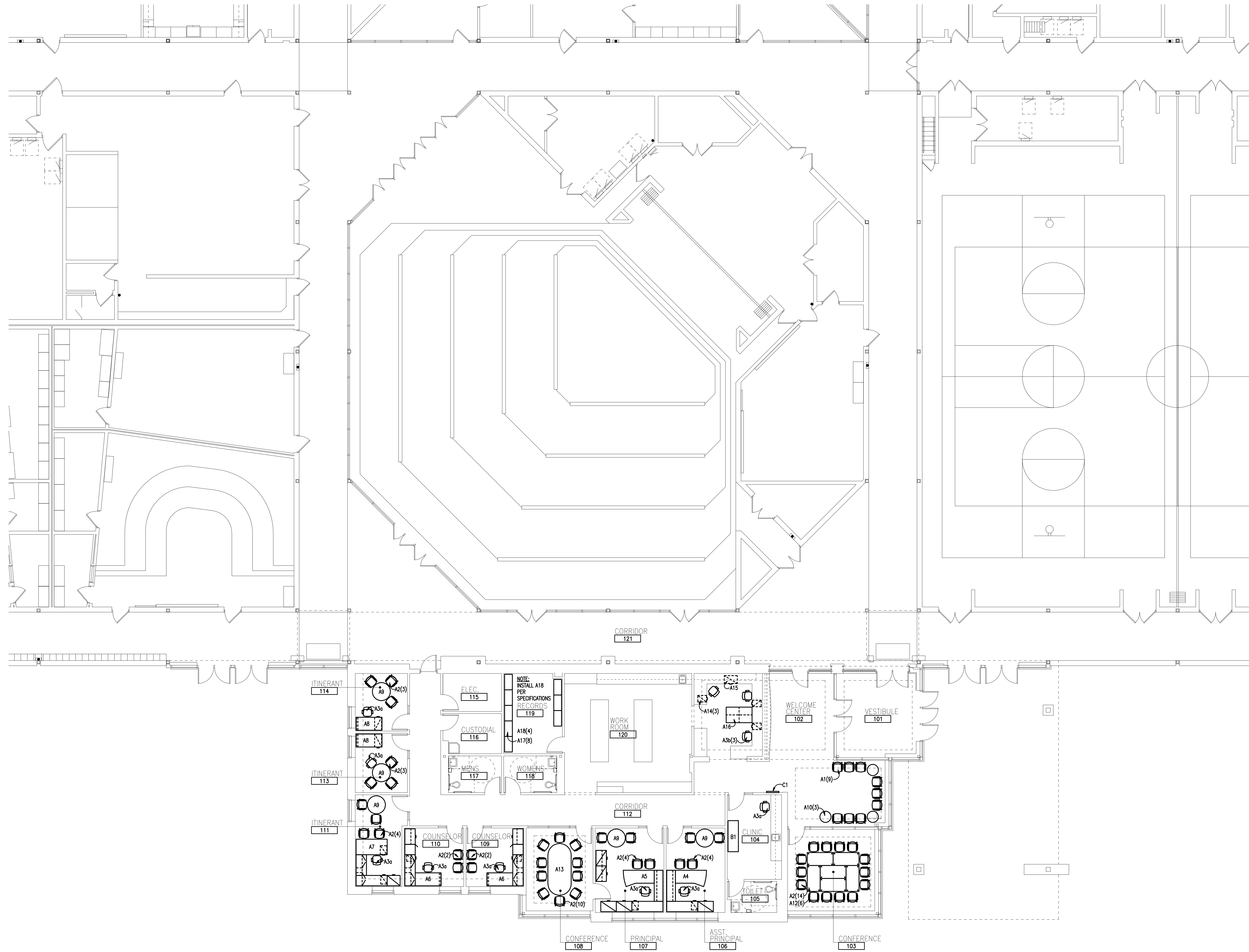

TMP ARCHITECTURE INC  
 191 WEST SQUARE LAKE ROAD  
 BLOOMFIELD HILLS - MICHIGAN - 48302  
 PH - 248.338.4561 FX - 248.338.0023  
 EM - INFO@TMP-ARCHITECTURE.COM

REGISTRATION SEAL

CONSULTANT

PROJECT TITLE  
**Boulan Park  
 Middle School  
 Addition  
 Bid Package #6**

Troy School District  
 Troy, Michigan

DRAWING TITLE  
**Furniture Floor Plan**

ISSUE DATES

DATE	ISSUED FOR:
06-09-15	FURNITURE BIDS
06-04-15	OWNER REVIEW - FURNITURE BIDS
06-06-14	BIDS
05-28-14	CD OWNER REVIEW

DATE	ISSUED FOR:
DRAWN	DBO
CHECKED	JMM
APPROVED	JJC

PROJECT NO.

**13170**

DRAWING NO.

**A12.1**

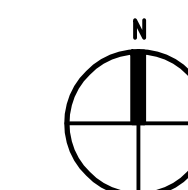

**FURNITURE FLOOR PLAN**  
 SCALE: 1/8" = 1'-0"



