



The School District of Haverford Township

Haverford High School Schematic Design & Lynnewood Act 34 Advertisement

December 6th 2018

The background image shows a high school campus. On the left, a brick building has "STANFORD HIGH SCHOOL" written on its side. A large tree stands in front of it. To the right, another building is visible, and an American flag flies on a pole. In the foreground, there is a paved parking lot with white lines and a concrete sidewalk. The text "HIGH SCHOOL SCHEMATIC DESIGN" is overlaid in the center in a bold, dark gray font.

HIGH SCHOOL SCHEMATIC DESIGN

HAVERFORD HIGH SCHOOL

STEPS TAKEN – SCHEMATIC DESIGN

- Utility Location
- Geotechnical Testing
- Met with District Facilities & High School Principal
- Initial meeting with Haverford Township
- 3rd Party/Independent Cost Estimate

BUILDING ADDITIONS





Expanded
Parking

3-Floor
Classroom
Addition

1-Floor Addition



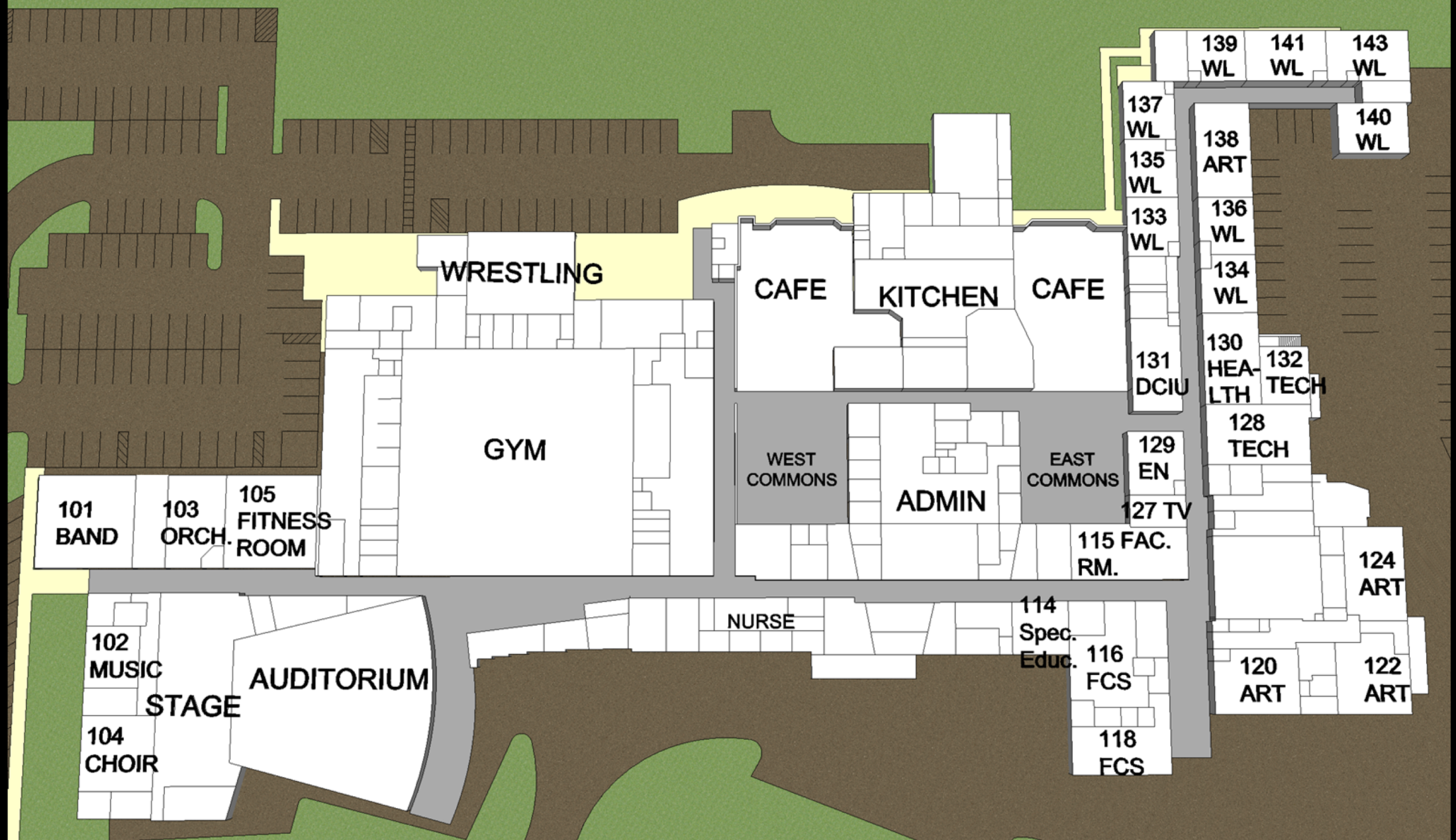

Haverford Senior High School
First Floor - Existing Floor Plan
School District of Haverford Township



An aerial photograph of a suburban area in Haverford, Pennsylvania. The image shows a mix of residential streets, green spaces, and educational institutions. A large, semi-circular green field with a red running track is prominent in the center-left. To its right is a large, multi-story building with a red roof, identified as Haverford High School. Below the high school is another building, identified as Haverford Middle School. The surrounding area is filled with houses and smaller commercial buildings. The text "BUILDING AREA A PHASE 1" is overlaid in large, bold, grey letters across the center of the image.

BUILDING AREA A PHASE 1

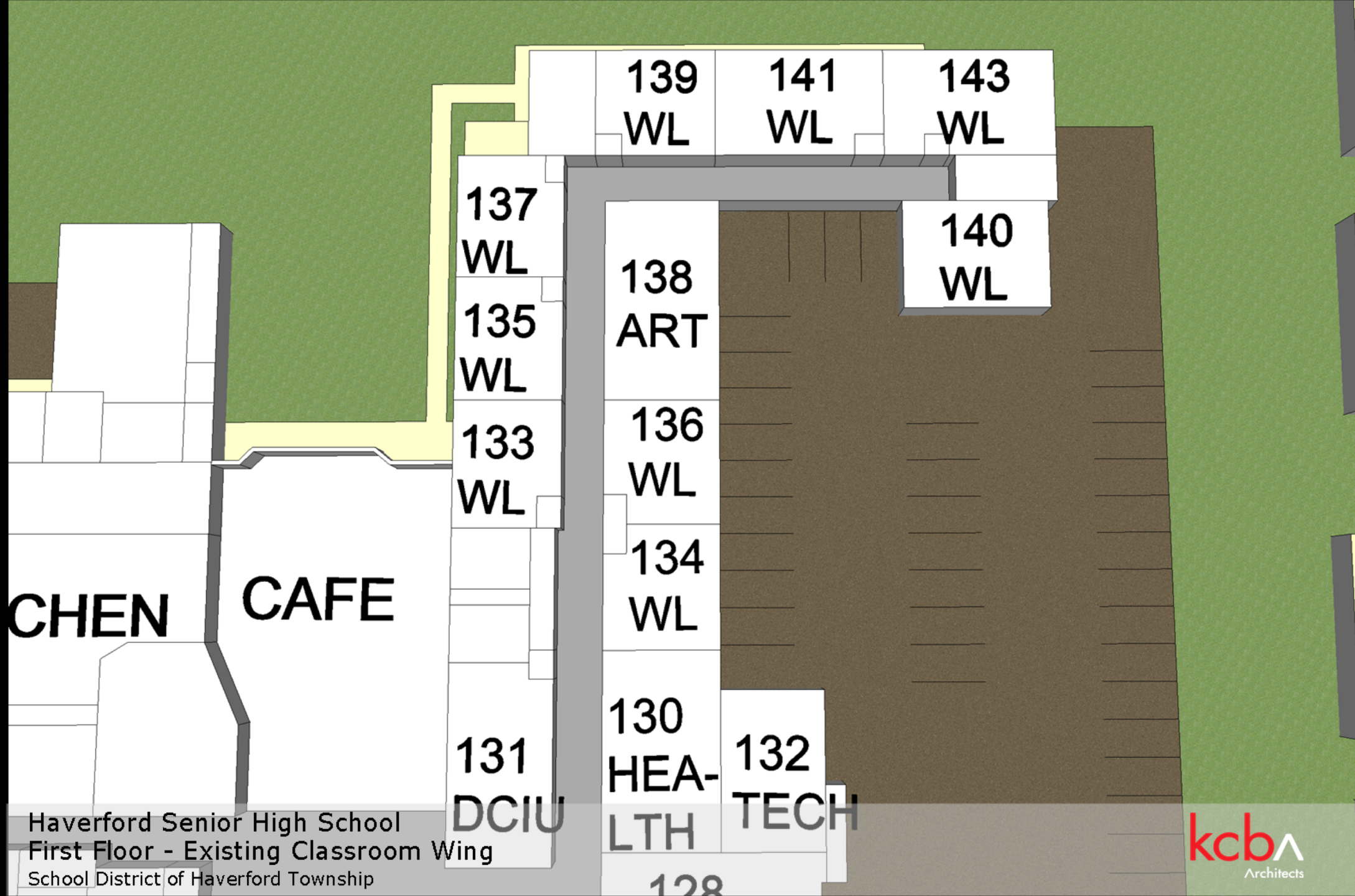

Haverford Senior High School
First Floor - Existing Classroom Wing
School District of Haverford Township

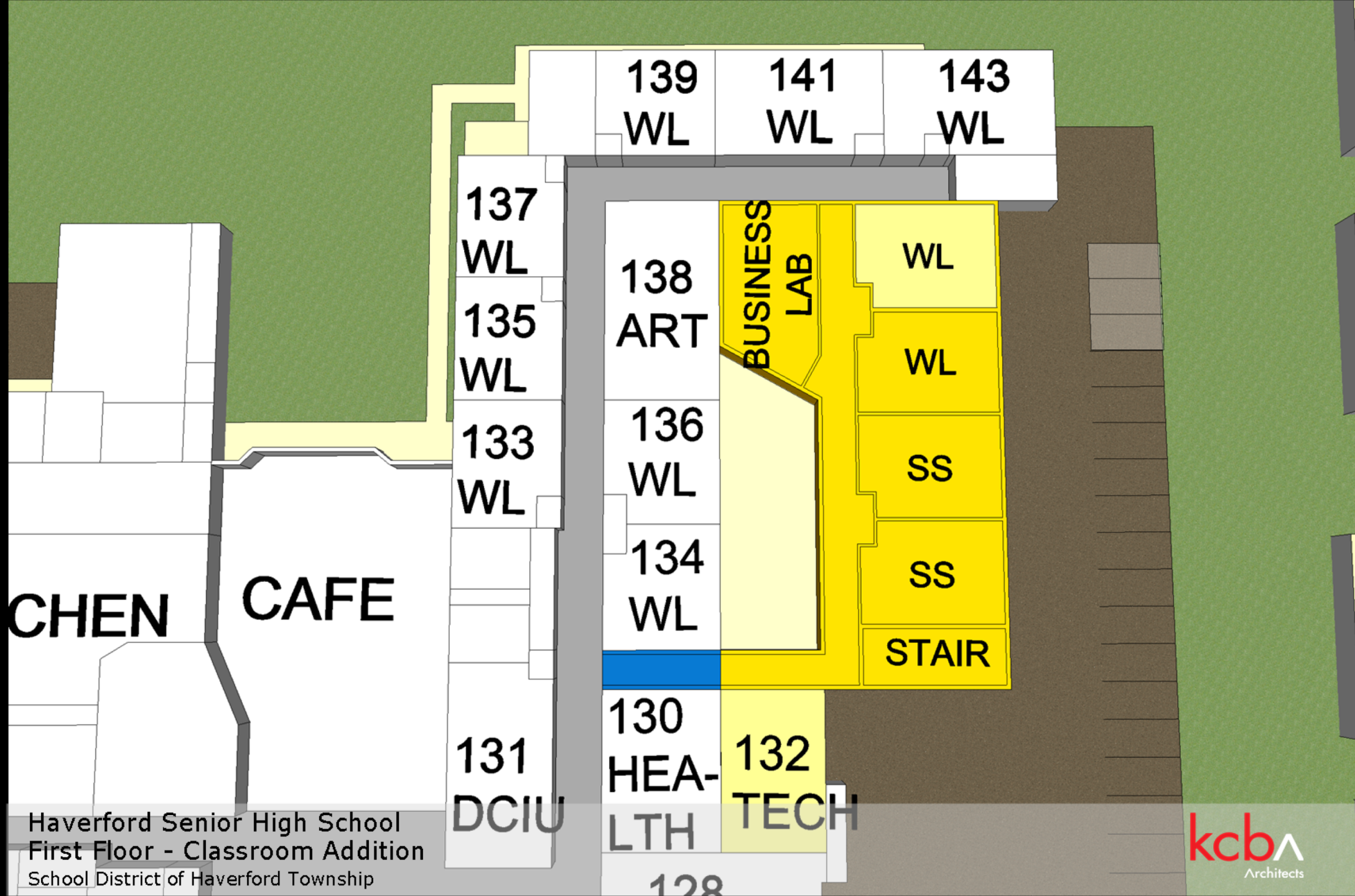

Haverford Senior High School
First Floor - Classroom Addition
School District of Haverford Township

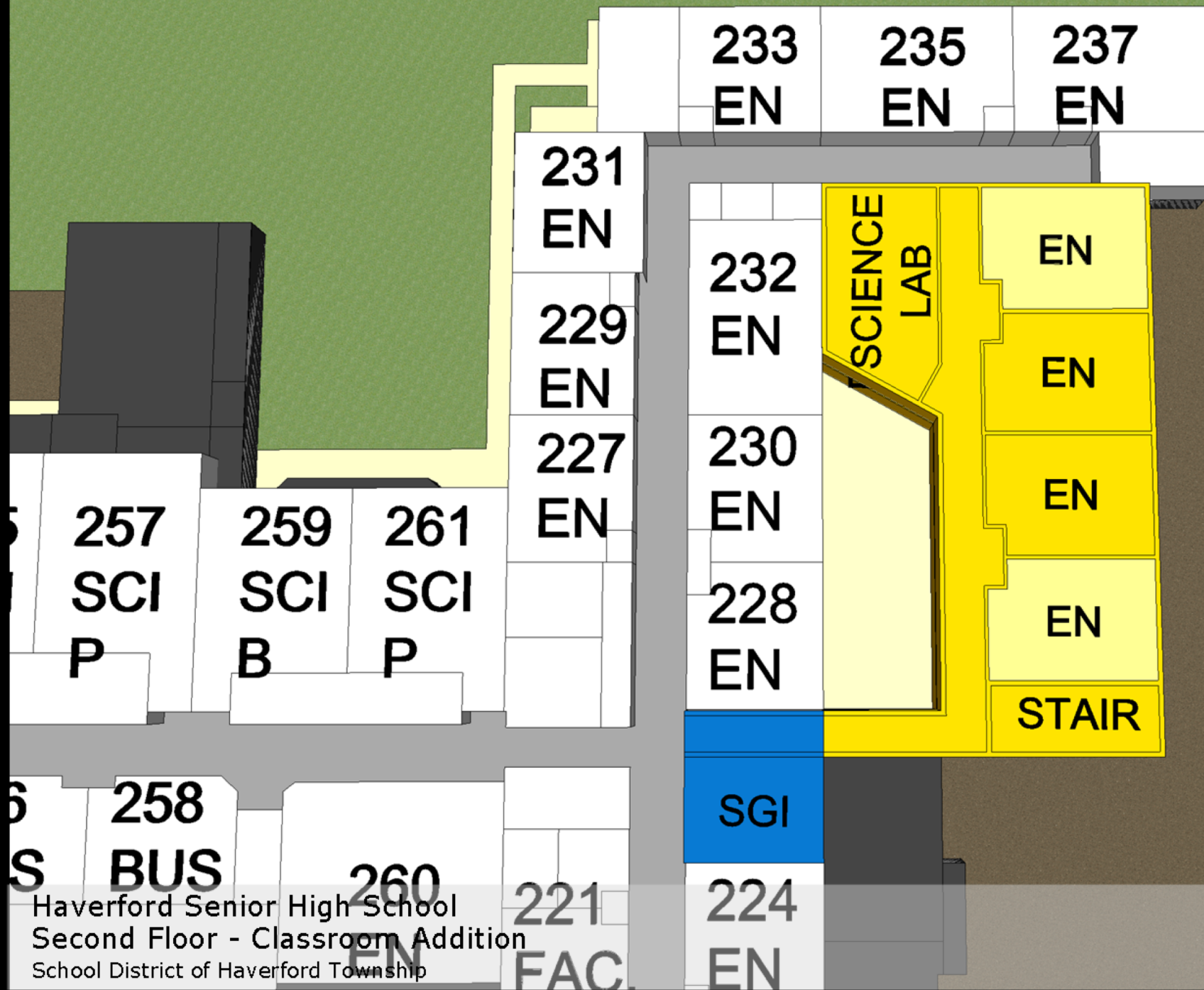

Haverford Senior High School
Second Floor - Classroom Addition
School District of Haverford Township

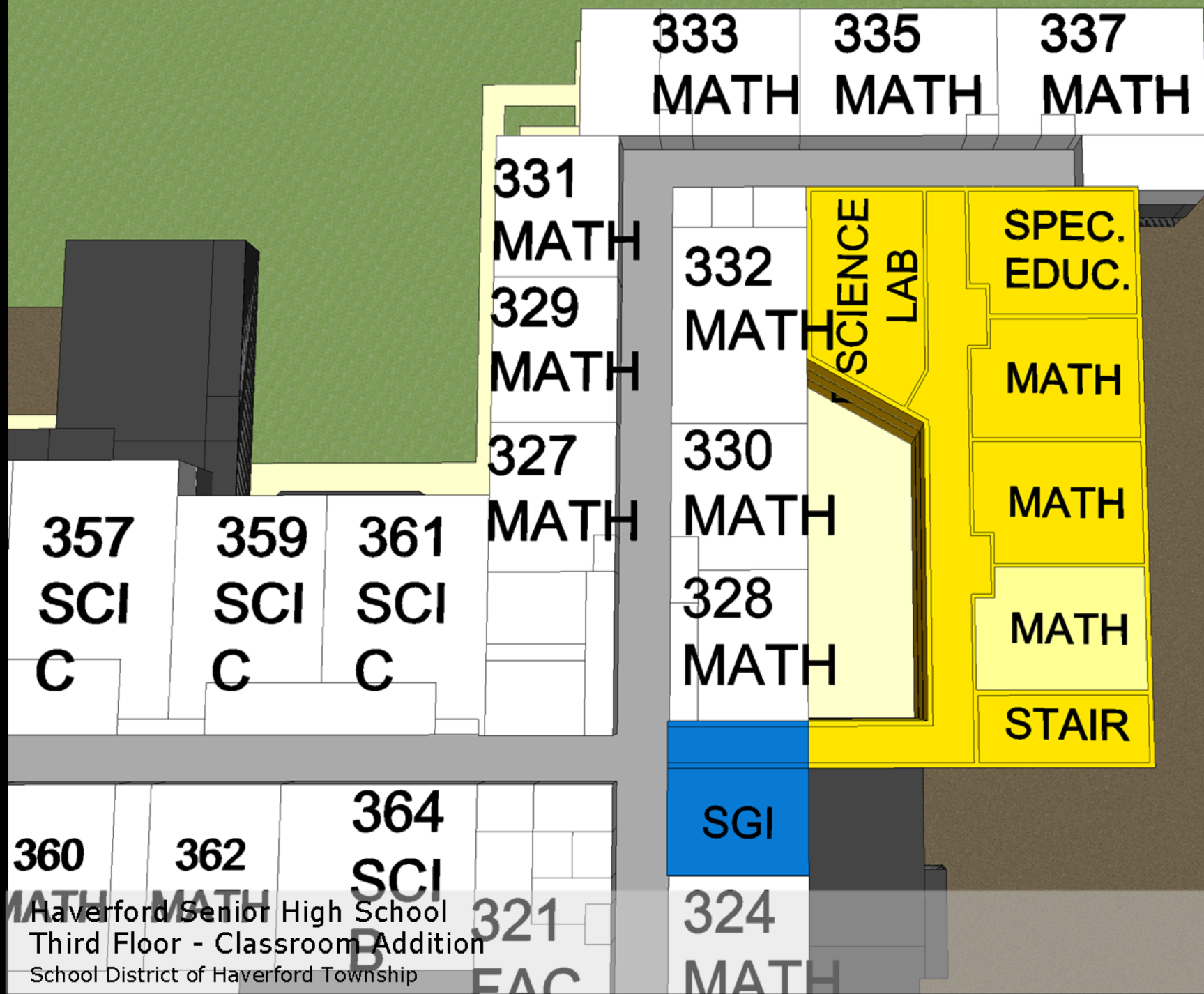

Haverford Senior High School
Third Floor - Classroom Addition
School District of Haverford Township

HAVERFORD HIGH SCHOOL

CLASSROOM ADDITION

Classroom Addition & Modifications to link Addition

Build 15 Classrooms (3 Labs & 12 Classrooms)

- Demolish 2 Existing Classrooms to accommodate new Addition
- Convert 2 Existing Classrooms into SGI's to allow for a corridor to link to the new addition

Total Gain of 11 Classrooms, 2 SGI's & improved Circulation

HAVERFORD HIGH SCHOOL

AREA A - COST ESTIMATE

Phase 1

Area A - Addition	19,500	SF	\$312	\$6,076,000
Area A - Renovation	3,950	SF	\$101	\$399,000
Area A General Conditions - 9 Months	23,450	SF	\$39	\$906,370
Sitework				w/ Phase 2
Total	23,450	SF	\$315	\$7,381,370
Escalation - 1.5 Years		4.5%		\$332,000
Total w/ Escalation	23,450	SF	\$329	\$7,713,370

Includes 10% Contingency

An aerial photograph of a school campus and surrounding residential area. The central feature is a large green field with a red running track. To the left of the field is a baseball field. To the right is a large school building with a red roof. The area is surrounded by residential streets and houses. The text "BUILDING AREA B" and "PHASE 2" is overlaid in large, bold, grey letters.

BUILDING AREA B

PHASE 2

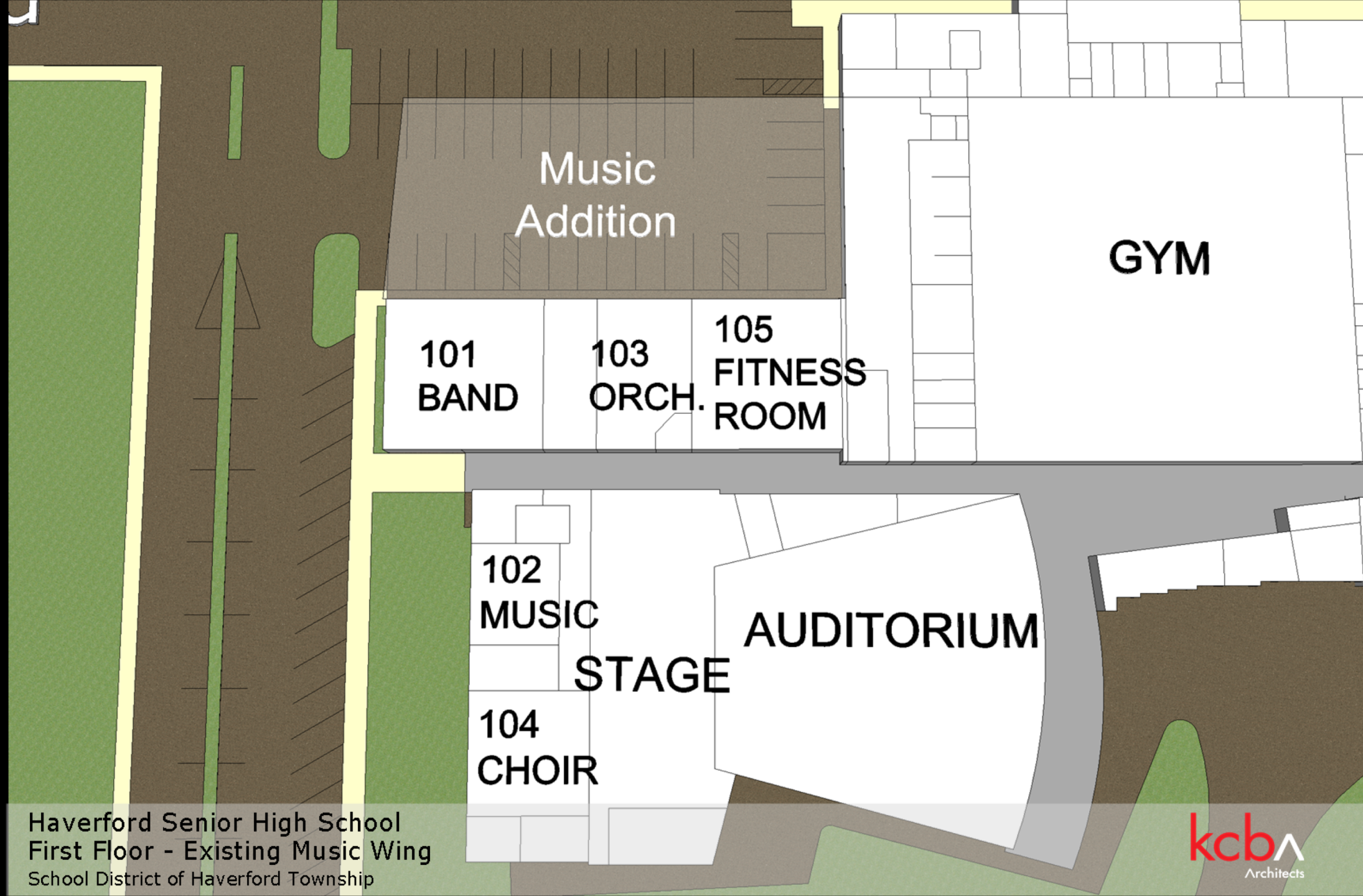

Haverford Senior High School
First Floor - Existing Music Wing
School District of Haverford Township

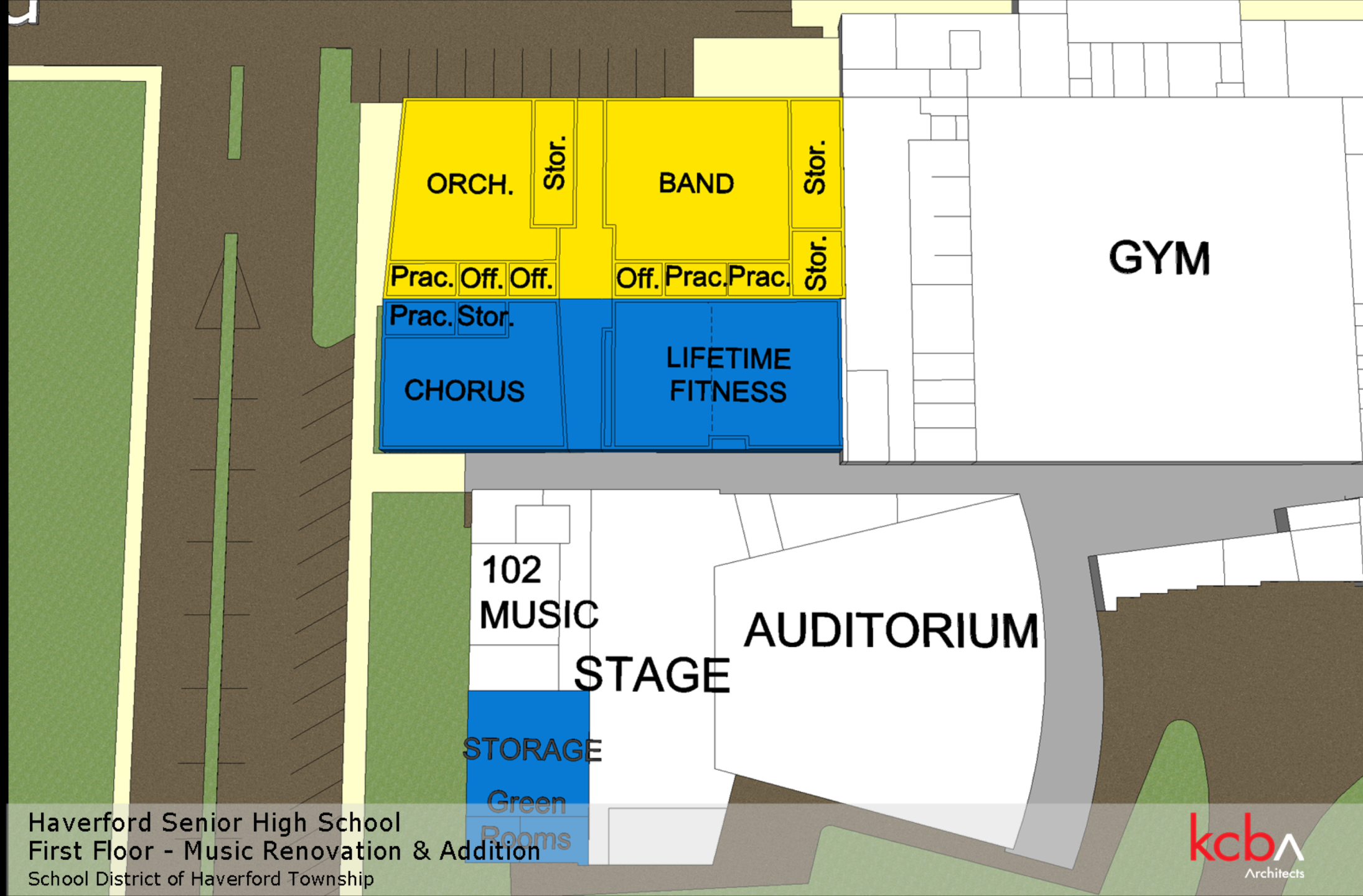

Haverford Senior High School
First Floor - Music Renovation & Addition
School District of Haverford Township

An aerial photograph of a suburban area in Haverford, Pennsylvania. The image is overlaid with a semi-transparent grey rectangle. In the center of this rectangle, the word "SITE" is written in large, bold, dark grey capital letters. The map shows a mix of residential streets, green spaces, and educational institutions. To the left of the "SITE" area is a large green field with a red running track, identified as Haverford Middle School. To the right is a large complex of red-roofed buildings, identified as Haverford High School. Various streets are labeled, including E Marthart Ave, E Turnbull Ave, Leedom Ave, Mill Rd, Strathmore Rd, and Allston Rd. A baseball field is visible near the top center, and a large green field is to the right of the middle school.

SITE

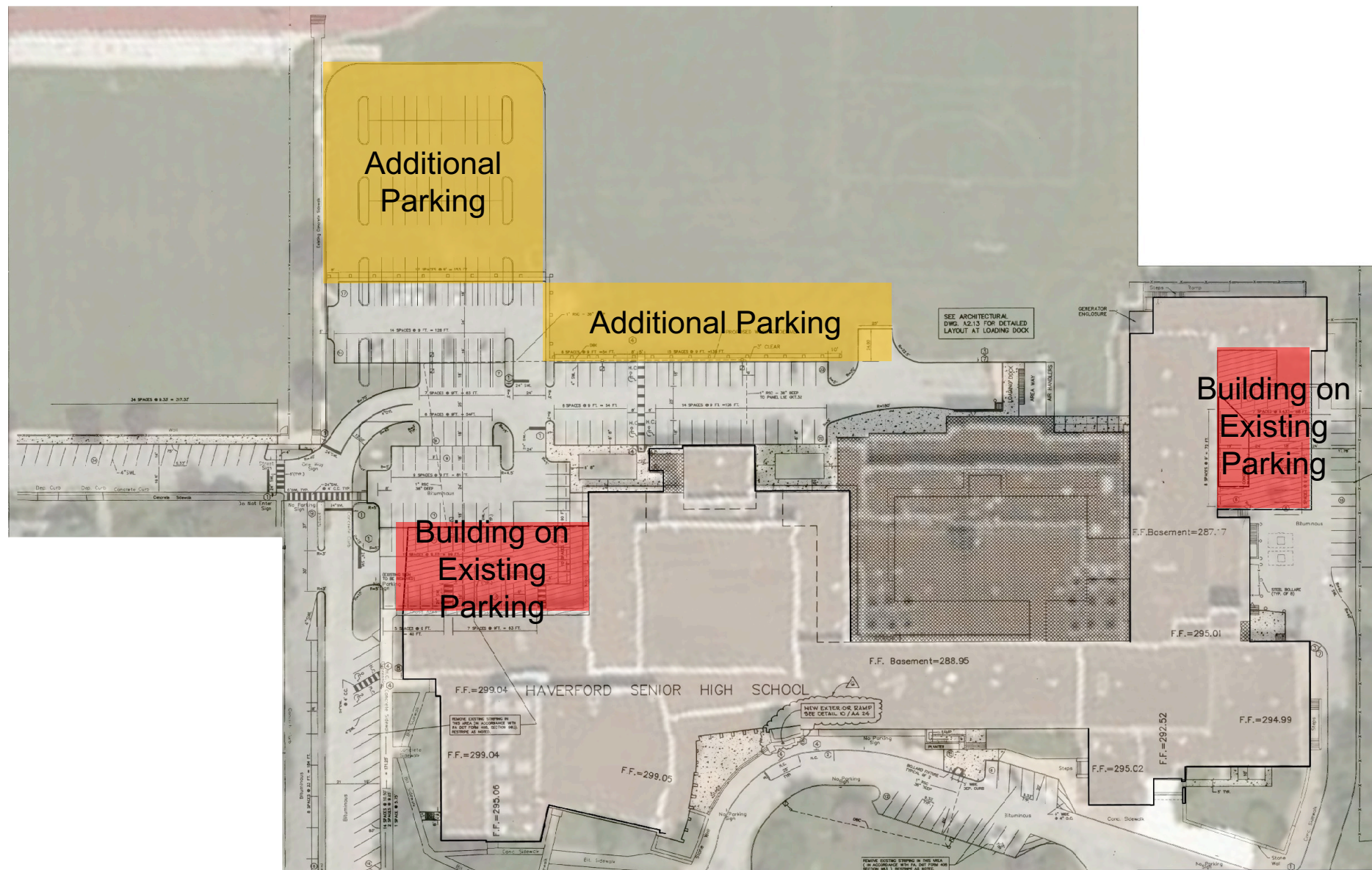

ADDITIONAL PARKING AND PARKING RECONFIGURATION HAVERFORD HIGH SCHOOL

HAVERFORD HIGH SCHOOL

AREA B - COST ESTIMATE

Phase 2

Area B - Addition	8,700	SF	\$341	\$2,969,000
Area B - Renovation	6,400	SF	\$182	\$1,164,000
Area B General Conditions - 9 Months	15,100	SF	\$57	\$858,860
Sitework				\$617,000
Total	15,100	SF	\$371	\$5,608,860
Escalation - 3 Years		9.0%		\$505,000
Total w/ Escalation	15,100	SF	\$405	\$6,113,860

Includes 10% Contingency

HAVERFORD HIGH SCHOOL

TOTAL COST ESTIMATE

Phase 1

Area A - Addition	19,500	SF	\$312	\$6,076,000
Area A - Renovation	3,950	SF	\$101	\$399,000
Area A General Conditions - 9 Months	23,450	SF	\$39	\$906,370
Sitework				w/ Phase 2
Total	23,450	SF	\$315	\$7,381,370
Escalation - 1.5 Years		4.5%		\$332,000
Total w/ Escalation	23,450	SF	\$329	\$7,713,370

Includes 10% Contingency

Phase 2

Area B - Addition	8,700	SF	\$341	\$2,969,000
Area B - Renovation	6,400	SF	\$182	\$1,164,000
Area B General Conditions - 9 Months	15,100	SF	\$57	\$858,860
Sitework				\$617,000
Total	15,100	SF	\$371	\$5,608,860
Escalation - 3 Years		9.0%		\$505,000
Total w/ Escalation	15,100	SF	\$405	\$6,113,860

Includes 10% Contingency

Total - Construction	38,550	SF	\$359	\$13,827,230
-----------------------------	---------------	-----------	--------------	---------------------

HAVERFORD HIGH SCHOOL

TOTAL PROJECT COST ESTIMATE

Order of Magnitude

Classroom Addition/Renovation

$21,500 \text{ sf} \times \$300 = \$6,450,000 \times 30\% = \$8,385,000$

Music & Fitness Addition & Renovation

$15,100 \text{ sf} \times \$300 = \$4,530,000 \times 30\% = \$5,889,000$

Site

$30,000 \text{ sf} \times \$50 = \$1,500,000 \times 30\% = \$1,950,000$

Total = \$16,224,000

SD Project Cost Estimate

Classroom Addition/Renovation

\$7,713,370

Music & Fitness Addition & Renovation

\$6,113,860

Site

Included Above

Subtotal = \$13,827,230 + 20% Soft Costs

Total = \$16,592,676

HAVERFORD HIGH SCHOOL

NEXT STEPS

- Township Approvals
 - Including Zoning & Planning Commission

DISCUSSION





CLASSROOM WING EXTERIOR PERSPECTIVE
HAVERFORD HIGH SCHOOL



MUSIC WING EXTERIOR PERSPECTIVE
HAVERFORD HIGH SCHOOL



BAND ROOM INTERIOR PERSPECTIVE
HAVERFORD HIGH SCHOOL



ORCHESTRA ROOM INTERIOR PERSPECTIVE
HAVERFORD HIGH SCHOOL