



Spring Woods High School Additions and Renovations

PAT Meeting No. 03

Spring Branch Independent School District \ Houston, Texas \ September 27th, 2018



PAT Meeting #03 (12:00pm to 1:30pm)

- Project Recap
- Options Comments Review
- Dining Commons Layout Progress
- Learning Center Layout Progress
- Commons Plaza Layout Progress
- Next Steps
- Meeting Adjourned at 1:30pm

Project Recap

**PAT 01**

08-31-2018

KICK-OFF

- Gather Data
- Start Design

**PAT 02**

09-13-2018

**Schematic
Design**

- Layout Options
- Library Services
- Nutrition Services

PAT 03

09-27-2018

**Final
Schematic
Design**

- Refine Layout
- Start Interior Concepts

PAT 04

10-04-2018

**Design
Development**

- Refine Interior
- Review Budget
- Library Services
- Nutrition Services

PAT 05

10-25-2018

**Final
Design
Develp.**

- Finalize Overall Design
- Review Interior Finishes and colors

PAT 06

12-18-2018

**Final
Design
Review**

- Review Overall Design
- Review Budget
- Review Finishes

Goal

The goal of the PAT is to ensure that parents, staff and community members have the opportunity to take part in the planning and design of new schools. The PAT members will **serve as communicators** to and from the community during the schematic design and development phases of the project and participate in discussions that will lead to recommendations. The PAT concludes its work once construction begins.

Charge

Each Project Advisory Team's (PAT) members are charged with **providing input into planning and design development** for their school's new construction or major renovation project in the 2017 Bond Program. The PAT will meet as needed throughout the project, from initial planning, through design to the start of construction. Meeting agendas and minutes will be posted on the school's bond project website.

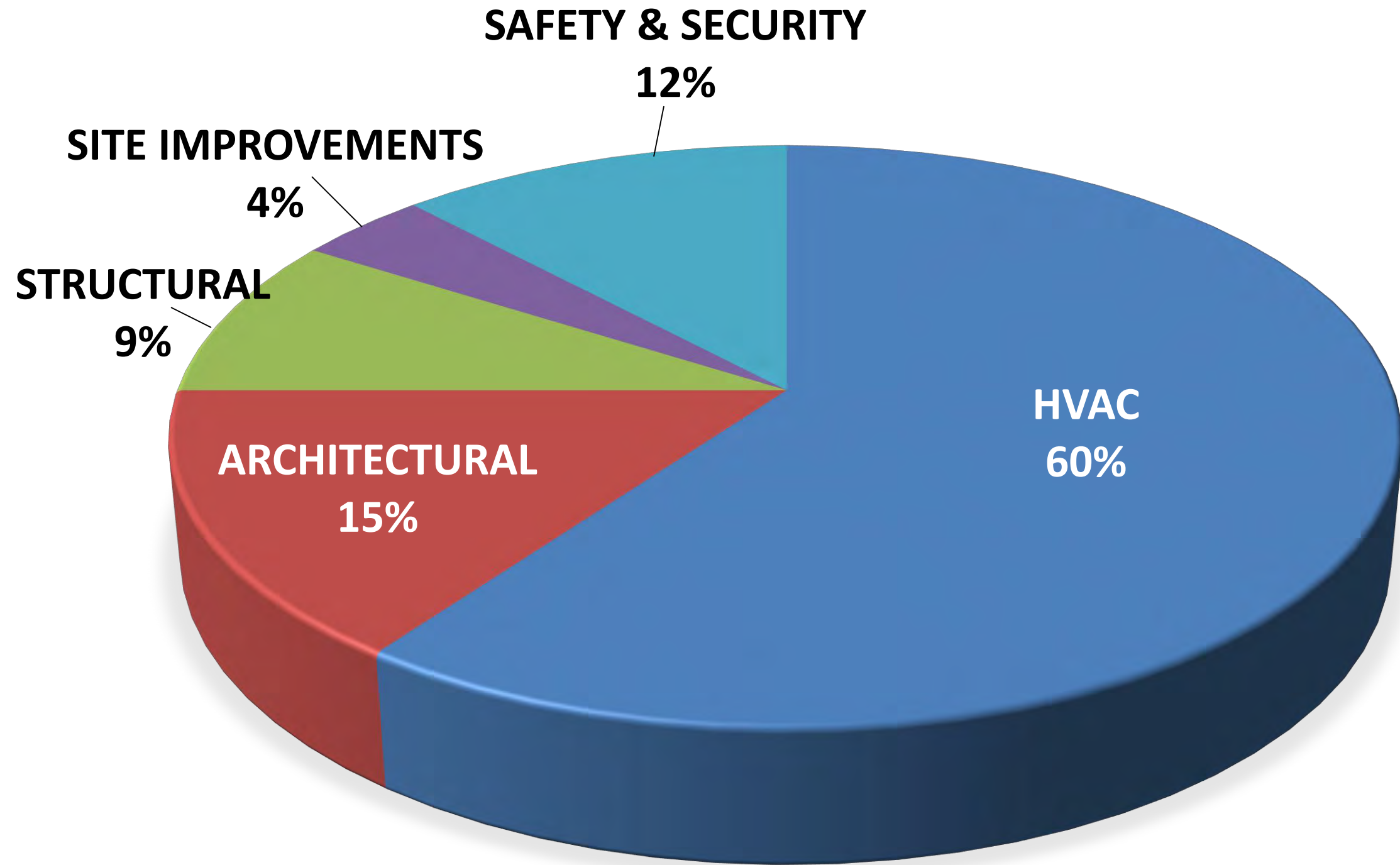

- ATHLETICS
- FURNITURE



- ENTRY – EXIT ISSUES
- PRIORITY 1: **STUDENT FLOW**
- PRIORITY 2: STUDENT SEATING
- **IMPROVE STUDENT QUEUING**
- RELOCATE ENTRY POINTS
- USE EXISTING TEACHER LOUNGE
- REMOVE EXTERIOR STAIRWAY
- **SINGLE LUNCH A POSITIVE**
- INCREASE LUNCH PERIODS
- MAXIMIZE DAYLIGHT

On behalf of the entire **PBK** Team, we thank you for this opportunity!
"With You Not To You" - SWHS

LIBRARY VISIONING IDEAS

- How do you see the functionality of the Library?
- How is the access to the Library?
- Is there a need to define a main entry on the 2nd floor?
- Does the Library need more "social" areas?
- Does the Library need more "individual" areas?
- Issues with HVAC and Lighting?

Playable spaces, zones that are bright in color and



Sentiments About The Space

- Define a main entry on 2nd floor of space?
- Define a main entry on 2nd floor of space?
- Social areas of group areas on 2nd floor
- Small personal space on 2nd floor
- First level of entry - open of light, "Life" tables, social
- Second floor - individual
- upstairs - group spaces (larger group)
- downstairs - small

On behalf of the entire **PBK** Team, we thank you for this opportunity!
"With You Not To You" - SWHS

LIBRARY VISIONING IDEAS

- How do you see the functionality of the Library?
- How is the access to the Library?
- Is there a need to define a main entry on the 2nd floor?
- Does the Library need more "social" areas?
- Does the Library need more "individual" areas?
- Issues with HVAC and Lighting?

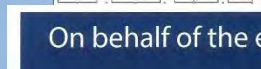
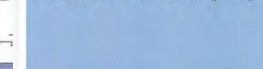

Sentiments About The Space

- Access to "tools" to inspire & develop ideas.
- Reference materials to access historical & research writings/notes

On behalf of the entire **PBK** Team, we thank you for this opportunity!
"With You Not To You" - SWHS

LIBRARY VISIONING IDEAS

- How do you see the functionality of the Library?
- How is the access to the Library?
- Is there a need to define a main entry on the 2nd floor?
- Does the Library need more "social" areas?
- Does the Library need more "individual" areas?
- Issues with HVAC and Lighting?

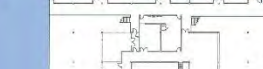
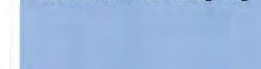

Sentiments About The Space

- Dining Commons & Library: They need more "definition" to identify them as "lunch room" & "library room"
- Stair by dining area -> it's on the way. Area needs better flow inside.
- Stair to library access 2nd floor -> wind/dark feeling of "do not go up". More lighting & shared spaces (couches & where feeling)

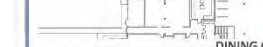

LIBRARY - 1ST FLOOR



LIBRARY - 2ND FLOOR



DINING COMMONS VISIONING IDEAS

- Is there a student flow issue?
- Is there a need for additional seating?
- How is the front entry to the Commons?
- Is the stair "in the way"?
- How is the entry to the serving area?
- Issues with HVAC and Lighting?



DINING COMMONS

- IMPROVE **ACCESIBILITY**
- MORE **INVITING**
- STUDY/ SOCIAL BALANCE
- 1ST FLOOR PLACKED
- 2ND FLOOR UNDERUTILIZED
- WANT **FLEXIBLE SPACES**
- CONNECT TO ACADEMICS
- NO SPACE FOR LARGE GROUPS
- ADD TECH/POWER HUBS
- TAKE ADVANTAGE OF LOCATION

On behalf of the entire **PRK** Team, we thank you for this opportunity!
 "With You Not To You" - SWHS

LIBRARY VISIONING IDEAS

- How do you see the functionality of the Library? *Diff. spaces because it's in flux w/ 1st*
- How is the access to the Library? *Very good*
- Is there a need to define a main entry on the 2nd floor? *No*
- Does the Library need more "social" areas? *Not more, but defined spaces*
- Does the Library need more "individual" areas? *Flexibility*
- Issues with HVAC and Lighting? *It's cold, Lighting to parkade*

LIBRARY - 1ST FLOOR

Sentiments About The Space

Library wish list →

- updated furniture
- remote window blinds
- larger circulation desk
- updated active boards w/ software
- bookend study - library

On behalf of the entire **PRK** Team, we thank you for this opportunity!
 "With You Not To You" - SWHS

LIBRARY VISIONING IDEAS

- How do you see the functionality of the Library?
- How is the access to the Library?
- Is there a need to define a main entry on the 2nd floor?
- Does the Library need more "social" areas?
- Does the Library need more "individual" areas?
- Issues with HVAC and Lighting?

LIBRARY - 1ST FLOOR

Sentiments About The Space

Love the natural light!

Current ground floor second floor is a spatial mixture separating second floor from separating from existing space. Needs from ground floor separate floor.

Second floor/drop off SF library to not have to go

On behalf of the entire **PRK** Team, we thank you for this opportunity!
 "With You Not To You" - SWHS

LIBRARY VISIONING IDEAS

- How do you see the functionality of the Library?
- How is the access to the Library?
- Is there a need to define a main entry on the 2nd floor?
- Does the Library need more "social" areas?
- Does the Library need more "individual" areas?
- Issues with HVAC and Lighting?

LIBRARY - 1ST FLOOR

Sentiments About The Space

Library - need 2nd store entry - overall. Could need renovations so that classes that are using the library are not disturb when other enter.

- needs a media area for student use
- love the natural light but not the sound
- library needs more signage of area
- move extract offices out and use the space for student centers

Cafeteria

- yes there is a school fly issue, and a need for more seating
- Is it possible to make it two stories by removing the class rooms
- make more inviting

DINING C

LIBRARY - 2ND FLOOR

DINING COMMONS VISIONING IDEAS

- Is there a student flow issue? *Lines block doors*
- Is there a need for additional seating?
- How is the front entry to the Commons?
- Is the stair "in the way"? *yes - remove staircase*
- How is the entry to the serving area? *Blocked w/ traffic*
- Issues with HVAC and Lighting? *throughout the building*

DINING COMMONS

PRK
 116 Gateway Park
 2nd Floor
 Houston, Texas 77065
 800.938.7272
 PRK.com

Dining Commons Layout Progress

Spring Woods High School Additions and Renovations

Existing Dining Commons Plan

Seating Count/ Queue Line

Tables/ Seating

Existing Tables: 39 seats

Existing Seating: 468 seats

Queue Lines

Existing Queue: 255' lft.

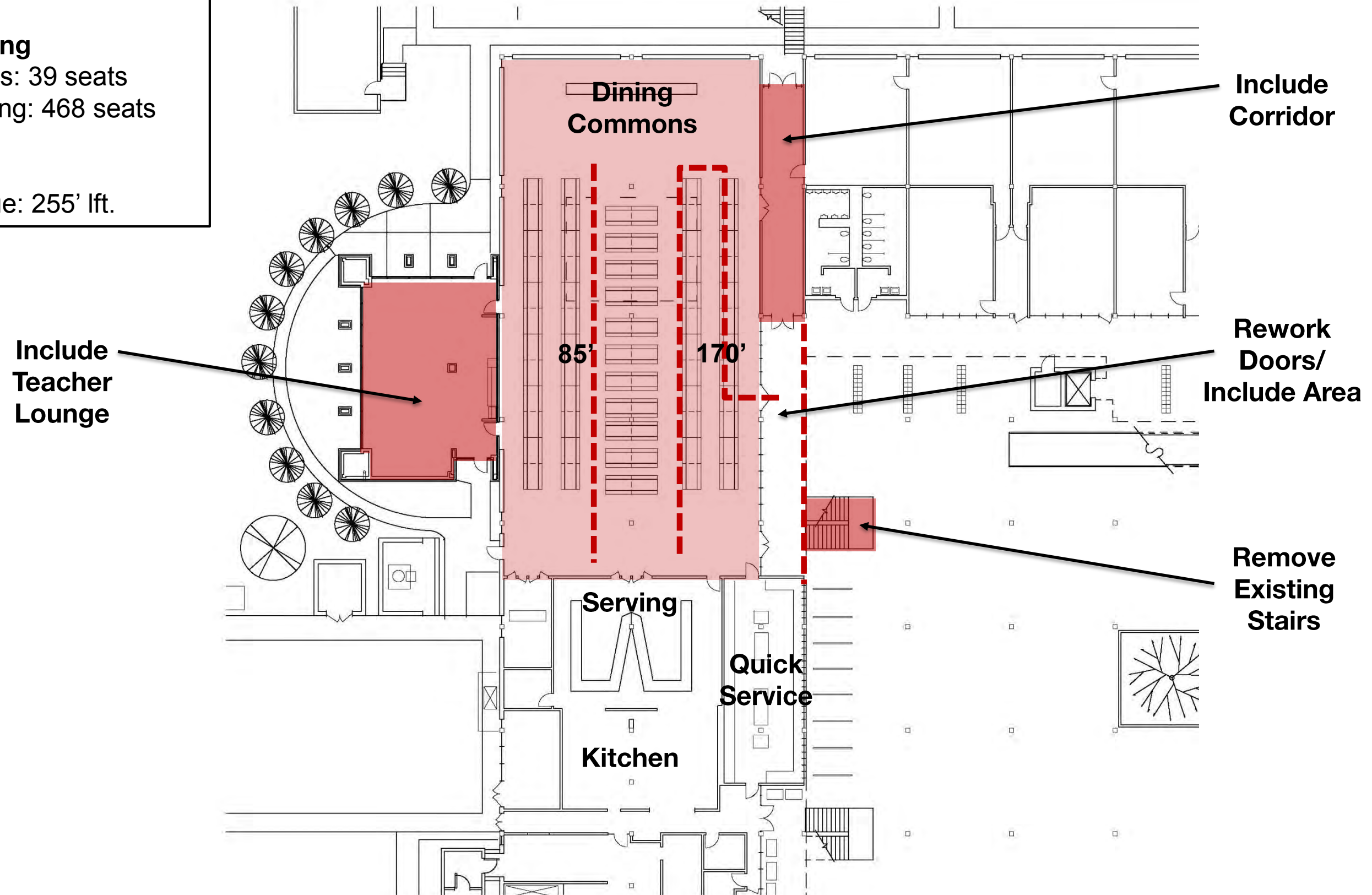

Spring Woods High School Additions and Renovations

Dining Commons Options

Seating Count/ Queue Line

Tables/ Seating
 Existing Seating: 468 seats
 "A1" Tables: 44 tables
 "A1" Seating: 528 seats

Queue Lines
 Existing Queue: 255' lft.
 "A1" Queue: 334 lft.

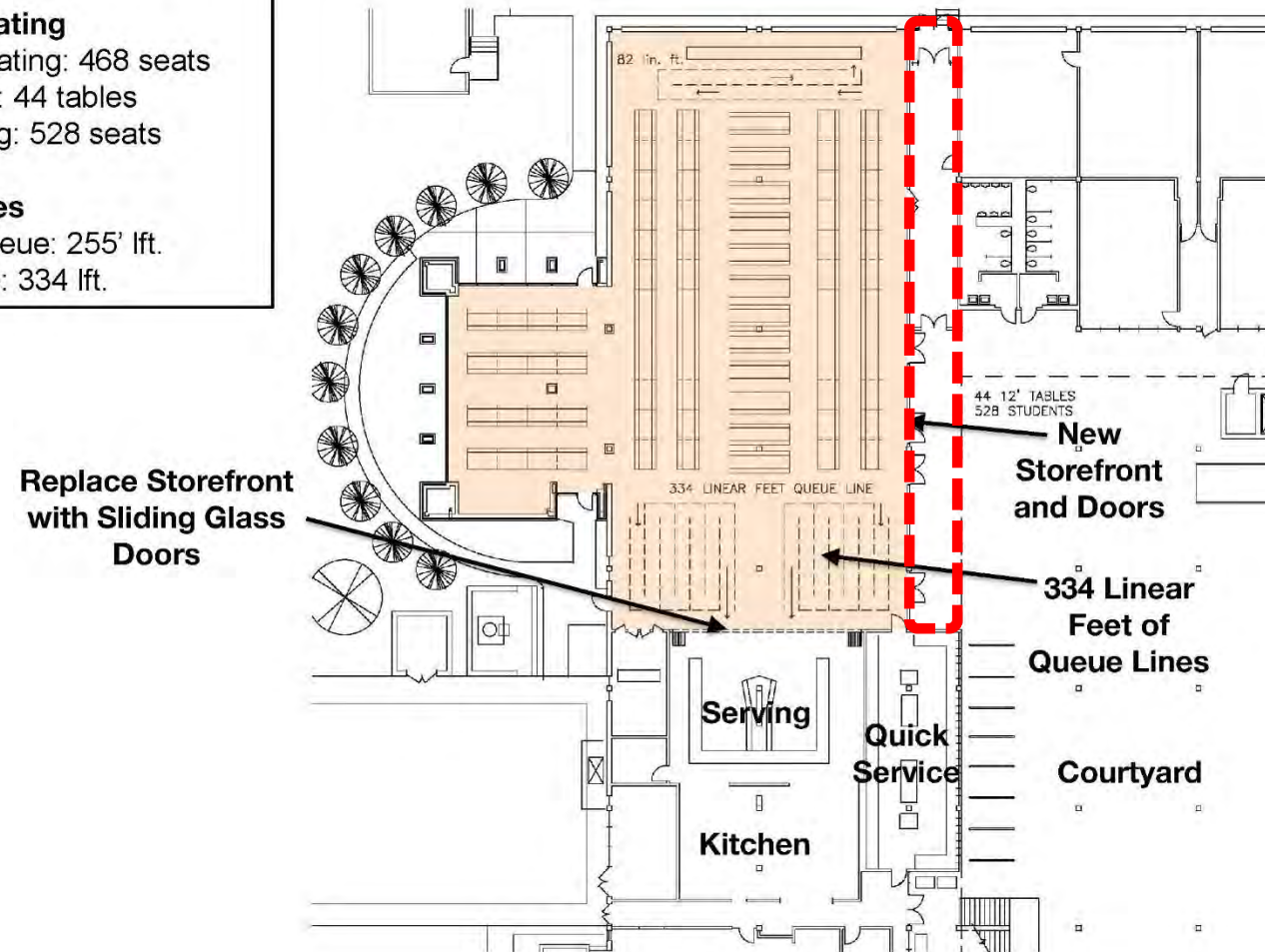

Opt A

Seating Count/ Queue Line

Tables/ Seating
 Existing Seating: 468 seats
 "B1" Tables: 50 tables
 "B1" Seating: 600 seats

Queue Lines
 Existing Queue: 255 lft.
 "B1" Queue: 480 lft.

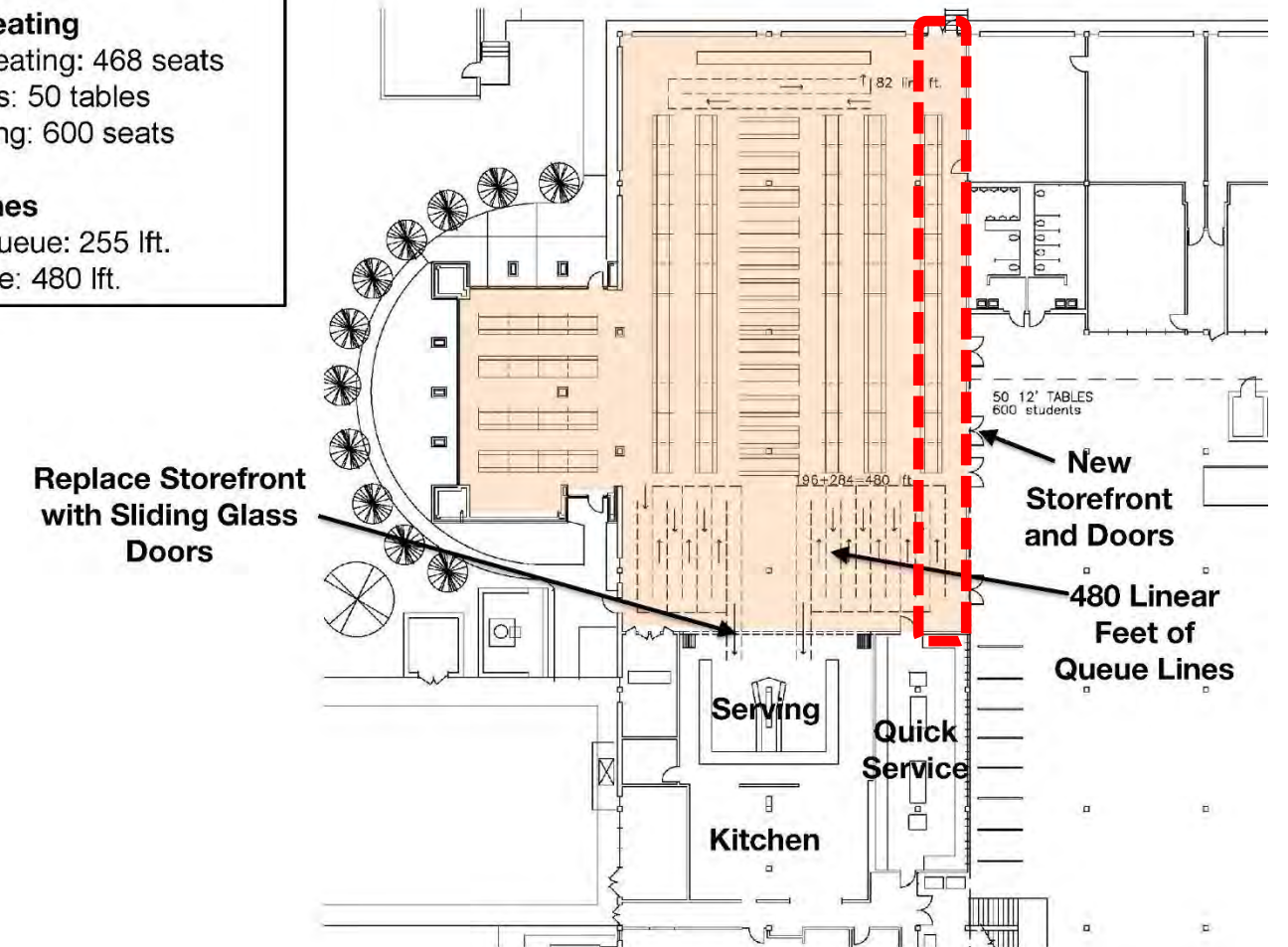

Opt B

Spring Woods High School Additions and Renovations

Dining Commons Options

Seating Count/ Queue Line

Tables/ Seating

Existing Seating: 468 seats

"C" Seats (inside): 600 seats

Queue Lines

Existing Queue: 255 lft.

"C" Queue: 480 lft.

Replace Storefront
with Sliding Glass
Doors

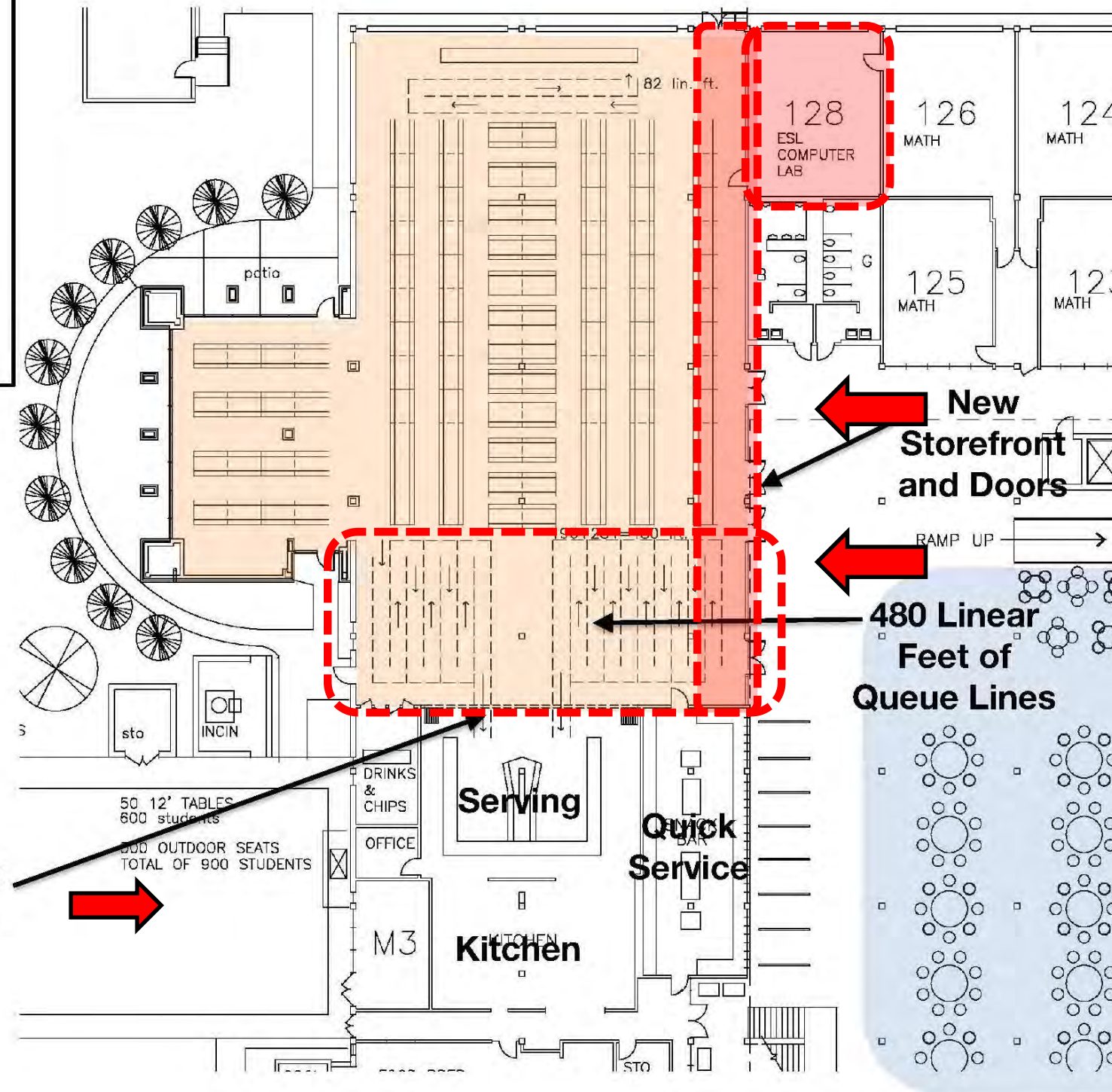

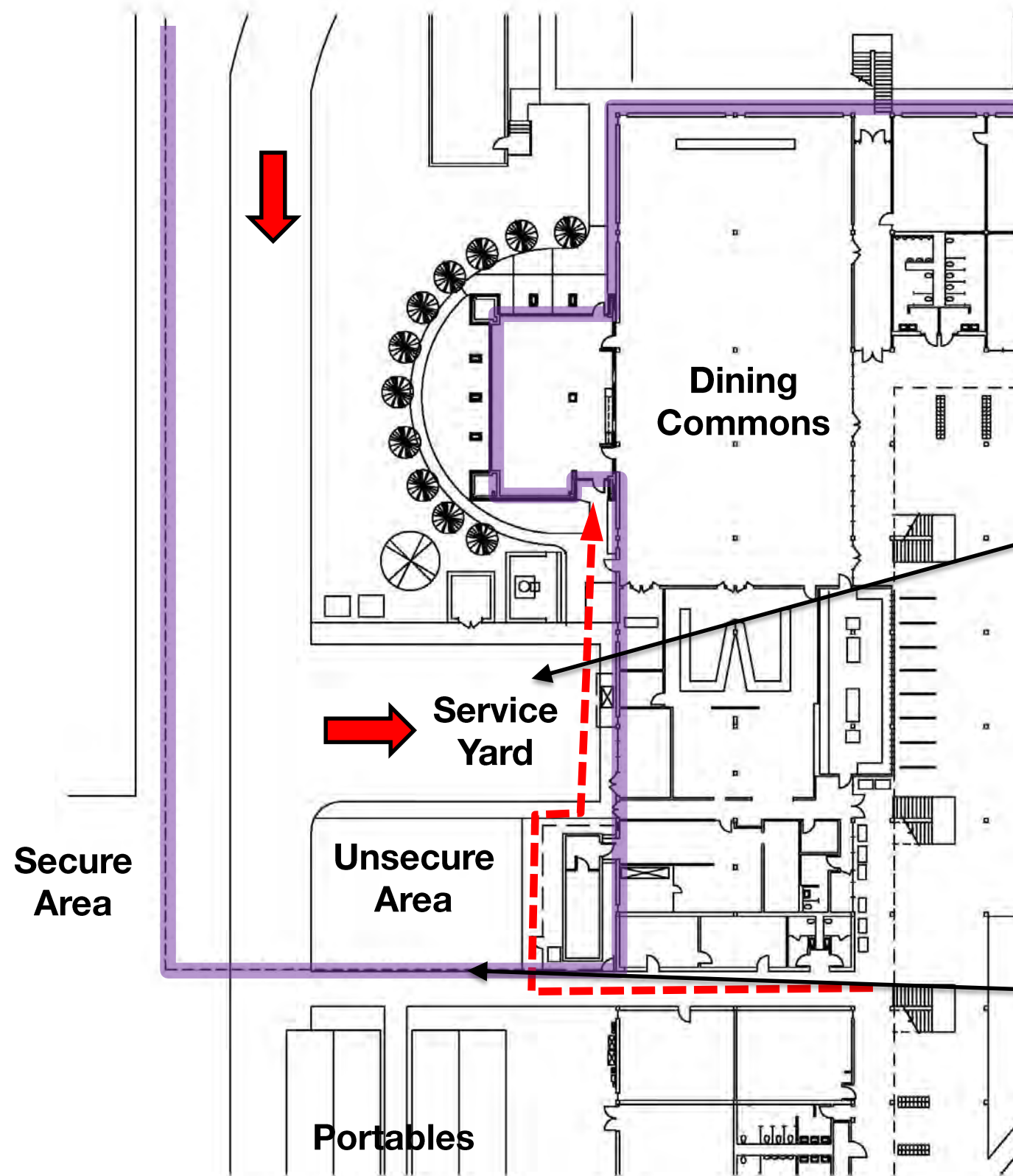

Service Yard



Security Fencing



- Need queue line control system
- Have one queue line instead of two
- Capture maximum expansion as possible
- Expand Commons into hallway and under balcony
- Repurpose classroom for Commons
- Add more daylight
- Variety of seating (as possible)
- Keep looking into reshaping serving lines

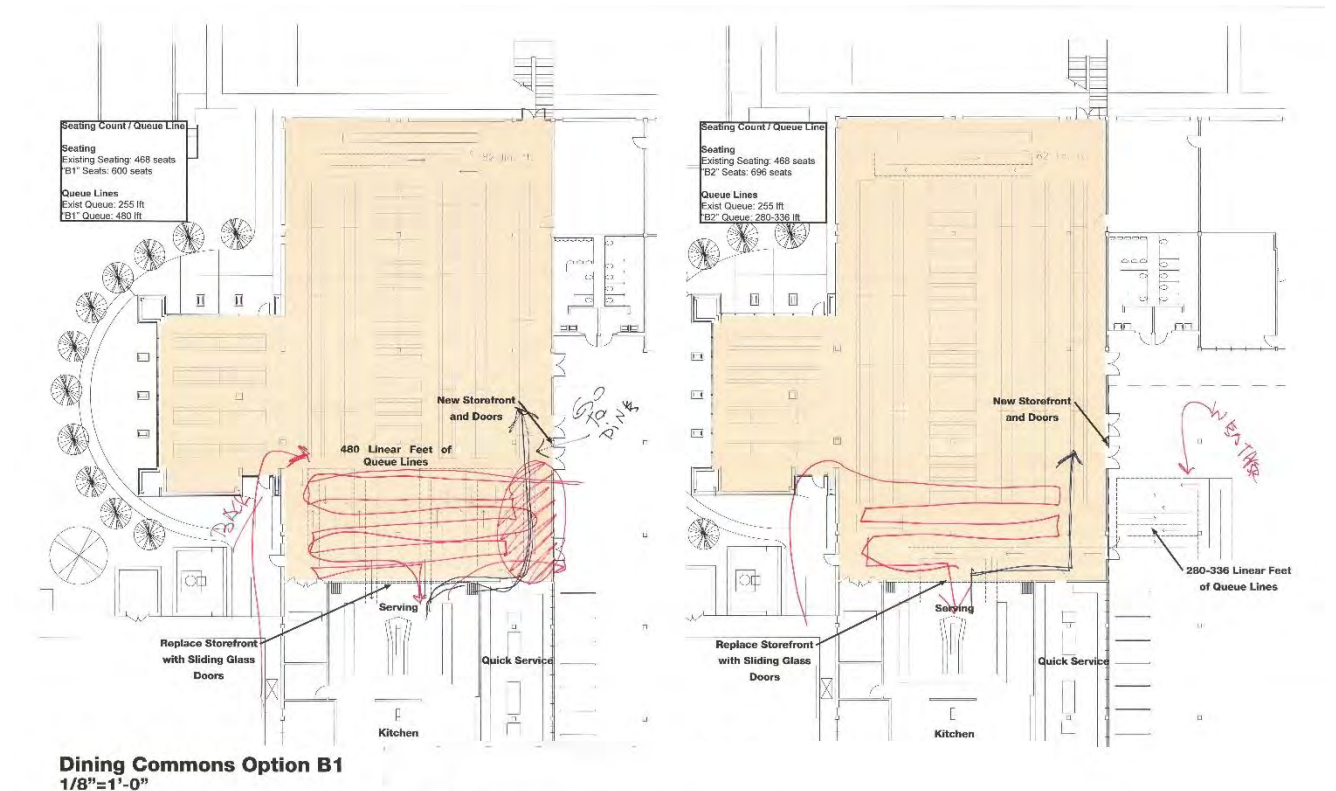

SPRING WOODS HIGH SC
SPRING BRANCH INDEPENDENT SC

— CONSIDER QUEUE OUTSIDE:
FUNCTION, FEEL, ETC. PRO/CON

UT OPTIONS **PRK**

— NEED PERMANENT QUEUE LINES
(ARROWS OR FLOOR PAINT MARK)

— FORCE PEDESTRIAN TRAFFIC AROUND CAFE
ENERGIZE "BACK"

— SPLIT LINES FOR SPEED

— ENSURE SPACE AT DOORS IS AVAILABLE/OPEN
EXTEND LINES FARTHER WITHIN SPACE

— BACK ENTRY HELPS DISCHARGE TO COURTYARD

— CAPTURING MAX. EXPANSION BOTH SIDES DESIRED

Spring Woods High School Additions and Renovations

Dining Commons Layout

Seating Count/ Queue Line

Tables/ Seating

Existing Seating: 468 seats
"C" Seats (inside): 607 seats

Queue Lines

Existing Queue: 255 lft.
"C" Queue: 440 lft.

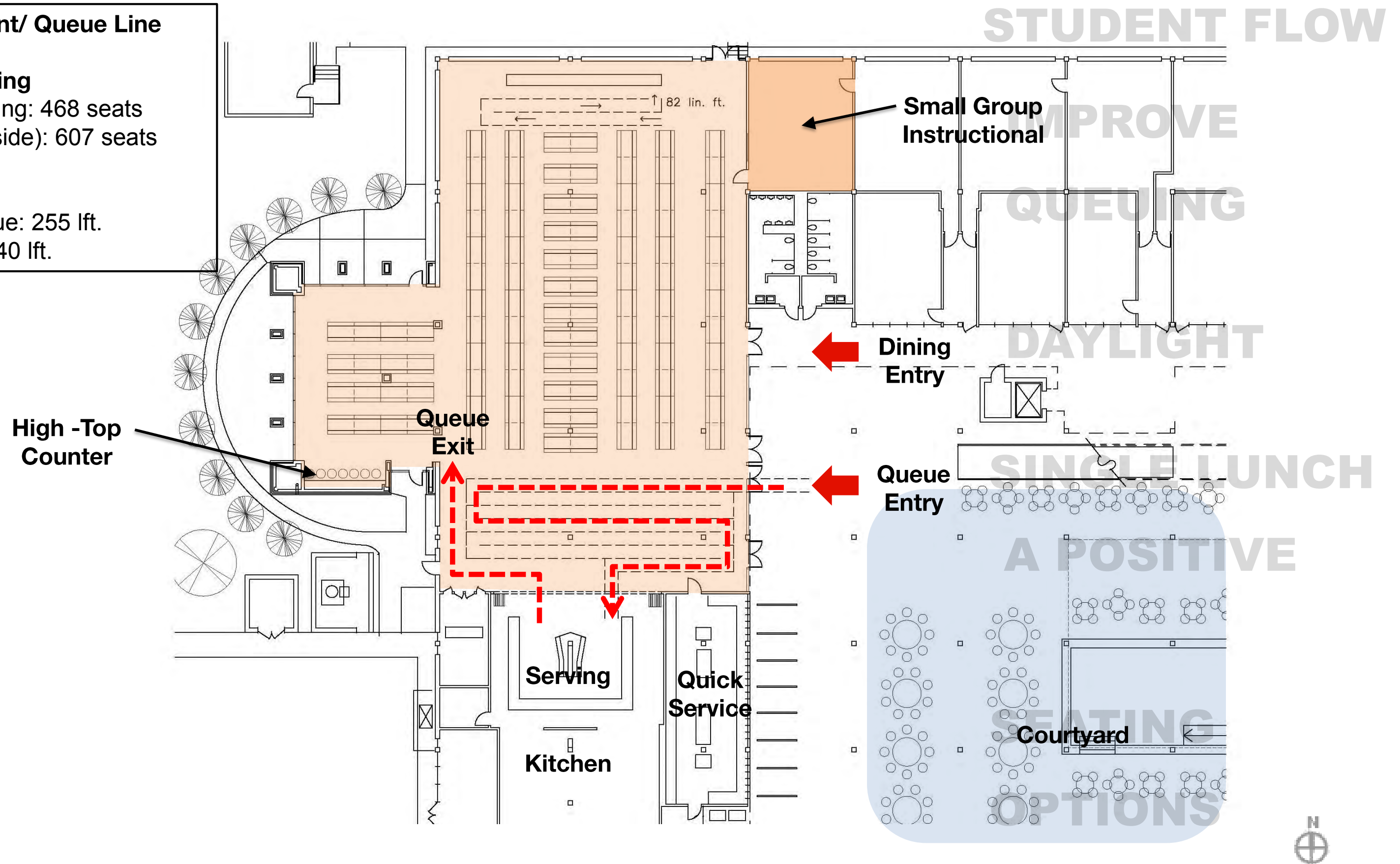

Spring Woods High School Additions and Renovations

Dining Commons Examples



Spring Woods High School Additions and Renovations

Dining Commons Examples



Learning Center Layout Progress

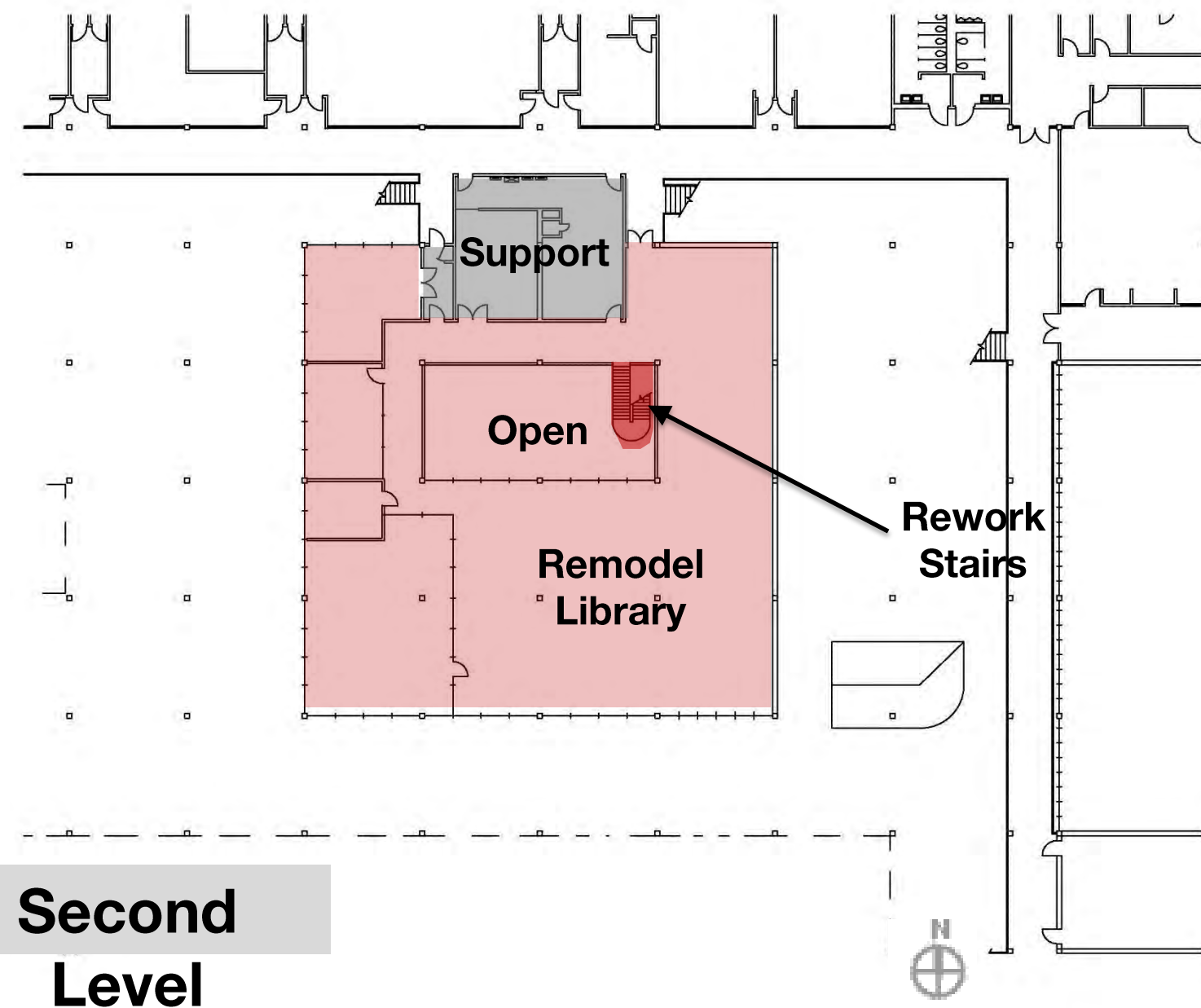
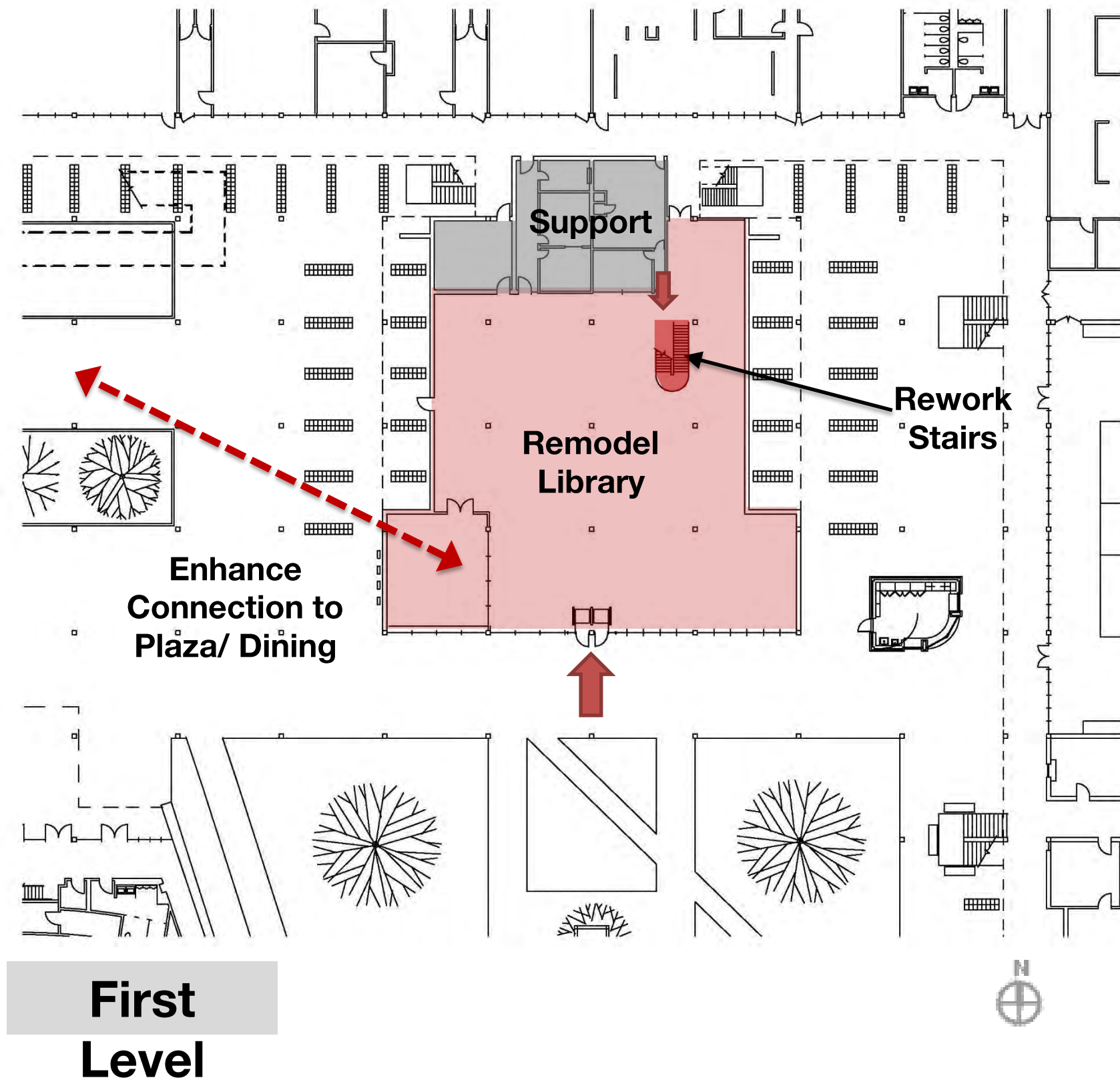

Spring Woods High School Additions and Renovations

Learning Commons Options

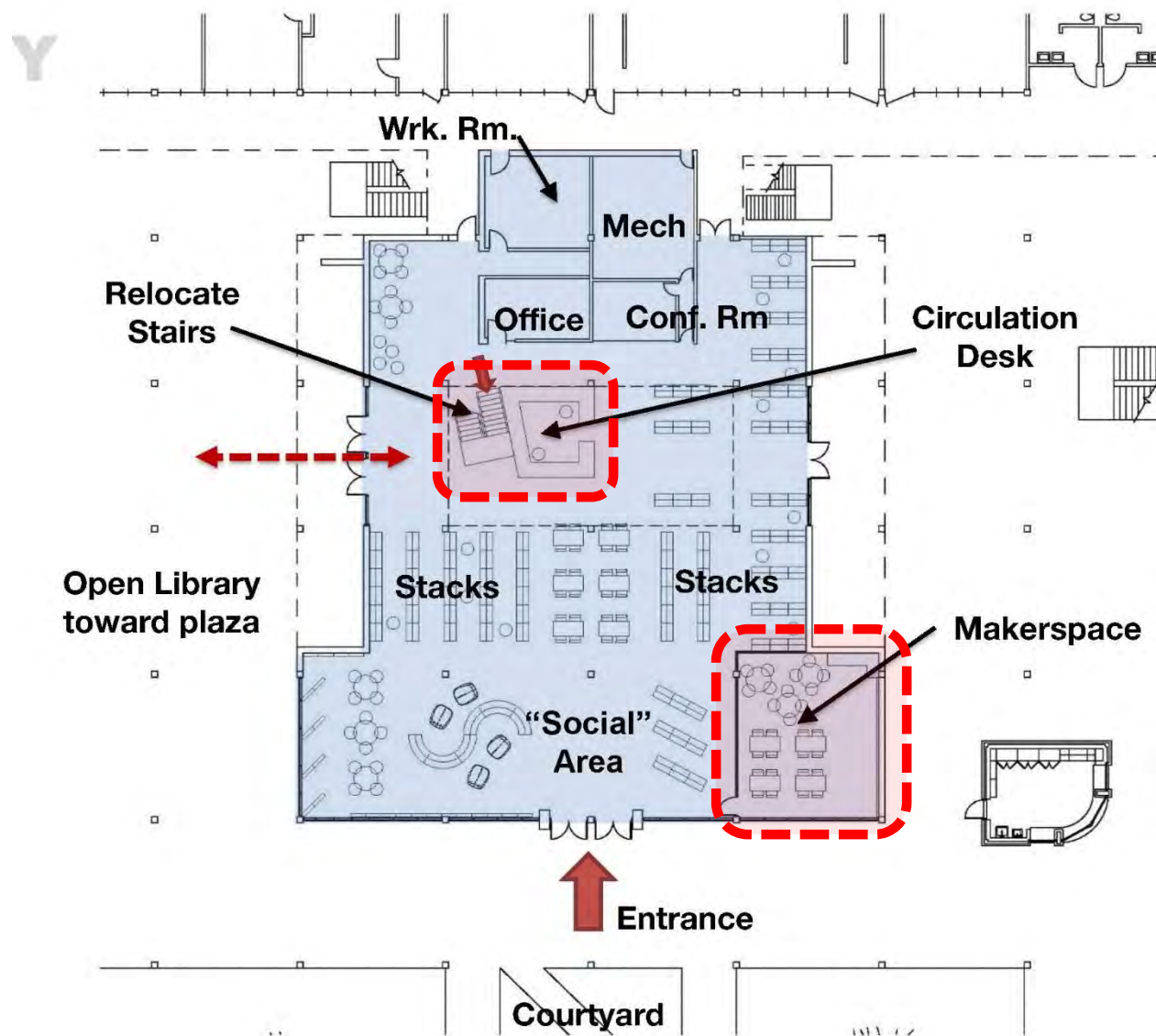

Opt A

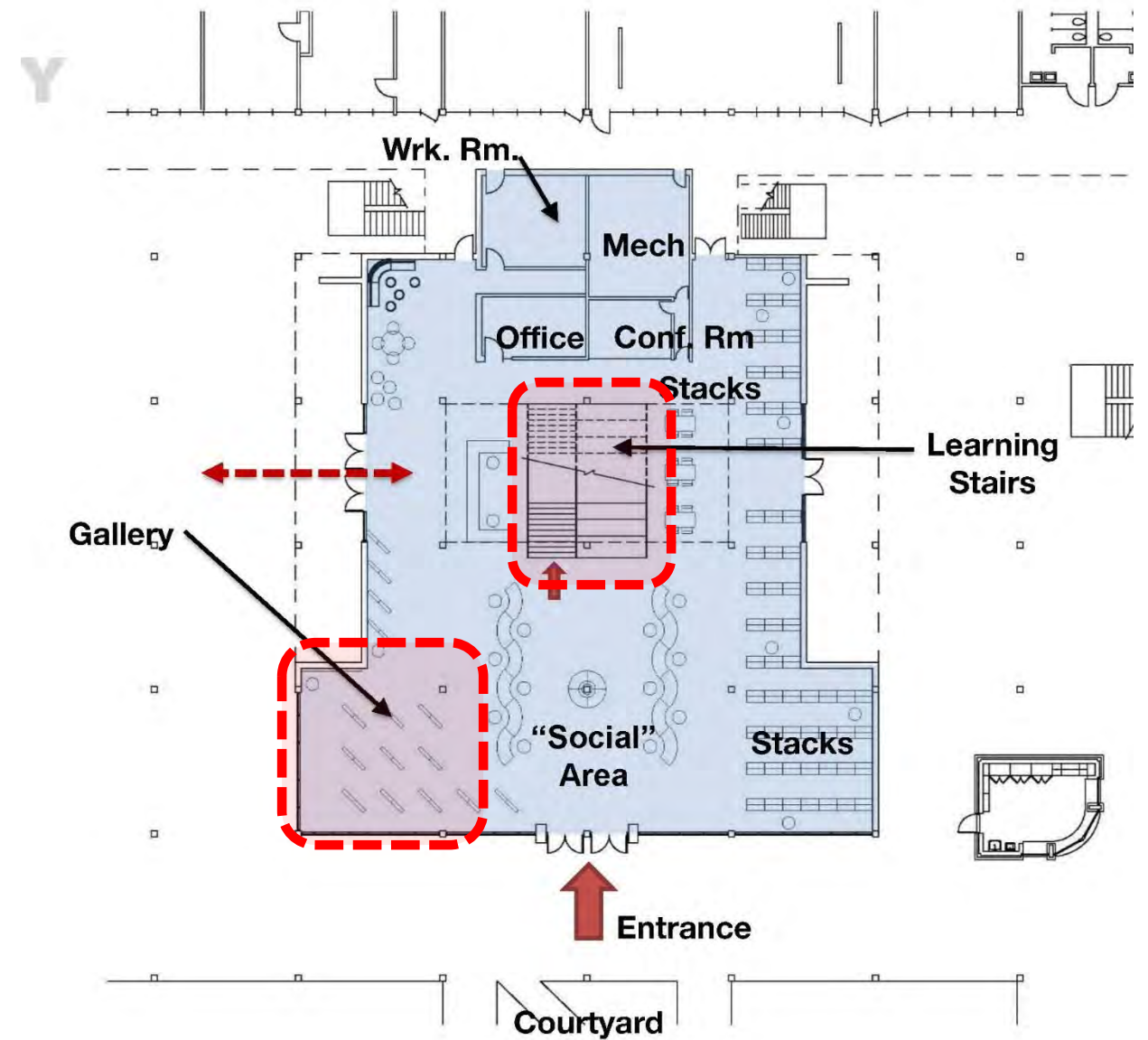

Opt B

Spring Woods High School Additions and Renovations

Learning Commons Options

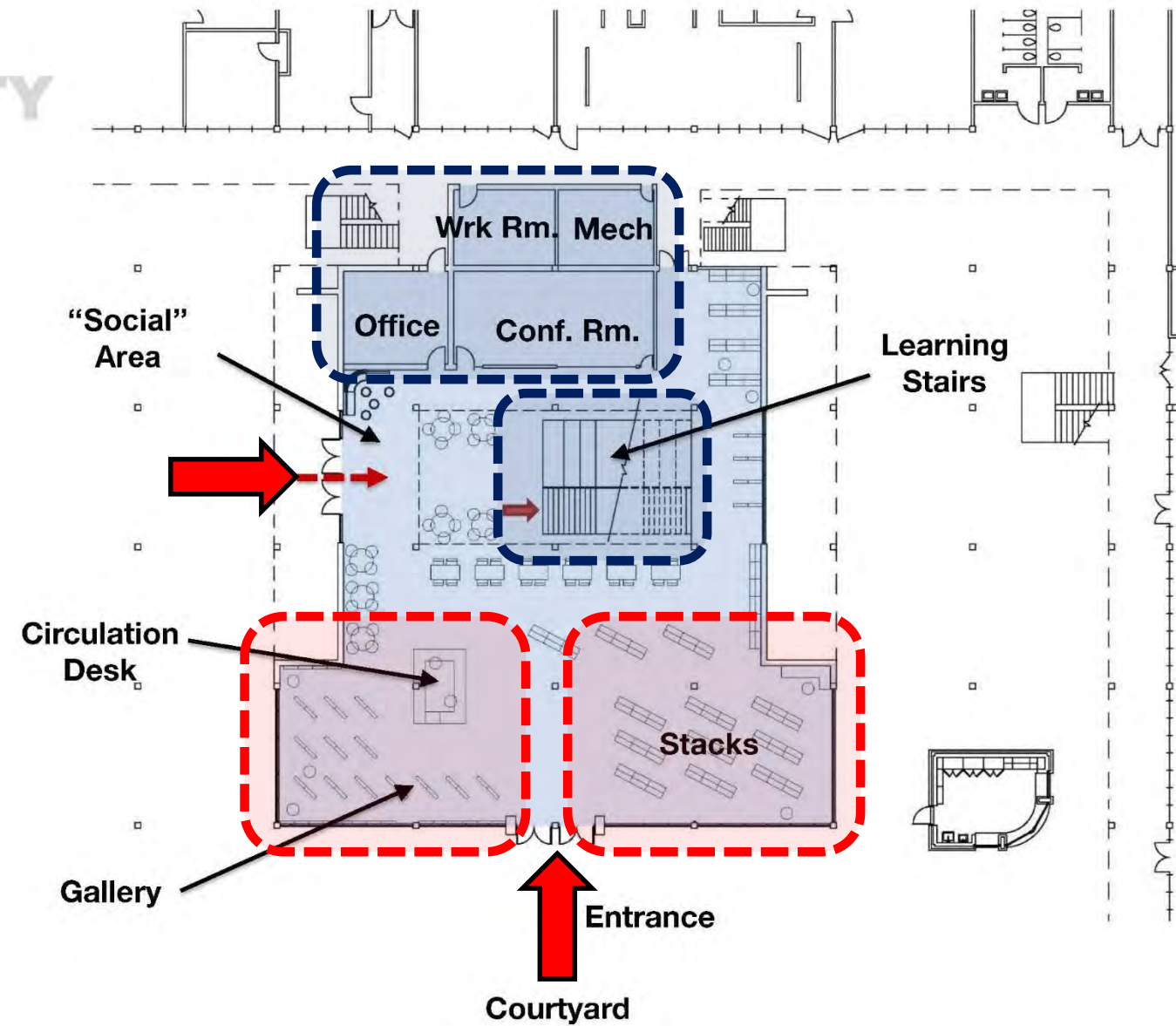

**Opt C
Level 01**

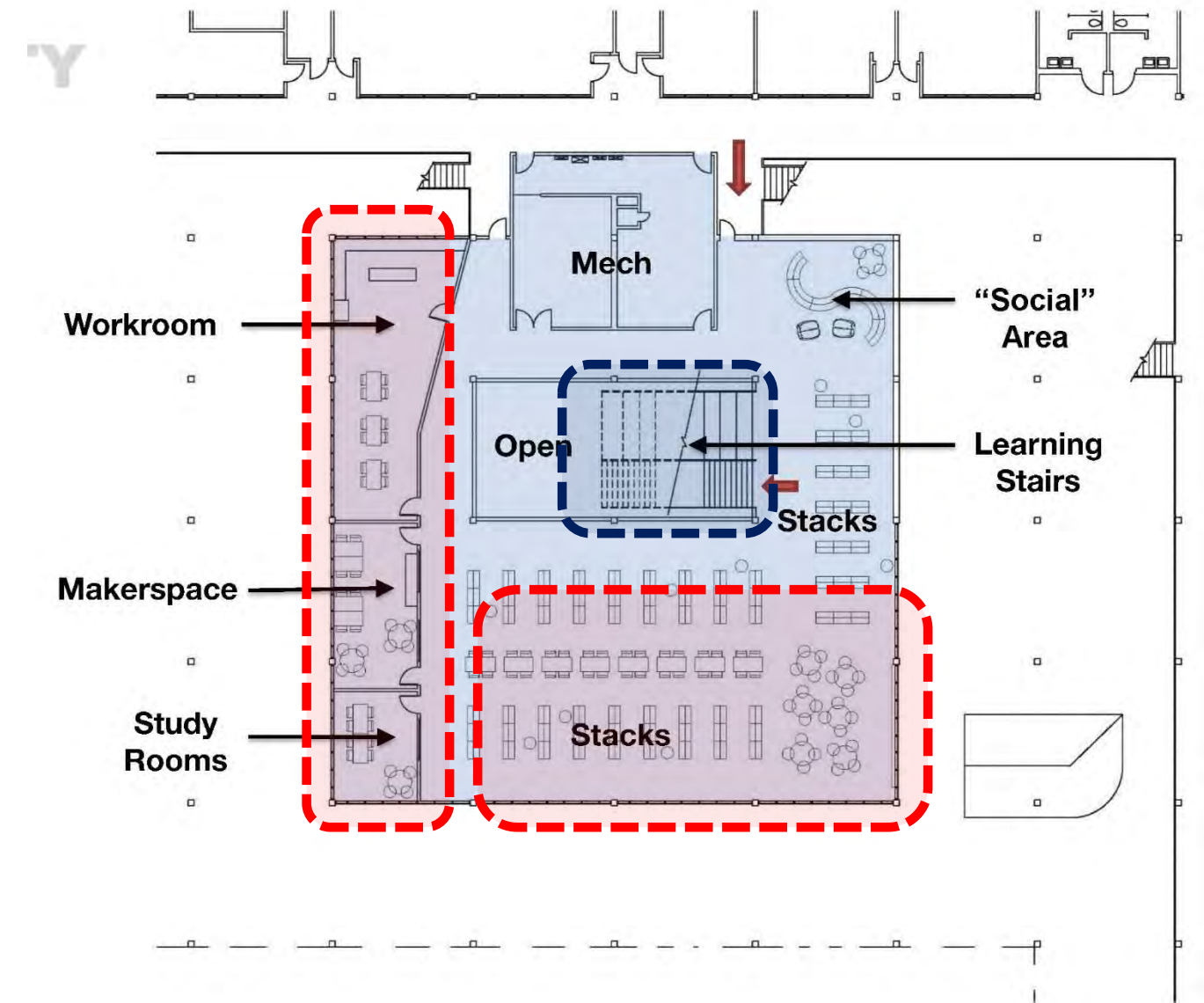

**Opt C
Level 02**

- Move all books to 1st Level
- Have circulation desk close to entrances
- No Makerspace
- “Computer room” 1st Level
- Flexible Classrooms 2nd Level
- Lack of supervision at 2nd Level
- Need Tech office 1st Level
- Workroom 1st Level
- Broadcast room 2nd Level
- Liked “Learning Stair”

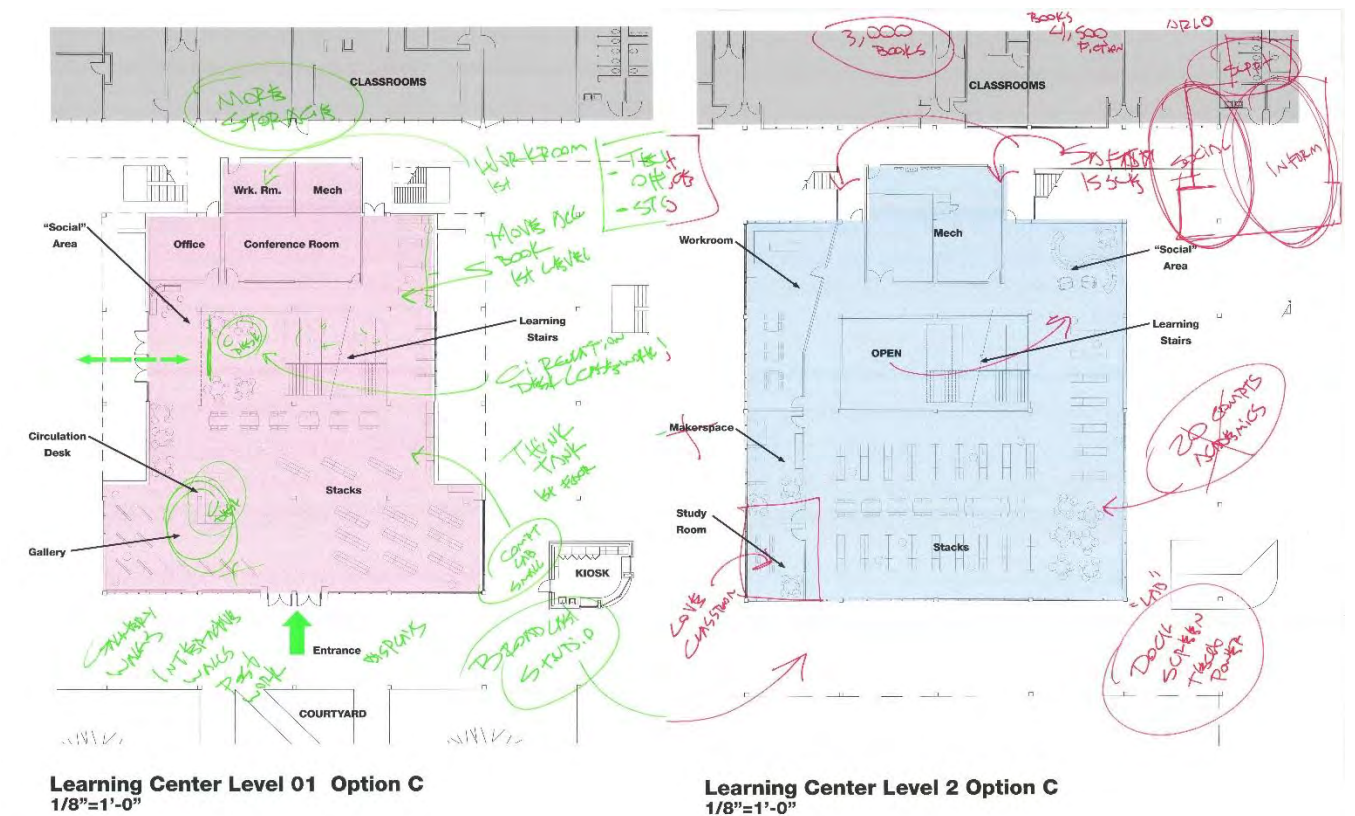

SPRING WOODS H
SPRING BRANCH INDEPE

- 2ND FLOOR DOORS LOCK TO LIMIT SECURITY & MONITORING OF SPACES BY 1 LIBRARIAN/ *SUPPORT SPACES
- 2ND FLOOR "ACADEMIC" 1ST FLOOR SOCIAL
- w/ 1:1 CHROMEBOOKS DECREASED COMP. WORKSTATIONS 20 USED FOR ACADEMIC
- EXISTING CLASSROOM ON LEVEL 2 BECOMES 2 FLEX. CLASSROOMS
↓
PARTITION WALL (OPERABLE)
- DESIGN TO PERSONALIZED LEARNING.

ARGED FLOOR PLAN **PRK**

Spring Woods High School Additions and Renovations

Learning Center 1st level Diagram layout

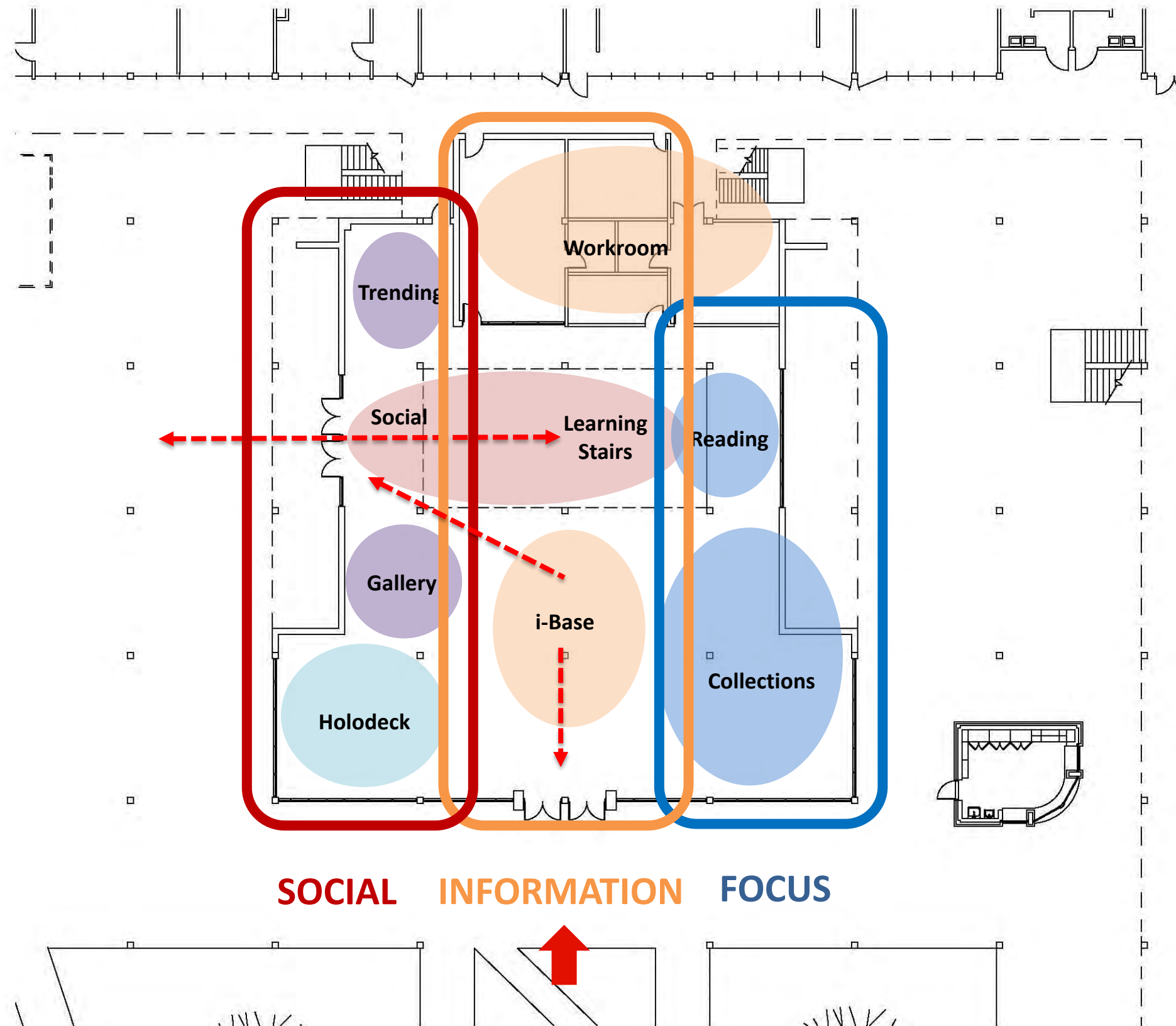

ACCESSIBILITY

QUEUING

DAYLIGHT

SEATING

OPTIONS

GATHERING

OPTIONS

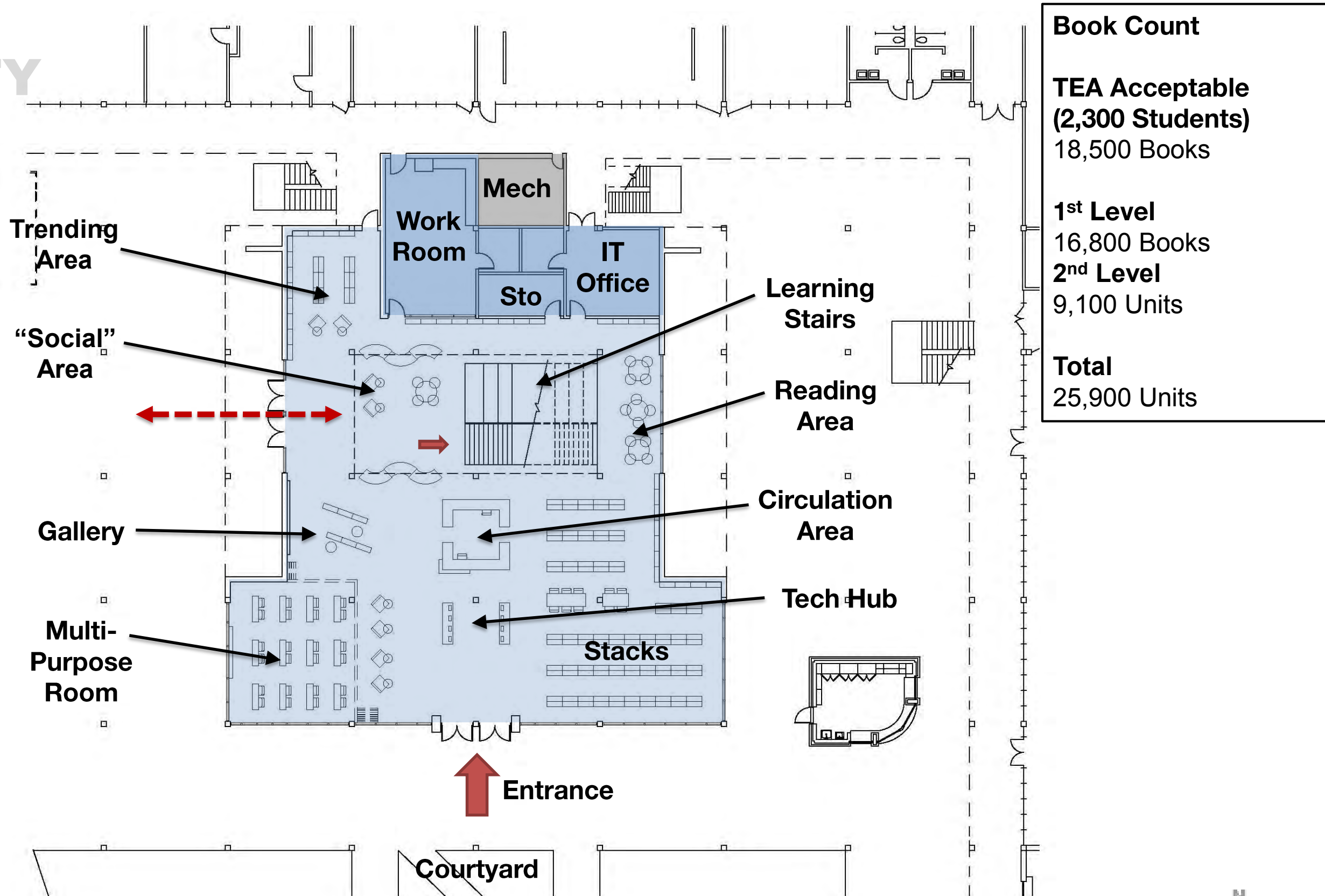

Spring Woods High School Additions and Renovations

Learning Center 2nd Level Diagram Layout

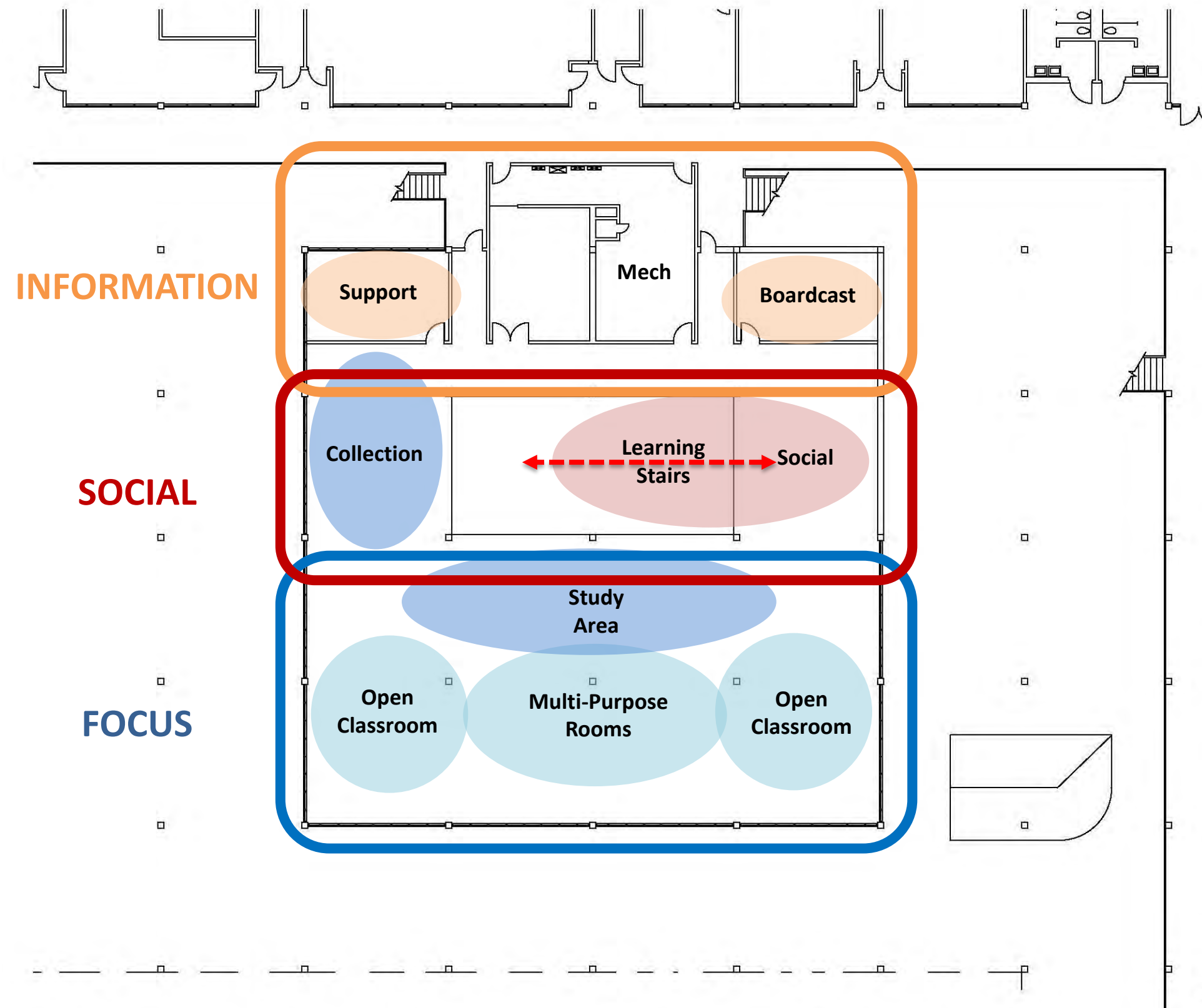

Spring Woods High School Additions and Renovations

Learning Center 2nd Level Option D (Summation of A, B, & C)

ACCESSIBILITY

QUEUEING

DAYLIGHT

SEATING

OPTIONS

GATHERING

OPTIONS

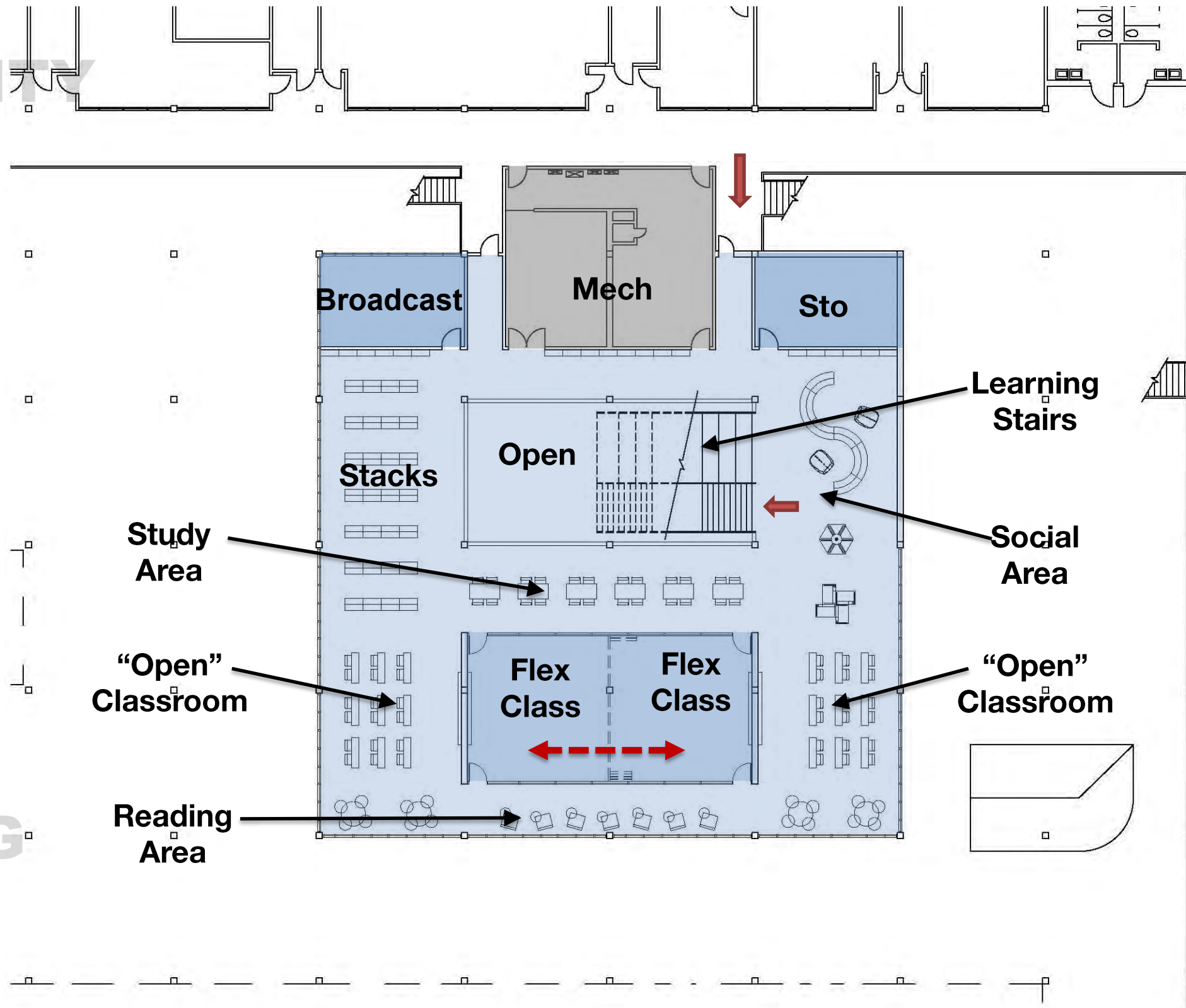

Book Count

TEA Acceptable
(2,300 Students)
18,500 Books

1st Level
16,800 Books
2nd Level
9,100 Units

Total
25,900 Units



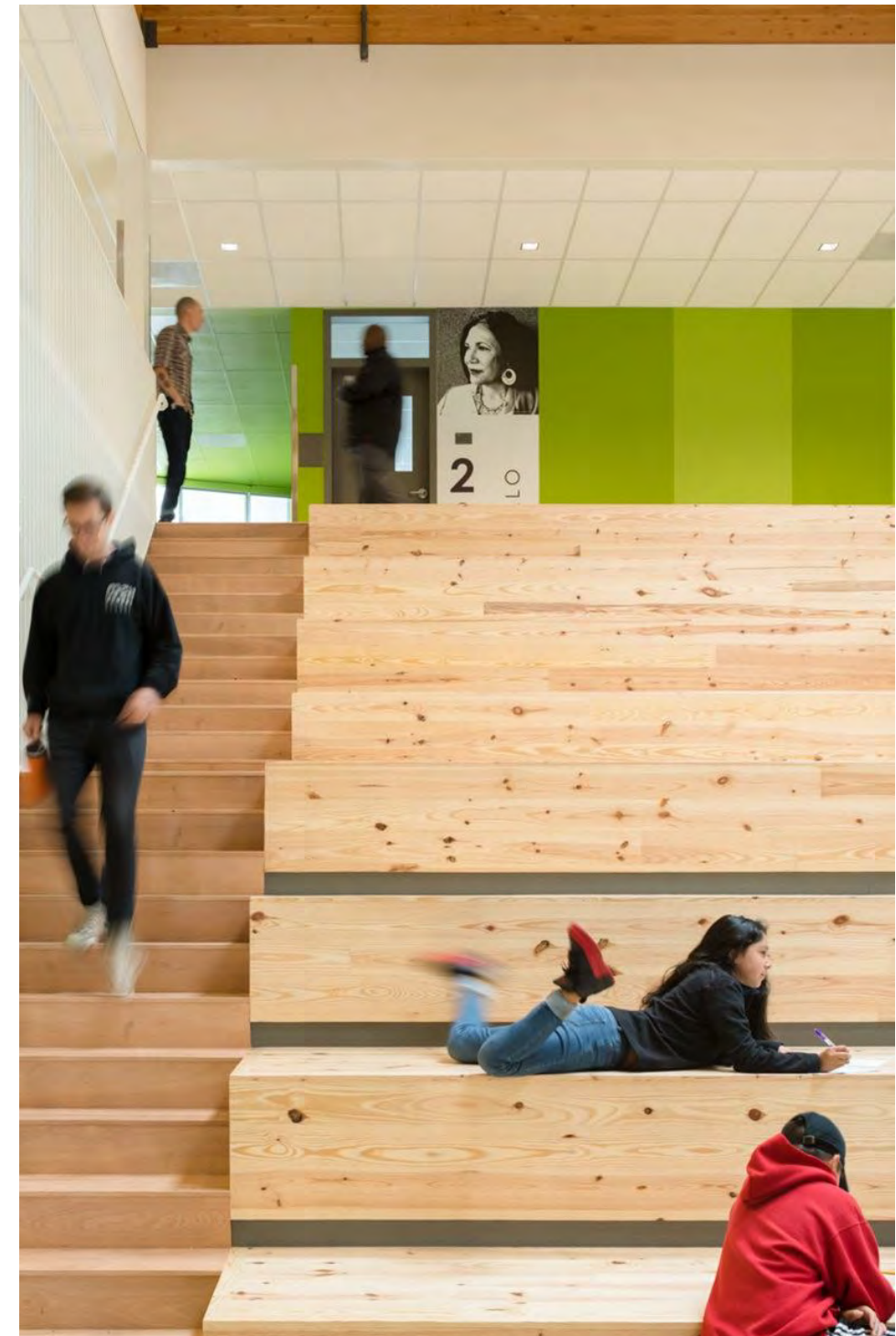



Plaza Layout Progress

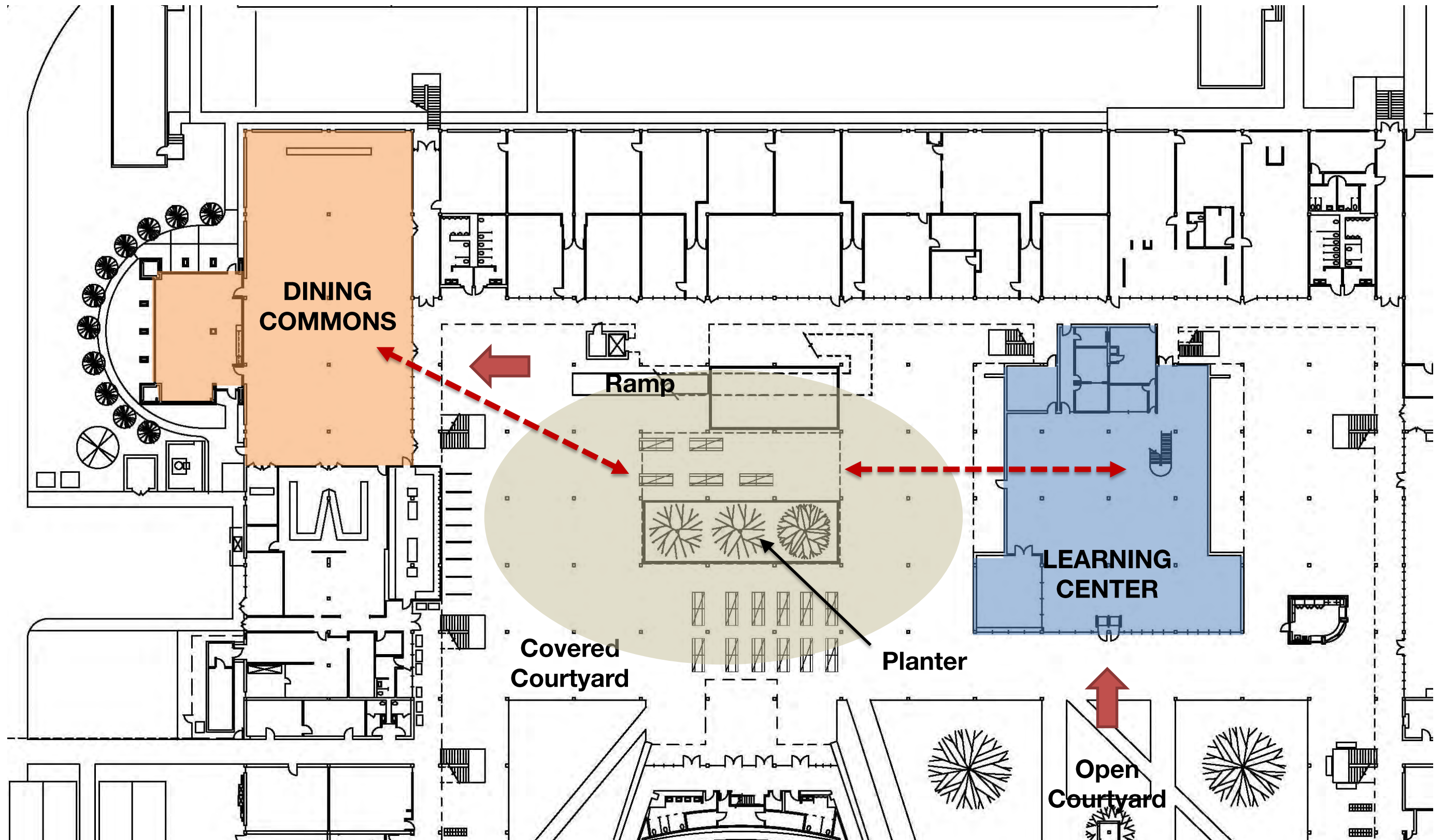





Spring Woods High School Additions and Renovations

Tiger Plaza Option A

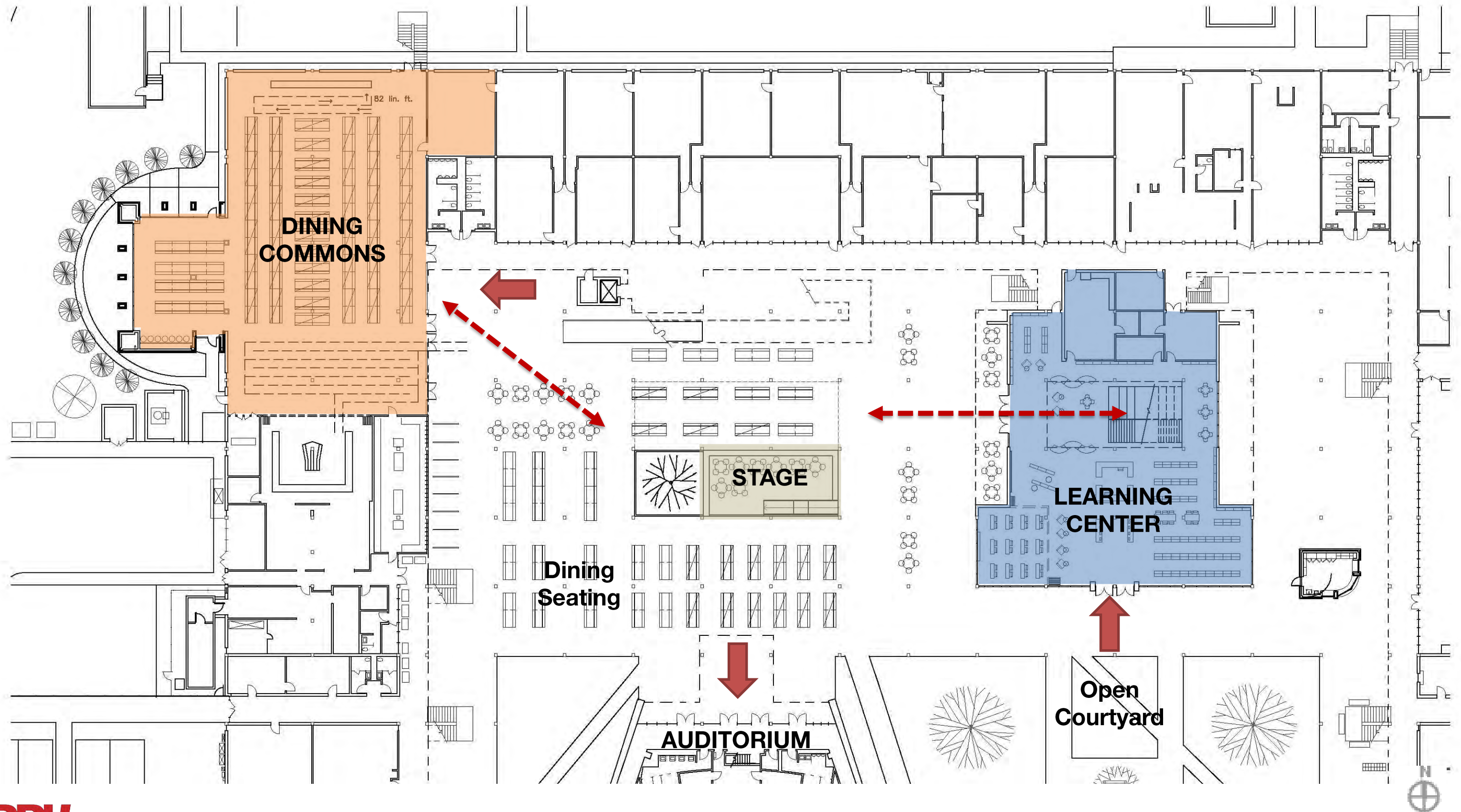

Spring Woods High School Additions and Renovations

Tiger Plaza Option B (Dining Seating Layout)

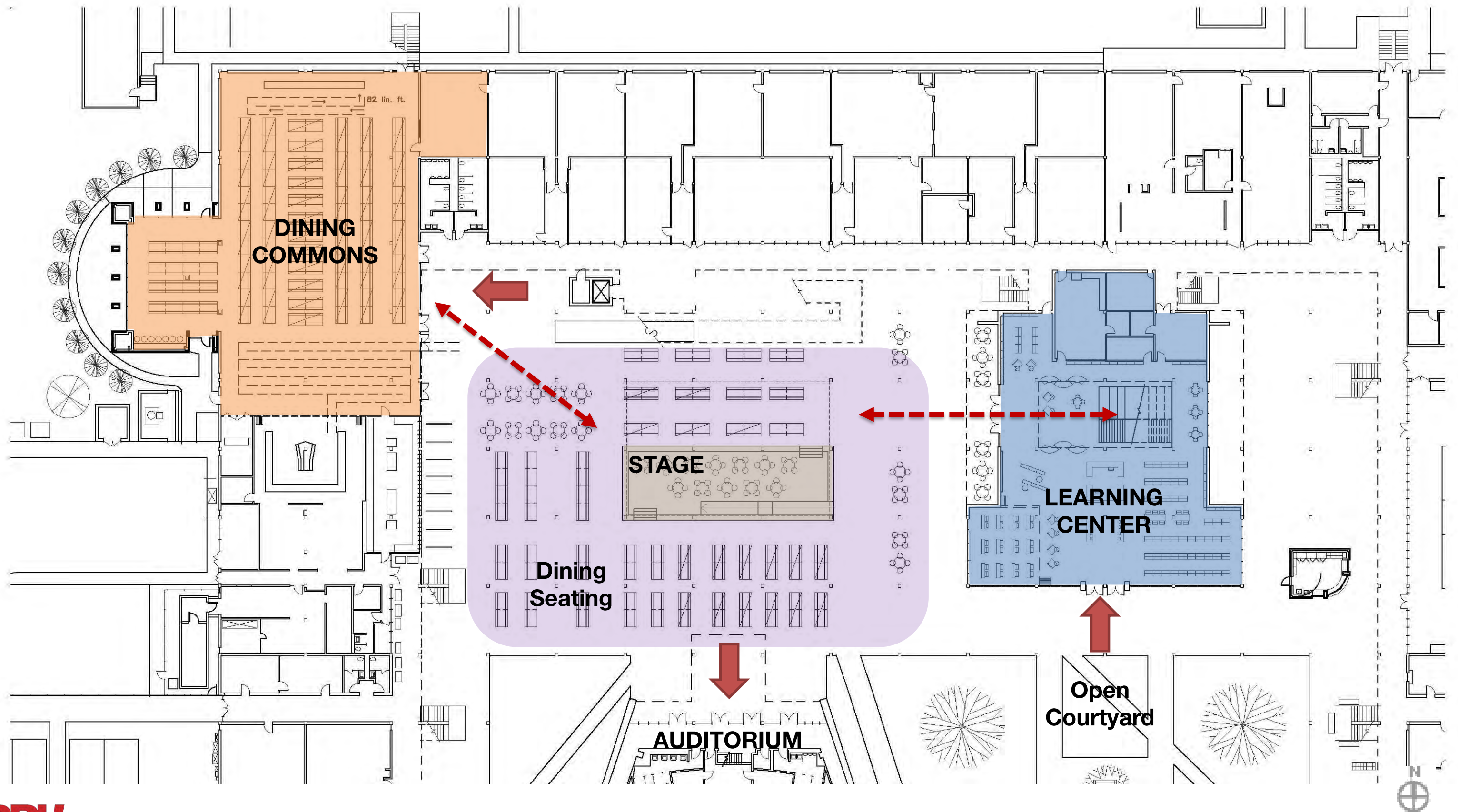

Spring Woods High School Additions and Renovations

Tiger Plaza Option B (Pep Rally layout)

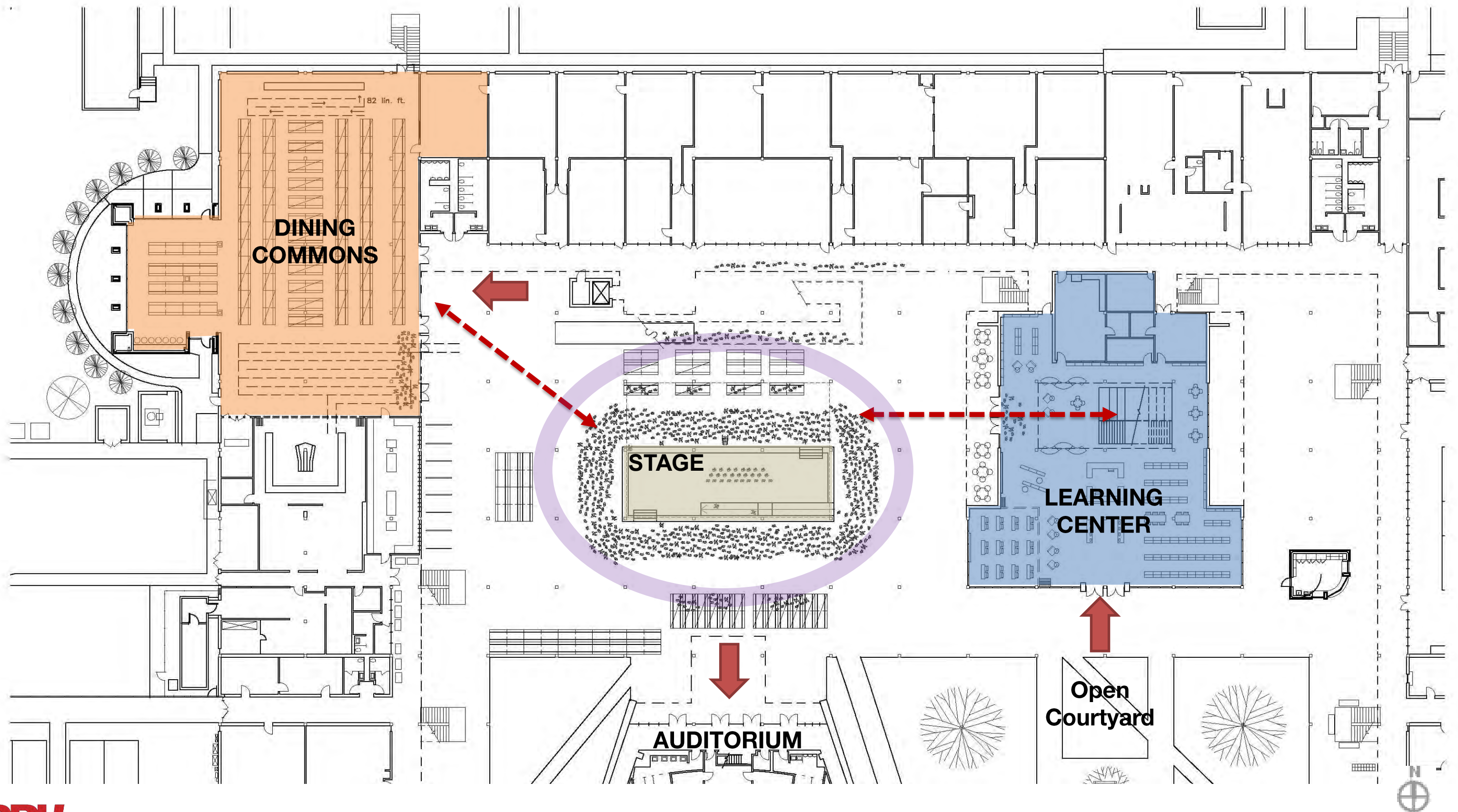

Spring Woods High School Additions and Renovations

Tiger Plaza Option B (Performance Layout)

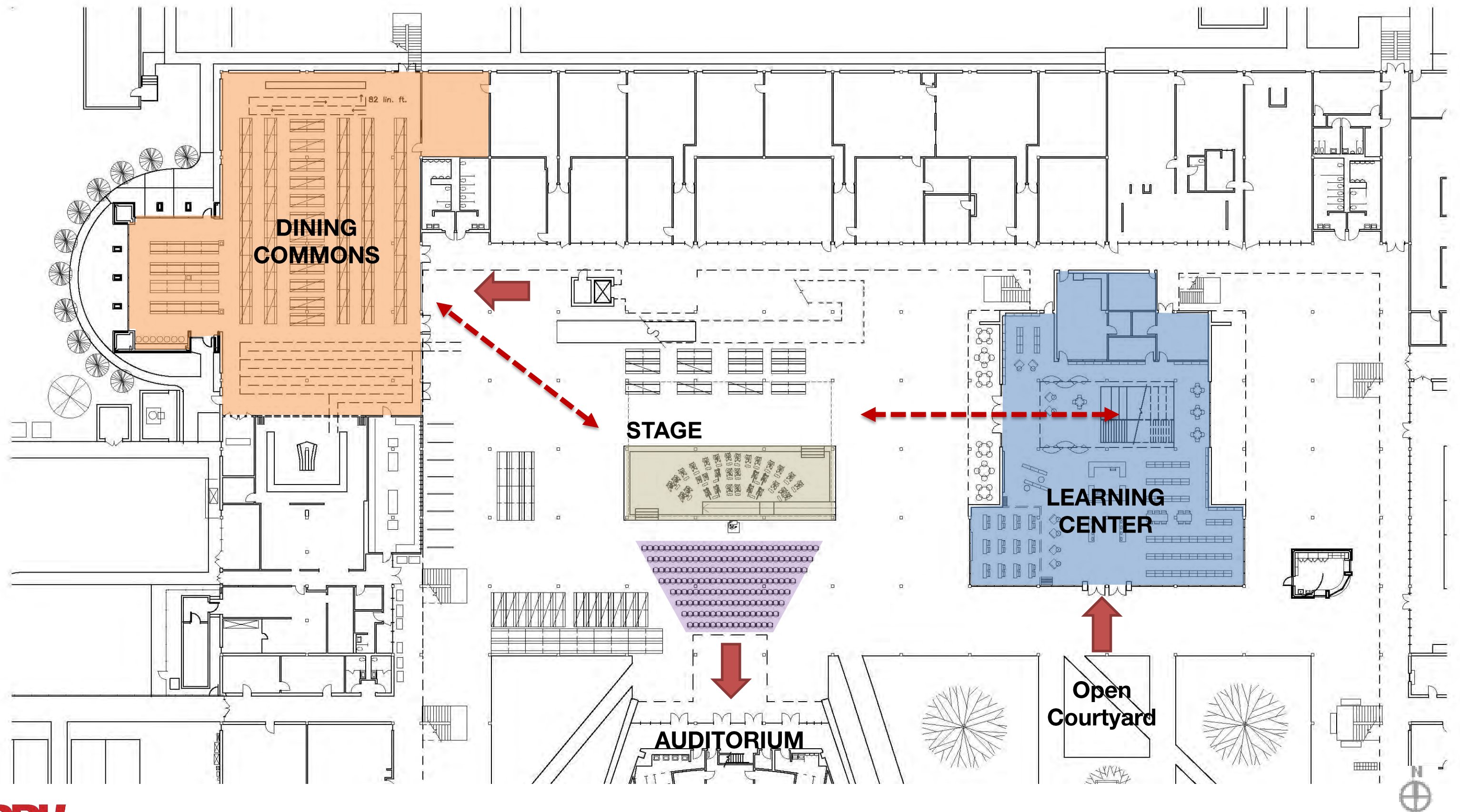

Next Steps

PAT 01

08-31-2018

KICK-OFF

- Gather Data
- Start Design

PAT 02

09-13-2018

Schematic Design

- Layout Options
- Library Services
- Nutrition Services

PAT 03

09-27-2018

Final Schematic Design

- Refine Layout
- Start Interior Concepts

PAT 04

10-04-2018

Design Development

- Refine Interior
- Review Budget
- Library Services
- Nutrition Services

PAT 05

10-25-2018

Final Design Develp.

- Finalize Overall Design
- Review Interior Finishes and colors

PAT 06

12-18-2018

Final Design Review

- Review Overall Design
- Review Budget
- Review Finishes



Thank you!

