

Citizen Response to a Violent Intruder

Alert **L**ockdown **I**nform **C**ounter **E**vacuate

*Are they prepared for when Today is not
like Yesterday?...*

Why is Citizen Preparation Necessary?

- 25 years of *mass shooting* events have yielded a national average for the response time of Law Enforcement to an Active Killer scene.
- How long:

Why is Citizen Preparation Necessary?

- 25 years of mass shooting events have yielded a national average for the arrival response time of Law Enforcement to an Active Killer scene.
- How long:

5-6 Minutes

Citizen preparation for danger is nothing new. Where do we first learn what to do when...

- There is a fire?
- There is a tornado?
- There is an active shooter/violent intruder?

Who and/or what is responsible for developing the information that is taught?

Is this really all you need to know in order to respond to a Violent Intruder?



We Have Three NATURAL Responses

- Fight: Counter Strategies
- Flight: Evacuate
- Freeze: Lockdown (Secure-in-Place)

Which is the preferred?

Which responses do you observe?



Columbine High School, April 20, 1999

- **Lessons Learned:** There were many, but the primary one has often been missed...

911: "Jefferson Country 911."

Patti Nielson: "Yes, I am a teacher at Columbine High School,
there is a student here with a gun,
he has shot out a window...
I believe... um ... I."

911: "Columbine High School."

Patti Nielson: "I don't know what's in my shoulder,
if it's just some glass or what."

911: "OK,
Has anyone been injured ma'am?"

Patti Nielson: "I am, yes ... yes!"

911: "OK."



Why did they STAY? Preferred Response?

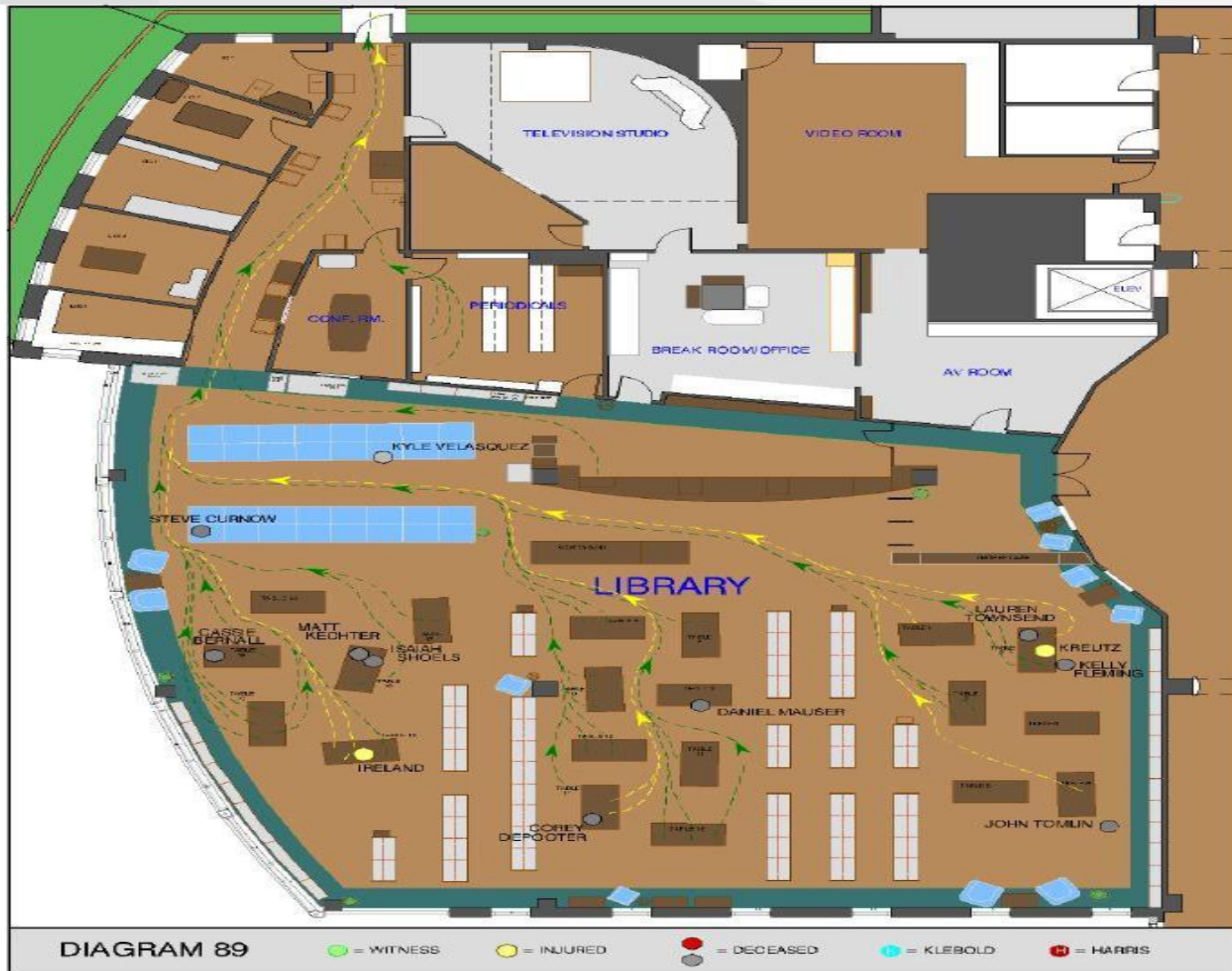

Why did they STAY?



The Lesson from Virginia Tech:

Room 210 No Class	<i>STAYED DOWN</i> Room 206 - 14 Present Killed – 10 Wounded -2	<i>JUMPED & BARRICADED</i> Room 204 - 19 Present Killed – 2 Wounded - 3	Room 200 No Class
Hallway – Killed 1			
Offices	<i>STAYED DOWN</i> Room 211 - 19 Present Killed – 12 Wounded - 6	<i>BARRICADED AFTER 1ST TIME</i> Room 207 - 13 Present Killed – 5 Wounded - 6	<i>BARRICADED</i> Room 205 - 12 Present Killed – 0 Wounded – 0

The Lesson from Virginia Tech:

28 vs. 2 (Fatalities)

Passive vs. Proactive

	Wounded - 6	Wounded - 6	Wounded - 0
--	-------------	-------------	-------------

A.L.I.C.E.

Common Sense, just not Common Knowledge

Alert
Lockdown
Inform
Counter
Evacuate

ALICE is **NOT** a linear, progressive response.

Alert

- Information is the key to good decisions
- Information should flow in all directions
- Provide as much initial intel as possible to as many people as possible
- Use any and all available means: Texts, PA, Digital Signage, Web, Twitter, Facebook, BELS, etc.
- May be your sensory inputs

ALERT needs to be of benefit to all...

Provide info, don't issue commands.

Change
this...

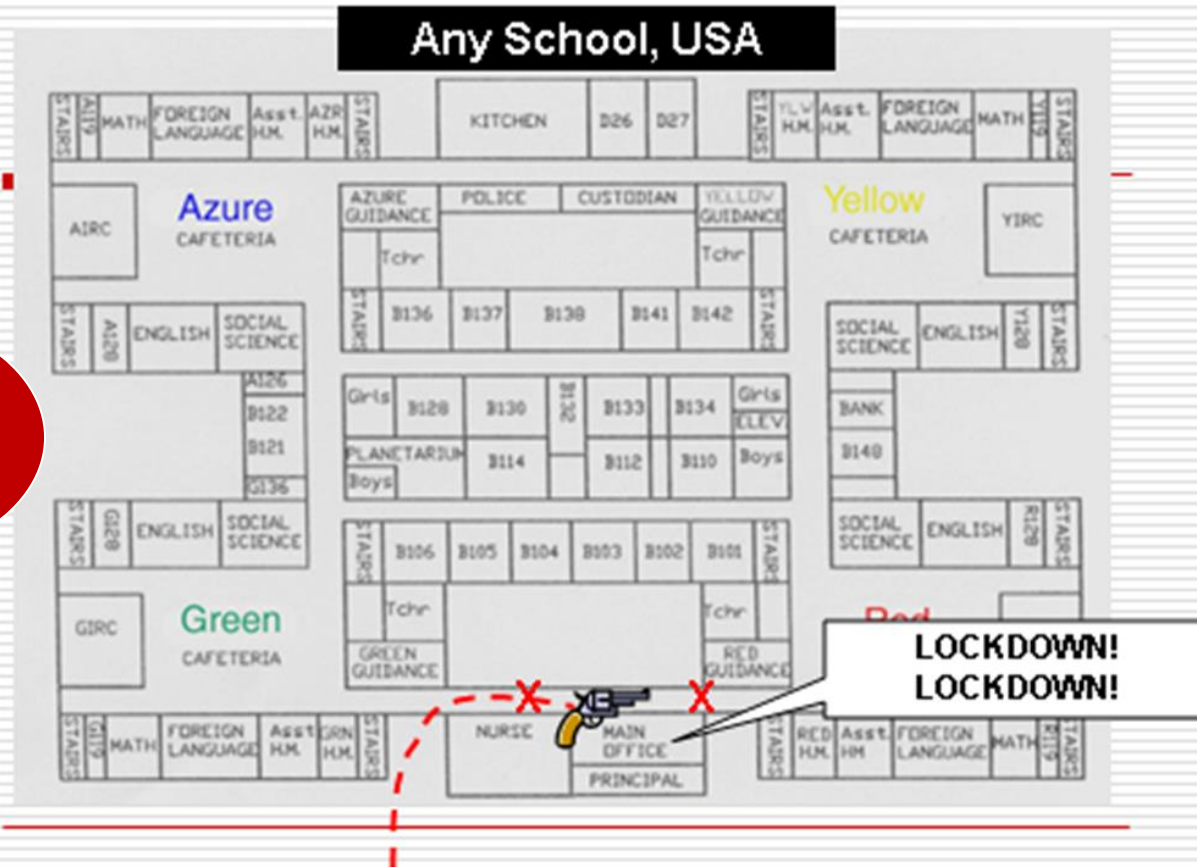

ALERT needs to be of benefit to all...

Provide info, don't issue commands.

To
THIS!

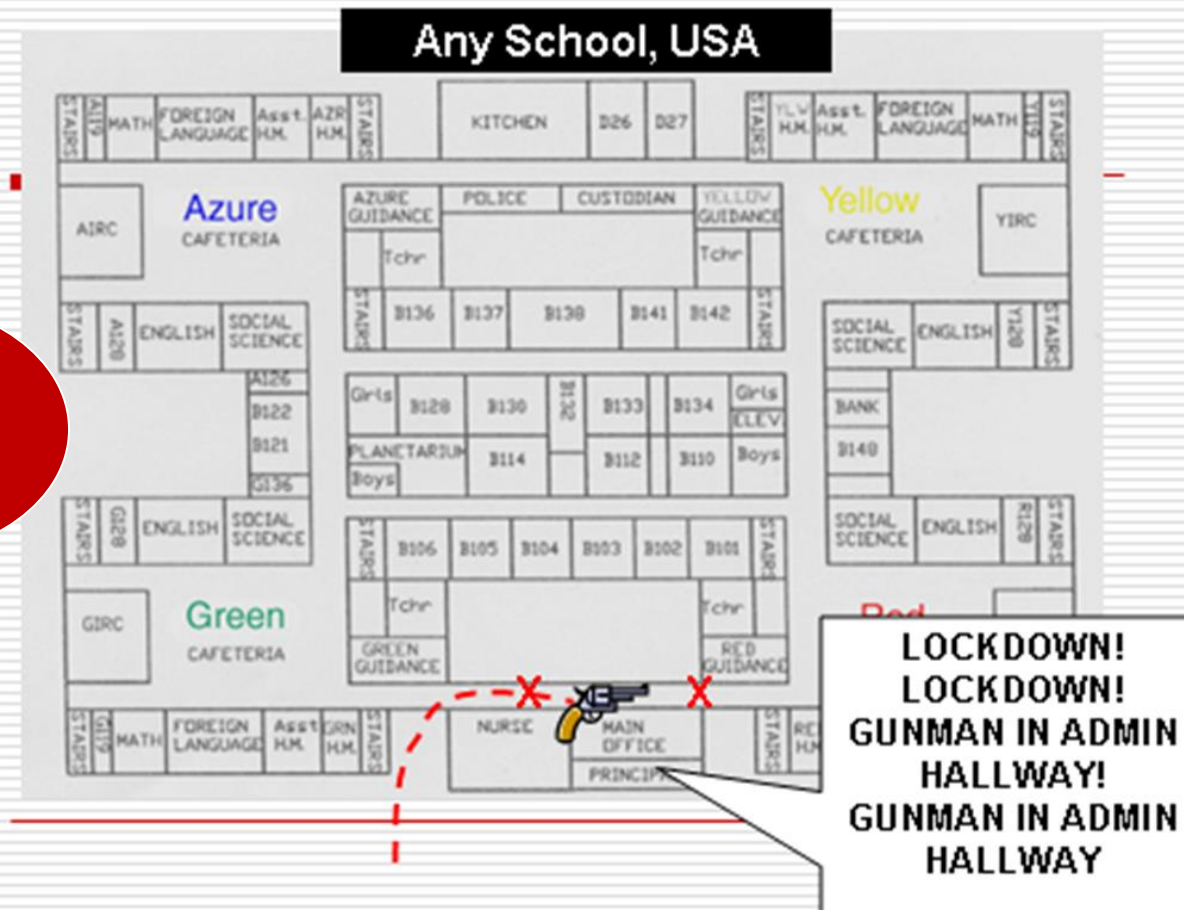

Lockdown

- Excellent starting point
- When should doors be locked?
- Before, During, or After?
- Locked doors provide a time barrier. Locks can, and have been defeated.
- ***BARRICADE:*** *The idea is to create a stronghold that nobody can breach... BE A HARDER TARGET!*
- Once Lockdown is in effect no one should be allowed into a secure room under any circumstances. Only open your locked door for uniformed police personnel.

Which is a more effective barricade for a door opening out?



Heavy Objects make good Obstacles



Inform

- As real-time information as possible will be provided by all means possible.
- Use this information to make single or collective decisions as to the best option for survival.
- Be flexible because the situation will be dynamic and fluid

Play-by-Play Announcer

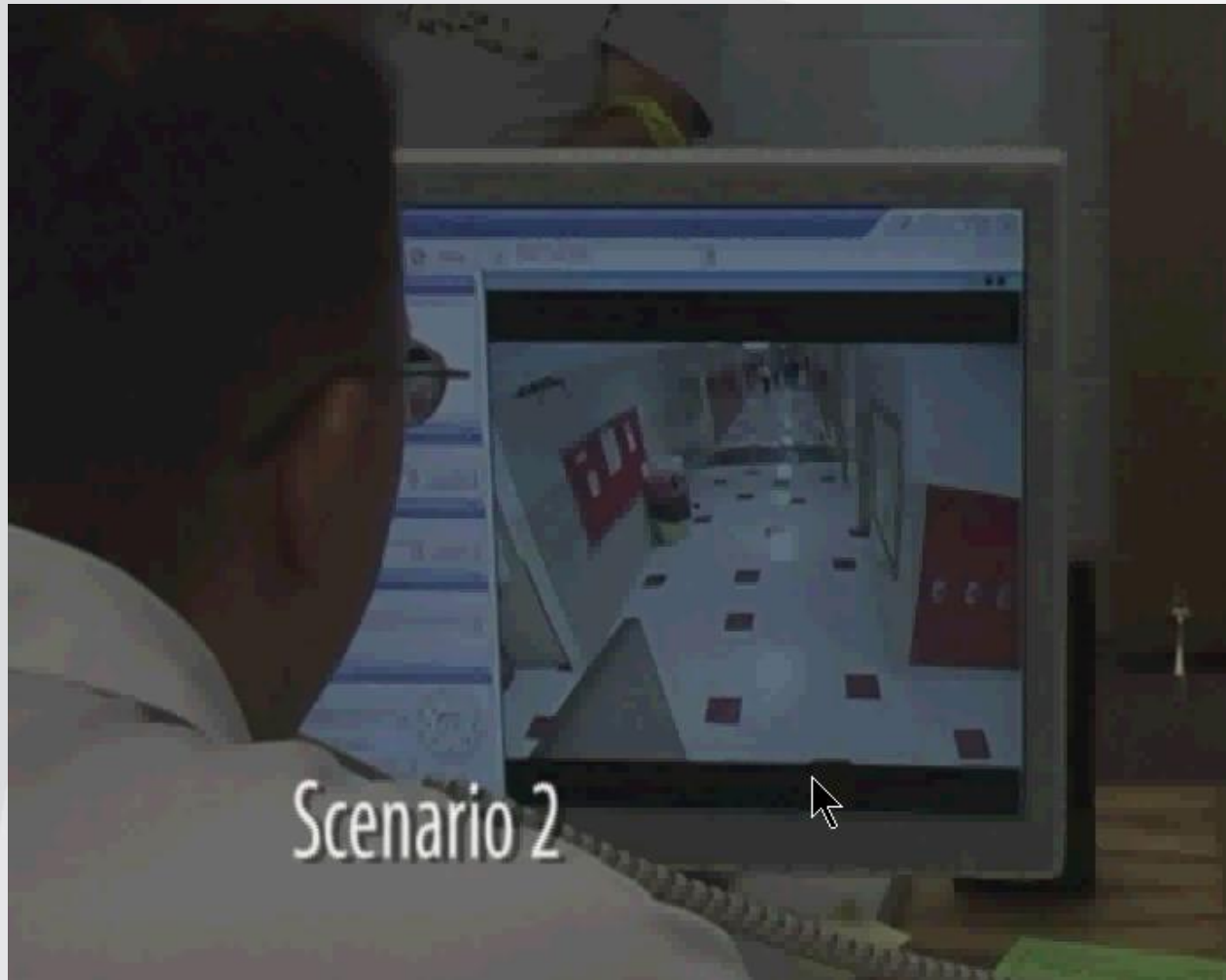

Counter

- Is it possible to interrupt the skill set needed to shoot accurately?

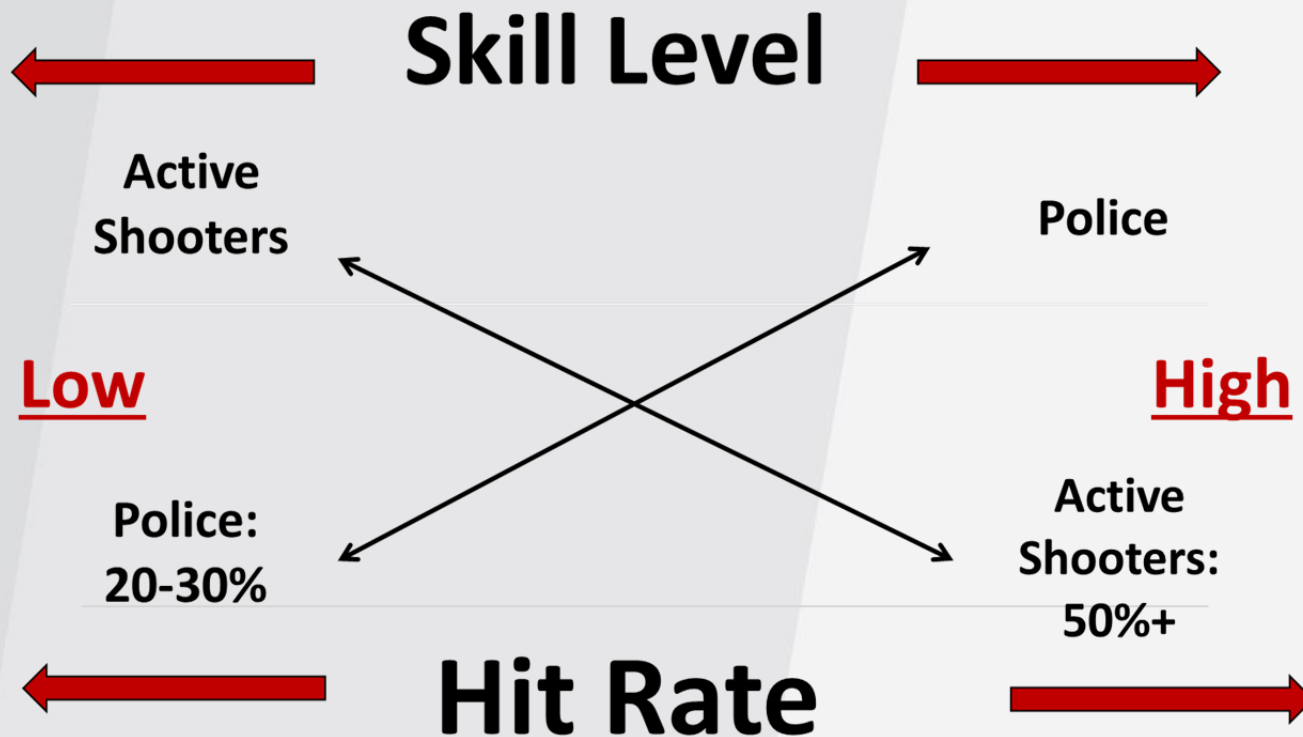

How Stimulus Can Effect Accuracy

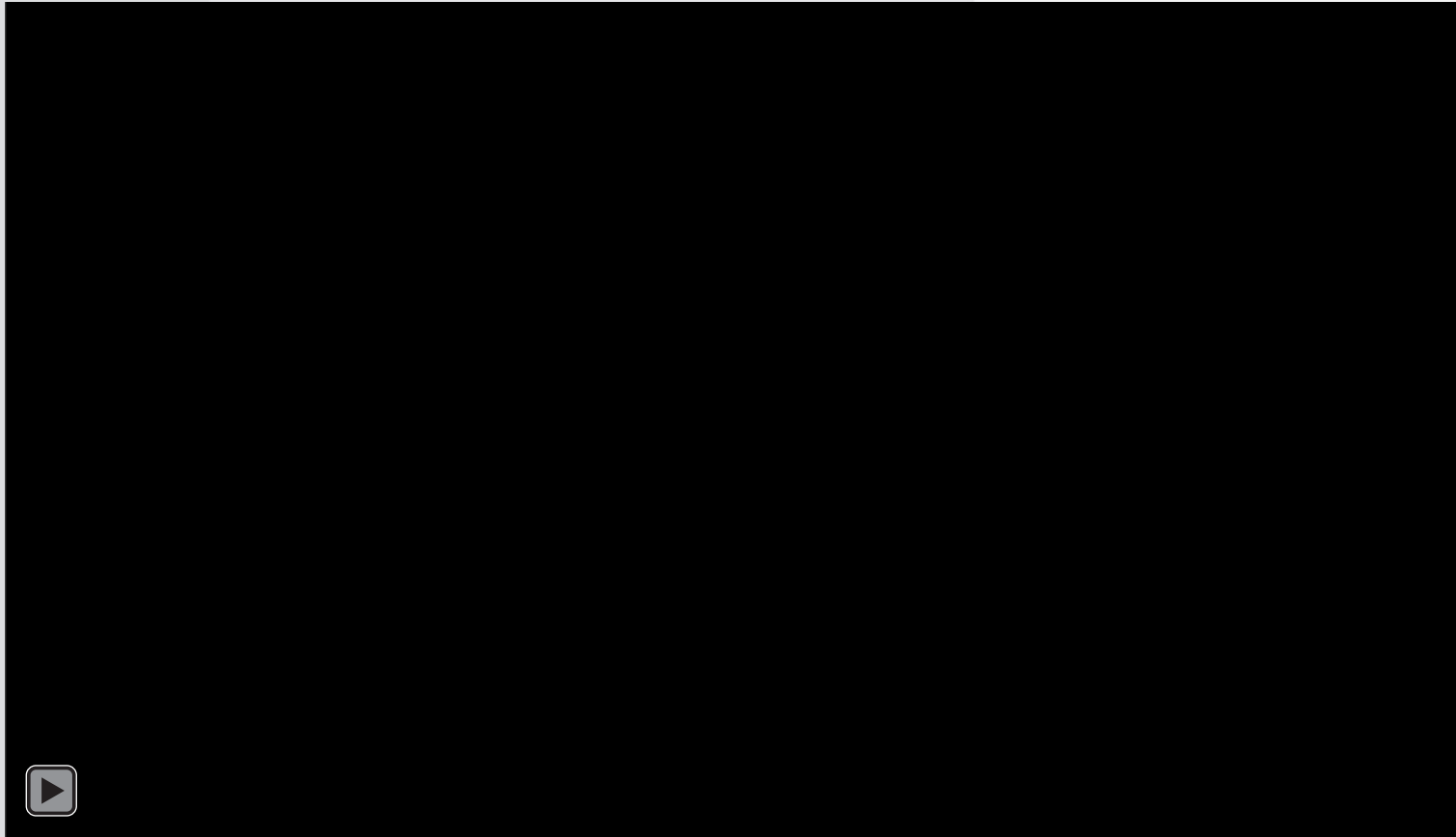

Counter

You can survive contact with an armed intruder!!

- Police miss **70-80%** of their shots in dynamic events.
- The “bad guy” is not usually a highly skilled shooter.
- Engage in acts that will require very high skill level:
 - Noise
 - Movement
 - Distance
 - Distractions

Survival Tactics:

Skills beyond lockdown that should be provided:

- Barricading, Cover and Concealment
- Evade/Escape
- SWARM
- Removing and Securing the Weapon
- Contact with Law Enforcement



Evacuate

- Only 2% of Violent Intruder events have been by more than one person.
- If he is inside, you get outside.
- Cannot use car to evacuate
- Reunification points established

Where do they go? How do they go?

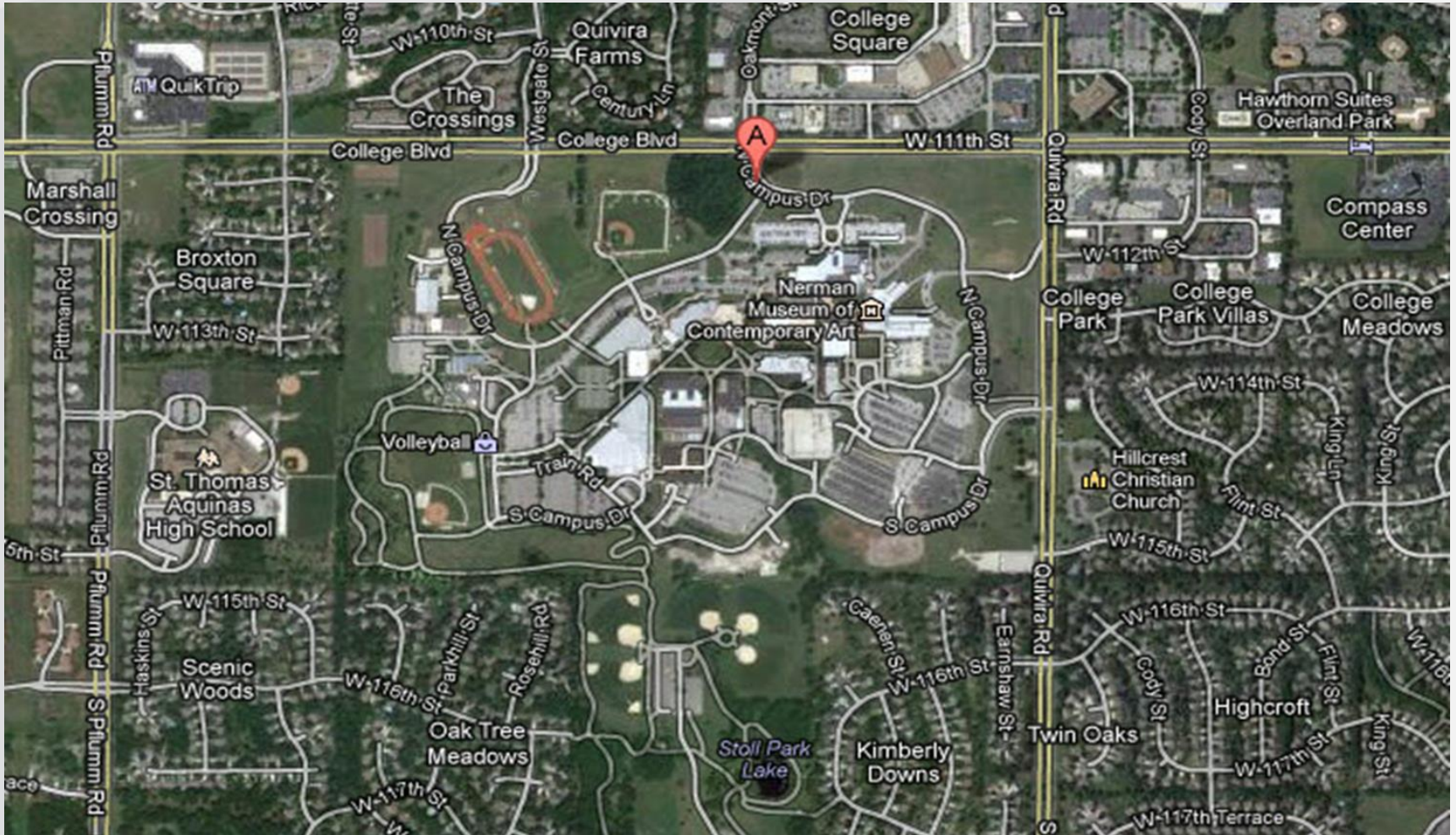

A.L.I.C.E.

**When faced with Danger,
You Must DO Something.**

"In a moment of decision, the best thing you can do is the right thing. The next best thing is the wrong thing. The worst thing you can do is nothing."

- Theodore Roosevelt

Why should “they” act?

Attack Resolution

The NYPD organized attack resolutions in the active shooter data set into four categories: applied force, no applied force, suicide or attempted suicide, and attacker fled.

Table 2 shows that the vast majority of attacks in the active shooter data set ended violently, either by force applied by law enforcement, private security, bystanders, or the attackers themselves. Only 14% ended without applied force, such as by a negotiated surrender.

Table 2: Number of Incidents by Incident Resolution

Resolution	Number of Incidents	Percentage
Applied Force Citizens and Police	93	46%
No Applied Force	28	14%
Suicide/Attempted Suicide Shooter	80	40%
Attacker Fled	1	<1%
Total	202	100%

Source: NYPD, Active Shooter, Recommendations and Analysis for Risk Mitigation. 2011

Why should “they” act?

Attack Resolution

The NYPD organized attack resolution into three categories: applied force, no applied force, and other.

Table 2 shows that the vast majority of attacks are resolved violently, either by force applied by the police or by the attackers themselves. Only 1% of attacks result in surrender.

If it is going to take an aggressive act to stop the killing, who do we hope is committing this act first?

Table 2: Number of Incidents by Incident Resolution

Resolution	Number of Incidents	Percentage
Applied Force Citizens and Police	93	46%
No Applied Force	28	14%
Suicide/Attempted Suicide Shooter	80	40%
Attacker Fled	1	<1%
Total	202	100%

Source: NYPD, Active Shooter, Recommendations and Analysis for Risk Mitigation. 2011

Observations

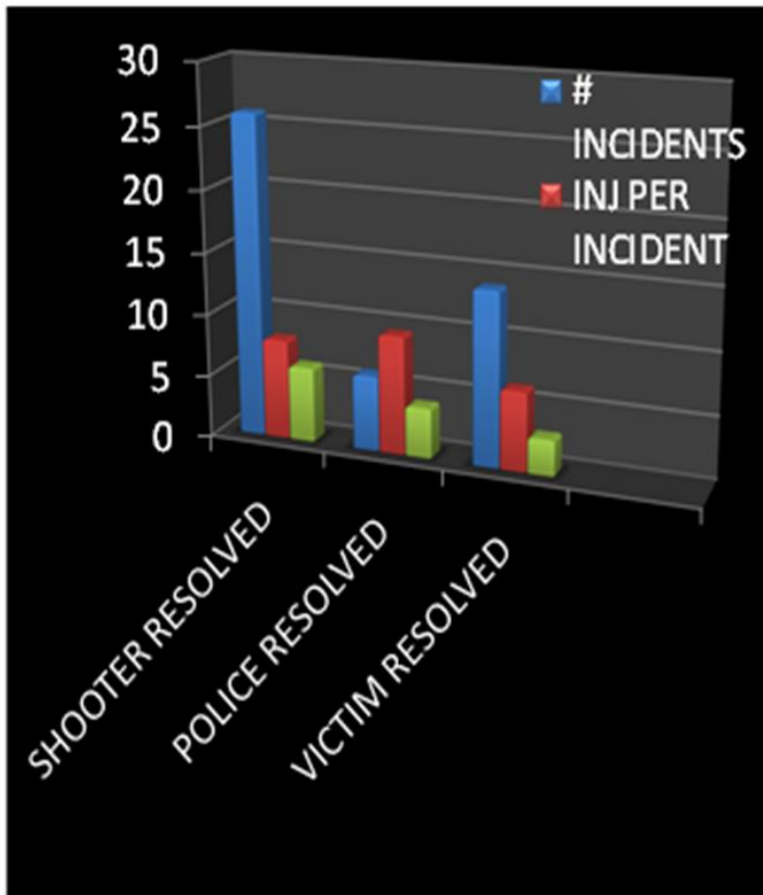

- Victims resolved **two and a half times** incidents than Police did

- Police-resolved incidents resulted in **25% more fatalities** than victim-resolved incidents

- Police-resolved incidents resulted in **30% more non-fatal casualties** than victim-resolved incidents

- Victim-resolved incidents resulted in a **almost three times fewer fatalities** than shooter-resolve incidents

- Police-resolved incidents resulted in **16% more casualties** than shooter-resolved incidents

Research courtesy of Bill Barchers, www.hardtactics.com

Casualties by Category Since 1966

Note: Graph includes Beslan casualties



Courtesy of Bill Barchers, www.hardtactics.com

Casualties by Category Since 1966

Note: Graph includes Beslan casualties

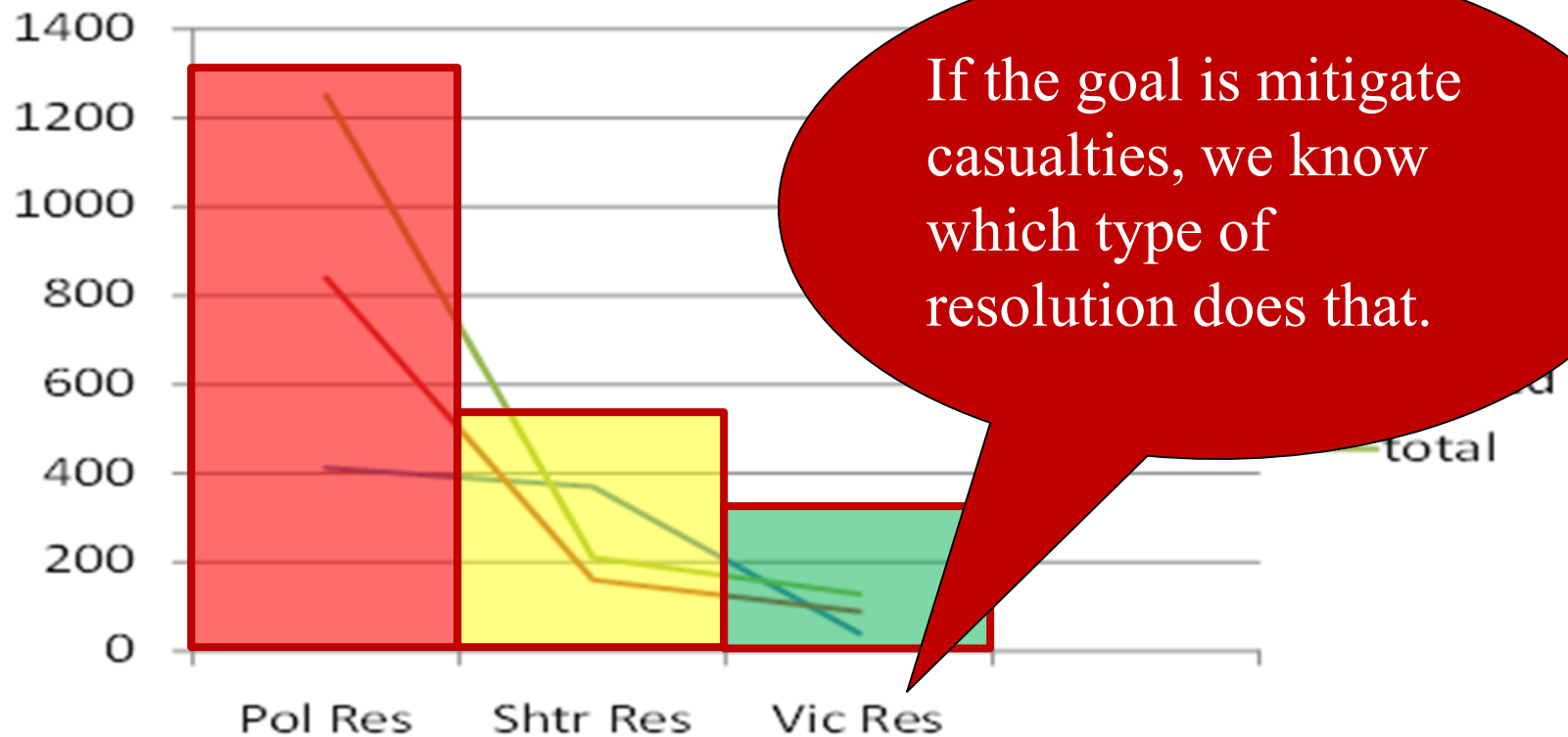

Courtesy of Bill Barchers, www.hardtactics.com

There is now a movement towards Proactive Response at official levels:



ACTIVE SHOOTER HOW TO RESPOND



October 2008

DHS Recommendations

- October 2008
- Known as the 3-Outs Program
 - Get Out
 - Hide Out
 - Take Out

ALICE
TRAINING INSTITUTE

IACP Recommendations

- October 2009
- Do not have a one-size fits all plan.
- Teachers choose to Evacuate or Lockdown
- Authorize decisions to be made
- Active Resistance is an option

The book cover features a green-tinted photograph of a school hallway. In the foreground, a stack of books is topped with a single apple. In the background, a 'SCHOOL' sign is visible, and a silhouette of an adult holding a child's hand is walking away. The title 'Guide for Preventing and Responding to School Violence' is printed in white, with '2nd Edition' in smaller text to the right.

Guide for Preventing and
Responding to School Violence 2nd Edition





New York City Police Department

Active Shooter

*Recommendations and Analysis
for Risk Mitigation
2012 Edition*

Raymond W. Kelly
Police Commissioner



NYPD Recommendations Jan 2012, 2013

Training:

- Train building occupants on response options outlined by the Department of Homeland Security in “Active Shooter: How to Respond” when an active shooter is in the vicinity:⁴
 - **Evacuate:** Building occupants should evacuate the facility if safe to do so; evacuees should leave behind their belongings, visualize their entire escape route before beginning to move, and avoid using elevators or escalators.
 - **Hide:** If evacuating the facility is not possible, building occupants should hide in a secure area (preferably a designated shelter location), lock the door, blockade the door with heavy furniture, cover all windows, turn off all lights, silence any electronic devices, lie on the floor, and remain silent.
 - **Take Action:** If neither evacuating the facility nor seeking shelter is possible, building occupants should attempt to disrupt and/or incapacitate the active shooter by throwing objects, using aggressive force, and yelling.



The State of Alabama Active Shooter Response

Strategic Plan

February 2013



AL Gov't and Homeland Security

- February 2013
- Specifically names ALICE and Run, Hide, Fight as official State recommendations for AS response plans.

ALICE
TRAINING INSTITUTE

School Safety Task Force

Recommendations and Resources



Local Partnerships are Vital in Managing School-based Critical Incidents

June 2013

 **MIKE DEWINE**
— OHIO ATTORNEY GENERAL —

Ohio Attorney General and Safety Task Force Recommendations

- June 2013
- Lockdown does not mean stand-alone defensive strategy of Securing in Place
- Evacuate, Barricading, Counter
- For Staff and Students

ALICE
TRAINING INSTITUTE

US Dept. of Ed REMS Recommendations

- June 2013
- Has to be the end of LOCKDOWN only as the response plan for schools.

**Are your plans in
agreement with these
recommendations,
or contrary?**

ALICE has led this movement since 2001.

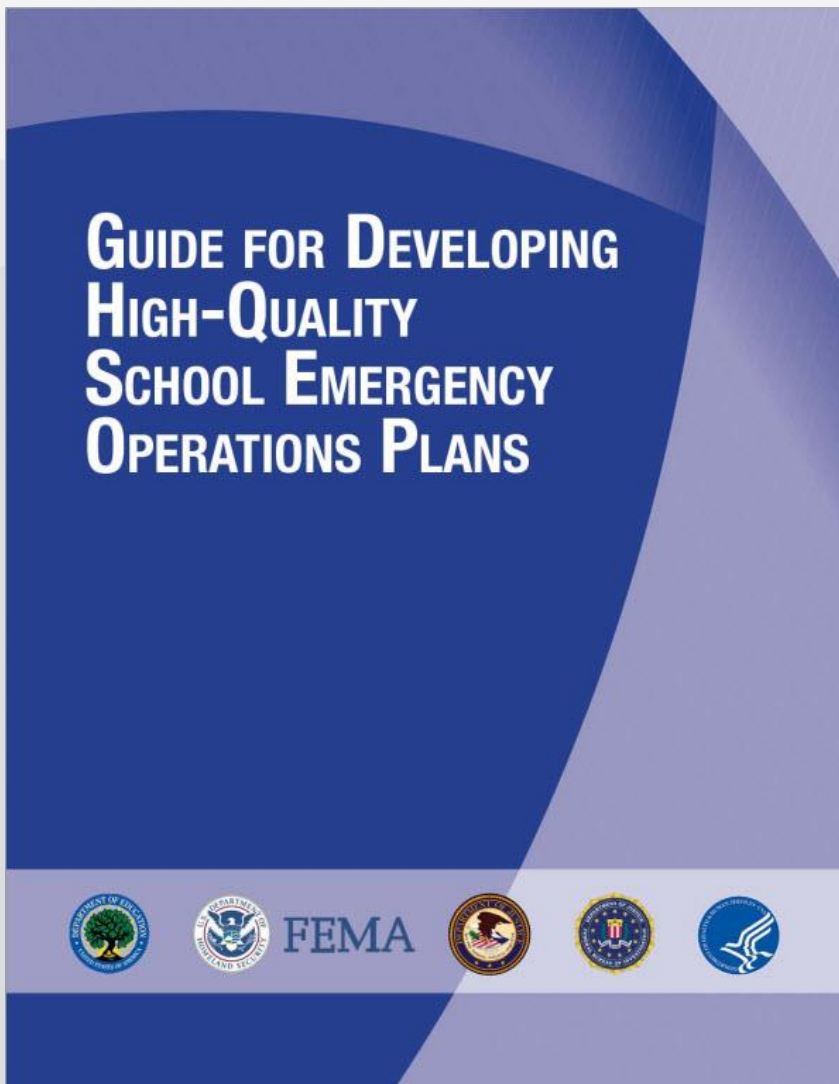

Citizens are Capable

Perry Hall Teacher Called "Heroic" for Stopping Shooter - WBFF 45

www.foxbaltimore.com/newsroom/top.../wbff_vid_14989.shtml

Aug 27, 2012 – Jesse Wasmer, the guidance counselor at Perry Hall High, rushed the ... Daniel, Victim of Perry Hall High School Shooting, Heading Home ...

Hero Teacher Reportedly Tackles Shooter at Normal, Illinois High ...

www.theblaze.com/.../hero-teacher-reportedly-tackles-gunman-at-illi...

3 days ago – NORMAL, Ill. (TheBlaze/AP) -- An otherwise normal morning turned into a nightmare scenario in Normal, Ill., Friday as a gunman opened fire at ...

Citizens are Capable

**Are we cultivating
these outcomes...
or just hoping for
them?**

[Perry Hall Teacher](#)

www.foxbaltimore.com

Aug 27, 2012 – Je
the ... Daniel, Vict

[ter - WBFF 45](#)

all High, rushed
Home ...

[Hero Teacher](#)

www.theblaze.com

3 days ago – NO
nightmare scenario

[is High ...](#)

ing turned into a
..

Usual Opponent Concerns:

- **There could be more than one shooter.**
- **They could run into the shooter.**
- **How will we account for those who left?**
- **Who will be liable?**
- **Small children aren't capable.**
- **Special Ed is not addressed.**
- **Rally Point could be a secondary attack location.**
- **Evacuating folks will get in the way of police.**
- **How will police distinguish friendlies from shooter if they get the gun away?**
- **Counter Strategies are ridiculous**

Questions?

Thank you and Stay Safe!

**Need more information or
host requests:**

330-661-0106

www.ALiCEtraining.com