

ACCESSIBLE RAMP LANDSCAPE 01
SCALE: 1" = 20'

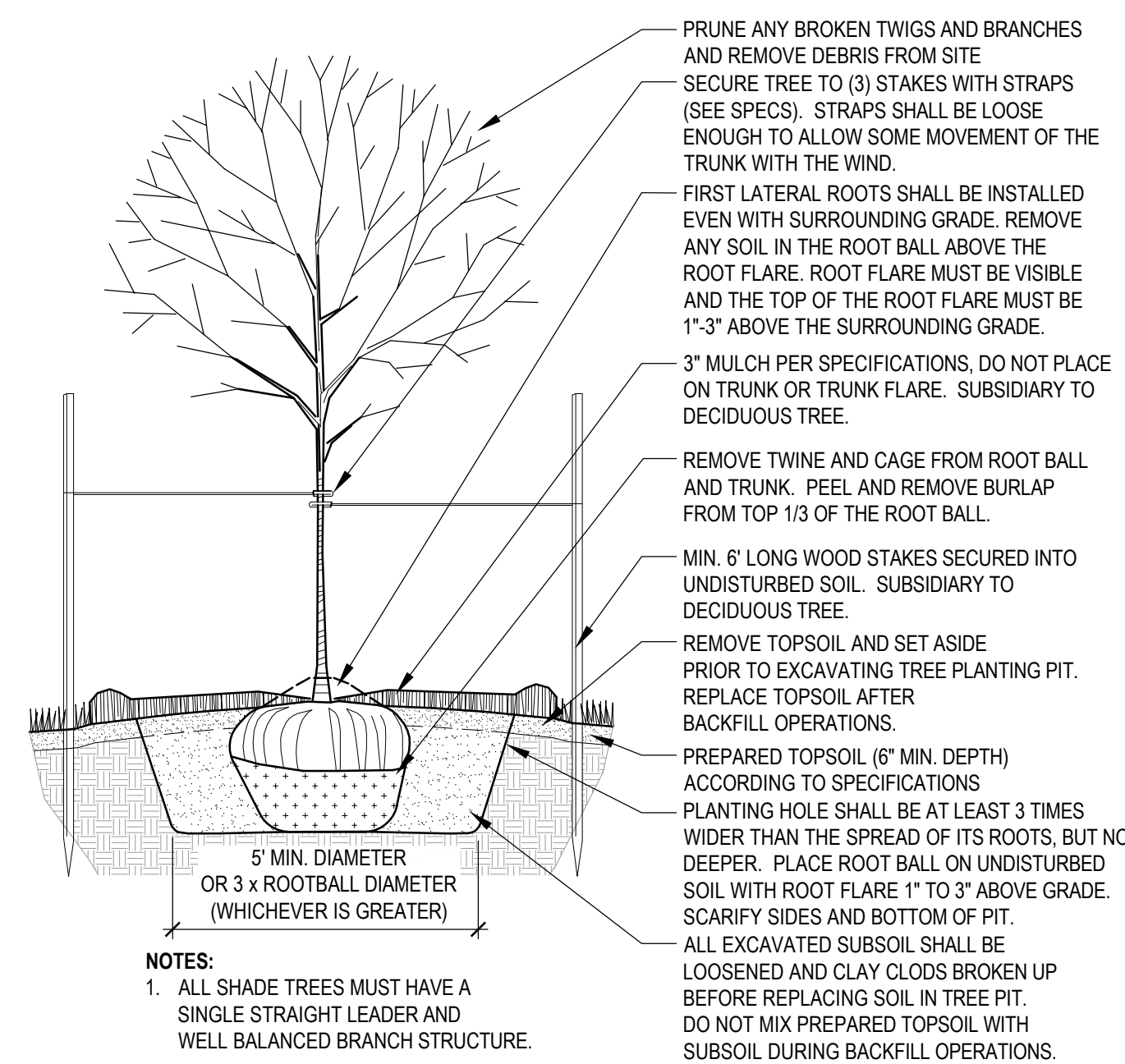

DECIDUOUS TREE 03
N.T.S.

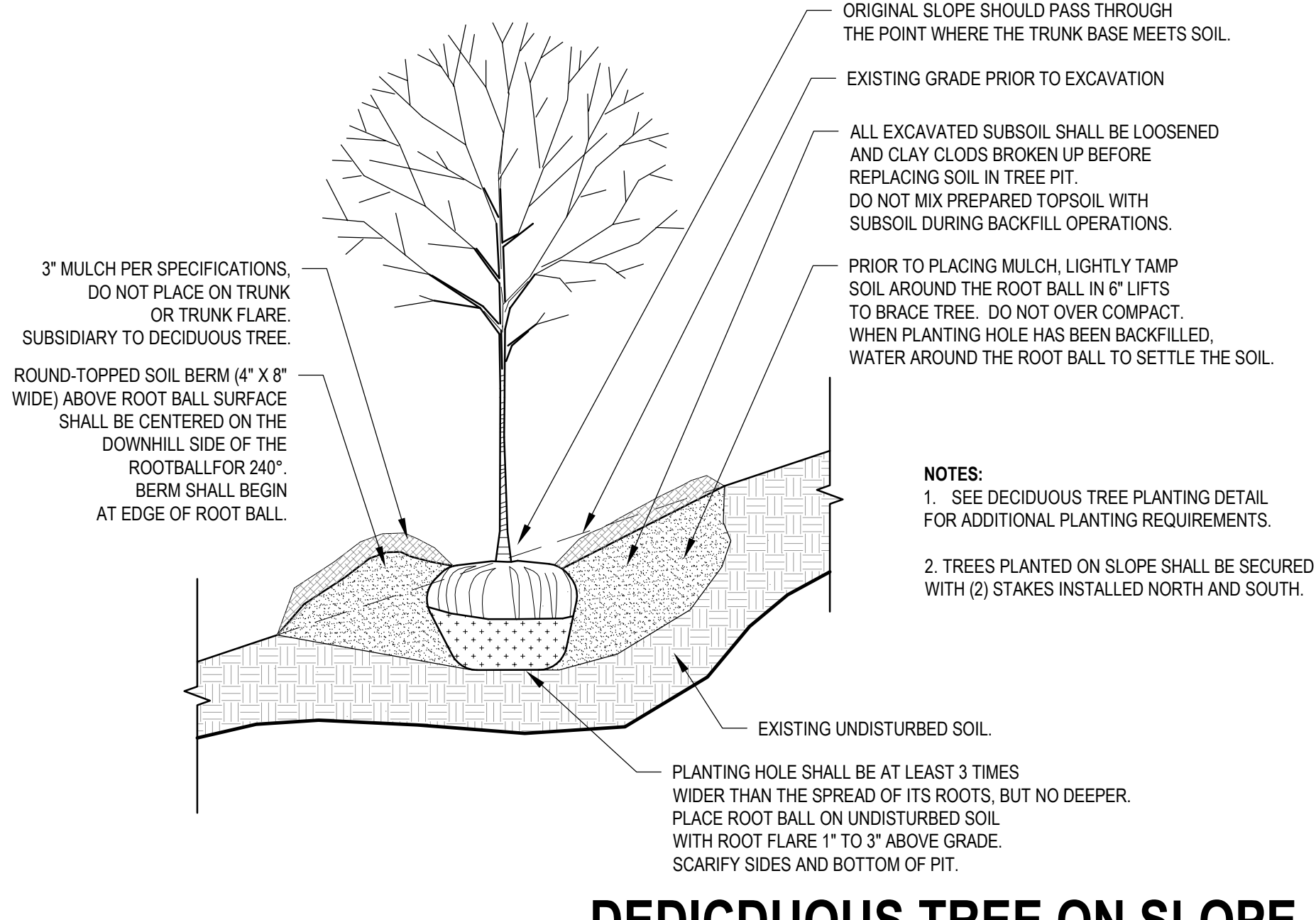

DECIDUOUS TREE ON SLOPE 04
N.T.S.

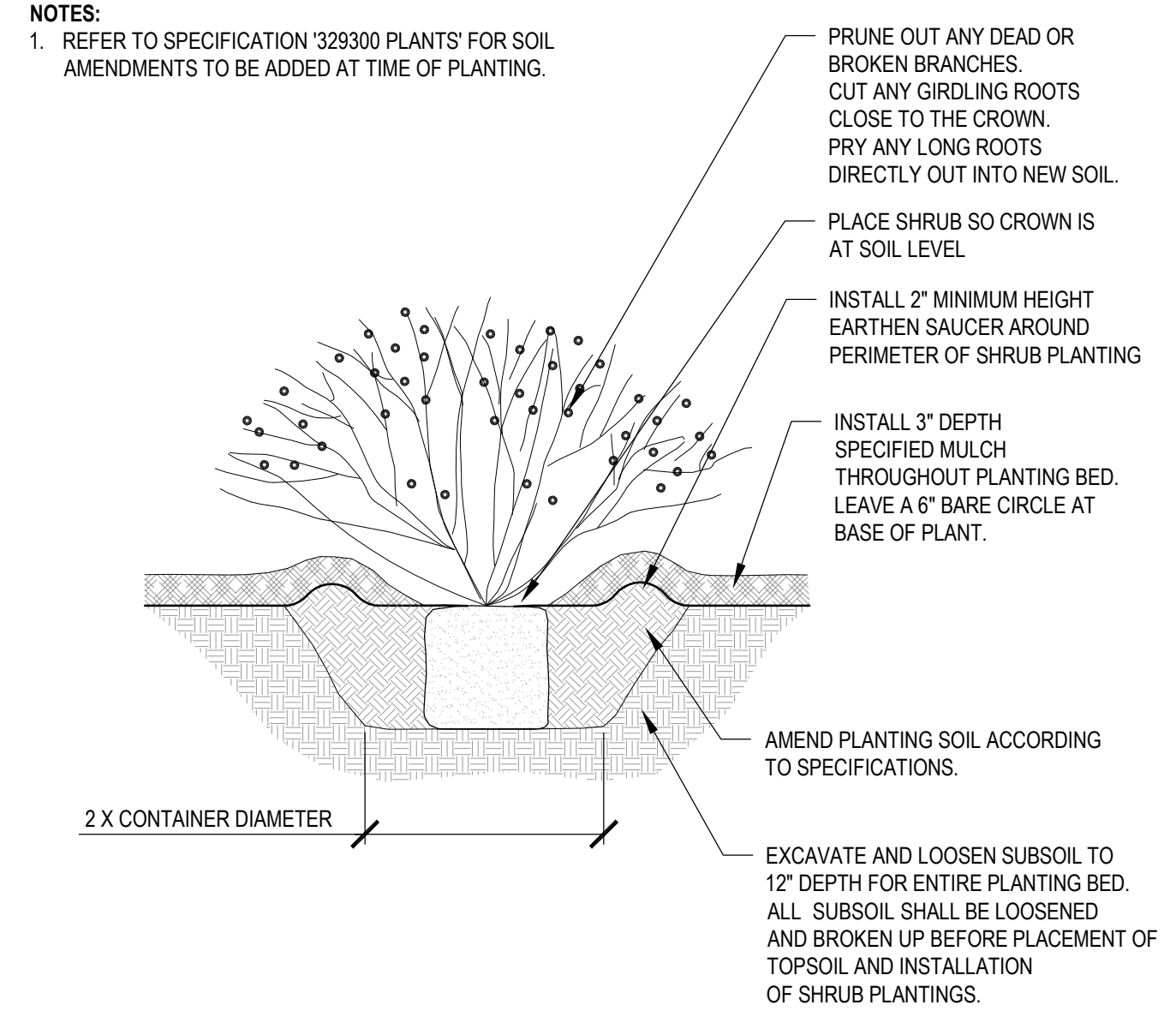

SHRUB 05
N.T.S.

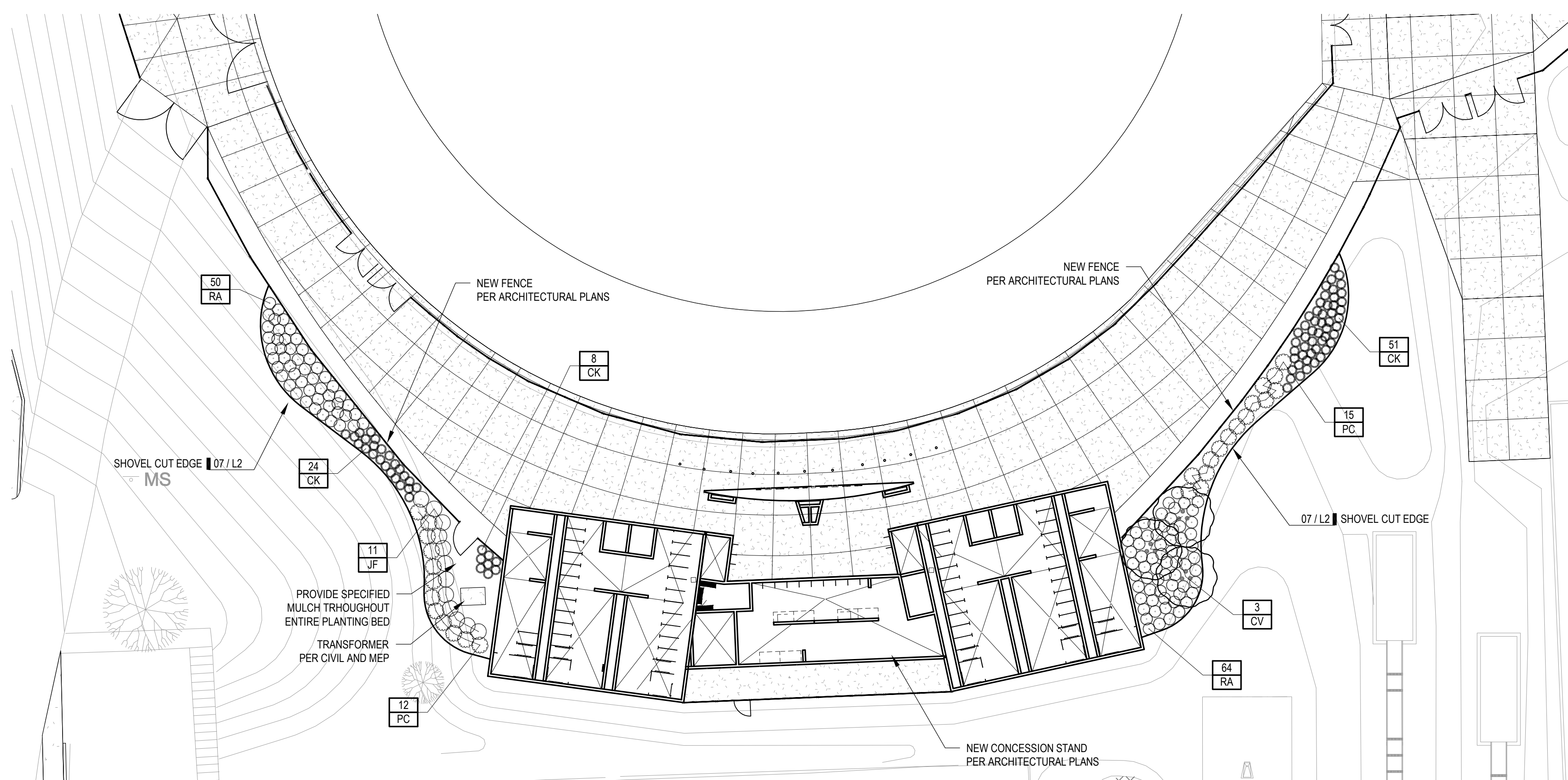

CONCESSION STAND LANDSCAPE 02
SCALE: 1" = 20'

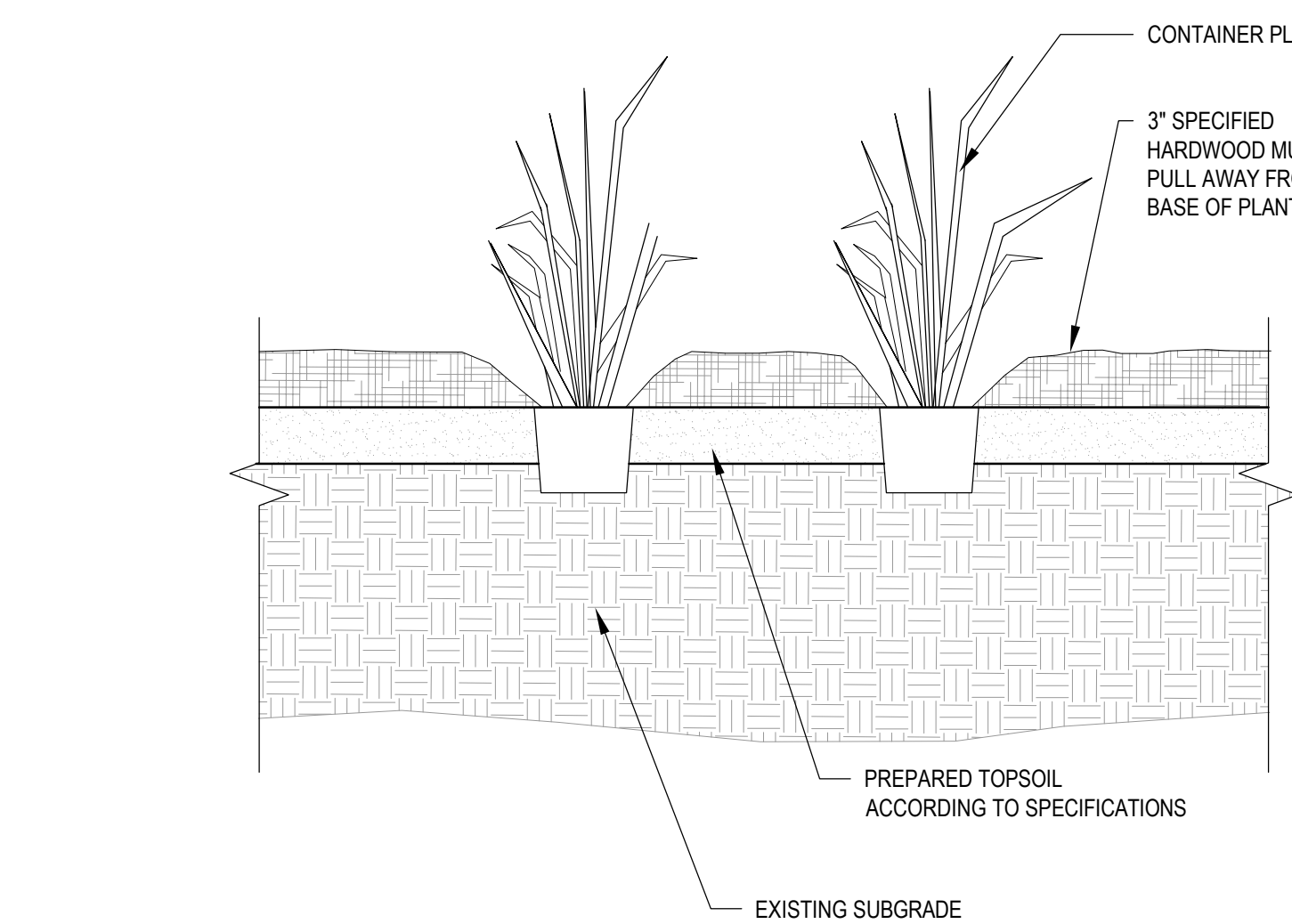

PERENNIAL PLANTING 06
N.T.S.

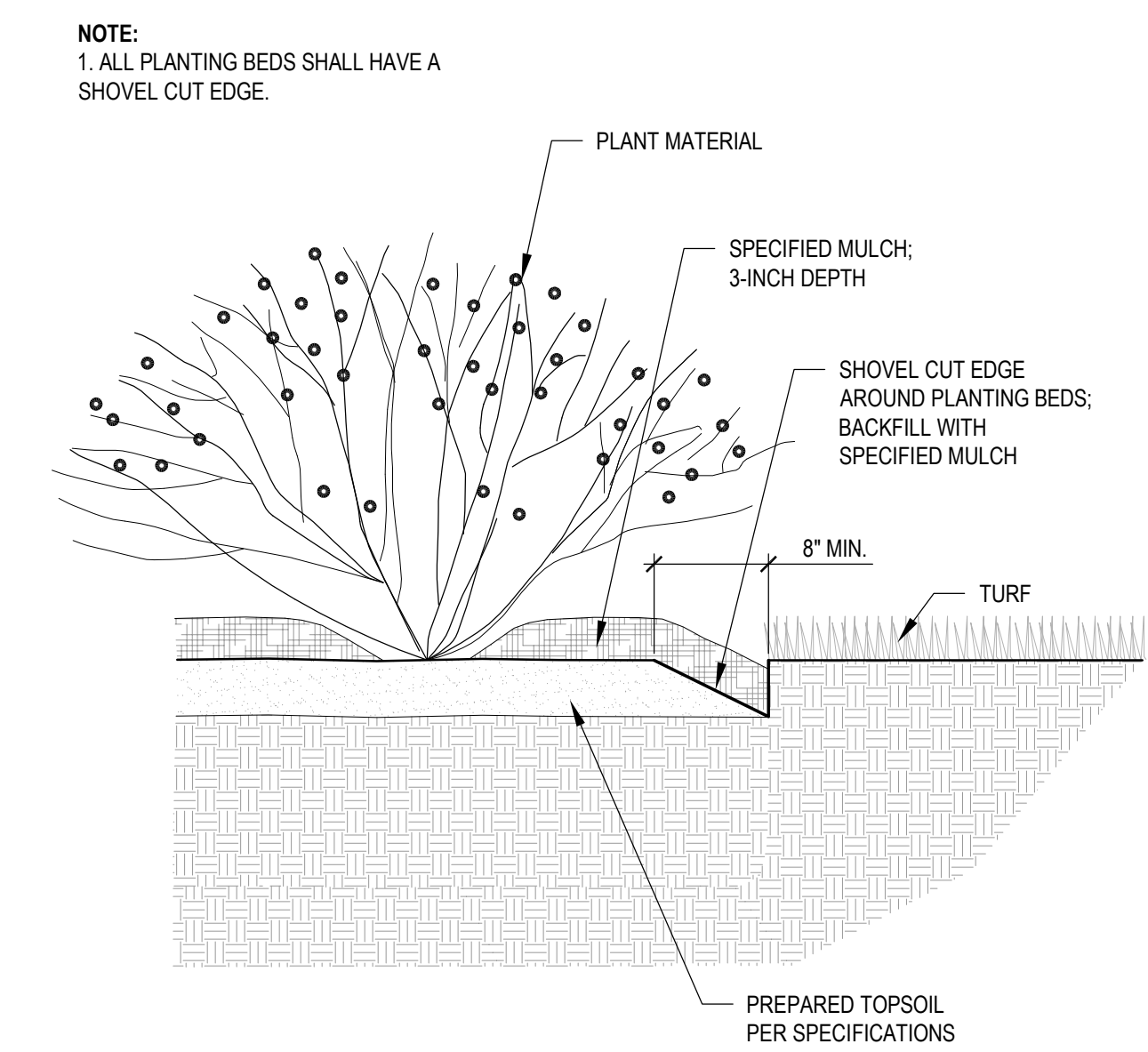

SHOVEL CUT EDGE 07
N.T.S.

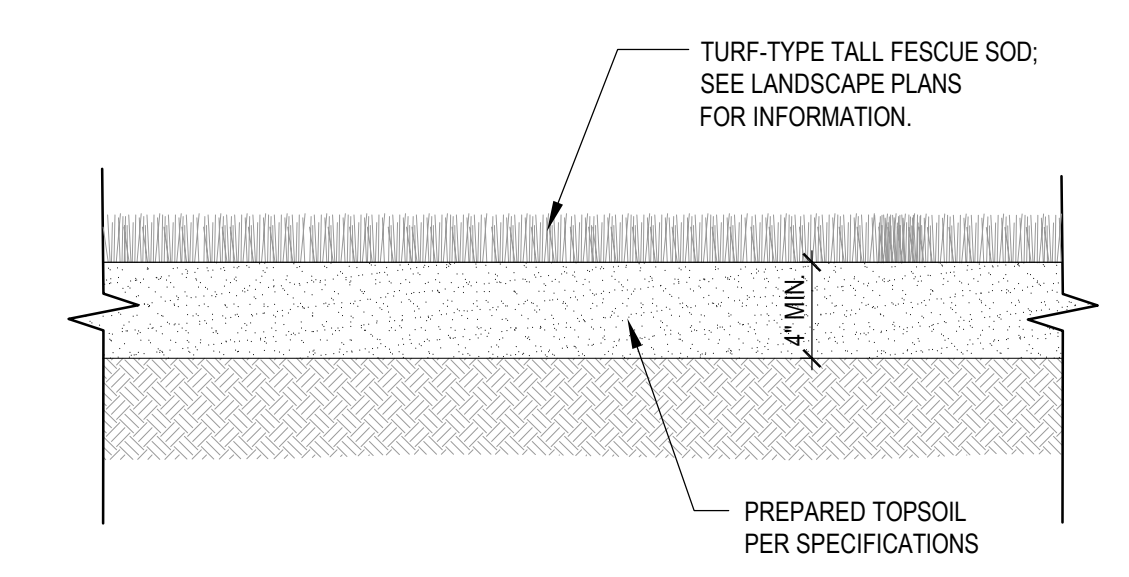

TURF SOD 08
N.T.S.

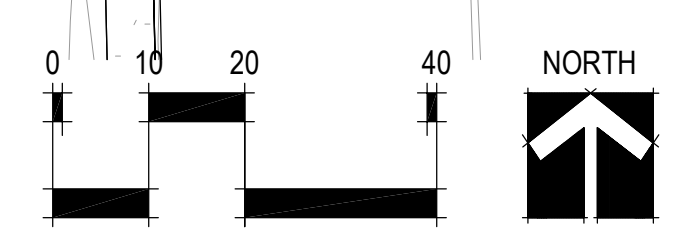

NOTE:
SOD ALL AREAS DISTURBED
DURING CONSTRUCTION
NOT DESIGNATED FOR OTHER PLANTINGS.

NOTE:
X = SPACING PER PLANT SCHEDULE
Y = 0.866 MULTIPLIED BY "X"

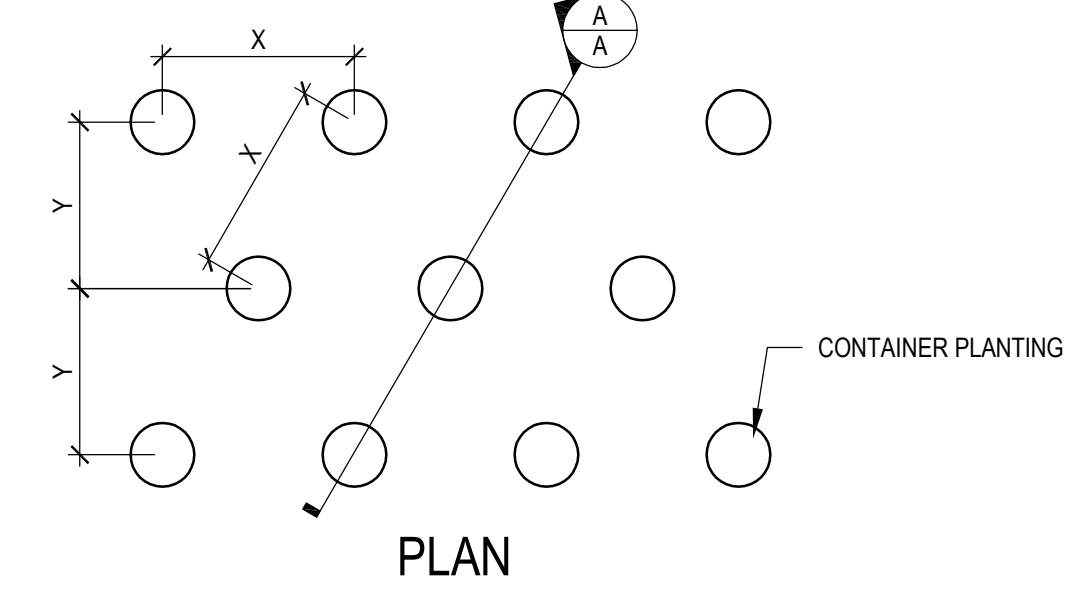

NOTE:
1. REFER TO SPECIFICATION '329300 PLANTS' FOR SOIL
AMENDMENTS TO BE ADDED AT TIME OF PLANTING.

NOTE:
1. REFER TO SPECIFICATION '329200 TURF AND GRASSES' FOR
SOIL AMENDMENTS TO BE ADDED AT TIME OF SODDING.



1710 Wyandotte
Kansas City, MO 64108
T: 816.763.9500 F: 816.763.9757
ACI/Boland, Inc.
Kansas City | St. Louis
Licensee's Certificate of Authority Number:
Kansas: #A-508

CIVIL CONSULTANT

BHC Rhodes
7101 College Blvd.
Overland Park, Kansas 66210
Licensee's Certificate of Authority Number:
Kansas #E-321
(913) 663-1900

STRUCTURAL CONSULTANT

Bob D. Campbell & Co., Inc.
4338 Bellevue
Kansas City, Missouri 64111
Licensee's Certificate of Authority Number:
Kansas #1119
(816) 531-4144

MEP CONSULTANT

Malone, Finkle, Eckhardt & Collins
7780 W. 119th St.
Overland Park, Kansas 66213
Licensee's Certificate of Authority Number:
Kansas #E-1186
(913) 922-1400

SMSD
Shawnee Mission School District
Renovations & Additions to
South Stadium @ Shawnee Mission South High School
5800 W. 107th Street, Overland Park, Kansas 66207

Date 02-16-2017
Job Number 16077
Drawn By
Checked By

Revision
Number Date Description

LANDSCAPE ARCHITECTURE
CONSULTANT



VIREO
929 Walnut Street, Suite 700
Kansas City, Missouri 64106
Licensee's Certificate of Authority Number:
Kansas #59
(816) 756-5690

BID SET

L2