

**H5** FIRST FLOOR PLAN  
1/4" = 1'-0"

NOTE:  
PROTECT ALL EXISTING FINISHES FROM DAMAGE DURING CONSTRUCTION

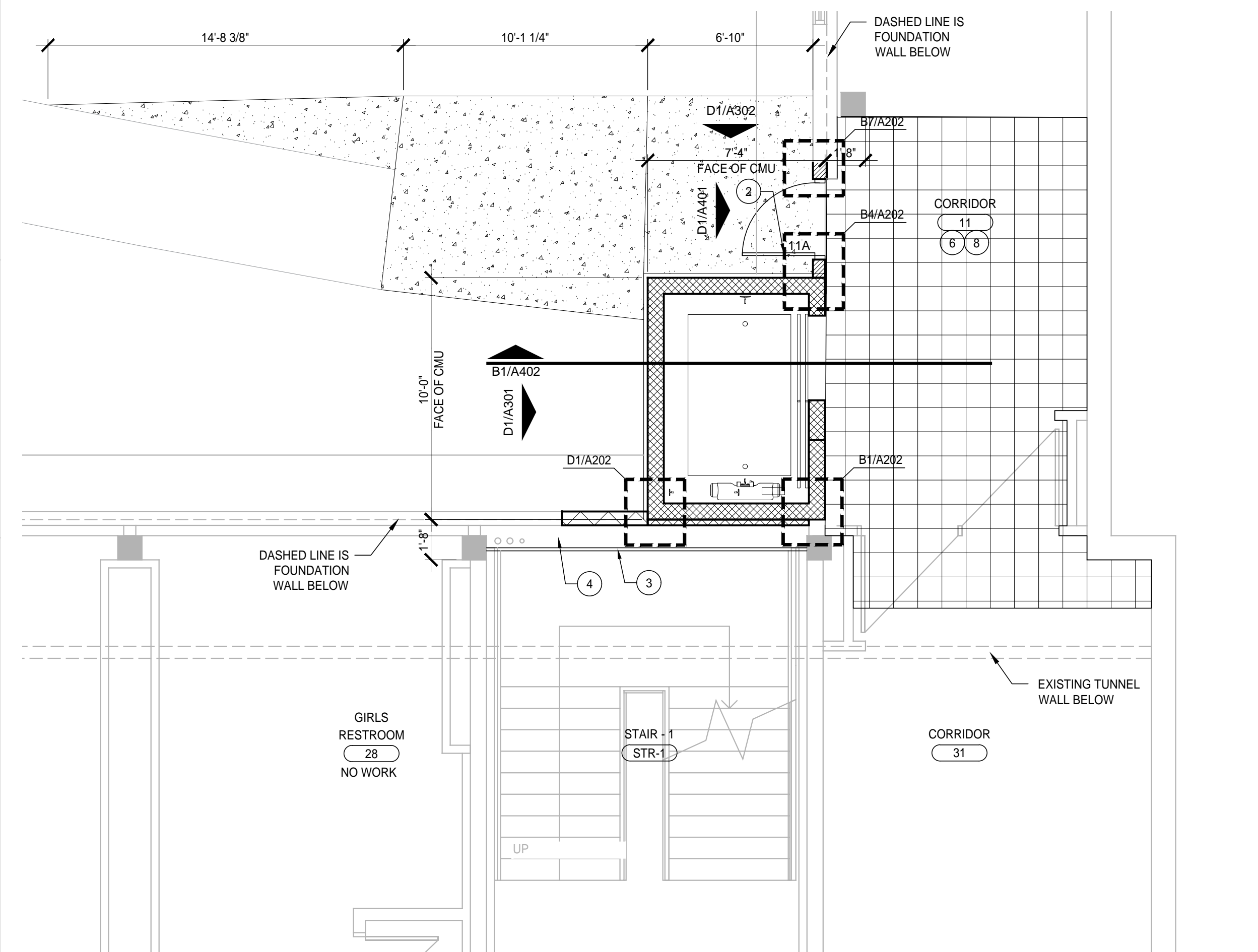

**H1** GROUND FLOOR PLAN  
1/4" = 1'-0"

NOTE:  
PROTECT ALL EXISTING FINISHES FROM DAMAGE DURING CONSTRUCTION

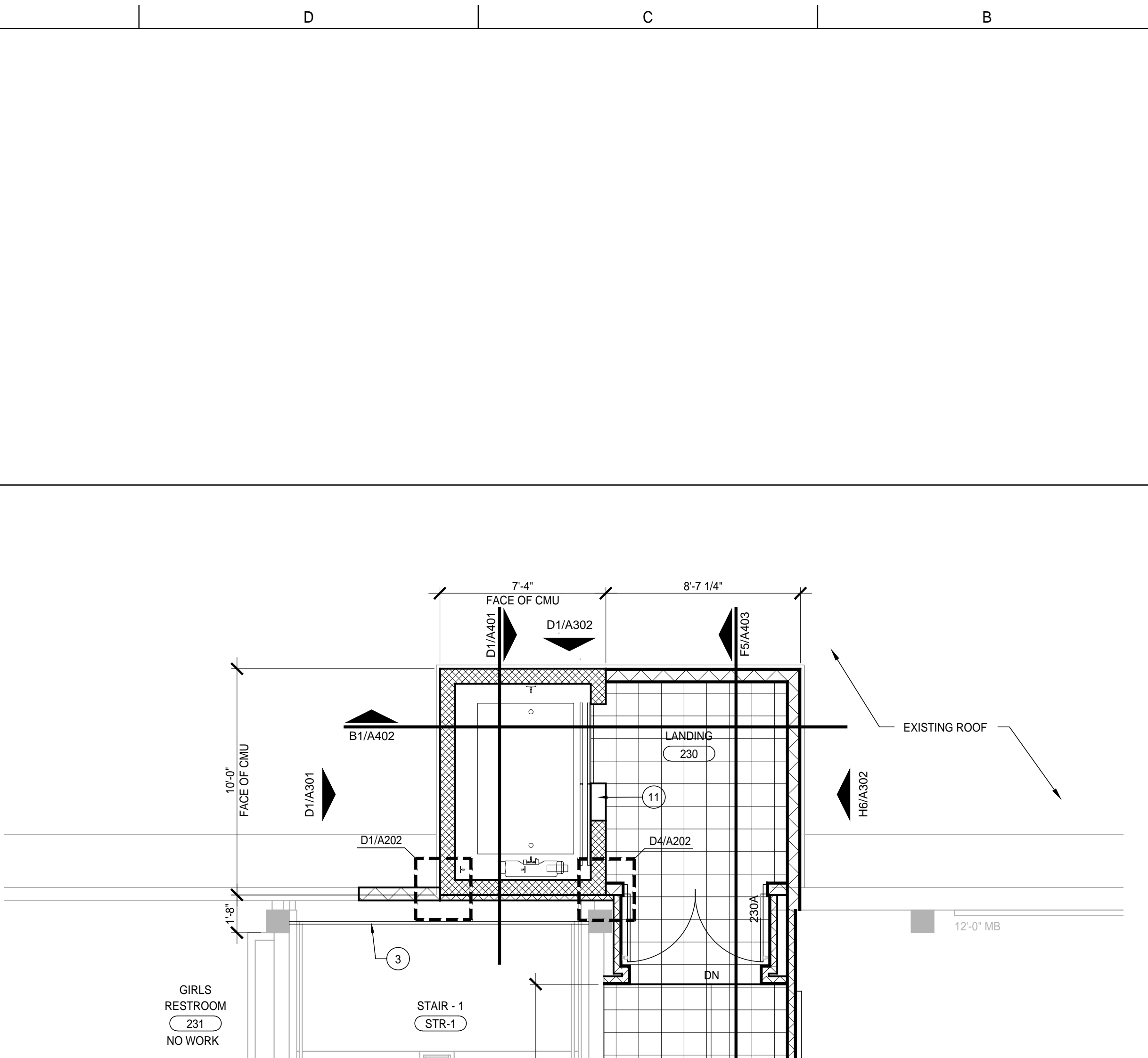













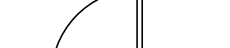

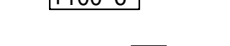
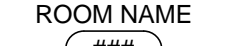

**D1** SECOND FLOOR PLAN  
1/4" = 1'-0"

NOTE:  
PROTECT ALL EXISTING FINISHES FROM DAMAGE DURING CONSTRUCTION

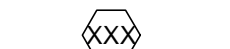
**IMPROVEMENT PLAN NOTES**

- ① NEW 4" THICK CONCRETE SIDEWALK ON 4" CLEAN CRUSHED ROCK W/#4s @ 2'-0" EACH WAY.
- ② NEW ALUMINUM DOOR & FRAME..
- ③ REINSTALL SALVAGED GUARDRAIL. REPAINT ENTIRE RAIL TO MATCH EXISTING COLOR.
- ④ PROVIDE NEW 1/2" PLYWOOD COVER @ LANDING & PAINT TO MATCH EXISTING COLOR.
- ⑤ REINSTALL SALVAGED UNIT HEATER. SEE ALSO MEP..
- ⑥ NEW 12" x 12" VCT FLOORING TO MATCH EXISTING COLOR & ORIENTATION.
- ⑦ REINSTALL SALVAGED SECTION OF OPERABLE WINDOW SYSTEM.
- ⑧ REINSTALL SALVAGED CEILING TILES TO PROVIDE SEAMLESS APPEARANCE.
- ⑨ REINSTALL SALVAGED MARKERBOARD.
- ⑩ REINSTALL SALVAGED ROOM SIGNAGE.
- ⑪ LOCATION OF INTEGRATED 'JAMB' CONTROLLER. BASIS OF DESIGN MANUFACTURER REQUIRES TOP WALLS CLEARED OUT FOR INSTALLATION OF CONTROLLER & PREFERS ALL WALLS AT EACH FLOOR TO BE CLEARED OUT. GENERAL CONTRACTOR SHALL COORDINATE REQUIREMENTS & CONSTRUCTION SEQUENCE W/ELEVATOR MANUFACTURER.

**LEGEND-NEW WORK**

	EXISTING CONST. TO REMAIN
	PATCH EXISTG CONSTR. W/ MATERIALS & FINISH TO MATCH EXISTG OR NEW FINISHES AS DESCRIBED IN WORK
	EXISTING DOOR AND DOOR FRAME TO REMAIN. EXISTING DOOR TO BE SALVAGED & RELOCATED
	NEW DOOR: RE: DOOR SCHEDULE
	FINISH FLOOR LEVEL
	NEW PARTITION TYPE. RE: SHEET AG01 ALL WALLS FULL HEIGHT UNLESS # NEXT TO PARTITION TYPE INDICATES HEIGHT OF PARTIAL HEIGHT WALL.
<b>ROOM NAME</b>	<b>ROOM NAME &amp; NUMBER</b>
	
	
	
	
	WINDOW TYPE
	H1/A101 WALL SECTION (SECTION IDENTIFIER/ SHEET NUMBER)
	H1/A101 BUILDING SECTION (SECTION IDENTIFIER/ SHEET NUMBER)
	H1/A101 ELEVATION MARK (ELEVATION IDENTIFIER/ SHEET NUMBER)
	H1/A101 ENLARGED AREA BLOWUP (IDENTIFIER/ SHEET NUMBER)

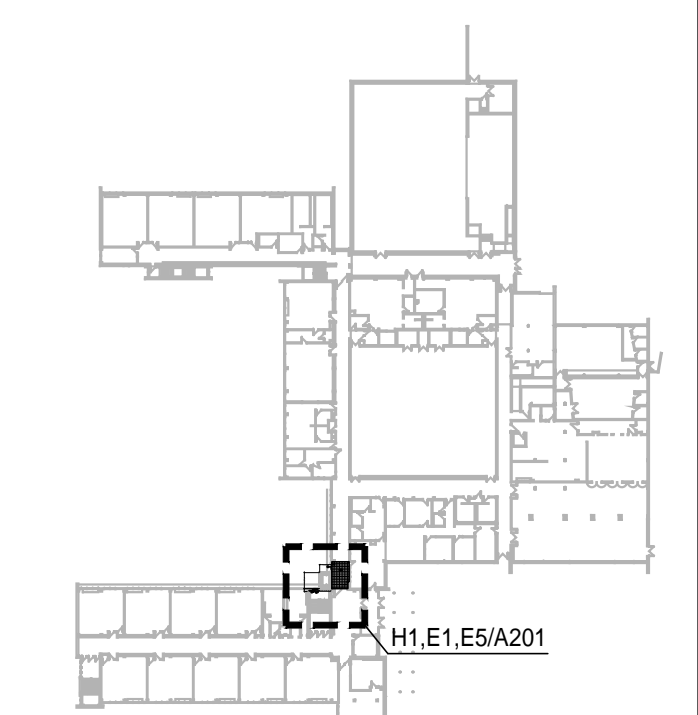

**A1** LOCATOR MAP  
N.T.S.

**KEVIN COWAN ARCHITECTS LLC**  
7840 CONSER STREET  
OVERLAND PARK, KS 66204  
913 341-3288  
FAX 341-5160

KCA PROJECT NO. 1725

**SMS&**

**INDIAN HILLS MIDDLE SCHOOL ELEVATOR ADDITION**

6400 MISSION ROAD  
PRAIRIE VILLAGE, KS 66208

STRUCTURAL ENGINEERS  
**BOB D. CAMPBELL & CO. INC.**  
4338 BELLEVUE  
KANSAS CITY, MISSOURI 64111  
P.816.531.4144  
F.816.531.8572

MECHANICAL/ELECTRICAL ENGINEERS  
**PKAIR ENGINEERS LLC**  
13300 W 98TH STREET  
LENEXA, KS 66215  
913-492-2400  
FAX-492-2437

ISSUE RECORD

NO.	DESCRIPTION	DATE

Revision Record

NO.	DESCRIPTION	DATE

**NEW FLOOR PLANS**

**A**

**201**

© Copyright 2018 Shawnee Mission School District