



Safety Meeting
December 2024





Corpus J. Zorola, CTSMS
Supervisor – Environmental/
Health/Safety/Custodial Training



Alonso Guerrero
Director of Health
Services and Operations

Safety Coordinators Meeting
December 12, 2024
SRN# 18224
Session
4:00 PM – 5:00 PM

AGENDA

- December Meeting Review
- TEA Review IDA
- Campus Map
 - Upload/Email
- Internal Safety Fence
- Exterior Door Language (OPED)
 - Operational Practical Exterior Doors
- IPM
 - Video
- Custodial Services
- Completion Matrix
- Comments

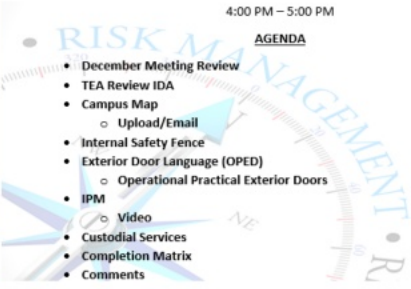



October
Meeting Review

Safety Coordinators Meeting

December 12, 2024

SRN# 18224

Session

4:00 PM – 5:00 PM

AGENDA

- December Meeting Review
- TEA Review IDA
- Campus Map
 - Upload/Email
- Internal Safety Fence
- Exterior Door Language (OPED)
 - Operational Practical Exterior Doors
- IPM
 - Video
- Custodial Services
- Completion Matrix
- Comments

1



CAMPUS LIST	FINDINGS/FLAGS	CORRECTIVE ACTIONS
26% (13 of 50 visited)	5 (Excludes Any Flags)	5 (Outstanding CAC)
Campus Data Breakdown Elementary School: 9 of 12 Intermediate School: 2 of 4 High School: 2 of 4	Classroom Breakdown Intruder Detection Audit: 0 Exterior Door Audit: 2 Monthly Door Log Audit: 0 Classroom Door Audit: 0 Other a Finding: 0	Corrective Action Breakdown TEA CAC Required: 0 TEA CAC Standard: 0 TEA CAC Approved: 0



2

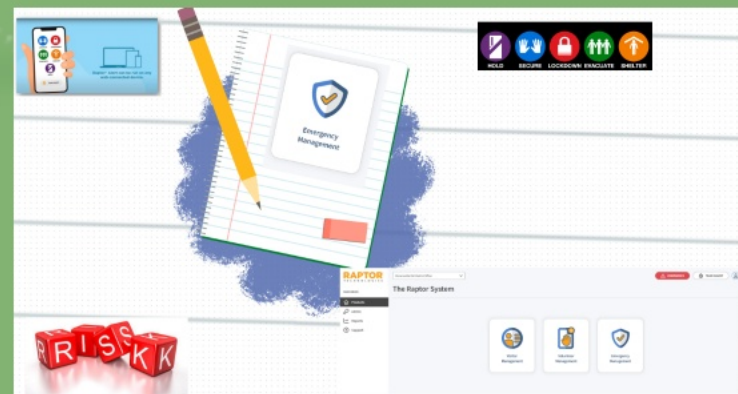

- 1 The Intruder Detection Phase
 - 2 The Exterior Door Phase
 - 3 The Classroom Door Phase (if applicable)
- Observation of the Weekly Exterior Door Sweep documentation



3

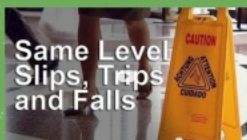

Video



CAMPUS LIST

26%

(13 of 50 visited)

Campus Visits Breakdown

Elementary School	9 of 32
Jr High/Middle School	2 of 10
High School	2 of 8

FINDINGS/FLAGS

5

(Excludes Any Flags)

Findings Breakdown

Intruder Detection Audit	0
Exterior Door Audit	3
Weekly Door Log Audit	2
Classroom Door Audit*	0
* Not a finding	

CORRECTIVE ACTIONS

5

(Outstanding CAs)

Corrective Actions Breakdown

Total CAs Required	5
Total CAs Submitted	0
Total CAs Approved	0

1

The Intruder Detection Phase

The unannounced portion where the inspector selects up to three exterior doors and if unsecured, attempts an unauthorized entry to the school.

2

The Exterior Door Phase

The inspector checks in at the school's main office, obtains a campus escort, and checks all exterior campus doors to see if they are closed, latched, and locked.

3

The Classroom Door Phase (if applicable)

If the LEA has an interior classroom door locking policy, the inspector conducts a random check of classroom doors to verify if they are closed, latched, and locked.



Observation of the Weekly Exterior Door Sweep documentation

While the inspector is on-site, they review the preceding six weeks of required weekly door sweep documentation of that campus.



TEA IDA (Intruder Detection Audit)

Make sure:
All exterior doors are locked

Document all weekly door sweeps

No exterior doors are propped open

No broken exterior doors

Inspectors evaluated campuses in the phases shown. Findings were issued in the following circumstances:	PHASE 1	Intruder Detection Audit Finding An inspector gained unauthorized access to a campus.
	PHASE 1	Exterior Door Audit Finding One or more issues were found with the security of one or more exterior doors (door is not secured, not locked, broken, propped open).
	PHASE 1	Classroom Door Audit Finding When a district had a written and/or verbal policy directing to lock classroom doors, any classroom door in a sample of 8 – 10 doors was not closed and/or not locked.
	DOOR SWEEPS	Weekly Door Sweeps Audit Finding A campus did not document door sweep process and/or did not have documentation of the previous six weeks' worth of checks on all exterior doors.

TEA IDA (Intruder Detection Audit)

Make sure:

All exterior doors are not propped open

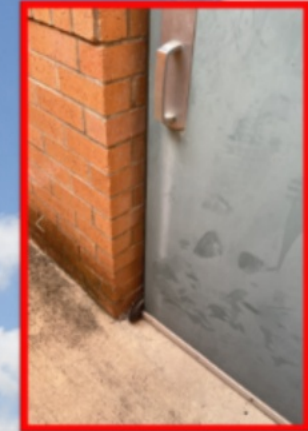

TEA IDA (Intruder Detection Audit)

Make sure:

All exterior doors are locked



TEA IDA (Intruder Detection Audit)

Make sure:

No broken exterior doors



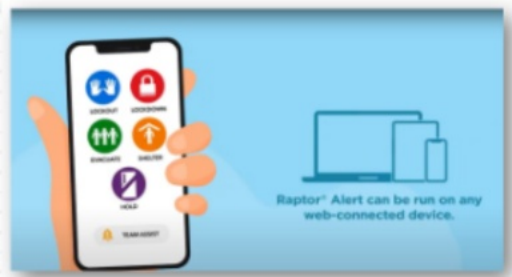

RAPTOR
TECHNOLOGIES

MAIN MENU

- Products
- Admin
- Reports
- Support

Brownsville ISD District Office

The Raptor System

EMERGENCY

TEAM ASSIST

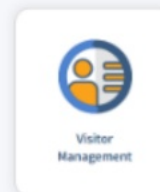

Visitor
Management

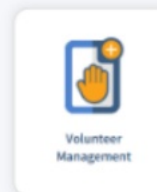

Volunteer
Management



Emergency
Management

TASK



**LOOK OUT
FOR...**

SLIPS



**TRIPS
&**

FALLS



© All Rights Reserved 2018



Video

High Schools

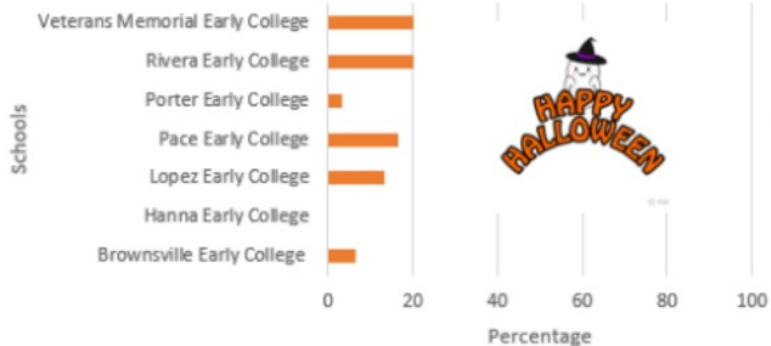

Alternative Schools

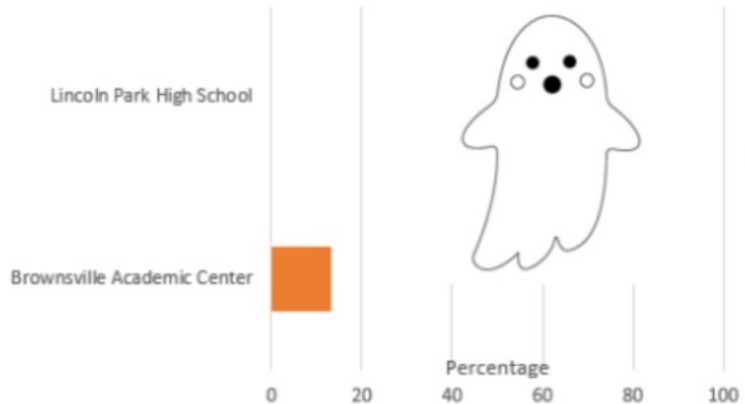

Middle Schools

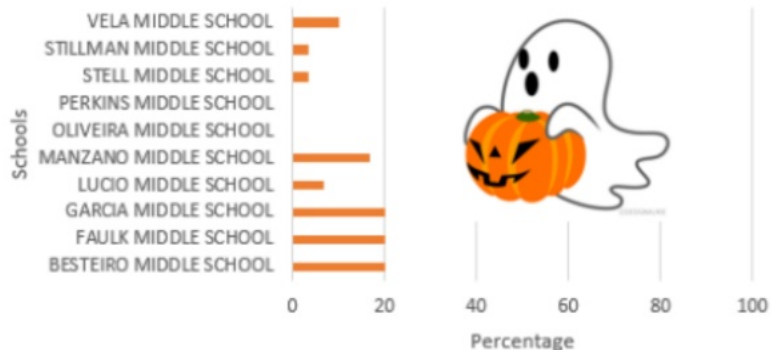

Elementary Schools

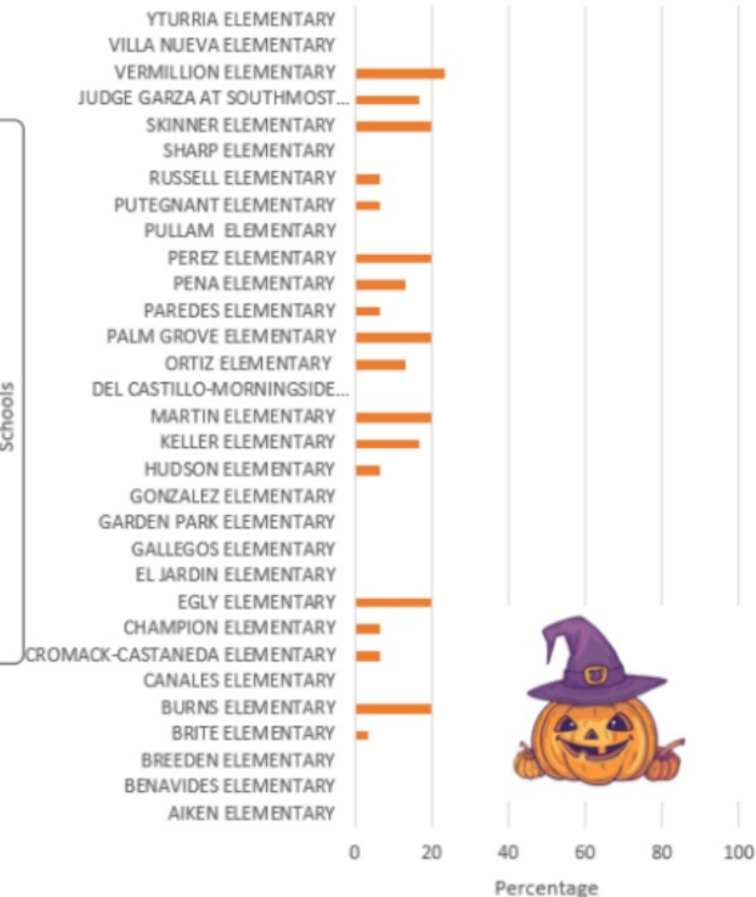

HAPPY HALLOWEEN

Same Level Slips, Trips and Falls



IDA Safety

Campus Findings



TEA IDA (Intruder Detection)

Make sure:

**All exterior doors
are locked**

Review



FINDINGS/FLAGS

CORRECTIVE ACTIONS



Corpus J. Zorola, CTSMS
Supervisor – Environmental/
Health/Safety/Custodial Training

Alonso Guerrero
Director of Health
Services and Operations

Safety Coordinators Meeting
December 12, 2024
SRN# 18224
Session
4:00 PM – 5:00 PM

AGENDA

- December Meeting Review
- TEA Review IDA
- Campus Map
 - Upload/Email
- Internal Safety Fence
- Exterior Door Language (OPED)
 - Operational Practical Exterior Doors
- IPM
 - Video
- Custodial Services
- Completion Matrix
- Comments



October
Meeting Review



Safety Meeting
December 2024





Safety



Campus Findings



Review



Campus List (50) - 48%

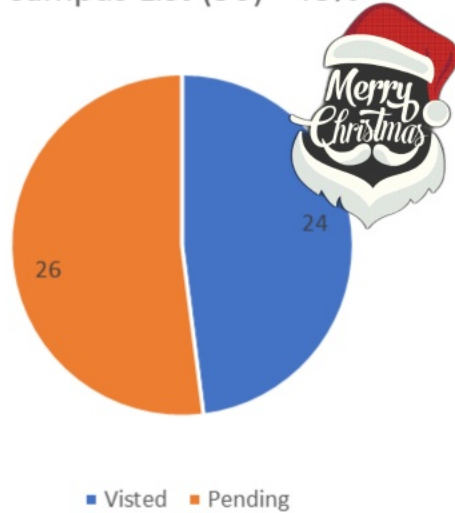

Elementary School
15 of 32
Jr High/Middle School
5 of 10
High School
4 of 8

Total Findings: Exterior Doors - 4 Weekly Door Logs - 5



1

The Intruder Detection Phase

The unannounced portion where the inspector selects up to three exterior doors and if unsecured, attempts an unauthorized entry to the school.

2

The Exterior Door Phase

The inspector checks in at the school's main office, obtains a campus escort, and checks all exterior campus doors to see if they are closed, latched, and locked.

3

The Classroom Door Phase (if applicable)

If the LEA has an interior classroom door locking policy, the inspector conducts a random check of classroom doors to verify if they are closed, latched, and locked.



Observation of the Weekly Exterior Door Sweep documentation

While the inspector is on-site, they review the preceding six weeks of required weekly door sweep documentation of that campus.



Campus List (50) - 48%

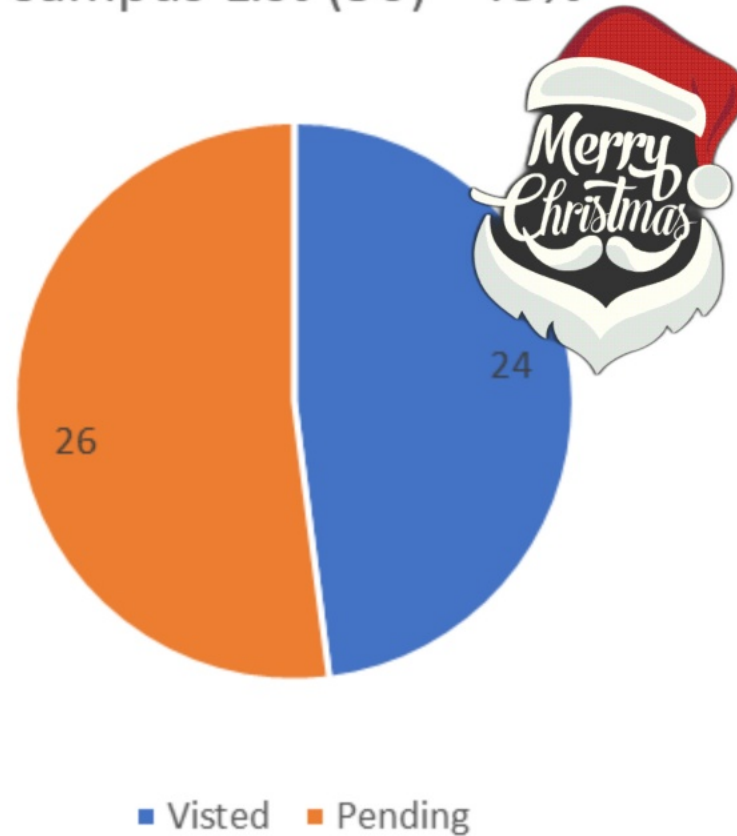

Elementary School
15 of 32
Jr High/Middle School
5 of 10
High School
4 of 8

tary School
Middle School
School

Total Findings: Exterior Doors - 4 Weekly Door Logs - 5





Safety



Campus Findings



Review



TEA IDA (Intruder Detection Audit)

Make sure:

All exterior doors are locked

Document all weekly door sweeps

No exterior doors are propped open

No broken exterior doors

Inspectors evaluated
campuses in the
phases shown.

Findings were issued
in the following
circumstances:

PHASE 1

Intruder Detection Audit Finding

An inspector gained unauthorized access to a campus

PHASE 2

Exterior Door Audit Finding

One or more issues were found with the security of one or more exterior doors (door/s not secured, not locked, broken, propped open)

PHASE 3

Classroom Door Audit Finding

When a district had a written and/or verbal policy/directive to lock classroom doors, any classroom door in a sample of 8 – 10 doors was not closed and/or not locked

DOOR SWEEPS

Weekly Door Sweeps Audit Finding

A campus did not document door sweep processes and/or did not have documentation of the previous six weeks' worth of checks on all exterior doors



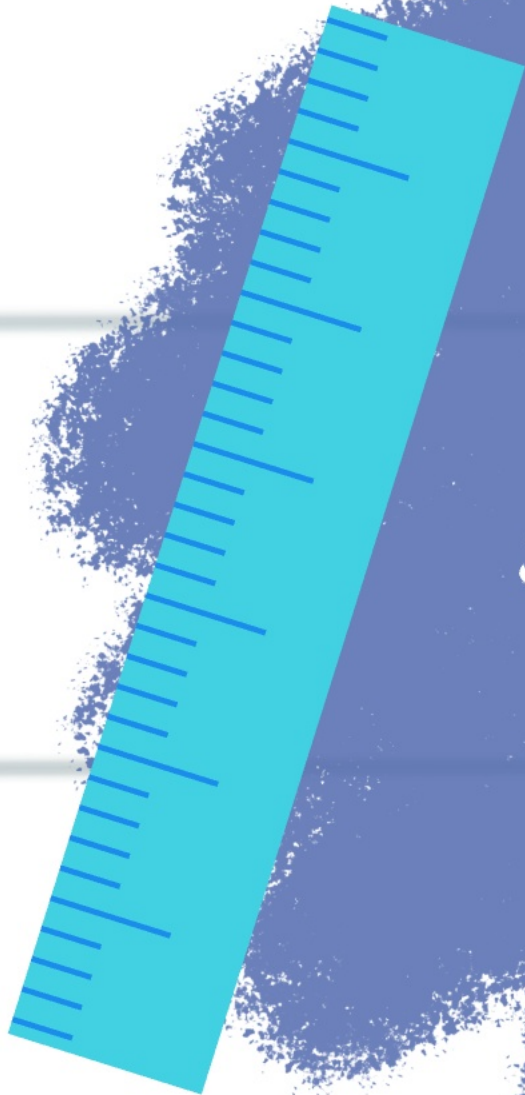

Safety



Campus Findings



Review





Safety Meeting
December 2024



Reply Reply All Forward 10/31/2024 9:34 AM
Jesus Aguayo, MS <jaguayo@esc1.net>
[EXTERNAL]: Follow-Up on Campus Safety and Door Locking Procedures
To: Corpus Christi
Cc: Deanna Stevens <Deanna.Stevens@txescs.gov>; Hector M. Rendon <hrendon@esc1.net>; Elizabeth Garcia
This message was sent with high importance.

From: Jesus Aguayo, MS <jaguayo@esc1.net>
Sent: Thursday, October 31, 2024 8:47 AM
To: Corpus Christi <corpus@txescs.gov>
Cc: Stevens, Deanna <Deanna.Stevens@txescs.gov>; Hector M. Rendon <hrendon@esc1.net>
Subject: [EXTERNAL]: Follow-Up on Campus Safety and Door Locking Procedures
Importance: High

CAUTION: This email originated from outside of Brownsville ISD. Do not click links or open attachments unless you recognize the sender and know the content is safe.

Good morning Corpus,

I hope all is well. The term for this is Operational Practical. We do not utilize the words transitional doors Please refer to the Intruder Detection Audit – School District Manual found in Sentinel.

If your district campuses do not currently meet the criteria to allow Operational Practical Exterior doors your district will need to either:

- **Actively monitor** those exterior doors OR
- **Properly Close, Lock & Latch** those exterior doors OR
- Have those doors within an **Exterior Secured Area** (Perimeter fencing is NOT considered an Exterior Secured Area – As Per the Texas Education Agency).

We can schedule Mr. Hector Rendon – ESC 1 Safety Specialist to meet with you at this campus to see your options or reach out to schedule with Ms. Deanna Stevens from TEA.

Please let me know how you would like to proceed.

Have a great day!

 Jesus Aguayo, MS
Director
Office of Safety & Transportation
Division of Leadership, and Community Impact
P: (361) 964-6223
www.esc1.net



BISD Sample School



The numbering sequence shall be clockwise and may be sequenced for the entire campus or for each facility individually.

BISD Sample School

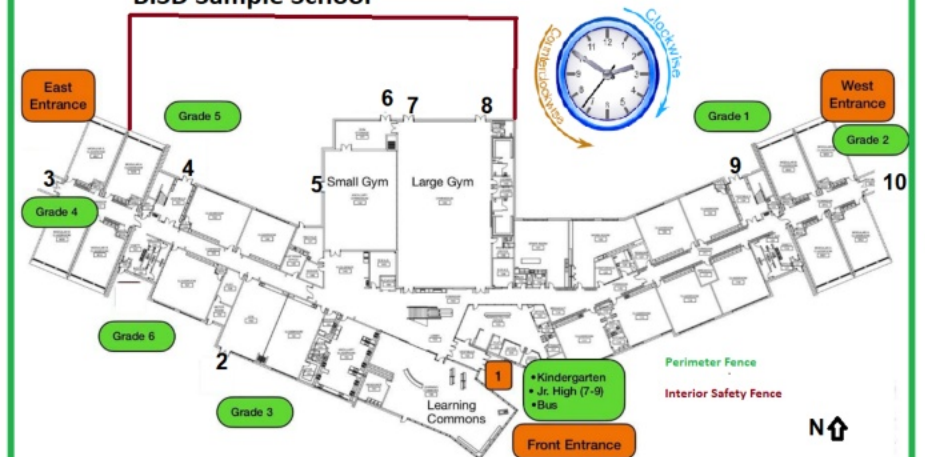

The numbering sequence shall be clockwise and may be sequenced for the entire campus or for each facility individually.

BISD Sample School



The numbering sequence shall be clockwise and may be sequenced for the entire campus or for each facility individually.

BISD Sample School

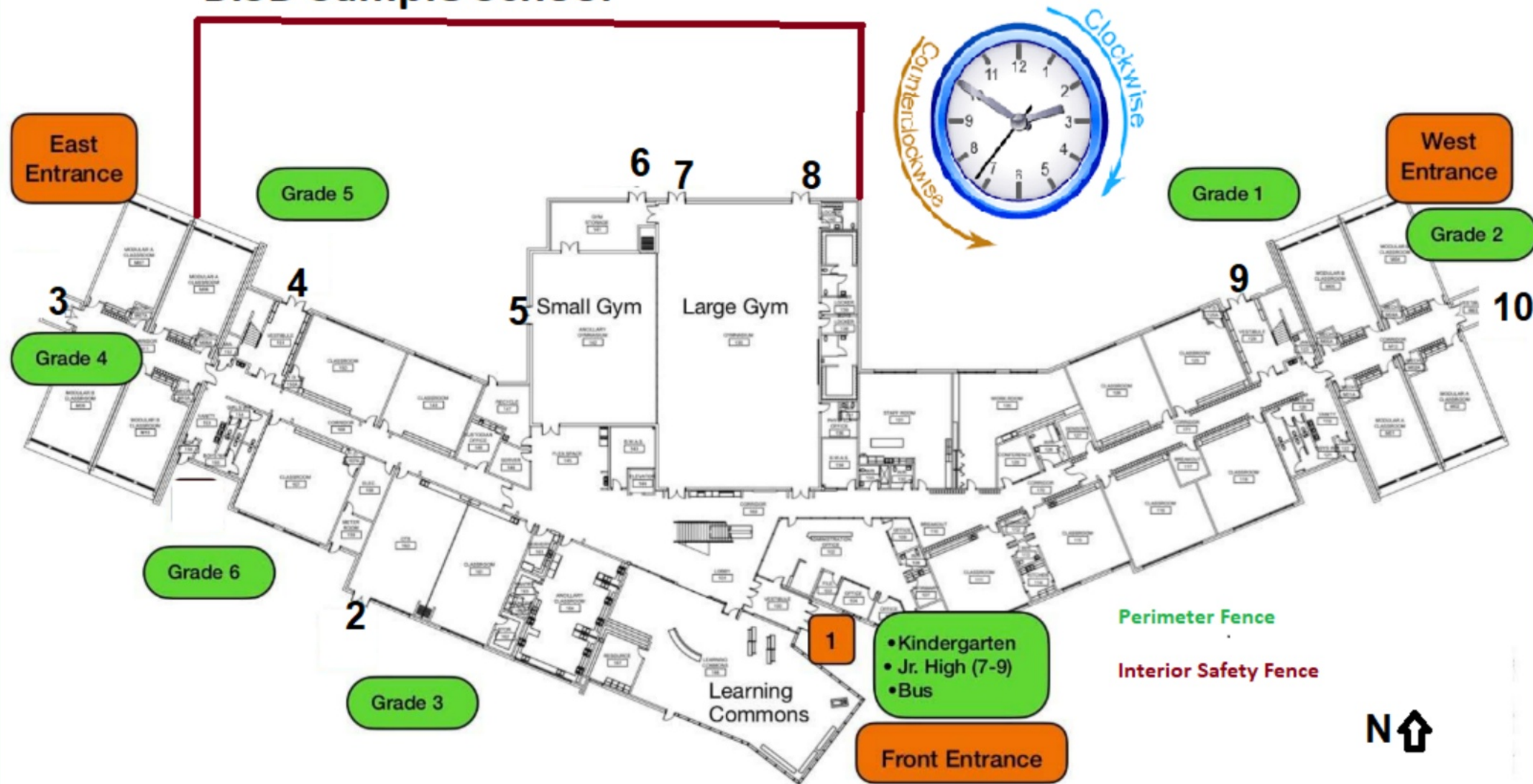

The numbering sequence shall be clockwise and may be sequenced for the entire campus or for each facility individually.

Reply Reply All Forward IM

Thu 10/31/2024 9:04 AM



Jesus Aguayo, MS <jaguayo@esc1.net>

[EXTERNAL]RE: Follow-Up on Campus Safety and Door Locking Procedures

To Corpus Zorola

Cc Stevens, Deanna; Hector M. Rendon; Alonso Guerrero; Elizabeth Garza

This message was sent with High importance.

From: Jesus Aguayo, MS <jaguayo@esc1.net>

Sent: Thursday, October 31, 2024 8:47 AM

To: Corpus Zorola <zorola@bisd.us>

Cc: Stevens, Deanna <Deanna.Stevens@tea.texas.gov>; Hector M. Rendon <hrendon@esc1.net>

Subject: [EXTERNAL]RE: Follow-Up on Campus Safety and Door Locking Procedures

Importance: High

CAUTION: This email originated from outside of Brownsville ISD. Do not click links or open attachments unless you recognize the sender and know the content is safe.

Good morning Corpus,

I hope all is well. The term for this is Operational Practical. We do not utilize the words transitional doors Please refer to the Intruder Detection Audit – School District Manual found in Sentinel.

If your district campuses do not currently meet the criteria to allow Operational Practical Exterior doors your district will need to either:

- **Actively monitor** those exterior doors OR
- **Properly Close, Lock & Latch** those exterior doors OR
- Have those doors within an **Exterior Secured Area** (Perimeter fencing is NOT considered an Exterior Secured Area – As Per the Texas Education Agency).

We can schedule Mr. Hector Rendon – ESC 1 Safety Specialist to meet with you at this campus to see your options or reach out to schedule with Ms. Deanna Stevens from TEA.

Please let me know how you would like to proceed.

Have a great day!



Jesus Aguayo, MS

Director

Office of Safety & Transportation

Division of Leadership, and Community Impact

P: (956) 984-6283

www.esc1.net



Safety Meeting
December 2024



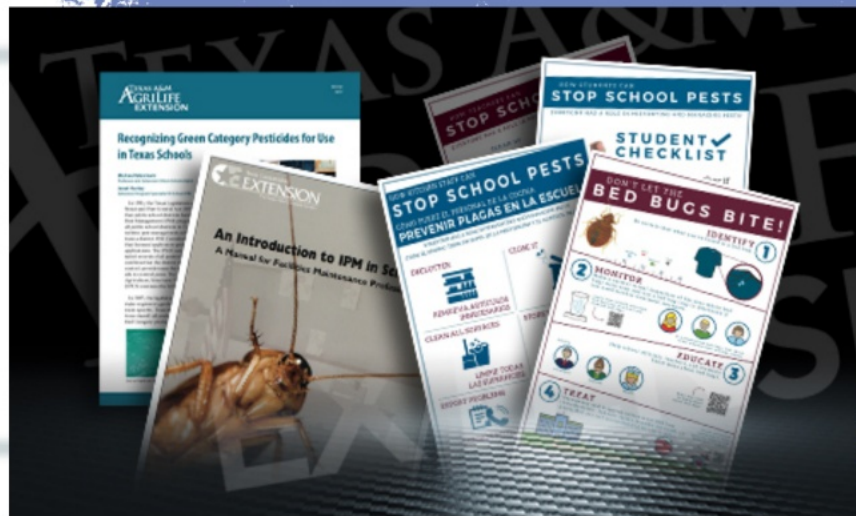

*Custodial
Services*

*Completion
Matrix*



IPM for Texas Schools and Teachers

IPM How-To: The Pest Proofing Pyramid

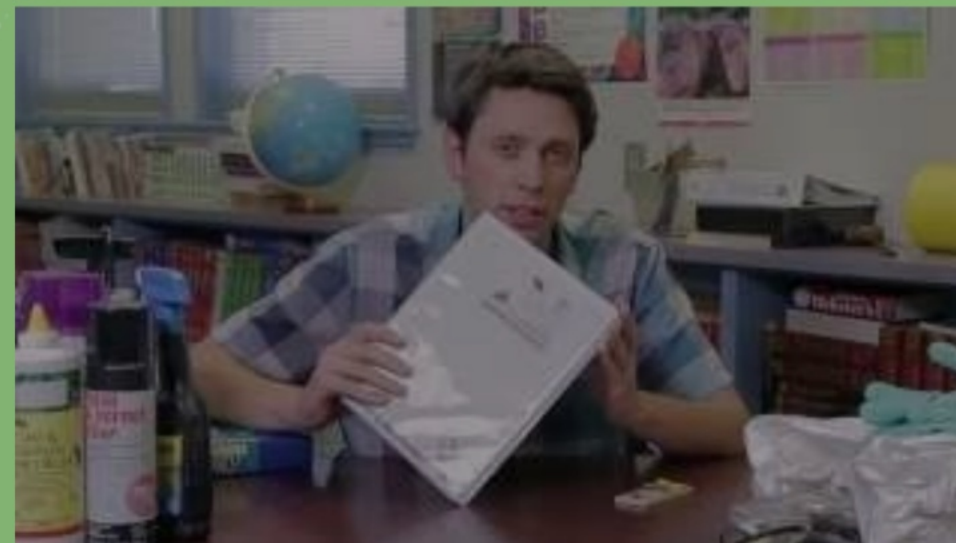

IPM for Texas Schools and Teachers

IPM How-To: The Pest Proofing Pyramid





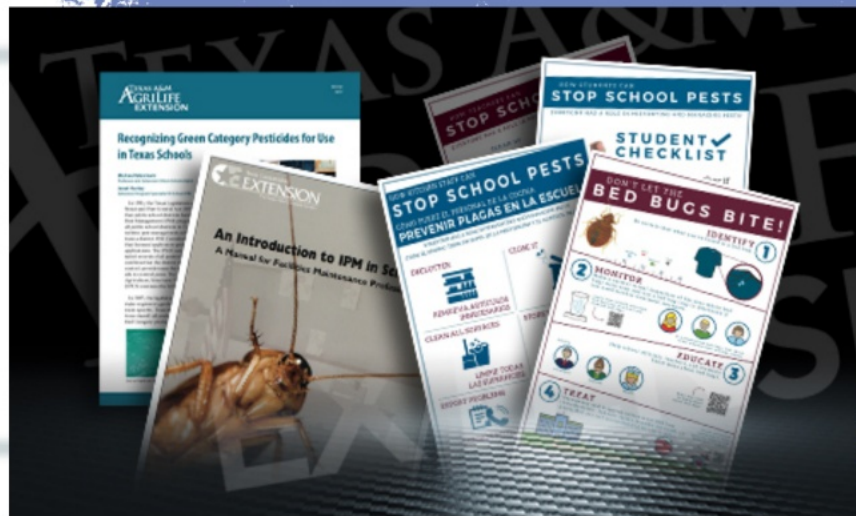

*Custodial
Services*

*Completion
Matrix*



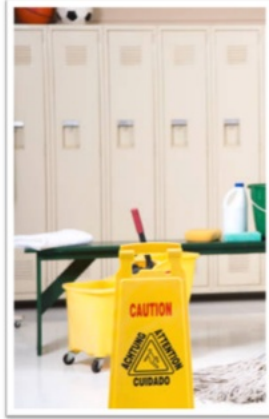

CUSTODIAL PROCEDURES MANUAL

BISD 2024

BROWNSVILLE INDEPENDENT SCHOOL DISTRICT CUSTODIAL SERVICES

MISSION STATEMENT

Our mission is to provide a clean, safe, and welcoming environment for all students, staff, and visitors. We are committed to maintaining the highest standards of cleanliness and hygiene, ensuring that our school facilities support the educational mission and foster a positive learning atmosphere. We strive to create a space where everyone can thrive through teamwork, dedication, and continuous improvement.

Vision Statement

The Custodial staff envisions a school environment where cleanliness and safety are paramount, contributing to our students' and staff's overall well-being and success. Our custodial team aspires to be recognized for excellence, reliability, and commitment to creating a pristine and healthy learning space. Through innovation, continuous training, and a proactive approach, we aim to set the standard for custodial services in educational institutions.

GOALS

1. **Maintain High Standards of Cleanliness:** Ensure all school facilities are consistently clean and hygienic to provide students and staff with a safe and healthy environment.
2. **Enhance Safety:** Regularly inspect and maintain school premises to prevent accidents and ensure compliance with safety regulations.
3. **Support Educational Activities:** Provide timely and efficient support for school events and activities, ensuring that all spaces are prepared and maintained.
4. **Promote Sustainability:** Implement eco-friendly cleaning practices and waste management solutions to reduce the school's environmental footprint.
5. **Continuous Improvement:** Engage in ongoing training and professional development to stay updated with the latest cleaning techniques and safety protocols.
6. **Foster Teamwork:** Encourage collaboration and communication within the custodial team to improve efficiency and job satisfaction.
7. **Customer Satisfaction:** Strive to meet and exceed the expectations of students, staff, and visitors through responsive and courteous service.

BISD 2024

Custodial Services Supervisor

Jorge Corpus
and
Luis E. Gonzalez



TASK 

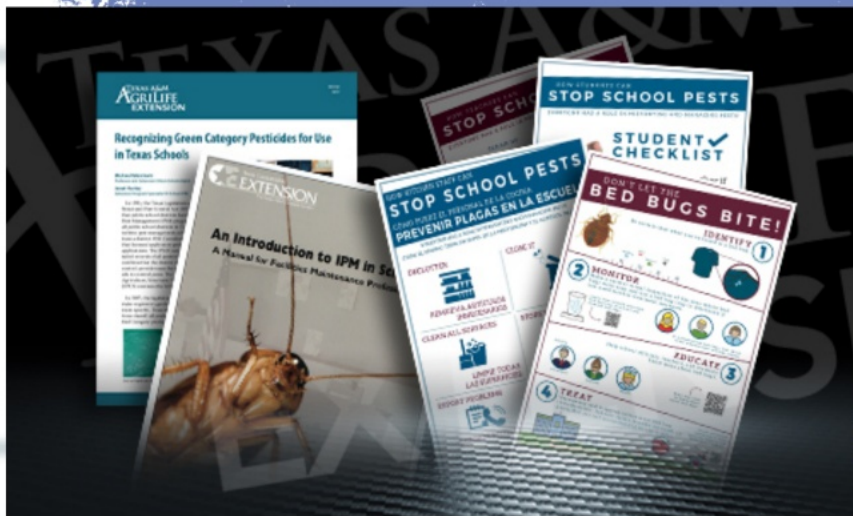

*Custodial
Services*

*Completion
Matrix*



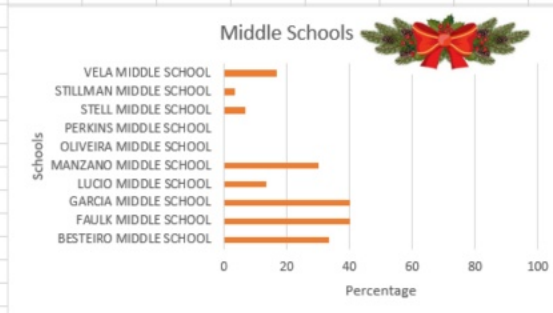
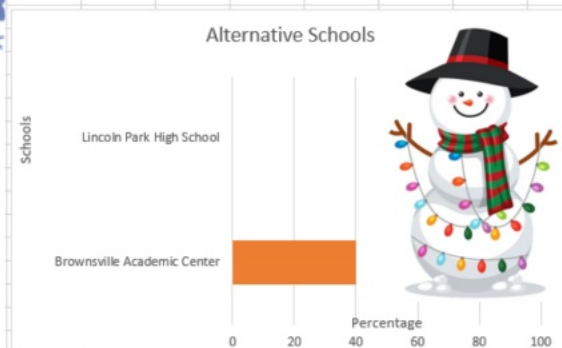
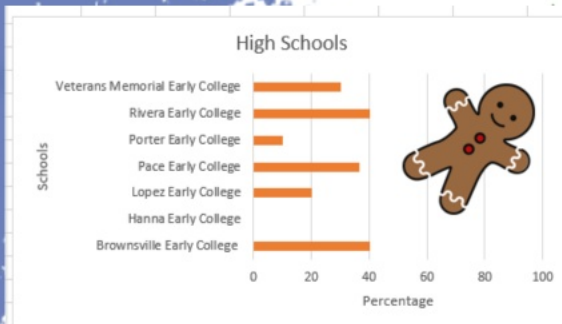

High Schools

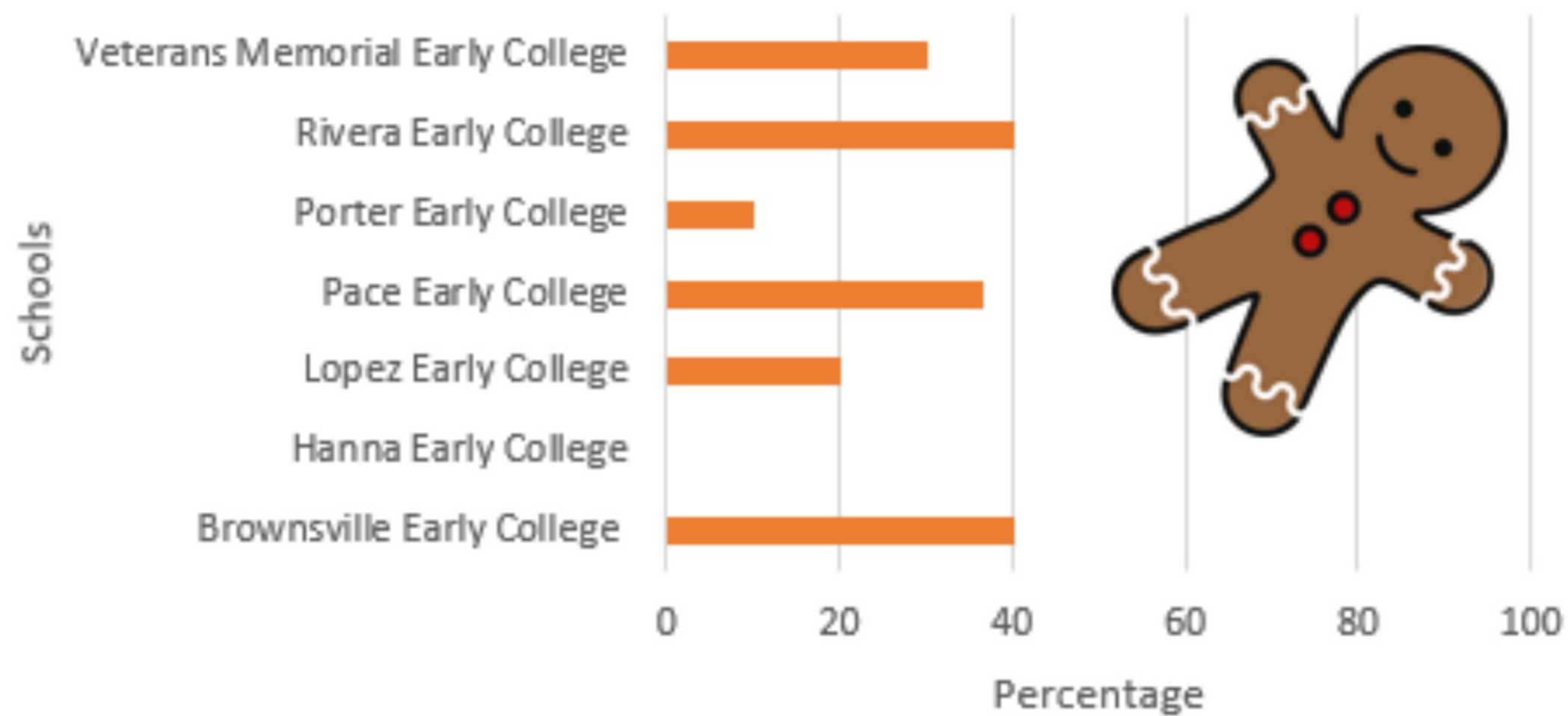

Alternative Schools

Schools

Lincoln Park High School

Brownsville Academic Center

0

20

40

60

80

100

Percentage



Middle Schools

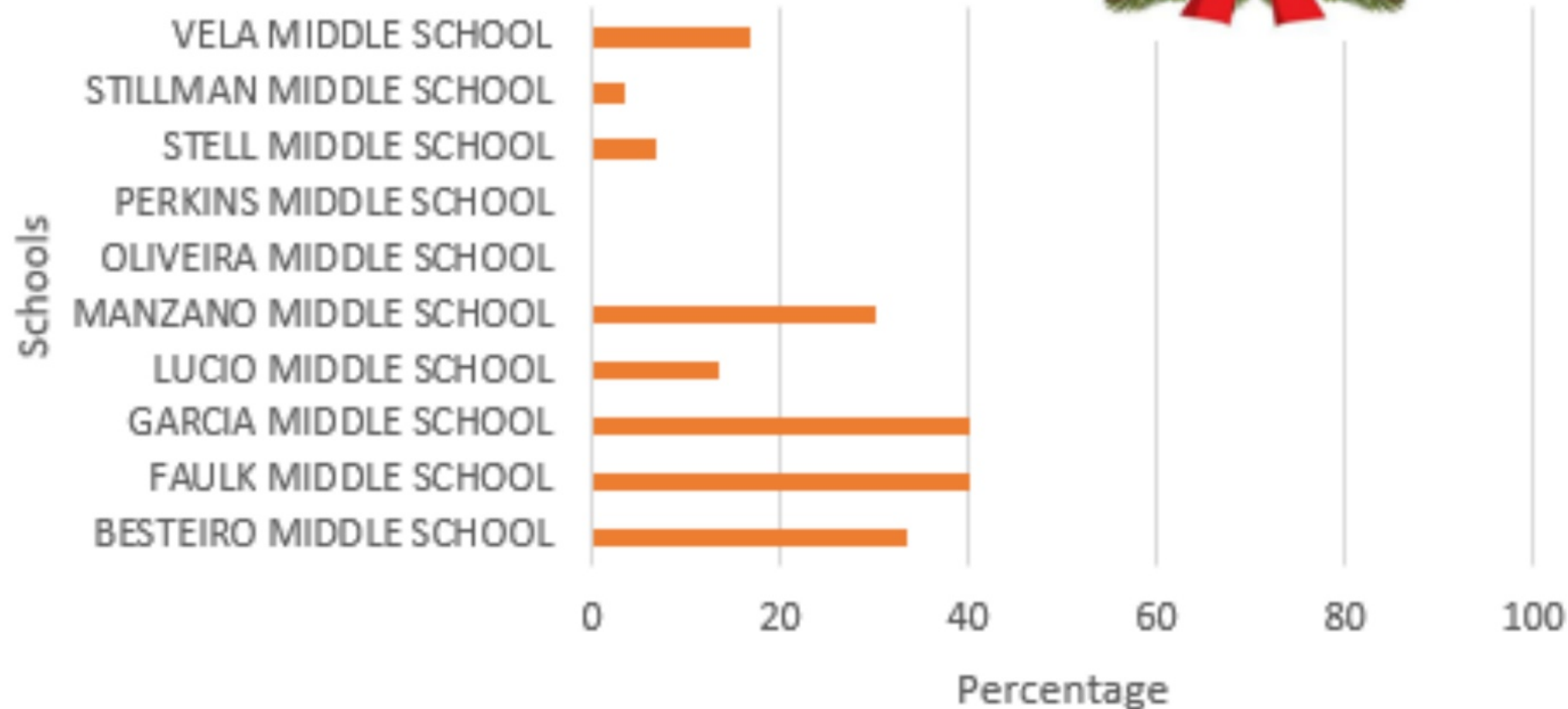

iddle Schools

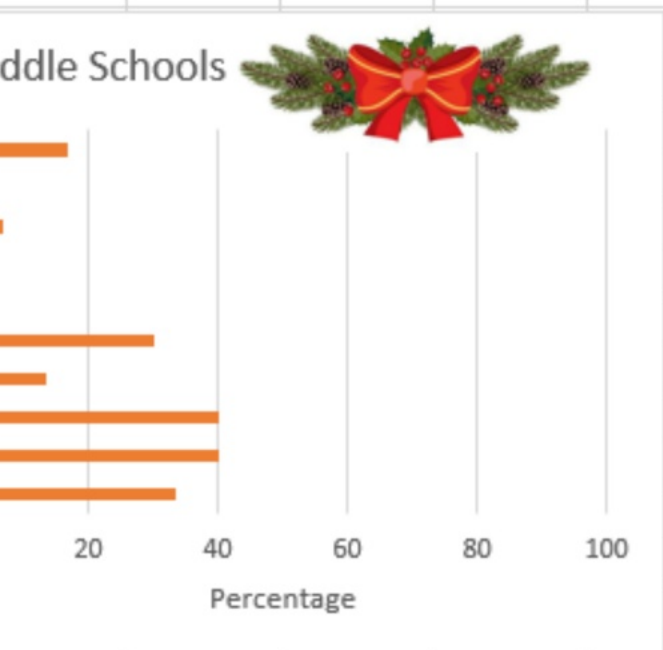

Elementary Schools

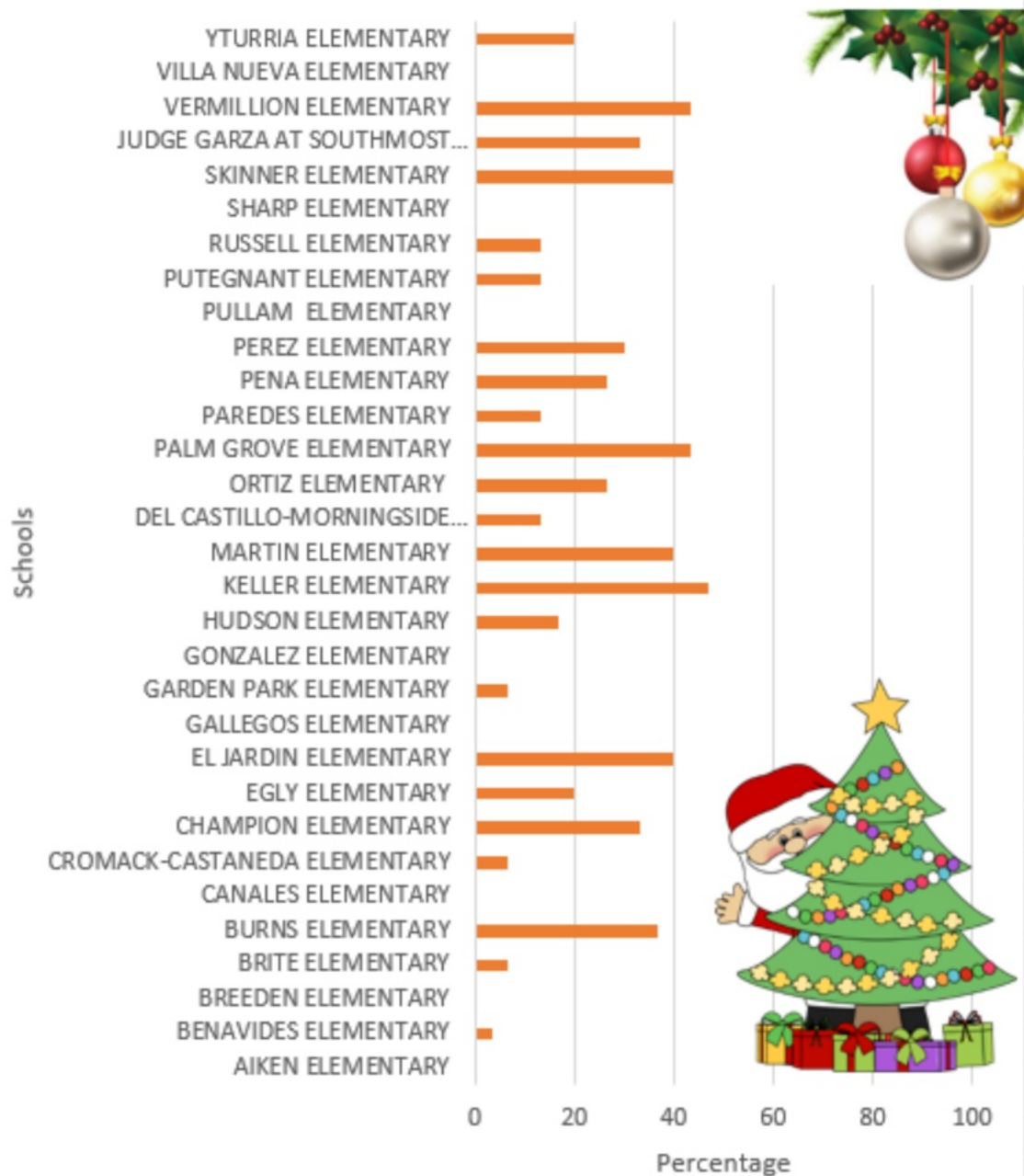

TASK 

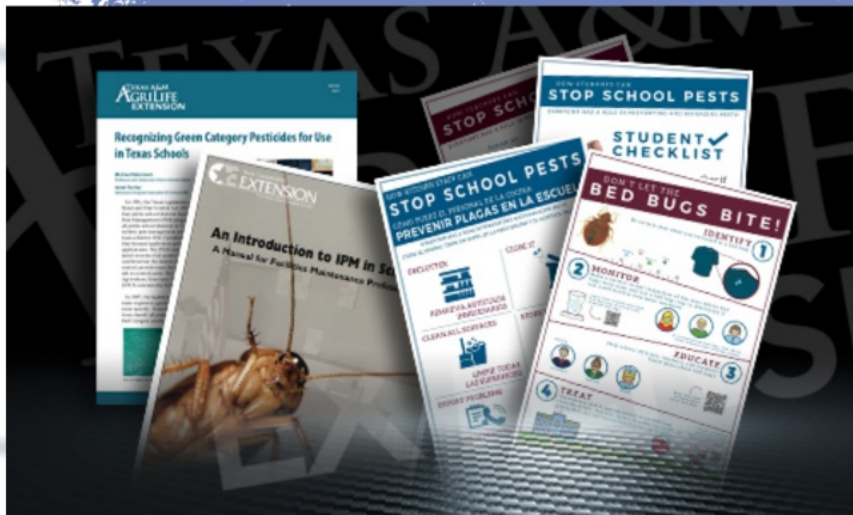

*Custodial
Services*

*Completion
Matrix*





Safety Meeting
December 2024





*Q&A
and Thank you!*





Safety Meeting
December 2024

